

MATCH LINE SEE SHEET 14

WATER DATA TABLE

SYMBOL	DELTA/BEARING	RADIUS	LENGTH	REMARKS
W19	N90°00'00"E	...	475.00'	8" PVC DR 18 C900
W21	N00°00'00"E	...	794.00'	8" PVC DR 18 C900
W22	N00°00'00"E	...	20.00'	8" PVC DR 18 C900
W23	N00°00'00"E	...	407.87'	10" PVC DR 18 C900

WATER NOTES:

1. ALL WATER PIPELINES SHALL HAVE 3' MINIMUM COVER.
2. INSTALL JOINT RESTRAINT SYSTEM AS REQUIRED AT ALL VALVES, BENDS, TEES AND FITTINGS TO MEET PRESSURE TEST REQUIREMENTS (SEE SPECIFICATION SECTION 700)
3. INSTALL BLOWOFFS PER SDWAS DWG WB-01 AT ALL LOW POINTS IN WATER PIPELINES.
4. INSTALL AIR RELEASE VALVES PER SDWAS DWGS WA-02 AND WA-03 AT ALL HIGH POINTS IN WATER PIPELINES.

STORMDRAIN DATA TABLE

SYMBOL	DELTA/BEARING	RADIUS	LENGTH	REMARKS
SD22	N90°00'00"W	...	21.37'	12" HDPE
SD41	N00°00'00"W	...	219.01'	18" HDPE
SD55	N90°00'00"E	...	158.55'	18" HDPE
SD56	N90°00'00"W	...	159.55'	18" HDPE
SD57	N90°00'00"W	...	159.27'	18" HDPE
SD58	N90°00'00"W	...	212.22'	24" HDPE
SD59	N90°00'00"W	...	207.33'	24" HDPE
SD128	N90°00'00"W	...	19.46'	12" HDPE
SD130	N00°00'00"E	...	130.86'	12" HDPE

NOTE: ALL STORM DRAIN LENGTHS ARE MEASURED ALONG PIPE CENTERLINE FROM INSIDE FACE TO INSIDE FACE ON CONCRETE STRUCTURE OR TO TERMINATION POINT AT CONCRETE HEADWALL. TABLE LENGTHS REPRESENT TOTAL PIPE LENGTH WHERE PIPES ARE SHOWN ON TWO PLAN SHEETS.

POINT DATA TABLE

POINT #	NORTHING	EASTING	REMARKS
505	1874873.9051	6428985.6798	CORNER
506	1874873.9051	6428930.6798	CORNER
534	1874643.9051	6428820.6798	RADIAL
539	1874803.9051	6428482.6798	RADIAL
540	1874803.9051	6428602.6798	RADIAL
543	1874843.9051	6428820.6798	RADIAL
779	1874559.9051	6429100.6798	TOP SLOPE
780	1874559.8373	6429104.6798	TOE SLOPE
781	1874559.8373	6429114.6798	TOE SLOPE
782	1874559.9051	6429157.7857	HINGE PT
783	1874559.9051	6429170.6358	TOP SLOPE
784	1874559.9051	6429181.2768	TOE SLOPE
785	1874659.9051	6429100.4111	TOP SLOPE
786	1874659.9051	6429104.4110	TOE SLOPE
787	1874659.9051	6429114.4110	TOE SLOPE
788	1874659.9051	6429192.2347	HINGE PT
789	1874659.9051	6429207.0101	TOP SLOPE
790	1874659.9051	6429217.6511	TOP SLOPE
791	1874759.9051	6429100.1341	TOP SLOPE
792	1874759.9051	6429104.1456	TOE SLOPE
793	1874759.9051	6429114.1548	TOE SLOPE
794	1874759.9051	6429196.7222	HINGE PT
795	1874759.9051	6429227.8208	TOP SLOPE
796	1874759.9051	6429238.0107	TOE SLOPE
797	1874864.9051	6429099.7965	TOP SLOPE
798	1874864.9310	6429103.8848	TOE SLOPE
799	1874864.9051	6429113.8848	TOE SLOPE
800	1874864.9051	6429170.4084	HINGE PT
801	1874864.9051	6429192.5377	TOP SLOPE
802	1874864.9051	6429203.1130	TOE SLOPE
803	1874958.8738	6429102.4397	TOP SLOPE
804	1874958.8738	6429106.0507	TOE SLOPE
805	1874958.8726	6429109.6921	TOE SLOPE
806	1874958.8738	6429112.7728	HINGE PT
807	1874958.8738	6429160.1959	TOP SLOPE
808	1874958.8738	6429170.7837	TOE SLOPE
809	1874972.4128	6429100.6798	TOE HINGE
810	1875020.3484	6429110.6798	TOE SLOPE
811	1875020.3484	6429139.0586	TOP SLOPE
812	1875020.3484	6429149.6339	TOE SLOPE

CENTER POINT STORM DRAIN BOX DATA TABLE

POINT #	NORTHING	EASTING	REMARKS
892	1874743.9051	6429083.2277	CP SD BOX
921	1874966.4121	6428920.6841	CP SD BOX

NOLTE
REGISTERED PROFESSIONAL ENGINEER
No. C63344
Exp. 12-30-10
CIVIL
STATE OF CALIFORNIA

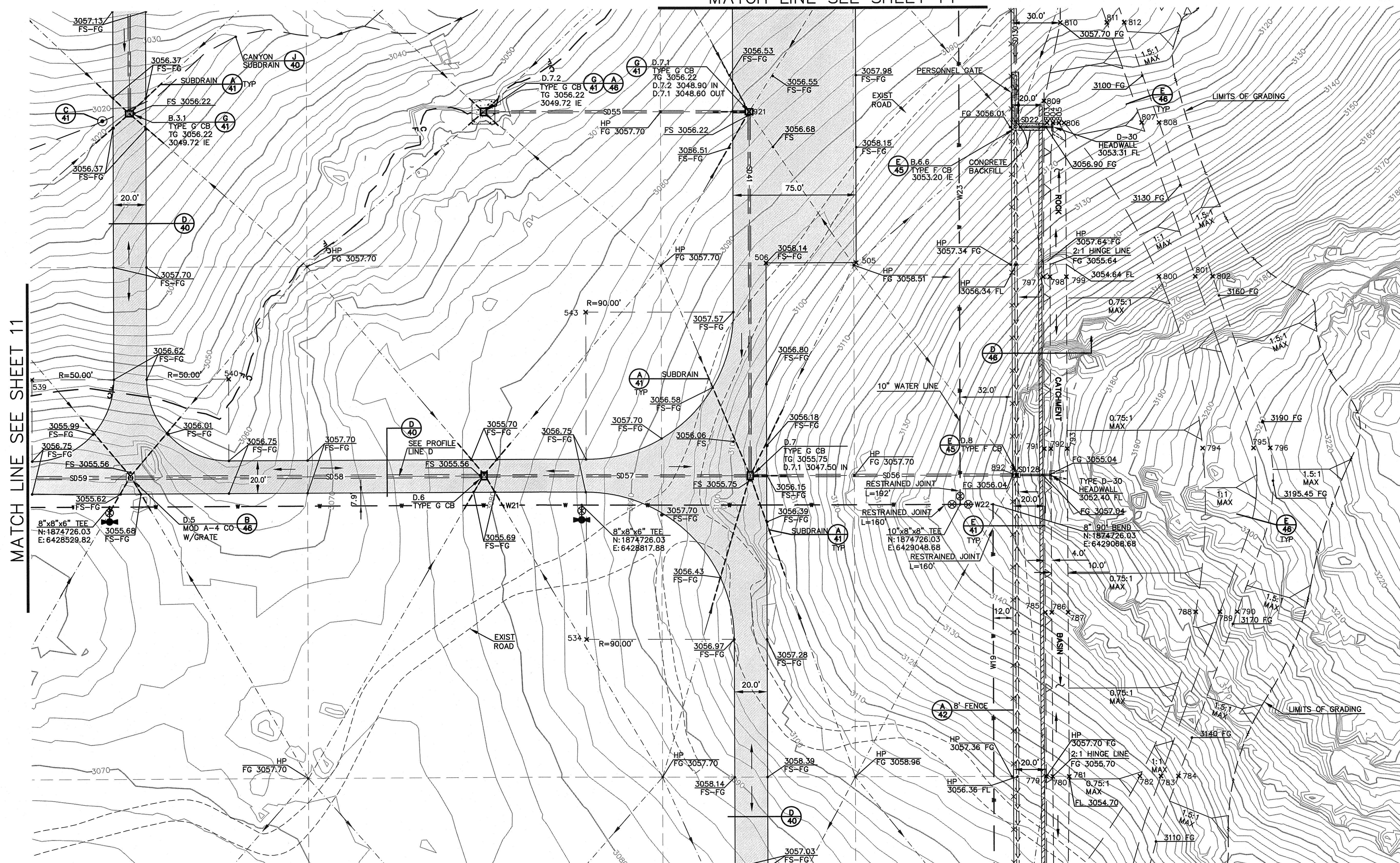
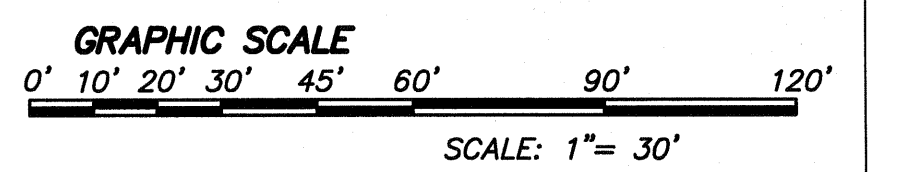

MATCH LINE SEE SHEET 11

MATCH LINE SEE SHEET 10

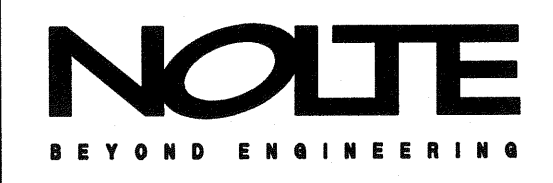

REVISIONS

NO.	WORK DONE	DATE:	BY:	APP'D:	NO.	WORK DONE	DATE:	BY:	APP'D:	NO.	WORK DONE	DATE:	BY:	APP'D:	NO.

SAN DIEGO GAS & ELECTRIC COMPANY
SAN DIEGO, CALIFORNIA

SUNCREST SUBSTATION
GRADING PLAN

DRAWN BY: MJ	DATE: 3/24/10	SCALE: 1"=30'	W.O.:	REV: 0
CHECKED BY: RWM	DATE: -	SHEET 12 OF 66	SCR-C-012	
APPROVED BY: CR	DATE: -	PLOT SCALE: 1=1		
CAD NO.: GP12				

N:\SDR030600\CADD\USFS\CIVIL\GP12.XREFS