



# ROAD IMPROVEMENT PERMIT

## COUNTY OF FRESNO ROAD MAINTENANCE AND OPERATIONS DIVISION

MAILING ADDRESS: 2220 TULARE STREET, 6<sup>th</sup> FLOOR, FRESNO, CA 93721  
OFFICE LOCATION: SOUTHWEST CORNER OF TULARE  
& 'M' STREETS, SUITE B

In compliance with County of Fresno Ordinance Nos. 13.04040, 13.08.010 and Chapter 5.5 of Division 2 of the Streets and Highways Code, the undersigned hereby applies for permission to excavate, construct and/or otherwise encroach on the County right-of-way by performing the following work.

County of Fresno  
REG-RECEIPT: 8864-111926  
CASHIER ID: RFINNEY Oct 05, 2018  
Date Printed: Oct 05, 2018 2:37 PM

### PROJECT INFORMATION

18108091 ROAD	\$405.69
SubTotal	\$405.69
GST	\$0.00
PST	\$0.00
TOTAL DUE	\$405.69
RECEIVED FROM:	
800 - PACIFIC GAS & ELEC	
ROADS CHARGE	\$405.69
ACCOUNT 800	
TOTAL TENDERED	\$405.69
CHANGE DUE	\$0.00

Permit Title: **PG&E PM# 74001710 (2) AC Approaches**

Permit No.: **IP18-0587**

Location of Proposed Work: **1889 S. MCCALL AVE N/O JENSEN AVE**

Folder No.: 18 108091  
For Inspection Service:  
Phone: (559) 600-4240  
Fax: (559) 600-4203  
EncroachmentPermits@co.fresno.ca.us

### Description of Proposed Work:

Authorization is granted to place and utilize traffic control devices within the County of Fresno Road right of way for constructing two new 16' x 14' asphalt concrete driveway approaches for the PG&E Sanger Substation.

**THIS APPLICATION IS YOUR PERMIT WHEN STAMPED AND SIGNED ABOVE**

<u>11/1/18</u>	<u>2/28/19</u>	<u>N/A</u>
Estimated Starting Date	Estimated Completion Date	Traffic Control Days

In consideration of the granting of this application, it is agreed that the applicant shall indemnify the County of Fresno and any of its officers, employees and agents and shall defend and hold them harmless from any and all claim or liability for personal injury or property damage due to any acts or failure to act in connection with any work permitted herein. Applicant further agrees to comply with all terms, conditions and specifications contained below and on the reverse side hereof.

### PERMIT APPROVAL

**NOTIFY THE COUNTY OF FRESNO PERMIT DESK AT (559)600-4240 A MINIMUM OF 48 HOURS IN ADVANCE OF BEGINNING CONSTRUCTION ACTIVITIES.**

Permission is hereby granted to perform the above described work subject to all terms, conditions and restrictions contained below and on the reverse side hereof. This permit is to be strictly construed and no work other than that specified is authorized hereby. This permit is expressly conditioned upon performance of the work. Failure to so perform said work in accordance with County specifications shall be deemed an immediate revocation of this permit and without notice. WORK SHALL BE SUBJECT TO COUNTY INSPECTION. PERMITEE SHALL NOTIFY COUNTY INSPECTOR John Barbery A MINIMUM OF 48 HOURS BEFORE STARTING WORK. (559) 554-4099 THIS PERMIT SHALL BE VOID UNLESS THE WORK HEREIN CONTEMPLATED SHALL HAVE BEEN COMPLETED BEFORE 2/28/19. To commence or complete work after said date requires approved application for permit renewal or time extension. Grantor reserves the right to complete the work to restore the right-of-way as provided in Section 10 on the reverse side hereof.

### PROJECT CONDITIONS

## ATTACHED ADDENDUM IS A PART OF THIS PERMIT

APPLICANT: 800 - PACIFIC GAS & ELEC	OWNER: 800 - PACIFIC GAS & ELEC
ADDRESS: 3580 CALIFORNIA AVE, FRESNO CA 93725	ADDRESS: 3580 CALIFORNIA AVE, FRESNO CA 93725
PHONE: (559) 250-7387 5592507387	PHONE: 5592507387
EMAIL:	EMAIL:

Project Manager: Michael Calvillo (559) 417-3337

APPLICANT SIGNATURE: (X) \_\_\_\_\_ DATE: \_\_\_\_\_

ACCOUNT NUMBER: 800 LICENSE NUMBER: \_\_\_\_\_ BOND NUMBER: \_\_\_\_\_

### PERMIT QUANTITIES & INSPECTION FEES

2204.A.4 - Asphalt Concrete (HMA) Approach/Frontage	\$405.69	2 - 16' x 14' AC Approaches
TOTAL PROJECT FEES:		<b>\$405.69</b>

Permit No.: IP18-0587

MTCE Area: 9

Steven E. White, Director  
Department of Public Works & Planning

By: Darren Findley Date: 10/5/18  
Darren Findley, Permit Engineer

## ADDENDUM

Road Encroachment Permit No. IP18-0587

Amanda Folder No. 18-108091

1. Permittee shall have the existing utilities marked by 811 USA prior to the start of work.
2. Work is limited to period of good visibility.
3. Work is to be performed during daylight hours.
4. Construction area must be signed in accordance with the current State of California Manual of Uniform Traffic Control Devices (CA MUTCD). Signs in place during hours of darkness shall be reflectorized for night time visibility in accordance with the above manual.
5. The County of Fresno will not be responsible for damage that occurs to the asphalt or concrete drive approach/frontage as a result of shoulder grading that might occur on [ McCall ] Avenue.
6. If, at any time, the asphalt or concrete drive approach/frontage impedes the flow of drainage to the surrounding area, at the request of the County, the impediment shall be removed to correct the drainage problem to the satisfaction of the County.
7. The County will not be responsible for any additional work on the drive approach/frontage authorized under this permit that may be required due to maintenance performed on [ McCall ] Avenue including elevation changes which may occur during paving operations.
8. Restore all existing drainage patterns and facilities to preconstruction conditions or better.
9. Any irrigation pipes disturbed, within the County rights-of-way, during construction shall be replaced with R.C.P.-RG, Class III. Fresno County shall determine the limits of replacement.
10. Permittee shall properly maintain and repair any encroachment authorized herein, unless such maintenance and repair by Permittee is exempted by law and shall exercise reasonable care in inspecting for and immediately repairing any injury to the highway which occurs as a result of the existence of said encroachment or as the result of any work done hereunder. If at any future date it is necessary because of road relocation or changes in grade to relocate this facility, the owner, his assigns, heirs and successors, hereby agrees to relocate the facility upon notice by the Grantor at no expense to the County, unless otherwise provided by law.
11. Permittee shall indemnify the County of Fresno and any of its officers, employees, servants, and agents and shall defend and hold them harmless from any and all liability for personal injury or property damage due to any acts in connection with the performance of the work permitted herein. It will be the responsibility of the Permittee to determine the location of any existing underground facilities within the work area and to arrange for any necessary relocation.



# ROAD ENCROACHMENT PERMIT

## COUNTY OF FRESNO ROAD MAINTENANCE AND OPERATIONS DIVISION

MAILING ADDRESS: 2220 TULARE STREET, 6<sup>TH</sup> FLOOR, FRESNO, CA 93721  
OFFICE LOCATION: SOUTHWEST CORNER OF TULARE  
& 'M' STREETS, SUITE B

In compliance with County of Fresno Ordinance Nos. 13.04040, 13.08.010 and Chapter 5.5 of Division 2 of the Streets and Highways Code, the undersigned hereby applies for permission to excavate, construct and/or otherwise encroach on the County right-of-way by performing the following work.

County of Fresno  
REG-RECEIPT: 7965-100097  
CASHIER ID: LAK6718 Oct 26, 2017  
Date Printed: Oct 26, 2017 10:05 AM

### PROJECT INFORMATION

17108100 ROAD \$320.00  
SubTotal \$320.00  
GST \$0.00  
PST \$0.00  
TOTAL DUE \$320.00

Permit Title: **PG&E BLANKET PERMIT FOR 2018**

Permit No.: **EP17-0694**

Location of Proposed Work: **VARIOUS LOCATIONS**

Amanda No.: 17 108100  
For Inspection Service:  
Phone: (559) 600-4240  
Fax: (559) 600-4203  
EncroachmentPermits@co.fresno.ca.us

RECEIVED FROM:  
PACIFIC GAS AND ELECTRIC CO  
CHECK \$320.00  
TOTAL TENDERED \$320.00  
CHANGE DUE \$0.00

### Description of Proposed Work:

Authorization is granted to place and utilize traffic control devices within the County of Fresno Road right of way to Authorization is granted to make minor excavations within various County of Fresno Right-of-Ways in dirt only, excavations shall not exceed 35 square feet in area and shall not exceed greater then 6 linear feet in length. Any work requiring a larger excavation shall be done under a regular Road Encroachment Permit. Traffic Control does not include in this Encroachment Permit it will be require approved Traffic Control Plans from County Traffic Engineer.

1/1/18

12/31/18

N/A

**THIS APPLICATION IS YOUR PERMIT WHEN STAMPED AND SIGNED ABOVE**

Estimated Starting Date

Estimated Completion Date

Traffic Control Days

In consideration of the granting of this application, it is agreed that the applicant shall indemnify the County of Fresno and any of its officers, employees and agents and shall defend and hold them harmless from any and all claim or liability for personal injury or property damage due to any acts or failure to act in connection with any work permitted herein. Applicant further agrees to comply with all terms, conditions and specifications contained below and on the reverse side hereof.

### PERMIT APPROVAL

**NOTIFY THE COUNTY OF FRESNO PERMIT DESK AT (559)600-4240 A MINIMUM OF 48 HOURS IN ADVANCE OF BEGINNING CONSTRUCTION ACTIVITIES.**

Permission is hereby granted to perform the above described work subject to all terms, conditions and restrictions contained below and on the reverse side hereof. This permit is to be strictly construed and no work other than that specified is authorized hereby.

This permit is expressly conditioned upon performance of the work. Failure to so perform said work in accordance with County specifications shall be deemed an immediate revocation of this permit and without notice.

WORK SHALL BE SUBJECT TO COUNTY INSPECTION. PERMITEE SHALL NOTIFY COUNTY INSPECTOR Various A MINIMUM OF 48 HOURS BEFORE STARTING WORK. **559-600-4240**

**THIS PERMIT SHALL BE VOID UNLESS THE WORK HEREIN CONTEMPLATED SHALL HAVE BEEN COMPLETED BEFORE 12/31/18.**

To commence or complete work after said date requires approved application for permit renewal or time extension. Grantor reserves the right to complete the work to restore the right-of-way as provided in Section 10 on the reverse side hereof.

### PROJECT CONDITIONS

SEE ANNUAL UTILITY BLANKET RIDER

APPLICANT: 800 - PACIFIC GAS & ELEC  
ADDRESS: 8 RIVER PARK PL, FRESNO CA 93720  
PHONE: (559) 250-7387 5592507387  
EMAIL:

OWNER:  
ADDRESS:  
PHONE:  
EMAIL:

Project Manager: Karen Monohon 559-347-5058

APPLICANT SIGNATURE: (X) Karen Monohon for PG&E DATE: 10/26/17

ACCOUNT NUMBER: 800 LICENSE NUMBER: BOND NUMBER:

### PERMIT QUANTITIES & INSPECTION FEES

2205.A.1 - Right of Way/Traffic Control Permission \$320.00 2018 Annual Blanket Permit Fee  
TOTAL PROJECT FEES: \$320.00

Steven E. White, Director  
Department of Public Works & Planning

By: [Signature] Date: 10/26/17  
Gennadiy Kitsen, Permit Engineer

WHITE - Office Copy GREEN - Inspector Copy CANARY - Permittee Copy PINK - Accounting Copy GOLDENROD - Area Supervisor Copy FOR OFFICE USE ONLY

Permit No.: EP17-0694 MTCE Area: Various



**COUNTY OF FRESNO**  
**ENCROACHMENT PERMIT –ANNUAL UTILITY BLANKET RIDER**

Maintenance & Operation Division  
2220 Tulare Street, Lower Annex  
Fresno, California 93271  
Phone: (559) 600-4247

**PACIFIC GAS & ELEC**  
**8 RIVER PARK PL EAST**  
**FRESNO CA 93720**  
**(Work):559-250-7387**

This permit is issued under Chapter 5.5 of Division 2 of the Streets and Highway Code. It is understood and agreed to by the permittee that by doing any of the work under this permit he or she accepts the conditions listed below. The granting of this permit does not establish any precedent concerning the kind of encroachments permitted within public right-of-way.

To be attached to and made part of Encroachment Permit Number: **EP17-0694**

complying with your request of, and subject to all terms, conditions and restrictions contained below and on the reverse side of the permit.

This Permit is issued this **1st** day of **January, 2018** by the County of Fresno, Public Works & Planning Department (hereinafter "COUNTY") to **PACIFIC GAS & ELEC** (hereinafter called the "UTILITY") to perform work as described herein, during calendar year **2018**.

Whereas, COUNTY has authority to regulate activities within COUNTY road rights-of-way pursuant to STREETS AND HIGHWAYS CODE SECTION 1460, and

Whereas, COUNTY and UTILITY have entered into a Franchise Agreement granting Utility permission to occupy County road rights-of-way, and

Whereas, pursuant to the Franchise Agreement, work performed under the agreement shall be conducted under the direction of the County Road Commissioner, and

Whereas, it is the desire of the UTILITY to obtain permission from the COUNTY for performance of emergency work or routine maintenance and replacement operations on the Utility's facilities (buried and overhead) within COUNTY road rights-of-way, and

NOW THEREFORE, COUNTY grants the UTILITY permission to perform emergency repair work and to provide routine maintenance on its facilities within the COUNTY road rights-of-way, pursuant to the Franchise Agreement, subject the following conditions:

1. *Definition of Routine Maintenance* - Routine maintenance shall be defined as maintenance to existing facilities defined in Appendix A.
2. *One Permit* - This Permit eliminates the necessity of applying to COUNTY for separate encroachment permits for routine maintenance and emergency work as defined herein.

3. *Insurance* - Utility shall obtain and maintain during the performance of any services under this Permit insurance coverage issued by a company satisfactory to the County's Risk Manager, or, if self-insured, the Utility shall submit to the County's Risk Manager, as noted above, a Letter of Self Insurance, according to the limits as currently prescribed by the County's Risk Manager for the year in which this Permit Rider is applicable.
  - a. Utility shall, prior to performance of any services, file with the Department of Public Works & Planning a certificate of insurance, certifying that the insurance coverages shall remain in effect at all times during the term of this Agreement, or any extension thereof.
  - b. Utility agrees that all insurance coverages shall be provided by a California admitted insurance carrier with an A.M. Best Rate of A-7 or better and shall bear endorsements providing that the policies may not be cancelled or modified without thirty (30) days' prior written notice to the County's Risk Manager.
  - c. Utility agrees that the commercial general liability insurance policy shall be endorsed to name County, its officers and employees as additional insured and to provide that the coverages provided to County shall be primary and not contributing to or in excess of any existing County insurance coverages.
  - d. All insurance standards applicable to Utility shall also be applicable to Utility's subcontractors. Utility agrees to maintain appropriate agreements with subcontractors and to provide proper evidence of coverage upon receipt of a written request from the County.
4. *Indemnification* - The Utility does hereby agree to indemnify and hold harmless COUNTY for and from any and all loss, damage, cost or expense proximately resulting from any maintenance and operations of Utility within the COUNTY road rights-of-way.
5. *Warranty* - Utility warrants all work within the COUNTY road rights-of-way to be free of defects for five years.
6. *Utility-Owned Forces* - All work will be performed by the Utility, including the Utility's contracted forces who will be required to submit and obtain a Rider Permit unless already on file with the County.
7. *Work Standards* - All work shall conform to COUNTY's Improvement Standards and Specifications, latest edition. All work shall be subject to COUNTY's observation and satisfaction.
8. *Encroachment Permit Notification Form* - Utility shall notify the Department of Public Works & Planning at (559) 600-4247, a minimum of 48 hours to 72 hours prior to starting of any routine maintenance work authorized by this permit, and the permittee shall submit an ENCROACHMENT PERMIT NOTIFICATION FORM. If the utility work requiring an encroachment is necessary for emergency purposes, contact the COUNTY OF FRESNO PUBLIC WORKS AND PLANNING DEPARTMENT Non-Emergency Dispatch at (559) 600-4247 to comply with the notification requirements under this Permit. Scheduled routine work shall not be on a recognized COUNTY holiday, except in the case of an emergency. If substantial work is being done that requires the relocation or abandonment of underground or surface facilities, the permittee will provide the COUNTY with information about the location changes.
9. *Required COUNTY Inspections* - COUNTY inspections may be required for, but not limited to, the following activities: Traffic control, trench backfill, compaction testing, roadway subgrade prior to placement of aggregate base, AC paving, and final five-year warranty.
10. *Traffic Control Obligations* - A Traffic Control Plan shall be submitted for ALL lane closures and must be approved by COUNTY prior to work commencing. Adequate provisions shall be made for the protection of the traveling public (including pedestrian traffic) at all times. All necessary barricades, warning signs, arrow boards and flaggers shall be provided by the Utility. All work shall be planned and performed so that there will be the least possible inconvenience to the traveling public. This provision does not allow the closing of a roadway or the implementation of a detour. Any maintenance work that requires a detour, lane closure, or the closing of any roadway shall only be performed with written approval by COUNTY. Utility agrees to observe all applicable COUNTY rules and regulations while performing the work contemplated herein and to take all other precautions that circumstances warrant. Additionally, all traffic control design and delineation shall conform to THE LATEST EDITION OF THE California Manual on Uniform Traffic Control Devices (CAMUTCD) standards.
11. *Pavement & Concrete Removal* - When pavement and/or concrete removal is anticipated for routine maintenance work, prior approval shall be obtained from the County and a separate permit shall be issued for that work.

## Appendix A Definition of New and Routine Maintenance

### Overhead: Routine activities are as listed but not limited to the following

- a. Maintain, inspect, repair or replace in the same location all aerial facilities.
- b. String service drop wire or install service connections from facilities existing within the COUNTY road right of way.
- c. Stub, or reset existing pole, provided no change in the location or pole or anchor is made. Stubs and anchors must not be placed between existing poles, within vehicular traveled way, or the required ADA path of travel.
- d. Replace poles, guy poles, and cross arms in or near the same location (less than 10 feet away when it does interfere with the required ADA path of travel). No new poles are authorized under these conditions.
- e. Install new and replace existing transformers on existing poles.
- f. Installations and clearances shall be equal to those required by either the California Public Utilities Commission Order or the California Occupational Safety and Health (CAL-OSHA) Safety Orders, whichever is greater.
- g. Clear grass from around base of poles and excavate around poles for inspection, including tamping and straightening.
- h. Trimming of trees for maintenance purposes at locations of existing aerial lines.
- i. Tree/vegetation: Prune and remove vegetation within franchise easement to meet State General Order 95, Rule 35 and improve electric reliability/public safety

### Underground: Routine activities are listed but not limited to the following

- a. Maintain, inspect, repair or replace in the same location all underground facilities accessible through existing enclosure, vaults and manholes.
- b. Minor maintenance work involving an excavation where such excavation does not exceed 6 feet in any direction or a surface area of 35 square feet for excavations in dirt areas within the County road rights-of-way or Public Utility Easement.
- c. Replace, repair, and adjust, all existing manhole covers, rings, lids, to match changes in conditions.
- d. Emergency work within paved areas of County roads may be performed under this Blanket Permit, but routine maintenance work in paved areas shall be performed under separate Encroachment Permit. Pavement restoration for Emergency Work shall be performed to COUNTY standards.
- e. USA required pot holes and/ or bar holes less than 2' x 2', with full compaction and saw cut beyond hole diameter. Fill pot holes with temporary paving, with permanent paving to follow as soon as possible, but at least within 30 calendar days. Restoration shall be to COUNTY standards.
- f. **PACIFIC GAS & ELEC** manhole access in roadway/ right of way (including basic shoulder closures during business hours).
- g. Pedestal/ CAD/ box repair/ replacement for small in-ground dimensions (2' x 2' or less).
- h. Gas and electric bell holes for leak repair, splice box repair/ replacement and boring; where standard size would be a 5' x 5' bell hole, provided there is no disruption of traffic and no disturbance to public improvements.
- i. Emergency work- Emergency work can be performed without a separate Encroachment Permit, however any disruption to the public right of way whether to traffic or physical improvements must be submitted by the end of the next business day, along with proper notification that the emergency work is taking place.

12. *Removal/Relocation at Option of COUNTY* - Utilities within the County road rights-of-way are subject to removal/relocation under the conditions of the Franchise Agreement.
13. *Repair of Rights-of-Way Upon Removal* - All work performed within road rights-of-way shall be repaired and/or removed in accordance with the Franchise Agreement. This includes, but is not limited to, repair of roadways, sidewalks, curbs, gutters, shoulders and removal of all temporary signs, traffic control devices, and storm water BMP's used in conjunction with the work performed.
14. *All Work at Utility's Expense* - All work associated with the construction, maintenance & operations, relocating or removing of the service facilities contemplated herein shall be performed by the Utility at the Utility's sole expense.
15. *Rights of Abutting Property Owners* - It is distinctly understood that this Permit does not in any way grant or release any rights lawfully possessed by the abutting property owners. Any such rights necessary for the Utility's work must be secured by the Utility from the abutting property owners prior to performing the work.
16. *Discharges of Storm Water and Non-Storm Water* - Work within the COUNTY'S road rights-of-way shall be conducted in compliance with all applicable requirements of the National Pollutant Discharge Elimination System (NPDES) permit(s) issued to COUNTY, to govern the discharge of storm water and non-storm water from its properties. Work shall also adhere to all other applicable federal, state and local laws and regulations, and COUNTY's requirements. Where applicable, the applicant may need to obtain a General Permit from the Regional Water Quality Control Board.
17. *Permit Subject to Inspection* - A copy of this approved Permit shall be kept at the site of the work at all times while said work is under way and must be shown to any representative of COUNTY or law enforcement officer on demand.
18. *COUNTY's Right to Revoke* - This Permit may be revoked by COUNTY at any time upon written 30-day notice to the Utility. Prior to proceeding with the right to revoke, the COUNTY shall attempt reasonable resolution with Utility. Failure to comply with the requirements herein, including reporting requirements, may lead to the revocation of this and future blanket permits. This permit is expressly conditioned upon performance of the work. Failure to so perform said work in accordance with the specifications hereinabove set forth shall be deemed cause for an immediate revocation of this permit and without notice.
19. *Annual Permit Fee* - The Utility shall pay an annual permitting application fee in the amount of \$320.00 per calendar year, payable on or before January 1st. The Utility may establish an annual utility fee draw-down account of with the County.
20. *Annual Renewal* - This Permit shall expire December 31st of the calendar year for which the permit was issued.

This rider must be attached to the original permit.

*Karen Monohan for PG&E*

**SIGNATURE OF PERMITTEE**

By: *Karen Monohan for PG&E*  
 (Print Name and Title; Date Signed)  
*Dependency Management Lead*  
*10/26/17*

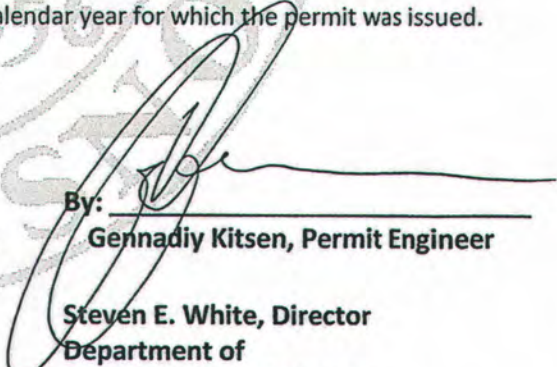
By:   
**Gennadiy Kitsen, Permit Engineer**

**Steven E. White, Director**  
**Department of**  
**Public Works and Planning**

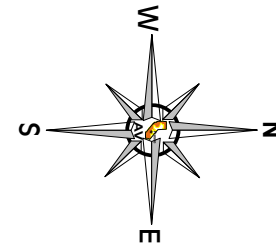

**Contractor to Set Up  
Contractor to Maintain  
All Traffic Control Will Meet MUTCD Standards**

Jensen

McCall Ave

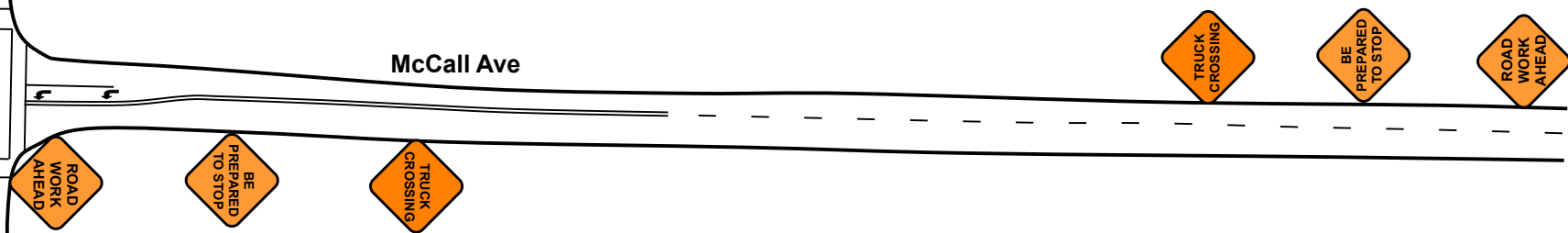

Table 6C-1, Suggested Advance Warning Sign Spacing (2014 CAMUTCD)

Road Type	Distance Between Signs** (Feet)		
	A	B	C
Urban: 25mph or less	100	100	100
Urban: More than 25mph to 40mph	250	250	250
Urban: More than 40mph	350	350	350
Rural	500	500	500
Expressway/Freeway	1000	1000	1000

	<b>Traffic Control:</b> Truck Crossing	<b>Prime Contractor:</b> AJ Excavation	<b>Job Number:</b> 69989
	<b>Start Date:</b>	<b>Field Contact:</b> Jesse Emmett	<b>Plan Number :</b> 18AV196
	<b>Duration:</b>	<b>Contact Number:</b> 559-696-5135	<b>Permit #:</b>