

**APPENDIX D – NATIVE AMERICAN HERITAGE COMMISSION (NAHC)  
CORRESPONDENCE**

**CONTENTS**

**D-1 2012 Letters**

**D-2 2015 Letters**



**D-1 – NAHC CORRESPONDENCE  
2012 LETTERS**





## Native American Consultation Log

### PG&E Sanger Substation Expansion Project

Organization	Contact	Letter	E-mail	Other	Comments
Native American Heritage Commission	Dave Singleton	12/6/2011	—	—	Sacred Lands File failed to indicate the presence of sacred sites in the project area. Provided a list of local Native American contacts.
Big Sandy Rancheria of Mono Indians	Chairperson, Liz Hutchins Kipp	3/7/2012	4/12/2012		
Cold Springs Rancheria of Mono	Chairperson, Robert Marquez	3/7/2012	4/12/2012		
Santa Rosa Rancheria	Chairperson, Rueben Barrios	3/7/2012	4/12/2012		
Sierra Nevada Native American Coalition	Chairperons, Lawrence Bill	3/7/2012		Phone	
Choinumni Tribe; Choinumni/ Mono	Lorrie Planas	3/7/2012	4/12/2012		Responded by e-mail (4/12/2012) that she has no issues or comments.
Table Mountain Rancheria	Bob Pennell, Cultural Resources Director	3/7/2012	4/12/2012		Received a letter dated 3/28/2012 declining participation at this time. However, would like to be notified in the unlikely event that cultural resources are identified.
Kings River Choinumni Farm Tribe	Chairperson, John Davis	3/7/2012		Phone	Attempted to call on 4/25/12, number incorrect.
Dunlap Band of Mono Historical Preservation Society	Chairperson, Mandy Marine	3/7/2012	4/12/2012		
Esohm Valley Band of Indians/ Wuksache Tribe	Chairperson, Kenneth Woodrow	3/7/2012	4/12/2012		
Choinumni Tribe of Yokuts	Chairperson, Rosemary Smith	3/7/2012	4/12/2012		
Traditional Choinumni Tribe	Chairperson, David Alvarez	3/7/2012	4/12/2012		
N/A	Frank Marquez	3/7/2012	4/12/2012	Phone	Called on 4/25/12 @ 10:50AM, message left.
Santa Rosa Tachi Rancheria	Lalo Fanco, Cultural Coordinator	3/7/2012	4/12/2012		Responded by e-mail (4/13/2012) with no immediate concerns; however, recommended construction be monitored by an archaeologist and that all parties be made aware of the recommended actions to be taken in the event of a discovery of any cultural features.
Dumna Wo Wah Tribe	Chairperson, Robert G. Ledger, Sr.	3/7/2012	—	—	

STATE OF CALIFORNIA

Edmund G. Brown, Jr., Governor

**NATIVE AMERICAN HERITAGE COMMISSION**

915 CAPITOL MALL, ROOM 364  
SACRAMENTO, CA 95814  
(916) 653-6251  
Fax (916) 657-5390  
Web Site [www.nahc.ca.gov](http://www.nahc.ca.gov)  
ds\_nahc@pacbell.net



December 6, 2011

Mr. Andrew Monastero, Environmental Planner

**Applied EarthWorks, Inc.**

1391 West Shaw Avenue, Suite C  
Fresno, CA 93711

Sent by FAX to: 559-229-2019  
No. of Pages: 5

Re: Sacred Lands File Search and Native American Contacts list for the  
"Proposed Pacific Gas & Electric Sanger Substation Expansion Project;" located  
west of the Community of Sanger, Fresno County, California

Dear Mr. Monastero:

The Native American Heritage Commission (NAHC) conducted a Sacred Lands File search of the 'area of potential effect,' (APE) based on the USGS coordinates provided and **Native American cultural resources were not identified** in the project area of potential effect (e.g. APE): you specified. Also, please note; the NAHC Sacred Lands Inventory is not exhaustive and does not preclude the discovery of cultural resources during any project groundbreaking activity. This area of San Diego County is known to the NAHC to be very culturally sensitive.

California Public Resources Code §§5097.94 (a) and 5097.96 authorize the NAHC to establish a Sacred Land Inventory to record Native American sacred sites and burial sites. These records are exempt from the provisions of the California Public Records Act pursuant to California Government Code §6254 (r). The purpose of this code is to protect such sites from vandalism, theft and destruction.

In the 1985 Appellate Court decision (170 Cal App 3rd 604), the court held that the NAHC has jurisdiction and special expertise, as a state agency, over affected Native American resources, impacted by proposed projects including archaeological, places of religious significance to Native Americans and burial sites

The California Environmental Quality Act (CEQA – CA Public Resources Code §§ 21000-21177, amendments effective 3/18/2010) requires that any project that causes a substantial adverse change in the significance of an historical resource, that includes archaeological resources, is a 'significant effect' requiring the preparation of an Environmental Impact Report (EIR) per the CEQA Guidelines defines a significant impact on the environment as 'a substantial, or potentially substantial, adverse change in any of physical conditions within an area affected by the proposed project, including ... objects of historic or aesthetic significance.' In order to comply with this provision, the lead agency is required to assess whether the project will have an adverse impact on these resources within the 'area of potential effect (APE), and if so, to mitigate that effect. CA Government Code §65040.12(e) defines "environmental justice" provisions and is applicable to the environmental review processes.

Early consultation with Native American tribes in your area is the best way to avoid unanticipated discoveries once a project is underway. Local Native Americans may have knowledge of the religious and cultural significance of the historic properties of the proposed project for the area (e.g. APE). Consultation with Native American communities is also a matter of environmental justice as defined by California Government Code §65040.12(e). We urge consultation with those tribes and interested Native Americans on the list the NAHC has attached in order to see if your proposed project might impact Native American cultural resources. Lead agencies should consider avoidance as defined in §15370 of the CEQA Guidelines when significant cultural resources as defined by the CEQA Guidelines §15064.5 (b)(c)(f) may be affected by a proposed project. If so, Section 15382 of the CEQA Guidelines defines a significant impact on the environment as "substantial," and Section 2183.2 which requires documentation, data recovery of cultural resources.

The 1992 *Secretary of the Interiors Standards for the Treatment of Historic Properties* were revised so that they could be applied to all historic resource types included in the National Register of Historic Places and including cultural landscapes. Also, federal Executive Orders Nos. 11593 (preservation of cultural environment), 13175 (coordination & consultation) and 13007 (Sacred Sites) are helpful, supportive guides for Section 106 consultation. The aforementioned Secretary of the Interior's *Standards* include recommendations for all 'lead agencies' to consider the historic context of proposed projects and to "research" the cultural landscape that might include the 'area of potential effect.'

Partnering with local tribes and interested Native American consulting parties, on the NAHC list, should be conducted in compliance with the requirements of federal NEPA (42 U.S.C 4321-43351) and Section 106 4(f), Section 110 (f)(k) of federal NHPA (16 U.S.C. 470 *et seq*), 36 CFR Part 800.3 (f) (2) & .5, the President's Council on Environmental Quality (CSQ, 42 U.S.C 4371 *et seq.* and NAGPRA (25 U.S.C. 3001-3013) as appropriate. The 1992 *Secretary of the Interiors Standards for the Treatment of Historic Properties* were revised so that they could be applied to all historic resource types included in the National Register of Historic Places and including cultural landscapes. Also, federal Executive Orders Nos. 11593 (preservation of cultural environment), 13175 (coordination & consultation) and 13007 (Sacred Sites) are helpful, supportive guides for Section 106 consultation. The NAHC remains concerned about the limitations and methods employed for NHPA Section 106 Consultation.

Also, California Public Resources Code Section 5097.98, California Government Code §27491 and Health & Safety Code Section 7050.5 provide for provisions for accidentally discovered archeological resources during construction and mandate the processes to be followed in the event of an accidental discovery of any human remains in a project location other than a 'dedicated cemetery', another important reason to have Native American Monitors on board with the project.

To be effective, consultation on specific projects must be the result of an ongoing relationship between Native American tribes and lead agencies, project proponents and their contractors, in the opinion of the NAHC. An excellent way to reinforce the relationship between a project and local tribes is to employ Native American Monitors in all phases of proposed projects including the planning phases.

Confidentiality of "historic properties of religious and cultural significance" may also be protected under Section 304 of the NHPA or at the Secretary of the Interior discretion if not eligible for listing on the National Register of Historic Places. The Secretary may also be advised by the federal Indian Religious Freedom Act (cf. 42 U.S.C., 1996) in issuing a decision

on whether or not to disclose items of religious and/or cultural significance identified in or near the APE and possibility threatened by proposed project activity.

If you have any questions about this response to your request, please do not hesitate to contact me at (916) 653-6251.

Sincerely,

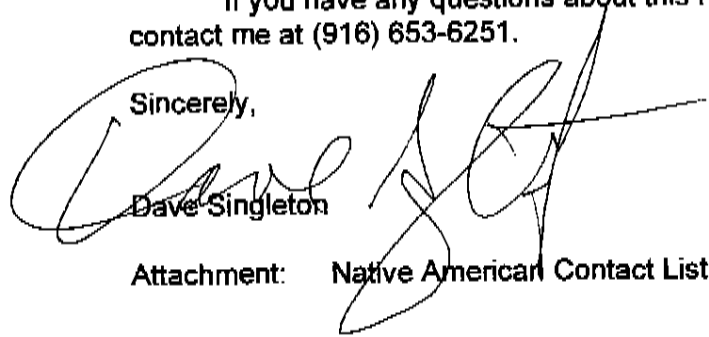
A large, stylized handwritten signature in black ink, appearing to read "Dave Singleton". The signature is written over the printed name and extends upwards and to the right.

Dave Singleton

Attachment: Native American Contact List



**California Native American Contacts**

Fresno County

December 6, 2011

Big Sandy Rancheria of Mono Indians  
Liz Hutchins Kipp, Chairperson  
P.O. Box 337 / 37302 Western Mono  
Auberry, CA 93602  
ck@bigsandyrancheria.com  
(559) 855-4003  
(559) 855-4129 Fax

Choinumni Tribe; Choinumni/Mono  
Lorrie Planas  
2736 Palo Alto Clovis, CA 93611 Choinumni  
Mono

Cold Springs Rancheria of Mono Indians  
Robert Marquez, Chairperson  
P.O. Box 209 Mono  
Tollhouse, CA 93667  
(559) 855-5043  
559-855-4445 - FAX

Table Mountain Rancheria  
Bob Pennell, Cultural Resources Director  
P.O. Box 410 Yokuts  
Friant, CA 93626-0177  
(559) 325-0351  
(559) 217-9718 - cell  
(559) 325-0394 FAX

Santa Rosa Rancheria  
Rueben Barrios, Chairperson  
P.O. Box 8 Tache  
Lemoore, CA 93245 Tachi  
(559) 924-1278 Yokut  
(559) 924-3583 Fax

Kings River Choinumni Farm Tribe  
John Davis, Chairman  
1064 Oxford Avenue Foothill Yokuts  
Clovis, CA 93612-2211 Choinumni  
(669) 307-6430

Sierra Nevada Native American Coalition  
Lawrence Bill, Interim Chairperson  
P.O. 125 Mono  
Dunlap, CA 93621 Foothill Yokuts  
(559) 338-2354 Choinumni

Dunlap Band of Mono Historical Preservation Soc  
Mandy Marine, Board Chairperson  
P.O Box 18 Mono  
Dunlap, CA 93621  
mandy\_marine@hotmail.  
com  
559-274-1705  
559-252-0198 - fax

This list is current only as of the date of this document.

Distribution of this list does not relieve any person of the statutory responsibility as defined in Section 7050.5 of the Health and Safety Code, Section 5097.94 of the Public Resources Code and Section 5097.98 of the Public Resources Code.

This list is applicable for contacting local Native Americans with regard to cultural resources for the proposed PG&E Sanger Substation Expansion Project; located west of the Community of Sanger in southern Fresno County, California for which a Sacred Lands File search and Native American Contacts list were requested.

**California Native American Contacts**

Fresno County

December 6, 2011

**Esohm Valley Band of Indians/Wuksache Tribe**  
**Kenneth Woodrow, Chairperson**

1179 Rock Haven Ct.  
 Salinas, CA 93906

kwood8934@aol.com

831-443-9702

Foothill Yokuts

Mono

Wuksache

**Santa Rosa Tachi Rancheria**  
**Lalo Franco, Cultural Coordinator**

P.O. Box 8  
 Lemoore, CA 93245

(559) 924-1278 - Ext. 5

(559) 924-3583 - FAX

Tachi

Tache

Yokut

**The Choinumni Tribe of Yokuts**  
**Rosemary Smith, Chairperson**

1505 Barstow  
 Clovis, CA 96311

monoclovis@yahoo.com

559-862-5757

Choinumni

Foothill YoKut

**Dumna Wo Wah Tribe**

**Robert G. Ledger, Sr. Chairman**

2216 E. Hammond  
 Fresno, CA 93703

(559) 519-3988

Dumna/Foothill

**Traditional Choinumni Tribe**  
**David Alvarez, Chairperson**

2415 E. Houston Avenue  
 Fresno, CA 93720

davealvarez@sbcglobal.net

Choinumni

(559) 323-6231

(559) 292-5057 FAX

**Frank Marquez**

P.O. Box 565  
 Friant, CA 93626

francomarquez@pmr.org

559-213-6543 - cell

559-822-3785

Mono

Foothill Yokut

This list is current only as of the date of this document.

Distribution of this list does not relieve any person of the statutory responsibility as defined in Section 7050.5 of the Health and Safety Code, Section 5097.94 of the Public Resources Code and Section 5097.98 of the Public Resources Code.

This list is applicable for contacting local Native Americans with regard to cultural resources for the proposed PG&E Sanger Substation Expansion Project; located west of the Community of Sanger in southern Fresno County, California for which a Sacred Lands File search and Native American Contacts list were requested.



EXAMPLE

1391 W. Shaw Ave., Suite C  
Fresno, CA 93711-3600  
O: (559) 229-1856 | F: (559) 229-2019

March 07, 2012

Dumna Wo Wah Tribe  
Robert G. Ledger, Sr., Chairman  
2216 E. Hammond  
Fresno, CA 93703

RE: Pacific Gas and Electric Company Sanger Substation Project, Fresno County, California

Dear Mr. Ledger:

Applied Earthworks, Inc. (Æ) is currently providing cultural resource services in support of Pacific Gas and Electric Company's (PG&E) Sanger Substation Project located west of the City of Sanger and southeast of the City of Fresno (Figure 1) in unincorporated Fresno County. The project will include the replacement of nine breakers, 24 switches/disconnects, 18 structures, and the control building at the existing Sanger Substation. Due to congestion and a lack of space inside the substation, and based on the major civil and electrical requirements of the breakers, structures and switch replacement work, PG&E proposes to build the new substation on an adjacent site approximately 9 acres in size. As part of these services, Æ is conducting a records search, Native American consultation, and a cultural resources survey of the project area. The Native American Heritage Commission has provided your name as a person who may have knowledge of cultural resources in the project area. This is why we are contacting you at this time.

The Sanger Substation occupies a 4.5-acre parcel at the intersection of East Jensen Avenue and South McCall Avenue.. Specifically, it lies within Township 14 South, Range 22 East, Section 18 as shown on the Sanger CA 7.5 minute USGS quadrangle (Figure 2). Current plans propose to build the new substation on lands directly adjacent and north of the existing substation. Alternatively, the substation expansion may occur adjacent to the west.

If you have and are willing to share information on any cultural resources (e.g., former village sites, traditional food gathering places, sacred sites, etc.) within the project area, please contact me by mail (see address above), email ([mbaloian@appliedearthworks.com](mailto:mbaloian@appliedearthworks.com)) or by phone (559 229 1856, Ext. 11). I would be most grateful for any information you might provide. Be assured that any locations of archaeological sites, cemeteries, or sacred places will be treated confidentially, as required by law, and not disclosed in any document available to the general public. Thank you for your assistance.

Sincerely,

A handwritten signature in cursive script that reads "Mary Clark Baloian".

Mary Clark Baloian, Ph.D., RPA  
Senior Archaeologist

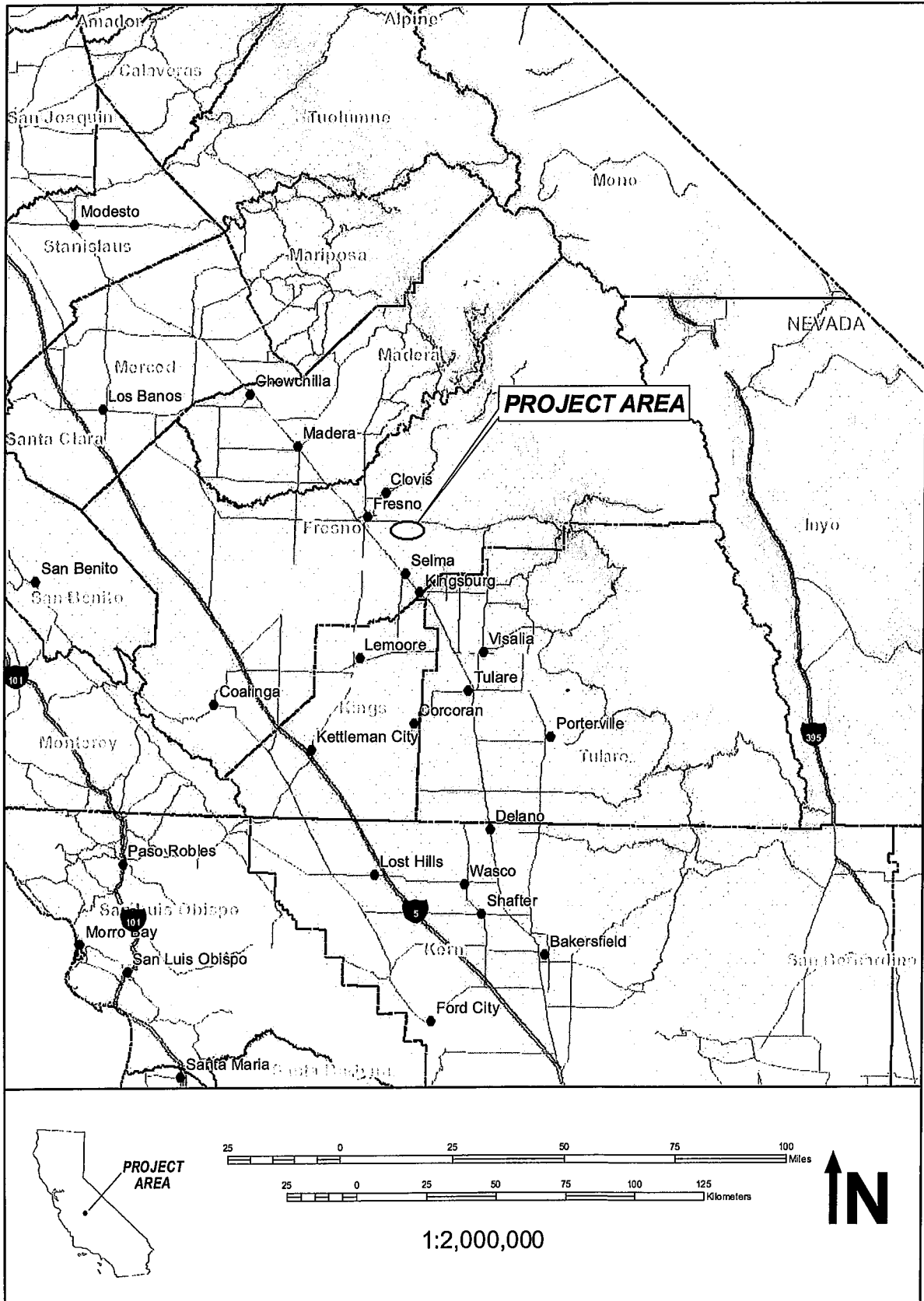
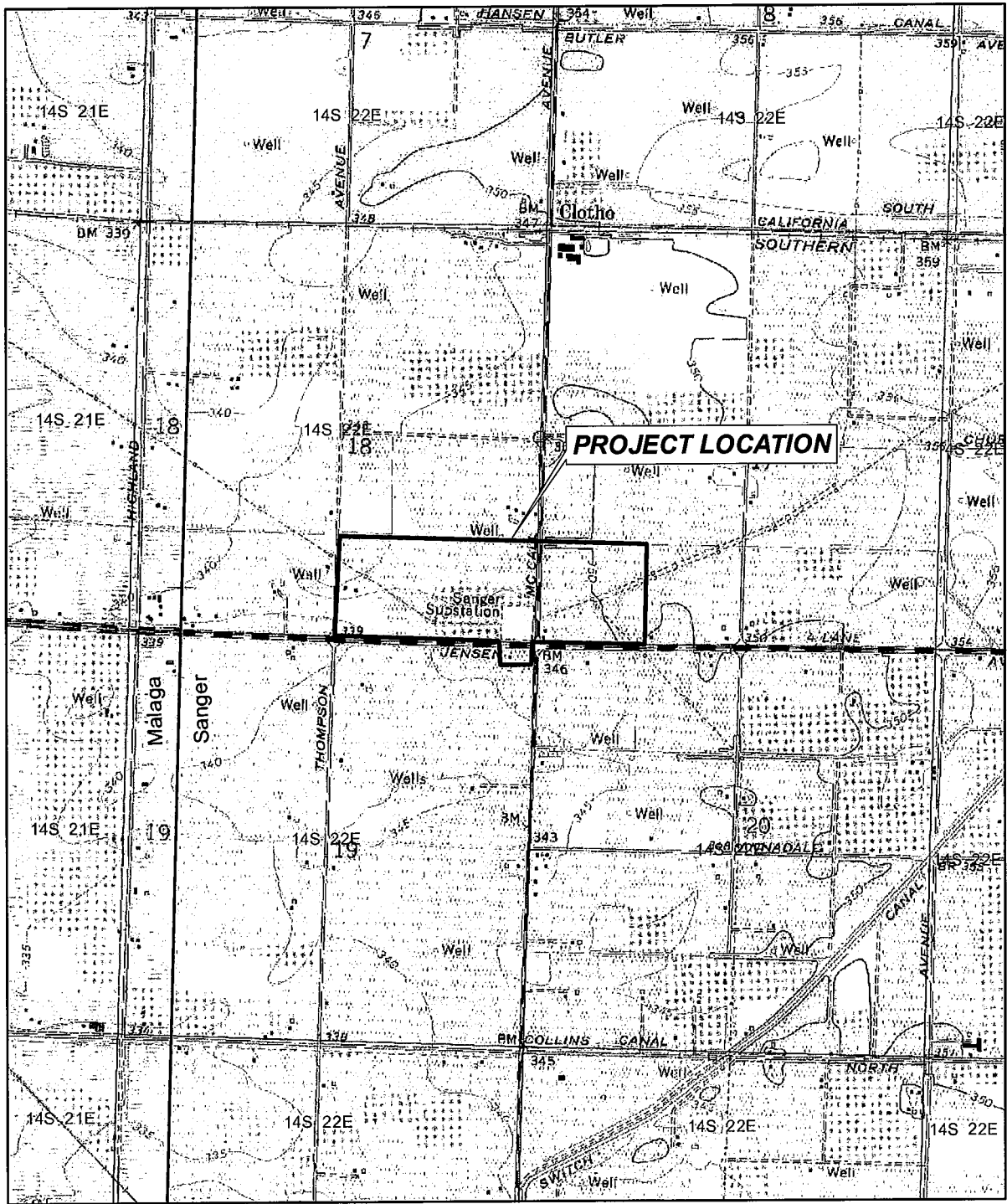
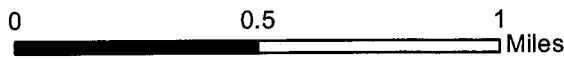

Figure 1 Project area in Fresno County.



Township 14 S Range 22 E, Section 17,18,19  
 Sanger, CA 7.5' USGS Quadrangle



1:24,000



Figure 2 Project location

## EXAMPLE

**From:** Mary Baloian [mbaloian@appliedearthworks.com]

**Sent:** Thursday, April 12, 2012 12:43 PM

**To:** 'Robert Marquez'

**Subject:** PGE Sanger Substation Expansion Project

Dear Mr. Marquez,

Applied Earthworks, Inc. (Æ) recently sent you a letter (dated March 7, 2012) informing you about the PG&E's Sanger Substation Expansion Project in Sanger, Ca. The project will include the replacement of nine breakers, 24 switches/disconnects, 18 structures, and the control building at the existing Sanger Substation, the construction of a new substation on an adjacent site approximately 9 acres in size, and the replacement of transmission poles on the adjacent property. Æ is currently providing cultural resource services in support of the project and have contacted the Native American Heritage Commission (NAHC) regarding the potential for sacred sites in the project area. The NAHC has provided your name as a person who may have knowledge of cultural resources in the project area. That is why we contacted you in March.

I am now following up to inquire whether you wish to comment on this project or are willing to share any information you may have regarding cultural resources (e.g., former village sites, traditional food gathering places, sacred sites, etc.) within the project area. If so, please don't hesitate to contact me by mail (see address above), email (mbaloian@appliedearthworks.com) or by phone (559 229 1856, Ext. 11). I would be most grateful for any information you might provide. Be assured that any locations of archaeological sites, cemeteries, or sacred places will be treated confidentially, as required by law, and not disclosed in any document available to the general public.

Thank you for your assistance,

**Mary Clark Baloian, Ph.D., RPA | Applied EarthWorks, Inc.  
Senior Archaeologist**

1391 W. Shaw Ave., Ste. C  
Fresno, CA 93711-3600  
559.229.1856 x-11      office  
559.801.1652            mobile

**From:** lplanas@comcast.net  
**Sent:** Thursday, April 12, 2012 4:31 PM  
**To:** Mary Baloian  
**Subject:** Re: PGE Sanger Substation Expansion Project  
I have no issues or comments. Lorrie

---

**From:** "Mary Baloian" <mbaloian@appliedearthworks.com>  
**To:** lplanas@comcast.net  
**Sent:** Thursday, April 12, 2012 12:46:46 PM  
**Subject:** PGE Sanger Substation Expansion Project

Hi Lorrie,

Applied Earthworks, Inc. (Æ) recently sent you a letter (dated March 7, 2012) informing you about the PG&E's Sanger Substation Expansion Project in Sanger, Ca. The project will include the replacement of nine breakers, 24 switches/disconnects, 18 structures, and the control building at the existing Sanger Substation, the construction of a new substation on an adjacent site approximately 9 acres in size, and the replacement of transmission poles on the adjacent property. Æ is currently providing cultural resource services in support of the project and have contacted the Native American Heritage Commission (NAHC) regarding the potential for sacred sites in the project area. The NAHC has provided your name as a person who may have knowledge of cultural resources in the project area. That is why we contacted you in March.

I am now following up to inquire whether you wish to comment on this project or are willing to share any information you may have regarding cultural resources (e.g., former village sites, traditional food gathering places, sacred sites, etc.) within the project area. If so, please don't hesitate to contact me by mail (see address above), email (mbaloian@appliedearthworks.com) or by phone (559 229 1856, Ext. 11). I would be most grateful for any information you might provide. Be assured that any locations of archaeological sites, cemeteries, or sacred places will be treated confidentially, as required by law, and not disclosed in any document available to the general public.

Thank you for your assistance,

**Mary Clark Baloian, Ph.D., RPA | Applied EarthWorks, Inc.**  
**Senior Archaeologist**

1391 W. Shaw Ave., Ste. C  
Fresno, CA 93711-3600  
559.229.1856 x-11 office  
559.801.1652 mobile

**From:** Hector Franco [HFranco@tachi-yokut.com]  
**Sent:** Friday, April 13, 2012 10:30 AM  
**To:** Mary Baloian  
**Subject:** RE: PGE Sanger Substation Expansion Project  
April 13, 2012

To: Mary Baloian. Applied Earth Works Analyst

From: Lalo Franco. Cultural Specialist/NAGPRA Coordinator  
Santa Rosa Rancheria Tachi Yokut Tribe

Re: Sanger Sub Station Expansion Project

Dear Mary Baloian

The Santa Rosa Rancheria appreciates the opportunity to comment on the proposed Sanger Sub Station Expansion.

After a careful review of the information you have sent us and a careful review of our Tribal Records the Tachi Yokut Tribe has no immediate concerns that this project will impact any cultural features such as burial grounds or gathering areas. This not to say that no culture features may be encountered during the course of earth moving activities. The City of Sanger and this particular part of the county has a long history of occupation by the Chounumni Tribe.

Our recommendations are that Applied Earth Works urge the City of Sanger to proceed with caution during the course of construction and that they hire an Archeological Monitor to oversee the project and that all parties involved receive all the relative information that address the recommended actions to be taken in the event of a discovery of any cultural features (Public Resource Codes)

The Santa Rosa Rancheria is also available to consult with in the event of a discovery or if any cultural items may need to be curated.

Thank you for kind attention Mary.

Lalo Franco. Cultural Specialist/NAGPRA Coordinator  
Santa Rasa Rancheria Tachi Yokut Tribe  
(559) 924-1278 ext 4011

---

**From:** Mary Baloian [mailto:mbaloian@appliedearthworks.com]  
**Sent:** Thursday, April 12, 2012 12:42 PM  
**To:** Hector Franco  
**Subject:** FW: PGE Sanger Substation Expansion Project

Dear Mr. Franco,

Applied Earthworks, Inc. (Æ) recently sent you a letter (dated March 7, 2012) informing you about the PG&E's Sanger Substation Expansion Project in Sanger, Ca. The project will include the replacement of nine breakers, 24 switches/disconnects, 18 structures, and the control building at the existing Sanger Substation, the construction of a new substation on an adjacent site approximately 9 acres in size, and the replacement of transmission poles on the adjacent property. Æ is currently providing cultural resource services in support of the project and have contacted the Native American Heritage Commission (NAHC) regarding the potential for sacred sites in the project area. The NAHC has provided your name as a person who may have knowledge of cultural resources in the project area. That is why we contacted you in March.



I am now following up to inquire whether you wish to comment on this project or are willing to share any information you may have regarding cultural resources (e.g., former village sites, traditional food gathering places, sacred sites, etc.) within the project area. If so, please don't hesitate to contact me by mail (see address above), email ([mbaloian@appliedearthworks.com](mailto:mbaloian@appliedearthworks.com)) or by phone (559 229 1856, Ext. 11). I would be most grateful for any information you might provide. Be assured that any locations of archaeological sites, cemeteries, or sacred places will be treated confidentially, as required by law, and not disclosed in any document available to the general public.

Thank you for your assistance,

***Mary Clark Baloian, Ph.D., RPA | Applied EarthWorks, Inc.  
Senior Archaeologist***

1391 W. Shaw Ave., Ste. C  
Fresno, CA 93711-3600  
559.229.1856 x-11 office  
559.801.1652 mobile



**D-2 – NAHC CORRESPONDENCE  
2015 LETTERS**





September 16, 2015

Kings River Choinumni Farm Tribe  
Stan Alec  
3515 East Fidora Avenue  
Fresno, CA 93726

Cardno

701 University Avenue  
Suite 200  
Sacramento, CA 95825  
USA

**RE: Pacific Gas & Electric Company's Sanger Substation Project, Fresno County, California**

Phone 916 923 1097  
Toll-free 800 368 7511  
Fax 916 923 6251  
www.cardno.com

Dear Stan Alec:

Cardno Inc. is currently providing cultural resource services in support of Pacific Gas & Electric Company's (PG&E) Sanger Substation Project, located west of the city of Sanger, Fresno County, California (see included map). The project will include the replacement of nine breakers, twenty-four switches/disconnects, eighteen structures, and the control building at the existing Sanger Substation. Due to congestion and lack of space inside the substation, and based on the major civil and electrical requirements of the breakers, structures, and switch replacement work, PG&E proposes to build a new substation on an adjacent location approximately nine acres in size. As part of these services, Cardno, Inc. requested a sacred lands search and list of individuals who may have knowledge of the cultural resources within the project area from the Native American Heritage Commission (NAHC). The sacred lands search did not indicate the presence of any areas of concern. Your name appears on the NAHC list of individuals who may know more about the cultural resources of the project area. Any information you have in this regard would greatly help our effort to identify all properties of concern for this project.

If you have information about cultural resources within the project area or any questions please write to:

Joshua Peabody  
Cardno, Inc.  
701 University Avenue, Suite 200  
Sacramento, CA 95825

Or email me at [Joshua.peabody@cardno.com](mailto:Joshua.peabody@cardno.com). You may also call me at (916)386-3826 if you have any questions.

Sincerely,

Joshua Peabody  
Senior Consultant/Cultural Resources Specialist  
for Cardno, Inc.  
Direct Line 916 386 3826  
Email: [joshua.peabody@cardno.com](mailto:joshua.peabody@cardno.com)

Writer: MR



September 16, 2015

Chowchilla Tribe of Yokuts  
Jerry Brown  
10553 N. Rice Road  
Fresno, CA 93730

Cardno

701 University Avenue  
Suite 200  
Sacramento, CA 95825  
USA

**RE: Pacific Gas & Electric Company's Sanger Substation Project, Fresno County, California**

Phone 916 923 1097  
Toll-free 800 368 7511  
Fax 916 923 6251  
www.cardno.com

Dear Jerry Brown:

Cardno Inc. is currently providing cultural resource services in support of Pacific Gas & Electric Company's (PG&E) Sanger Substation Project, located west of the city of Sanger, Fresno County, California (see included map). The project will include the replacement of nine breakers, twenty-four switches/disconnects, eighteen structures, and the control building at the existing Sanger Substation. Due to congestion and lack of space inside the substation, and based on the major civil and electrical requirements of the breakers, structures, and switch replacement work, PG&E proposes to build a new substation on an adjacent location approximately nine acres in size. As part of these services, Cardno, Inc. requested a sacred lands search and list of individuals who may have knowledge of the cultural resources within the project area from the Native American Heritage Commission (NAHC). The sacred lands search did not indicate the presence of any areas of concern. Your name appears on the NAHC list of individuals who may know more about the cultural resources of the project area. Any information you have in this regard would greatly help our effort to identify all properties of concern for this project.

If you have information about cultural resources within the project area or any questions please write to:

Joshua Peabody  
Cardno, Inc.  
701 University Avenue, Suite 200  
Sacramento, CA 95825

Or email me at [Joshua.peabody@cardno.com](mailto:Joshua.peabody@cardno.com). You may also call me at (916)386-3826 if you have any questions.

Sincerely,

Joshua Peabody  
Senior Consultant/Cultural Resources Specialist  
for Cardno, Inc.  
Direct Line 916 386 3826  
Email: [joshua.peabody@cardno.com](mailto:joshua.peabody@cardno.com)

Writer: MR



September 16, 2015

Dunlap Band of Mono Indians  
Benjamin Charley Sr., Chairperson  
P.O. Box 45  
Dunlap, CA 93621

Cardno

701 University Avenue  
Suite 200  
Sacramento, CA 95825  
USA

**RE: Pacific Gas & Electric Company's Sanger Substation Project, Fresno County, California**

Phone 916 923 1097  
Toll-free 800 368 7511  
Fax 916 923 6251  
www.cardno.com

Dear Chairperson Charley:

Cardno Inc. is currently providing cultural resource services in support of Pacific Gas & Electric Company's (PG&E) Sanger Substation Project, located west of the city of Sanger, Fresno County, California (see included map). The project will include the replacement of nine breakers, twenty-four switches/disconnects, eighteen structures, and the control building at the existing Sanger Substation. Due to congestion and lack of space inside the substation, and based on the major civil and electrical requirements of the breakers, structures, and switch replacement work, PG&E proposes to build a new substation on an adjacent location approximately nine acres in size. As part of these services, Cardno, Inc. requested a sacred lands search and list of individuals who may have knowledge of the cultural resources within the project area from the Native American Heritage Commission (NAHC). The sacred lands search did not indicate the presence of any areas of concern. Your name appears on the NAHC list of individuals who may know more about the cultural resources of the project area. Any information you have in this regard would greatly help our effort to identify all properties of concern for this project.

If you have information about cultural resources within the project area or any questions please write to:

Joshua Peabody  
Cardno, Inc.  
701 University Avenue, Suite 200  
Sacramento, CA 95825

Or email me at [Joshua.peabody@cardno.com](mailto:Joshua.peabody@cardno.com). You may also call me at (916)386-3826 if you have any questions.

Sincerely,

Joshua Peabody  
Senior Consultant/Cultural Resources Specialist  
for Cardno, Inc.  
Direct Line 916 386 3826  
Email: [joshua.peabody@cardno.com](mailto:joshua.peabody@cardno.com)

Writer: MR



September 16, 2015

Cold Springs Rancheria of Mono Indians  
Tribal Administrator  
P.O. Box 209  
Tollhouse, CA 93667

Cardno

701 University Avenue  
Suite 200  
Sacramento, CA 95825  
USA

**RE: Pacific Gas & Electric Company's Sanger Substation Project, Fresno County, California**

Phone 916 923 1097  
Toll-free 800 368 7511  
Fax 916 923 6251  
www.cardno.com

Dear Tribal Administrator:

Cardno Inc. is currently providing cultural resource services in support of Pacific Gas & Electric Company's (PG&E) Sanger Substation Project, located west of the city of Sanger, Fresno County, California (see included map). The project will include the replacement of nine breakers, twenty-four switches/disconnects, eighteen structures, and the control building at the existing Sanger Substation. Due to congestion and lack of space inside the substation, and based on the major civil and electrical requirements of the breakers, structures, and switch replacement work, PG&E proposes to build a new substation on an adjacent location approximately nine acres in size. As part of these services, Cardno, Inc. requested a sacred lands search and list of individuals who may have knowledge of the cultural resources within the project area from the Native American Heritage Commission (NAHC). The sacred lands search did not indicate the presence of any areas of concern. Your name appears on the NAHC list of individuals who may know more about the cultural resources of the project area. Any information you have in this regard would greatly help our effort to identify all properties of concern for this project.

If you have information about cultural resources within the project area or any questions please write to:

Joshua Peabody  
Cardno, Inc.  
701 University Avenue, Suite 200  
Sacramento, CA 95825

Or email me at [Joshua.peabody@cardno.com](mailto:Joshua.peabody@cardno.com). You may also call me at (916)386-3826 if you have any questions.

Sincerely,

Joshua Peabody  
Senior Consultant/Cultural Resources Specialist  
for Cardno, Inc.  
Direct Line 916 386 3826  
Email: [joshua.peabody@cardno.com](mailto:joshua.peabody@cardno.com)

Writer: MR





September 16, 2015

Dunlap Band of Mono Indians  
Florence Dick, Tribal Secretary  
P.O. Box 344  
Dunlap, CA 93621

Cardno

701 University Avenue  
Suite 200  
Sacramento, CA 95825  
USA

**RE: Pacific Gas & Electric Company's Sanger Substation Project, Fresno County, California**

Phone 916 923 1097  
Toll-free 800 368 7511  
Fax 916 923 6251  
[www.cardno.com](http://www.cardno.com)

Dear Florence Dick:

Cardno Inc. is currently providing cultural resource services in support of Pacific Gas & Electric Company's (PG&E) Sanger Substation Project, located west of the city of Sanger, Fresno County, California (see included map). The project will include the replacement of nine breakers, twenty-four switches/disconnects, eighteen structures, and the control building at the existing Sanger Substation. Due to congestion and lack of space inside the substation, and based on the major civil and electrical requirements of the breakers, structures, and switch replacement work, PG&E proposes to build a new substation on an adjacent location approximately nine acres in size. As part of these services, Cardno, Inc. requested a sacred lands search and list of individuals who may have knowledge of the cultural resources within the project area from the Native American Heritage Commission (NAHC). The sacred lands search did not indicate the presence of any areas of concern. Your name appears on the NAHC list of individuals who may know more about the cultural resources of the project area. Any information you have in this regard would greatly help our effort to identify all properties of concern for this project.

If you have information about cultural resources within the project area or any questions please write to:

Joshua Peabody  
Cardno, Inc.  
701 University Avenue, Suite 200  
Sacramento, CA 95825

Or email me at [Joshua.peabody@cardno.com](mailto:Joshua.peabody@cardno.com). You may also call me at (916)386-3826 if you have any questions.

Sincerely,

Joshua Peabody  
Senior Consultant/Cultural Resources Specialist  
for Cardno, Inc.  
Direct Line 916 386 3826  
Email: [joshua.peabody@cardno.com](mailto:joshua.peabody@cardno.com)

Writer: MR



September 16, 2015

North Fork Mono Tribe  
Ron Goode, Chairperson  
13396 Tollhouse Road  
Clovis, CA 93619

Cardno

701 University Avenue  
Suite 200  
Sacramento, CA 95825  
USA

**RE: Pacific Gas & Electric Company's Sanger Substation Project, Fresno County, California**

Phone 916 923 1097  
Toll-free 800 368 7511  
Fax 916 923 6251  
[www.cardno.com](http://www.cardno.com)

Dear Chairperson Goode:

Cardno Inc. is currently providing cultural resource services in support of Pacific Gas & Electric Company's (PG&E) Sanger Substation Project, located west of the city of Sanger, Fresno County, California (see included map). The project will include the replacement of nine breakers, twenty-four switches/disconnects, eighteen structures, and the control building at the existing Sanger Substation. Due to congestion and lack of space inside the substation, and based on the major civil and electrical requirements of the breakers, structures, and switch replacement work, PG&E proposes to build a new substation on an adjacent location approximately nine acres in size. As part of these services, Cardno, Inc. requested a sacred lands search and list of individuals who may have knowledge of the cultural resources within the project area from the Native American Heritage Commission (NAHC). The sacred lands search did not indicate the presence of any areas of concern. Your name appears on the NAHC list of individuals who may know more about the cultural resources of the project area. Any information you have in this regard would greatly help our effort to identify all properties of concern for this project.

If you have information about cultural resources within the project area or any questions please write to:

Joshua Peabody  
Cardno, Inc.  
701 University Avenue, Suite 200  
Sacramento, CA 95825

Or email me at [Joshua.peabody@cardno.com](mailto:Joshua.peabody@cardno.com). You may also call me at (916)386-3826 if you have any questions.

Sincerely,

Joshua Peabody  
Senior Consultant/Cultural Resources Specialist  
for Cardno, Inc.  
Direct Line 916 386 3826  
Email: [joshua.peabody@cardno.com](mailto:joshua.peabody@cardno.com)

Writer: MR



September 16, 2015

Dumna Wo-Wah Tribal Government  
John Ledger, Assistant Cultural Resource Manager  
2216 East Hammond Street  
Fresno, CA 93602 (or 93703)

Cardno

701 University Avenue  
Suite 200  
Sacramento, CA 95825  
USA

**RE: Pacific Gas & Electric Company's Sanger Substation Project, Fresno County, California**

Phone 916 923 1097  
Toll-free 800 368 7511  
Fax 916 923 6251  
[www.cardno.com](http://www.cardno.com)

Dear John Ledger:

Cardno Inc. is currently providing cultural resource services in support of Pacific Gas & Electric Company's (PG&E) Sanger Substation Project, located west of the city of Sanger, Fresno County, California (see included map). The project will include the replacement of nine breakers, twenty-four switches/disconnects, eighteen structures, and the control building at the existing Sanger Substation. Due to congestion and lack of space inside the substation, and based on the major civil and electrical requirements of the breakers, structures, and switch replacement work, PG&E proposes to build a new substation on an adjacent location approximately nine acres in size. As part of these services, Cardno, Inc. requested a sacred lands search and list of individuals who may have knowledge of the cultural resources within the project area from the Native American Heritage Commission (NAHC). The sacred lands search did not indicate the presence of any areas of concern. Your name appears on the NAHC list of individuals who may know more about the cultural resources of the project area. Any information you have in this regard would greatly help our effort to identify all properties of concern for this project.

If you have information about cultural resources within the project area or any questions please write to:

Joshua Peabody  
Cardno, Inc.  
701 University Avenue, Suite 200  
Sacramento, CA 95825

Or email me at [Joshua.peabody@cardno.com](mailto:Joshua.peabody@cardno.com). You may also call me at (916)386-3826 if you have any questions.

Sincerely,

Joshua Peabody  
Senior Consultant/Cultural Resources Specialist  
for Cardno, Inc.  
Direct Line 916 386 3826  
Email: [joshua.peabody@cardno.com](mailto:joshua.peabody@cardno.com)

Writer: MR



September 16, 2015

Cold Springs Rancheria of Mono Indians  
Jeffrey Lee, Chairperson  
P.O. Box 209  
Tollhouse, CA 93667

Cardno

701 University Avenue  
Suite 200  
Sacramento, CA 95825  
USA

**RE: Pacific Gas & Electric Company's Sanger Substation Project, Fresno County, California**

Phone 916 923 1097  
Toll-free 800 368 7511  
Fax 916 923 6251  
[www.cardno.com](http://www.cardno.com)

Dear Chairperson Lee:

Cardno Inc. is currently providing cultural resource services in support of Pacific Gas & Electric Company's (PG&E) Sanger Substation Project, located west of the city of Sanger, Fresno County, California (see included map). The project will include the replacement of nine breakers, twenty-four switches/disconnects, eighteen structures, and the control building at the existing Sanger Substation. Due to congestion and lack of space inside the substation, and based on the major civil and electrical requirements of the breakers, structures, and switch replacement work, PG&E proposes to build a new substation on an adjacent location approximately nine acres in size. As part of these services, Cardno, Inc. requested a sacred lands search and list of individuals who may have knowledge of the cultural resources within the project area from the Native American Heritage Commission (NAHC). The sacred lands search did not indicate the presence of any areas of concern. Your name appears on the NAHC list of individuals who may know more about the cultural resources of the project area. Any information you have in this regard would greatly help our effort to identify all properties of concern for this project.

If you have information about cultural resources within the project area or any questions please write to:

Joshua Peabody  
Cardno, Inc.  
701 University Avenue, Suite 200  
Sacramento, CA 95825

Or email me at [Joshua.peabody@cardno.com](mailto:Joshua.peabody@cardno.com). You may also call me at (916)386-3826 if you have any questions.

Sincerely,

Joshua Peabody  
Senior Consultant/Cultural Resources Specialist  
for Cardno, Inc.  
Direct Line 916 386 3826  
Email: [joshua.peabody@cardno.com](mailto:joshua.peabody@cardno.com)

Writer: MR



September 16, 2015

Picayune Rancheria of Chukchansi  
Reggie Lewis, Chairperson  
8080 Palm Avenue, Suite 207  
Fresno, CA 93711

Cardno

701 University Avenue  
Suite 200  
Sacramento, CA 95825  
USA

**RE: Pacific Gas & Electric Company's Sanger Substation Project, Fresno County, California**

Phone 916 923 1097  
Toll-free 800 368 7511  
Fax 916 923 6251  
[www.cardno.com](http://www.cardno.com)

Dear Chairperson Lewis:

Cardno Inc. is currently providing cultural resource services in support of Pacific Gas & Electric Company's (PG&E) Sanger Substation Project, located west of the city of Sanger, Fresno County, California (see included map). The project will include the replacement of nine breakers, twenty-four switches/disconnects, eighteen structures, and the control building at the existing Sanger Substation. Due to congestion and lack of space inside the substation, and based on the major civil and electrical requirements of the breakers, structures, and switch replacement work, PG&E proposes to build a new substation on an adjacent location approximately nine acres in size. As part of these services, Cardno, Inc. requested a sacred lands search and list of individuals who may have knowledge of the cultural resources within the project area from the Native American Heritage Commission (NAHC). The sacred lands search did not indicate the presence of any areas of concern. Your name appears on the NAHC list of individuals who may know more about the cultural resources of the project area. Any information you have in this regard would greatly help our effort to identify all properties of concern for this project.

If you have information about cultural resources within the project area or any questions please write to:

Joshua Peabody  
Cardno, Inc.  
701 University Avenue, Suite 200  
Sacramento, CA 95825

Or email me at [Joshua.peabody@cardno.com](mailto:Joshua.peabody@cardno.com). You may also call me at (916)386-3826 if you have any questions.

Sincerely,

Joshua Peabody  
Senior Consultant/Cultural Resources Specialist  
for Cardno, Inc.  
Direct Line 916 386 3826  
Email: [joshua.peabody@cardno.com](mailto:joshua.peabody@cardno.com)

Writer: MR



September 16, 2015

Picayune Rancheria of Chukchansi  
Mary Matola, THPO  
8080 Palm Avenue, Suite 207  
Fresno, CA 93711

Cardno

701 University Avenue  
Suite 200  
Sacramento, CA 95825  
USA

**RE: Pacific Gas & Electric Company's Sanger Substation Project, Fresno County, California**

Phone 916 923 1097  
Toll-free 800 368 7511  
Fax 916 923 6251  
[www.cardno.com](http://www.cardno.com)

Dear THPO Matola:

Cardno Inc. is currently providing cultural resource services in support of Pacific Gas & Electric Company's (PG&E) Sanger Substation Project, located west of the city of Sanger, Fresno County, California (see included map). The project will include the replacement of nine breakers, twenty-four switches/disconnects, eighteen structures, and the control building at the existing Sanger Substation. Due to congestion and lack of space inside the substation, and based on the major civil and electrical requirements of the breakers, structures, and switch replacement work, PG&E proposes to build a new substation on an adjacent location approximately nine acres in size. As part of these services, Cardno, Inc. requested a sacred lands search and list of individuals who may have knowledge of the cultural resources within the project area from the Native American Heritage Commission (NAHC). The sacred lands search did not indicate the presence of any areas of concern. Your name appears on the NAHC list of individuals who may know more about the cultural resources of the project area. Any information you have in this regard would greatly help our effort to identify all properties of concern for this project.

If you have information about cultural resources within the project area or any questions please write to:

Joshua Peabody  
Cardno, Inc.  
701 University Avenue, Suite 200  
Sacramento, CA 95825

Or email me at [Joshua.peabody@cardno.com](mailto:Joshua.peabody@cardno.com). You may also call me at (916)386-3826 if you have any questions.

Sincerely,

Joshua Peabody  
Senior Consultant/Cultural Resources Specialist  
for Cardno, Inc.  
Direct Line 916 386 3826  
Email: [joshua.peabody@cardno.com](mailto:joshua.peabody@cardno.com)

Writer: MR



September 16, 2015

Table Mountain Rancheria  
Michael Russell, Tribal Administrator  
P.O. Box 410  
Friant, CA 93626

Cardno

701 University Avenue  
Suite 200  
Sacramento, CA 95825  
USA

**RE: Pacific Gas & Electric Company's Sanger Substation Project, Fresno County, California**

Phone 916 923 1097  
Toll-free 800 368 7511  
Fax 916 923 6251  
[www.cardno.com](http://www.cardno.com)

Dear Michael Russell:

Cardno Inc. is currently providing cultural resource services in support of Pacific Gas & Electric Company's (PG&E) Sanger Substation Project, located west of the city of Sanger, Fresno County, California (see included map). The project will include the replacement of nine breakers, twenty-four switches/disconnects, eighteen structures, and the control building at the existing Sanger Substation. Due to congestion and lack of space inside the substation, and based on the major civil and electrical requirements of the breakers, structures, and switch replacement work, PG&E proposes to build a new substation on an adjacent location approximately nine acres in size. As part of these services, Cardno, Inc. requested a sacred lands search and list of individuals who may have knowledge of the cultural resources within the project area from the Native American Heritage Commission (NAHC). The sacred lands search did not indicate the presence of any areas of concern. Your name appears on the NAHC list of individuals who may know more about the cultural resources of the project area. Any information you have in this regard would greatly help our effort to identify all properties of concern for this project.

If you have information about cultural resources within the project area or any questions please write to:

Joshua Peabody  
Cardno, Inc.  
701 University Avenue, Suite 200  
Sacramento, CA 95825

Or email me at [Joshua.peabody@cardno.com](mailto:Joshua.peabody@cardno.com). You may also call me at (916)386-3826 if you have any questions.

Sincerely,

Joshua Peabody  
Senior Consultant/Cultural Resources Specialist  
for Cardno, Inc.  
Direct Line 916 386 3826  
Email: [joshua.peabody@cardno.com](mailto:joshua.peabody@cardno.com)

Writer: MR



September 16, 2015

Dumna Wo-Wah Tribal Government  
Eric Smith, Cultural Resource Manager  
2216 East Hammond Street  
Fresno, CA 93602 (or 93703)

Cardno

701 University Avenue  
Suite 200  
Sacramento, CA 95825  
USA

**RE: Pacific Gas & Electric Company's Sanger Substation Project, Fresno County, California**

Phone 916 923 1097  
Toll-free 800 368 7511  
Fax 916 923 6251  
[www.cardno.com](http://www.cardno.com)

Dear Eric Smith:

Cardno Inc. is currently providing cultural resource services in support of Pacific Gas & Electric Company's (PG&E) Sanger Substation Project, located west of the city of Sanger, Fresno County, California (see included map). The project will include the replacement of nine breakers, twenty-four switches/disconnects, eighteen structures, and the control building at the existing Sanger Substation. Due to congestion and lack of space inside the substation, and based on the major civil and electrical requirements of the breakers, structures, and switch replacement work, PG&E proposes to build a new substation on an adjacent location approximately nine acres in size. As part of these services, Cardno, Inc. requested a sacred lands search and list of individuals who may have knowledge of the cultural resources within the project area from the Native American Heritage Commission (NAHC). The sacred lands search did not indicate the presence of any areas of concern. Your name appears on the NAHC list of individuals who may know more about the cultural resources of the project area. Any information you have in this regard would greatly help our effort to identify all properties of concern for this project.

If you have information about cultural resources within the project area or any questions please write to:

Joshua Peabody  
Cardno, Inc.  
701 University Avenue, Suite 200  
Sacramento, CA 95825

Or email me at [Joshua.peabody@cardno.com](mailto:Joshua.peabody@cardno.com). You may also call me at (916)386-3826 if you have any questions.

Sincerely,

Joshua Peabody  
Senior Consultant/Cultural Resources Specialist  
for Cardno, Inc.  
Direct Line 916 386 3826  
Email: [joshua.peabody@cardno.com](mailto:joshua.peabody@cardno.com)

Writer: MR





September 16, 2015

Cold Springs Rancheria of Mono Indians  
Jamie Smith, Environmental Coordinator  
P.O. Box 209  
Tollhouse, CA 93667

Cardno

701 University Avenue  
Suite 200  
Sacramento, CA 95825  
USA

**RE: Pacific Gas & Electric Company's Sanger Substation Project, Fresno County, California**

Phone 916 923 1097  
Toll-free 800 368 7511  
Fax 916 923 6251  
[www.cardno.com](http://www.cardno.com)

Dear Jamie Smith:

Cardno Inc. is currently providing cultural resource services in support of Pacific Gas & Electric Company's (PG&E) Sanger Substation Project, located west of the city of Sanger, Fresno County, California (see included map). The project will include the replacement of nine breakers, twenty-four switches/disconnects, eighteen structures, and the control building at the existing Sanger Substation. Due to congestion and lack of space inside the substation, and based on the major civil and electrical requirements of the breakers, structures, and switch replacement work, PG&E proposes to build a new substation on an adjacent location approximately nine acres in size. As part of these services, Cardno, Inc. requested a sacred lands search and list of individuals who may have knowledge of the cultural resources within the project area from the Native American Heritage Commission (NAHC). The sacred lands search did not indicate the presence of any areas of concern. Your name appears on the NAHC list of individuals who may know more about the cultural resources of the project area. Any information you have in this regard would greatly help our effort to identify all properties of concern for this project.

If you have information about cultural resources within the project area or any questions please write to:

Joshua Peabody  
Cardno, Inc.  
701 University Avenue, Suite 200  
Sacramento, CA 95825

Or email me at [Joshua.peabody@cardno.com](mailto:Joshua.peabody@cardno.com). You may also call me at (916)386-3826 if you have any questions.

Sincerely,

Joshua Peabody  
Senior Consultant/Cultural Resources Specialist  
for Cardno, Inc.  
Direct Line 916 386 3826  
Email: [joshua.peabody@cardno.com](mailto:joshua.peabody@cardno.com)

Writer: MR



September 16, 2015

Dunlap Band of Mono Indians  
Jeneen Tex, Chief Executive Officer  
P.O. Box 44  
Dunlap, CA 93621

Cardno

701 University Avenue  
Suite 200  
Sacramento, CA 95825  
USA

**RE: Pacific Gas & Electric Company's Sanger Substation Project, Fresno County, California**

Phone 916 923 1097  
Toll-free 800 368 7511  
Fax 916 923 6251  
[www.cardno.com](http://www.cardno.com)

Dear Jeneen Tex:

Cardno Inc. is currently providing cultural resource services in support of Pacific Gas & Electric Company's (PG&E) Sanger Substation Project, located west of the city of Sanger, Fresno County, California (see included map). The project will include the replacement of nine breakers, twenty-four switches/disconnects, eighteen structures, and the control building at the existing Sanger Substation. Due to congestion and lack of space inside the substation, and based on the major civil and electrical requirements of the breakers, structures, and switch replacement work, PG&E proposes to build a new substation on an adjacent location approximately nine acres in size. As part of these services, Cardno, Inc. requested a sacred lands search and list of individuals who may have knowledge of the cultural resources within the project area from the Native American Heritage Commission (NAHC). The sacred lands search did not indicate the presence of any areas of concern. Your name appears on the NAHC list of individuals who may know more about the cultural resources of the project area. Any information you have in this regard would greatly help our effort to identify all properties of concern for this project.

If you have information about cultural resources within the project area or any questions please write to:

Joshua Peabody  
Cardno, Inc.  
701 University Avenue, Suite 200  
Sacramento, CA 95825

Or email me at [Joshua.peabody@cardno.com](mailto:Joshua.peabody@cardno.com). You may also call me at (916)386-3826 if you have any questions.

Sincerely,

Joshua Peabody  
Senior Consultant/Cultural Resources Specialist  
for Cardno, Inc.  
Direct Line 916 386 3826  
Email: [joshua.peabody@cardno.com](mailto:joshua.peabody@cardno.com)

Writer: MR



September 16, 2015

Table Mountain Rancheria  
Leanne Walker-Grant, Chairperson  
P.O. Box 410  
Friant, CA 93626

Cardno

701 University Avenue  
Suite 200  
Sacramento, CA 95825  
USA

**RE: Pacific Gas & Electric Company's Sanger Substation Project, Fresno County, California**

Phone 916 923 1097  
Toll-free 800 368 7511  
Fax 916 923 6251  
[www.cardno.com](http://www.cardno.com)

Dear Chairperson Walker-Grant:

Cardno Inc. is currently providing cultural resource services in support of Pacific Gas & Electric Company's (PG&E) Sanger Substation Project, located west of the city of Sanger, Fresno County, California (see included map). The project will include the replacement of nine breakers, twenty-four switches/disconnects, eighteen structures, and the control building at the existing Sanger Substation. Due to congestion and lack of space inside the substation, and based on the major civil and electrical requirements of the breakers, structures, and switch replacement work, PG&E proposes to build a new substation on an adjacent location approximately nine acres in size. As part of these services, Cardno, Inc. requested a sacred lands search and list of individuals who may have knowledge of the cultural resources within the project area from the Native American Heritage Commission (NAHC). The sacred lands search did not indicate the presence of any areas of concern. Your name appears on the NAHC list of individuals who may know more about the cultural resources of the project area. Any information you have in this regard would greatly help our effort to identify all properties of concern for this project.

If you have information about cultural resources within the project area or any questions please write to:

Joshua Peabody  
Cardno, Inc.  
701 University Avenue, Suite 200  
Sacramento, CA 95825

Or email me at [Joshua.peabody@cardno.com](mailto:Joshua.peabody@cardno.com). You may also call me at (916)386-3826 if you have any questions.

Sincerely,

Joshua Peabody  
Senior Consultant/Cultural Resources Specialist  
for Cardno, Inc.  
Direct Line 916 386 3826  
Email: [joshua.peabody@cardno.com](mailto:joshua.peabody@cardno.com)

Writer: MR

