

PUBLIC UTILITIES COMMISSION

505 VAN NESS AVENUE
SAN FRANCISCO, CA 94102-3298



October 21, 2016

Richard Quasarano
Compliance Manager
San Diego Gas & Electric Company
8330 Century Park Court, CP31F
San Diego, CA 92123

Subject: Salt Creek Substation—Review of Minor Project Refinement Request #5

Dear Mr. Quasarano,

The California Public Utilities Commission (CPUC) has reviewed San Diego Gas and Electric Company's (SDG&E's) proposed Minor Project Refinement (MPR) Request #5 for the approved Salt Creek Substation Project (project), provided by email on October 20, 2016. The CPUC adopted the Final Environmental Impact Report (FEIR) and approved the Environmentally Superior Alternative, Alternative 2 – Salt Creek Substation on May 12, 2016. SDG&E's request for an MPR has been reviewed, consistent with the requirements specified in the Mitigation Monitoring Reporting Program and Mitigation Monitoring Compliance and Reporting Program for the project.

SDG&E's Proposed Minor Project Refinement #5

On October 20, 2016, SDG&E submitted a request for MPR #5 to the CPUC. MRP#5 would modify the approved MPR #1 by changing the fire service lateral line location to improve the structural stability of the line. The new proposed location of the fire service lateral line is approximately 100 feet northeast of the originally proposed location that was approved through MPR #1. The new location crosses the property boundary closer to the transmission corridor within the installed temporary construction fence. The new total length of the fire water service lateral would be 191 feet. Approximately 45 feet of the fire water service lateral would be trenched outside of the property (30 feet would be trenched in asphalt on Hunte Parkway and 15 feet would be trenched in the landscaped parkway adjacent to Hunte Parkway) and 146 feet would be trenched inside the property (131 feet would be trenched in the landscaped slope and 15 feet would be trenched in concrete). The trench width would be 3 feet for a total trenched area of approximately 573 square feet. The approximate construction duration for the fire water service lateral would be 6 days.

CPUC Review of Minor Project Refinement #5

The proposed actions were reviewed for consistency with the impact analysis contained in the adopted Final Environmental Impact Report (FEIR) prepared for the project. A review form and

SDG&E's request are attached to this letter. Table 1 below provides CPUC's evaluation of whether the proposed refinement would result in a new impact, or increase the severity of any impact that was previously analyzed in the FEIR.

Conclusion

MPR #5 would not result in a new impact or increase the severity of a previously analyzed impact; therefore, no supplemental or subsequent CEQA review is required to address MPR #5. The actions proposed in MPR #5 are consistent with the CPUC approved FEIR.

Please contact me at will.maguire@cpuc.ca.gov if you have any questions regarding this review of MPR #5.

Sincerely,

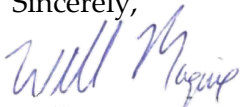

Will Maguire

Project Manager

Energy Division, CEQA Unit

cc: Susanne Heim, Panorama Environmental
Sheila Hoyer, Panorama Environmental

Attachment A: Minor Project Refinement #5 Review Form

Attachment B: SDG&E Minor Project Refinement Request for Change in Location of Fire Lateral Service Line (MPR Request #5)

Table 1 CPUC Evaluation of Minor Project Refinement #5

Would the Proposed Project refinement result in a new impact, or increase the severity of a previously analyzed impact to:	No	Yes
Aesthetics (e.g., damage scenic resources or vistas, degrade the existing visual character of the site and its surroundings, or create sources of light or glare)? <i>Final EIR Significance: Significant and Unavoidable</i>	<input checked="" type="checkbox"/>	<input type="checkbox"/>
Summary of Proposed Project Refinement Impacts on Aesthetics: The proposed refinement would not increase the impact to the visual quality of the area. The fire service lateral would be located underground. The relocation of the fire service lateral line would not result in a new impact or increase the severity of a previously analyzed impact on aesthetics.		
Agriculture and Forestry Resources (e.g., convert Farmland to nonagricultural use, or create a conflict with existing agricultural zoning or a Williamson Act)? <i>Final EIR Significance: Less than Significant</i>	<input checked="" type="checkbox"/>	<input type="checkbox"/>
Summary of Proposed Project Refinement Impacts on Agriculture and Forestry Resources: The proposed refinement would not convert agricultural land to non-agricultural use or result in the loss of agricultural land. The refinement is located within Hunte Parkway and in the area that was purchased by SDG&E for construction of the substation. This area is not subject to agricultural use. The proposed refinement would not result in a new impact or increase the severity of a previously analyzed impact on agriculture or forestry resources.		
Air Quality (e.g., produce criteria air pollutant emissions, or expose sensitive receptors to additional pollutants)? <i>Final EIR Significance: Less than Significant with Mitigation</i>	<input checked="" type="checkbox"/>	<input type="checkbox"/>
Summary of Proposed Project Refinement Impacts on Air Quality: The proposed refinement would increase the area of disturbance by 0.01 acre and involve trenching in an area adjacent to the previously analyzed area of disturbance. Trenching for installation of the fire service lateral line was previously considered in the EIR. APM Air-1 and Mitigation Measure Air-1 would reduce the impact on air quality to a less-than-significant level. The proposed refinement would not result in a new impact or increase the severity of a previously analyzed impact on air quality.		
Biological Resources (e.g., have an adverse effect on sensitive or special-status species; impact riparian, wetland, or any other sensitive habitat; or conflict with local policies or ordinances protecting biological resources)? <i>Final EIR Significance: Less than Significant with Mitigation</i>	<input checked="" type="checkbox"/>	<input type="checkbox"/>
Summary of Proposed Project Refinement Impacts on Biological Resources: The proposed refinement would involve temporary disturbance in an area containing landscaped vegetation (i.e., ice plant) and the biological resources in the proposed refinement area are consistent with the biological resources in the area of disturbance considered in the EIR. The refinement would not result in a new impact or increase the severity of a previously analyzed impact on biological resources.		

Would the Proposed Project refinement result in a new impact, or increase the severity of a previously analyzed impact to: No Yes

Cultural and Paleontological Resources (e.g., cause an adverse change to a significant historical, archeological, or paleontological resource)?

Final EIR Significance: Less than Significant with Mitigation

Summary of Proposed Project Refinement Impacts on Cultural and Paleontological Resources:

No cultural or paleontological resources have been recorded within the proposed refinement area. The proposed refinement would involve temporary ground disturbance in a new area of 0.01 acre. Cultural or paleontological resources could be encountered in this area; however, APM CUL-2, CUL-5, and CUL-7, and Mitigation Measure Cultural-1 would reduce the impact on cultural resources to less than significant. The proposed refinement would not result in a new impact or increase the severity of a previously analyzed impact on cultural or paleontological resources.

Geology and Soils (e.g., cause or expose people or structures to geologic or soil hazards, including erosion or loss of topsoil)?

Final EIR Significance: Less than Significant with Mitigation

Summary of Proposed Project Refinement Impacts on Geology and Soils:

The proposed refinement would increase ground disturbance by 0.01 acre. Impacts from erosion were considered in the Final EIR and implementation of the CPUC-approved Stormwater Pollution Prevention Plan (SWPPP) would reduce impacts from the proposed refinement to a less-than-significant level. The proposed refinement would occur in areas containing the same underlying geologic and soil units as the remaining substation parcel. Impacts on these geologic resources were analyzed in the Final EIR. The proposed refinement would not result in a new impact or increase the severity of a previously analyzed impact on geology and soils.

Greenhouse Gas Emissions (e.g., produce criteria greenhouse gas pollutants, or expose sensitive receptors to additional pollutants)?

FEIR Significance: Less than Significant with Mitigation

Summary of Proposed Project Refinement Impacts on Greenhouse Gas Emissions:

The level of equipment use and number of vehicle trips required for the proposed refinement would be consistent with the equipment use and vehicle trip estimates included in the Final EIR. The proposed refinement would not result in a new impact or increase the severity of a previously analyzed impact on greenhouse gas emissions.

Hazards and Hazardous Materials (e.g., create or increase the exposure of people or structures to hazardous materials, involve the use of additional hazardous materials or equipment, or interfere with an adopted emergency plan)?

Final EIR Significance: Less than Significant with Mitigation

Summary of Proposed Project Refinement Impacts on Hazards and Hazardous Materials:

The proposed refinement would require use of the same types of equipment and hazardous materials that were analyzed in the Final EIR. The refinement area does not contain known hazardous materials sites. The proposed refinement would not result in a new impact or increase the severity of a previously analyzed impact on hazards and hazardous materials.

Would the Proposed Project refinement result in a new impact, or increase the severity of a previously analyzed impact to:	No	Yes
Hydrology and Water Quality (e.g., degrade water quality, discharge waste or sediment, deplete groundwater, alter the existing drainage pattern, create additional runoff water or polluted runoff, place structures in a 100-year flood hazard area, or expose people or structures to a significant risk involving flooding)?	<input checked="" type="checkbox"/>	<input type="checkbox"/>
<i>Final EIR Significance: Less than Significant with Mitigation</i>		

Summary of Proposed Project Refinement Impacts on Hydrology and Water Quality:

The proposed refinement would increase ground disturbance by 0.01 acre. The proposed refinement would occur adjacent to the substation site and would drain to the same water bodies as the substation. Impacts to these water bodies were analyzed in the Final EIR. Implementation of the measures contained in the CPUC-approved SWPPP would reduce impacts to a less-than-significant level. The proposed refinement would not result in a new impact or increase the severity of a previously analyzed impact on hydrology and water quality.

Land Use and Planning (e.g., conflict with a land use plan, policy, or regulation of an agency with jurisdiction over the project, or conflict with a habitat conservation plan)?	<input checked="" type="checkbox"/>	<input type="checkbox"/>
<i>Final EIR Significance: No Impact</i>		

Summary of Proposed Project Refinement Impacts on Land Use and Planning:

The proposed refinement would occur within the substation parcel, which is owned by SDG&E. The proposed refinement would have no impact on land use and planning.

Noise (e.g., expose sensitive receptors to additional noise or vibration)?	<input checked="" type="checkbox"/>	<input type="checkbox"/>
<i>Final EIR Significance: Significant and Unavoidable</i>		

Summary of Proposed Project Refinement Impacts on Noise:

The refinement would not affect the distance between construction activities and the nearest sensitive receptors or change the equipment that would be used during construction. The calculated construction noise levels presented in the Final EIR are not affected by the proposed refinement. The proposed refinement would not result in a new impact or increase the severity of a previously analyzed impact on noise.

Public Services (e.g., result in adverse impacts on government facilities that provide a public service)?	<input checked="" type="checkbox"/>	<input type="checkbox"/>
<i>Final EIR Significance: Less than Significant</i>		

Summary of Proposed Project Refinement Impacts on Public Services:

The proposed refinement would not require any public services. The proposed refinement would not result in a new impact or increase the severity of a previously analyzed impact on public services.

Recreation (e.g., increase the use of, or cause adverse effects on, parks or other recreational facilities)?	<input checked="" type="checkbox"/>	<input type="checkbox"/>
<i>Final EIR Significance: Significant and Unavoidable</i>		

Summary of Proposed Project Refinement Impact on Recreation:

The proposed refinement would not affect the duration of construction in vicinity of a recreational resource. Closure and trenching across the Hunte Parkway trail was previously analyzed in the Final EIR. APM REC-1 requires temporary trail detours and MM Recreation-1 provides for restoration of trails to pre-construction levels. The proposed refinement would not result in a new impact or increase the severity of a previously analyzed impact on recreation.

Would the Proposed Project refinement result in a new impact, or increase the severity of a previously analyzed impact to:

No Yes

Transportation and Traffic (e.g., increase traffic congestion or degrade performance of the circulation system, taking into account all modes of transportation, or increase hazards due to a design feature)?

Final EIR Significance: Less than Significant with Mitigation

Summary of Proposed Project Refinement Impacts on Transportation and Traffic:

The proposed refinement would not change the roadways used to access project work area or the number of vehicles required to construct or maintain the project. The proposed refinement would not result in a new impact or increase the severity of a previously analyzed impact on transportation and traffic.

Utilities and result in the construction of new or expansion of existing water or stormwater drainage facilities, require additional water entitlements, create new solid waste disposal needs

Final EIR Significance: Less than Significant with Mitigation

Summary of Proposed Project Refinement Impacts on Utilities and Service Systems:

Potential conflicts with underlying or neighboring utilities would be the same as the potential conflicts with underground utilities considered in the Final EIR. APM UTIL-1 and MM Utilities-1 require notification of utilities to mark the location of underground utilities. MM Hazards-1 require excavating to the top of any buried utilities that are located within 10 feet of a proposed excavation. The proposed refinement would not result in a new impact or increase the severity of a previously analyzed impact on utilities and public services.

ATTACHMENT A

Minor Project Refinement Review Form

PUBLIC UTILITIES COMMISSION

505 VAN NESS AVENUE
SAN FRANCISCO, CA 94102-3298



Proposed Minor Project Change Type:	Request #:
Minor Project Refinement	5.

Part A: Proposed Minor Project Change Summary

Date Submitted:	Requested Approval Date:	Start Date:	Expected End Date:
10/20/2016	10/24/2016	10/25/2016	11/1/2016
Submitted by:	Organization and Title:	Duration and Work Hours:	
Keri Cuppage	Senior Environmental Compliance Specialist	Within approved work hours	

Location(s): Describe applicable location(s), address, and/or dimensions and area of any additional work areas and land disturbance associated with the proposed refinement.

Disturbance of 0.01 acre within approved LOD in northwest corner of SDG&E's property

Proposed Action(s): List and describe each proposed action.

Change of location approximately 100 feet northeast of the fire service lateral line approved in MPR #1.

Purpose(s): Explain why the proposed action(s) are necessary.

Since the area is relatively flat 100 feet to the northeast, soil can be placed behind the thrust blocks enabling the backflow preventer to resist forces from the water changing directions, preventing damage to the pipe.

Comparison Documentation: Submit supporting photos, maps, and other documentation illustrating the difference between the existing conditions in the area, the approved project, and the proposed refinement in Part D.

Part B: Existing Conditions

Current and Adjacent Land Use(s):

Currently vacant. Adjacent to single family residential and public school.

Has landowner approval been granted? (Describe below)	Landowner:	Date of Approval:	Approval Verified by:
<input type="checkbox"/> Yes <input type="checkbox"/> No <input checked="" type="checkbox"/> N/A	SDG&E	Click here to enter a date.	Click here to enter text.

SDG&E owns the proposed area of disturbance.

Surveys: List any new survey reports under Part D, attach a copy, and describe relevant survey details under the applicable resource category listed in Part E.

Biological Resources. Were all sites associated with the proposed action(s) surveyed for biological resources with the potential to occur in the area? If so, were survey results positive or negative? Were surveys completed during the appropriate timing and season to detect resources? If not, describe under the applicable resource category in Part E.	<input checked="" type="checkbox"/> Previously Surveyed	<input type="checkbox"/> Positive
	<input type="checkbox"/> Survey Attached	<input checked="" type="checkbox"/> Negative
	<input checked="" type="checkbox"/> N/A – Surveys were included in the EIR.	
Cultural Resources. Were all sites associated with the proposed action(s) surveyed for cultural resources (records search and pedestrian survey)? If so, were survey results positive or negative?	<input checked="" type="checkbox"/> Previously Surveyed	<input type="checkbox"/> Positive
	<input type="checkbox"/> Survey Attached	<input checked="" type="checkbox"/> Negative
	<input checked="" type="checkbox"/> N/A – Surveys were provided for the EIR.	
Hydrology. Were all sites associated with the proposed action(s) surveyed for hydrologic resources? If so, were survey results positive or negative?	<input checked="" type="checkbox"/> Previously Surveyed	<input type="checkbox"/> Positive
	<input type="checkbox"/> Survey Attached	<input type="checkbox"/> Negative
	<input checked="" type="checkbox"/> N/A – Surveys were included in the EIR.	
Summarize water features and stormwater considerations including any changes to jurisdictional features and the use of erosion and sediment control best management practices.		
Refinement does not cause changes to hydrologic features. No jurisdictional features are located in the area. BMPs will be implemented in accordance with the approved SWPPP.		

Part C: Permits, Agency Approvals, and Environmental Protection Measures (EPMs) (List any new permits or agency approvals under Part D, attach a copy, and describe relevant details under the applicable resource category listed in Part E)

Have all required permits, permit amendments/authorizations, or agency approvals been issued by resource agencies with applicable jurisdiction?	<input checked="" type="checkbox"/> Previously Provided
	<input type="checkbox"/> Authorization Attached
	<input type="checkbox"/> N/A
Would the proposed action(s) conflict with permit conditions or agency approvals?	<input type="checkbox"/> Yes <input checked="" type="checkbox"/> No
Would the proposed action(s) conflict with project applicant proposed measures (APMs), avoidance and minimization measures, or mitigation measures (MMs) listed in the Final Environmental Impact Report (FEIR)?	<input type="checkbox"/> Yes <input checked="" type="checkbox"/> No

Part D: Attached Materials (e.g., surveys, maps, photos, memos, agency authorizations, etc.)

Attachment 1 – Change in Location of Fire Service Lateral Line Figure

Part E: FEIR Consistency

List applicable project requirements (e.g., APMs, MMs, project parameters, or other project stipulations) for which the refinement are being requested.

APM Air-1, MM Air-1, APM BIO-2, APM BIO-3, APM BIO-4, MM Biology-3, APM CUL-2, APM CUL-5, APM CUL-7, MM Cultural-1, MM Cultural-4, MM Paleontology-1, MM Geology-1, APM HAZ-3, MM Hazards-1, MM Hazards-2, APM HYDRO-1, MM Noise-2, APM REC-1, MM Recreation-1, APM TRANS-1, APM UTIL-1, and MM Utilities-1

ATTACHMENT 1

Change in Location of Fire Service Lateral Line Figure

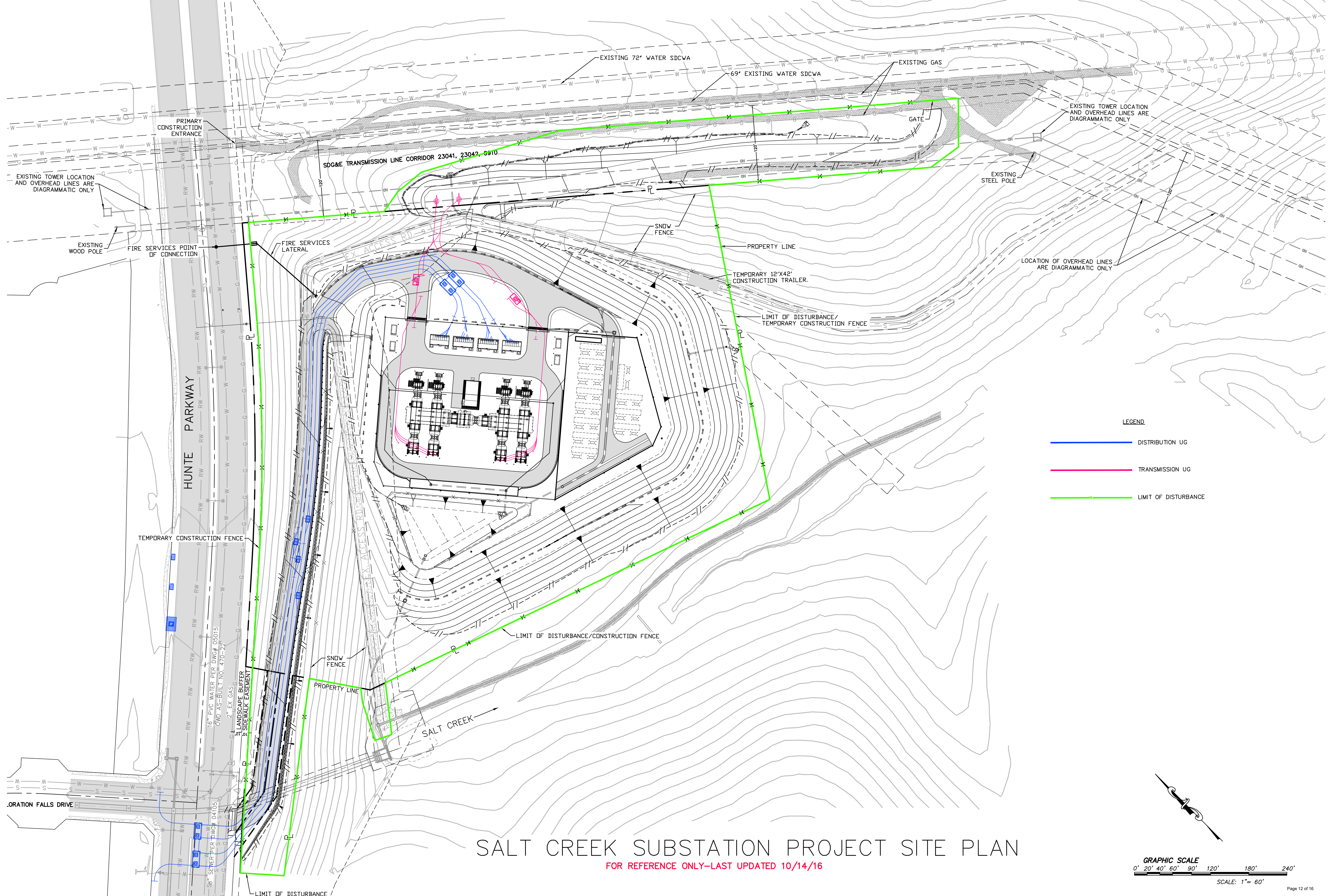

LEGEND

- DISTRIBUTION UG
- TRANSMISSION UG
- LIMIT OF DISTURBANCE

SALT CREEK SUBSTATION PROJECT SITE PLAN

FOR REFERENCE ONLY—LAST UPDATED 10/14/16

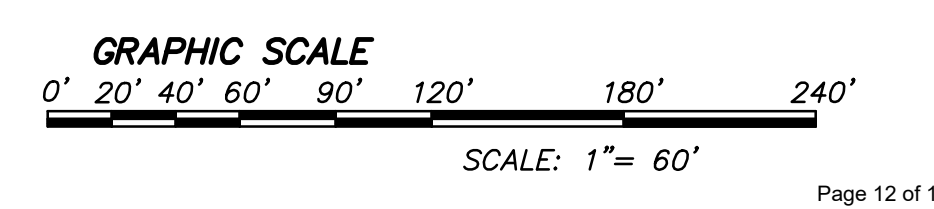

ATTACHMENT B

SDG&E Minor Project Refinement Request for Change in Location of Fire Service Lateral Line (MRP Request #5)



Memorandum

Date: October 20, 2016

To: Will Maguire
Project Manager
California Public Utilities Commission

From: Richard Quasarano
Compliance Manager
San Diego Gas & Electric Company

Subject: Revised Minor Project Refinement Request for Change of Fire Service Lateral Line Location (MPR #5)

SDG&E's design team is requesting a change associated with the previously approved MPR #1: Revised Minor Project Refinement Request for Change in Disturbance. Specifically, this MPR #5 is a request for approval of a change in location of the fire service lateral line from the location that was approved in MPR #1. The requested approval date of this MPR #5 is October 24, 2016.

The new proposed location of the fire service lateral line is approximately 100 feet northeast of the originally proposed location that was approved through MPR #1. The new location crosses the property boundary closer to the transmission corridor within the approved/amended and installed temporary construction fence. The new total length of the fire water service lateral would be 191 ft. Approximately 45 ft. of the fire water service lateral would be trenched outside of the property (30 ft. would be trenched in asphalt on Hunte Parkway and 15 ft. would be trenched in the landscaped parkway adjacent to Hunte Parkway) and 146 ft. would be trenched inside the property (131 ft. would be trenched in the landscaped slope and 15 ft. would be trenched in concrete). The trench width would be 3 ft. for a total trenched area of approximately 573 sq. ft. The approximate construction duration for the fire water service lateral would be 6 days.

The new proposed location of the fire service lateral line would be within the LOD approved through MPR #1 and no additional environmental impacts would occur as a result of this MPR #5.

The attached figure (Attachment 1) shows the new location of the fire service lateral line.

Your consideration of the proposed new location of the fire service lateral line is appreciated. Please let us know if you have any questions or concerns with this adjustment.

Thank you,

Richard Quasarano

**ATTACHMENT 1 – Change in Location of Fire Service
Lateral Line Figure**

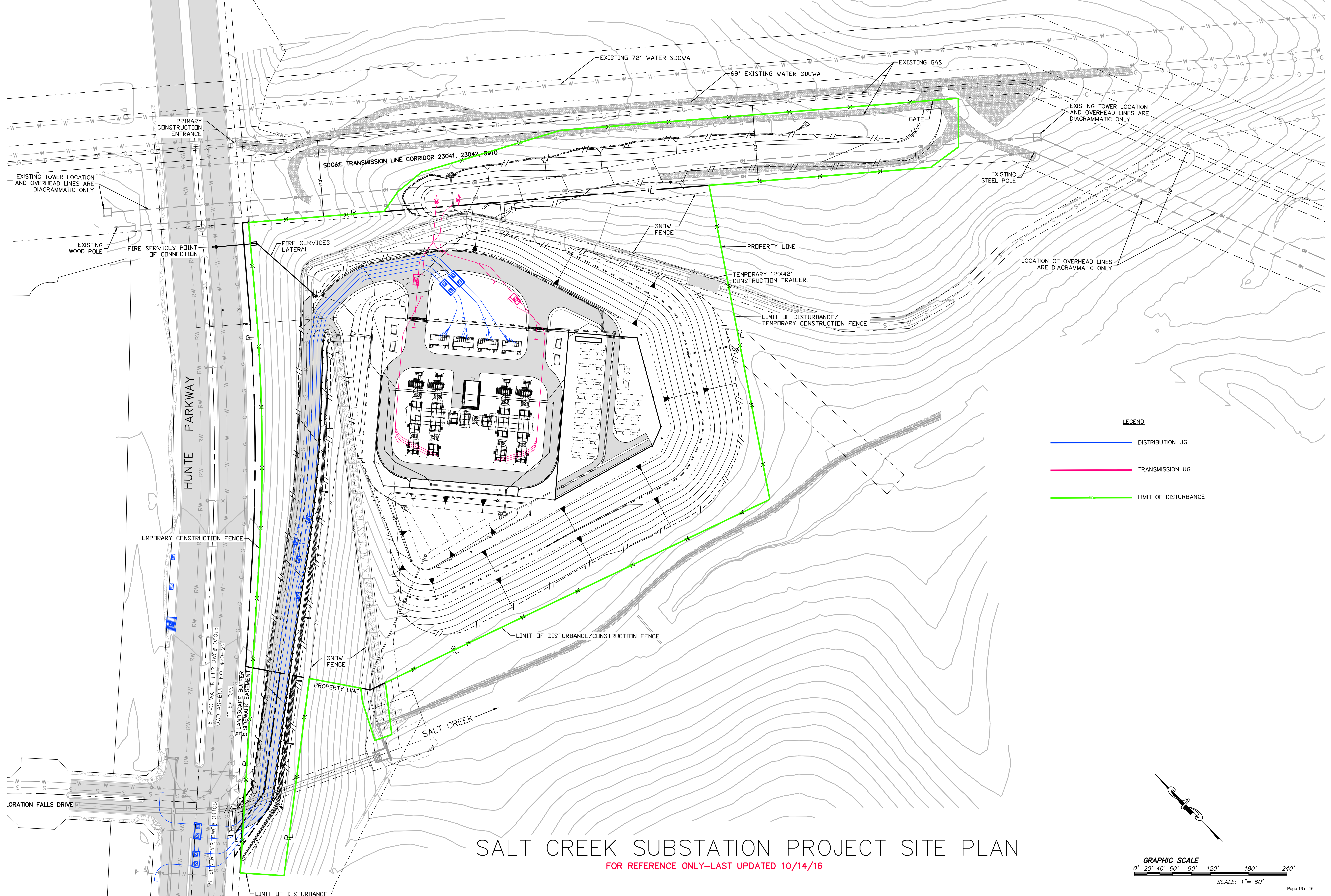

SALT CREEK SUBSTATION PROJECT SITE PLAN

FOR REFERENCE ONLY—LAST UPDATED 10/14/16

