



Traffic Control Permit (TCP) Multiple Location List

(Franchise Utility Company Only - May Not Be submitted By Contractor)

City Use Only
 Authorized # _____
 By Felipe Anlo
 Yes X No _____
 Date Reviewed 2/14/18

THE CITY OF

ATTENTION UTILITY COMPANY
 Special Inspection Fees May Be Applied By City of San Diego For Any Night or Weekend Work.

APPROVED
 FEB 14 2018
 CITY OF SAN DIEGO
 Development Services
 Engineering Division
 Traffic Safety Section

City of San Diego, Traffic Permit Section Date: 02/13/2018
 From: (Company): SDG&E Phone No.: 619-778-2405
 Contact Person: Rod Nelson Fax: _____
 W.O. or Account #: Permit # _____ TCP No. _____

- TYPE OF WORK**
- 1 = Lane Closure
 - 2 = Street Closure
 - 3 = Sidewalk Closure
 - 4 = Alley Closure
 - 5 = Parking Lane
 - 6 = Detour
 - 7 = Trenching
 - 8 = Flagging

Location	From	To	Start Date *	End Date *	Work Hours **	Thomas Bros.	Type of Work
Pomerado Road	Camino Alto	Legacy Road	2/20/18	3/10/18	8:30AM - 3:30PM	1210-A4, B4, B3, C3, C2, D2	1,7,8
Spring Canyon Rd	Pomerado Road	Caminito Canada	2/20/18	3/10/18	8:30AM - 3:30PM	1210-C2	8
Cypress Canyon Dr	Pomerado Road	Cypress Canyon Rd	2/20/18	3/10/18	8:30AM - 3:30PM	1210-C2	8
Stonebridge Pkwy	Pomerado Road	Greenstone Ct	2/20/18	3/10/18	9:00AM - 3:30PM	1210-C2, D2, E2	1,7,8
Brookside Ln	Hideaway Ln	Westly Ln	2/20/18	3/10/18	9:00AM - 3:30PM	1210-C2, D2	6,8
RoseGarden Ct	Stonebridge Pkwy	Hideaway Ln	2/20/18	3/10/18	9:00AM - 3:30PM	1210-D2	8

>>> Place CMS on I-15 (NB and SB): "CONSTRUCTION ON POMERADO RD - EXPECT DELAYS" <<<<

Vault and Trench Crews - Phases 109-125 - Daytime work hrs (M-F, 8:30AM - 3:30PM), Saturday work hrs 8:00am-4:30pm (2/24, 3/3, and 3/10)
 ** Stonebridge Pkwy ONLY work hours 9:00 AM - 3:30 PM **
 >>> Warning signs on approach to flagging operation will be doubled in east bound and west bound directions along Pomerado Road
 >>> Flaggers to assist with potential back ups and provide better traffic circulation for all movements at signalized intersections that require flash.

Comments: (Minimum 4 flaggers at intersection)

Must be submitted a minimum of 2 working days prior to start of work. All columns must be filled out for proper authorization
 Fax or mail to: City of San Diego • Traffic Control Permit Section • 1222 First Avenue, MS 501 • San Diego, CA 92101. Fax (619) 446-5489 Office (619) 446-5150
 * Work Days: Monday Through Friday ** Work Hours : 8:30 AM - 3:30PM. Unless other hours are preapproved)
 No Work on Saturdays, Sundays, or Holidays Unless Approved and Noted In Comments
 Minimum of 5 working days required for construction work which affects traffic signal e-mail info to: JVaca@sanidiego.gov



Traffic Control Permit (TCP) Multiple Location List

(Franchise Utility Company Only - May Not Be submitted By Contractor)

THE CITY OF SAN DIEGO

To: City of San Diego, Traffic Permit Section

Date: 02/13/2018

From: (Company): SDG&E

Phone No.: 619-778-2405

Contact Person: Rod Nelson

Fax.: _____

W.O. or Account #: Permit # _____

TCP No. _____

City Use Only

Authorized # _____

By Felipe Avila

Yes No _____

Date Reviewed 2/14/18

TYPE OF WORK

- 1 = Lane Closure
- 2 = Street Closure
- 3 = Sidewalk Closure
- 4 = Alley Closure
- 5 = Parking Lane
- 6 = Detour
- 7 = Trenching
- 8 = Flagging

ORIGINAL PERMIT MUST BE KEPT ON JOB SITE AT ALL TIMES

Location	From	To	Start Date *	End Date *	Work Hours **	Thomas Bros.	Type of Work
Fortino Point	Stonebridge Pkwy	Wild Meadow Pl	2/20/18	3/10/18	9:00AM - 3:30PM	1210-D2	8
Wild Meadow Pl	Fortino Point	Deer Canyon Ct	2/20/18	3/10/18	9:00AM - 3:30PM	1210-D2	8
Meritage Ct	Stonebridge Pkwy	Bella Rosa Rd	2/20/18	3/10/18	9:00AM - 3:30PM	1210-D2	8
Downing Ln	Stonebridge Pkwy	Bella Rosa Rd	2/20/18	3/10/18	9:00AM - 3:30PM	1210-E2	8
Greenstone Ct	Stonebridge Pkwy	End of Greenstone Ct	2/20/18	3/10/18	9:00AM - 3:30PM	1210-E2	8

>>> Place CMS on I-15 (NB and SB): "CONSTRUCTION ON POMERADO RD - EXPECT DELAYS" <<<<

Vault and Trench Crews - Phases 109-125 - Daytime work hrs (M-F, 8:30AM - 3:30PM), Saturday work hrs 8:00am-4:30pm (2/24, 3/3, and 3/10)

** Stonebridge Pkwy ONLY work hours 9:00 AM - 3:30 PM **

>>> Warning signs on approach to flagging operation will be doubled in east bound and west bound directions along Pomerado Road

>>> Flaggers to assist with potential back ups and provide better traffic circulation for all movements at signalized intersections that require flash.

Comments: (Minimum 4 flaggers at intersection)

Must be submitted a minimum of 2 working days prior to start of work. All columns must be filled out for proper authorization

Fax or mail to: City of San Diego • Traffic Control Permit Section • 1222 First Avenue, MS 501 • San Diego, CA 92101. Fax (619) 446-5489 Office (619) 446-5150

* Work Days: Monday Through Friday ** Work Hours: 8:30 AM - 3:30PM. Unless other hours are preapproved)

No Work on Saturdays, Sundays, or Holidays Unless Approved and Noted In Comments

Minimum of 5 working days required for construction work which affects traffic signal e-mail info to: JVaca@sanidiego.gov

ATTENTION UTILITY COMPANY

Special Inspection Fees May Be Applied By City of San Diego For Any Night or Weekend Work.

APPROVED
FEB 14 2018
Department of Public Works
Engineering Division
Traffic Safety Section

SIGN LEGEND

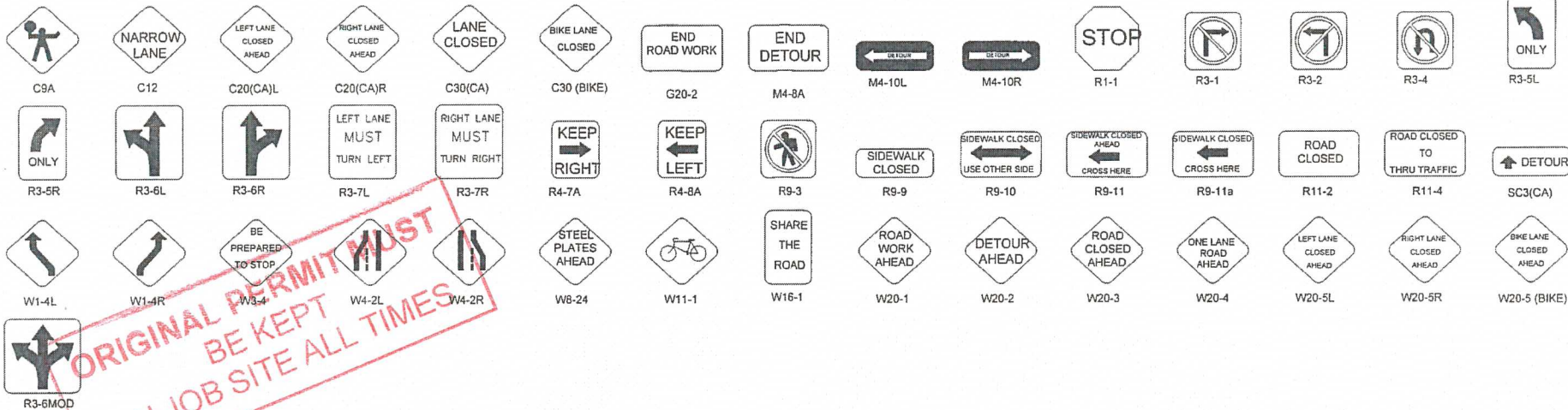

ORIGINAL PERMIT MUST BE KEPT ON JOB SITE ALL TIMES

APPROVED
TRAFFIC CONTROL PERMIT
FEB 14 2018

CITY OF SAN DIEGO
Development Services
Engineering Division
Traffic Safety Section

APPROACH SPEED (MPH)	MINIMUM DISTANCE (FEET) BETWEEN SIGNS AND FROM LAST SIGN TO TAPER
25	100
30	250
35	250
40	250
45	350
50	350
55+	350

MINIMUM DISTANCE (FEET) BETWEEN SIGNS AND FROM LAST SIGN TO TAPER	MINIMUM TAPER LENGTHS (L) (FEET) FOR 12-FOOT LANE		
	L	1/2L	1/3L
100	125	65	45
250	180	90	60
250	245	125	85
250	320	160	110
350	540	270	180
350	600	300	200
350	660	330	220

MINIMUM TAPER LENGTHS (L) (FEET) FOR 12-FOOT LANE	BUFFER LENGTH (FEET)	MAX CONE SPACING		
		TAPER	TANGENT	CONFLICT
125	155	25	50	12
180	200	30	60	15
245	250	35	70	17
320	305	40	80	20
540	360	45	90	22
600	425	50	100	25
660	485	55	110	27

LEGEND

- APPROXIMATE POTHOLE LOCATION
- SIGN
- TRAFFIC CONES / DELINEATOR
- BARRICADE
- FLAGGER
- FLASHING ARROW SIGN
- WORK ZONE
- CONSTRUCTION VEHICLE
- BUS STOP

UTILITY SURVEYORS, INC.

 2534 EAST EL NORTE PARKWAY, SUITE C
 ESCONDIDO, CA 92027
 PHONE: (760) 480-2347
 CELL: (760) 419-3736

Gail McMoran
President

PROJECT NAME: TL23071 – Sycamore Canyon Substation To Penasquitos Substation – 230 KV Underground	
AIRX JOB#: X160218	THOMAS GRID#: –
TYPE OF WORK: TRENCHING / CONDUIT	DRAWN FOR: SAN DIEGO COUNTY
MISC/POTHOLE#:	

DATE: Mar 2, 2017
DESIGNED BY:
 Clint Jones
SHEET 1 OF 4



ORIGINAL PERMIT MUST BE KEPT ON JOBSITE ALL TIMES

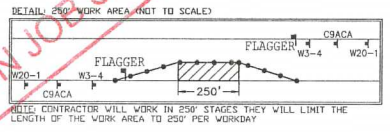
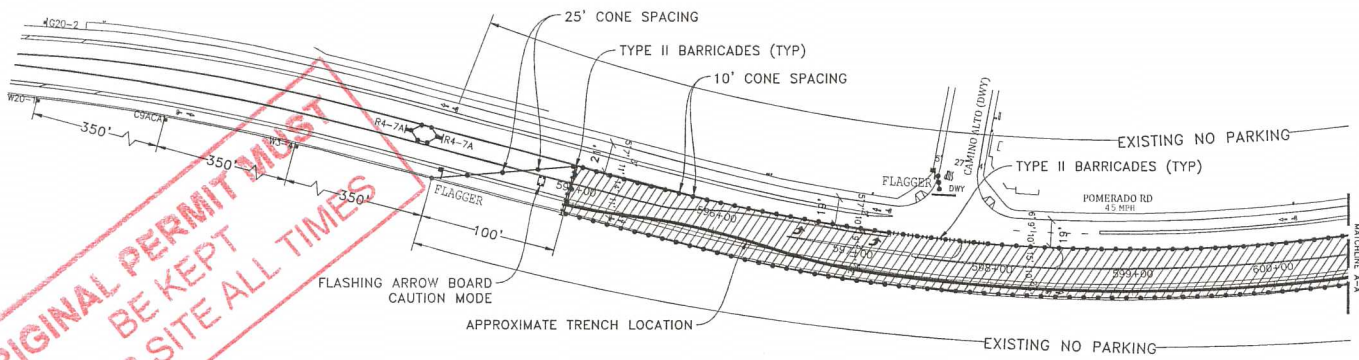

NOTE: VAULT INSTALL AND TRENCHING WILL BE CONSTRUCTED IN SEPARATE PHASES

NOTE: CONTRACTOR WILL COORDINATE ALL WORK WITH FIRE STATION PRIOR TO START OF WORK

NOTE: CONTRACTOR WILL COORDINATE ALL WORK WITH TRANSIT DEPARTMENT 5 DAYS PRIOR TO START OF WORK

NOTE: CONTRACTOR WILL COORDINATE ALL WORK WITH EXISTING PROJECTS AND NOT CONFLICT WITH EXISTING TRAFFIC CONTROL

APPROVED TRAFFIC CONTROL PERMIT

FEB 14 2018

CITY OF SAN DIEGO

Department of Public Works

Traffic Engineering Division

- LEGEND**
- SIGN
 - TRAFFIC CONES / DELINEATOR
 - ▬ BARRICADE
 - ⊠ FLAGGER
 - ⚡ FLASHING ARROW SIGN
 - ▨ WORK ZONE
 - ⊞ BUS STOP

NOTE: FLAGGERS WILL PROVIDE ACCESS TO DRIVEWAYS AT ALL TIMES

NOTE: FLAGGERS WILL SAFELY GUIDE PEDESTRIANS THROUGH WORK AREA

NOTE: CONTRACTOR WILL ALLOW FIRE STATION INGRESS AND EGRESS AT ALL TIMES

NOTE: W8-P4 STEEL PLATES HEAD SIGNS WILL REMAIN IN PLACE FOR DURATION OF WORK

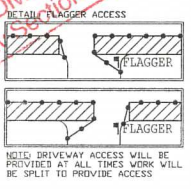

NOTE: CONTRACTOR WILL COORDINATE ALL WORK WITH RESIDENTS PRIOR TO START OF WORK

NOTE: CONTRACTOR WILL COORDINATE ALL WORK WITH BUSINESSES PRIOR TO START OF WORK

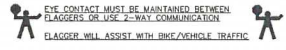

UTILITY SURVEYORS, INC.

AIRX

Gail McMorran
President

2534 EAST EL NORTE PARKWAY, SUITE C
ESCONDIDO, CA 92027
PHONE: (760) 480-2947
CELL: (760) 419-3738

PROJECT NAME: TL23071 - SYCAMORE CANYON SUBSTATION TO PENASQUITOS - 230 KV UNDERGROUND	
AIRX JOB#: X160218	THOMAS GRID#:-
TYPE OF WORK: TRENCHING / CONDUIT	DRAWN FOR: CALTRANS
MISC./POTHOLE#:	

DATE: Mar. 23, 2017
DESIGNED BY: Clint Jones
SHEET 126 OF 148

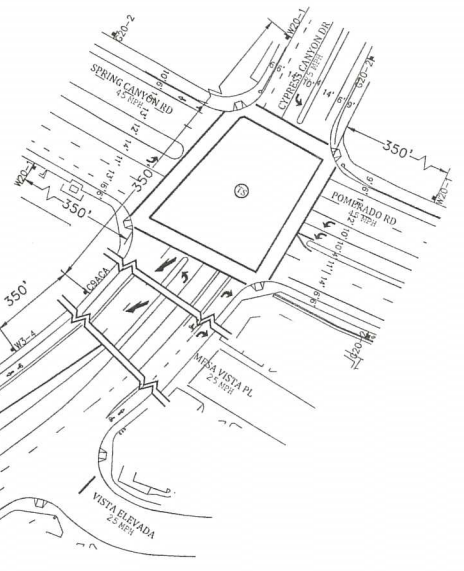
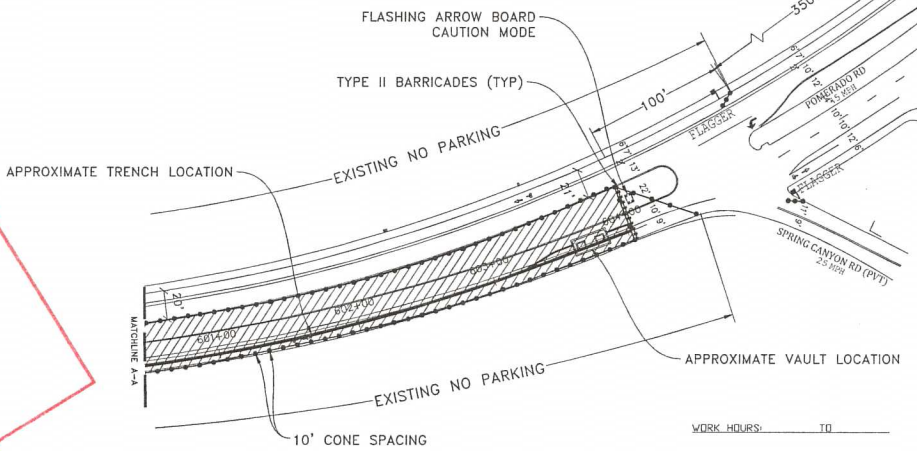

PHASE 109

SCALE 1"=40'

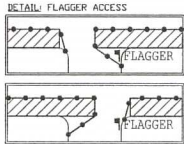

NOTE: DRIVEWAY ACCESS WILL BE PROVIDED AT ALL TIMES. WORK WILL BE SPLIT TO PROVIDE ACCESS.

ORIGINAL PERMIT MUST BE KEPT ON SITE ALL TIMES

NOTE: CONTRACTOR WILL COORDINATE ALL WORK WITH FIRE STATION PRIOR TO START OF WORK.

NOTE: CONTRACTOR WILL COORDINATE ALL WORK WITH TRANSIT DEPARTMENT 5 DAYS PRIOR TO START OF WORK.

NOTE: CONTRACTOR WILL COORDINATE ALL WORK WITH EXISTING PROJECTS AND NOT CONFLICT WITH EXISTING TRAFFIC CONTROL.

NOTE: CONTRACTOR WILL COORDINATE ALL WORK WITH RESIDENTS PRIOR TO START OF WORK.

NOTE: CONTRACTOR WILL COORDINATE ALL WORK WITH BUSINESSES PRIOR TO START OF WORK.

LEGEND

- SIGN
- TRAFFIC CONES / DELINEATOR
- I BARRICADE
- FL FLAGGER
- FLASHING ARROW SIGN
- WORK ZONE
- BUS STOP

NOTE: FLAGGERS WILL PROVIDE ACCESS TO DRIVEWAYS AT ALL TIMES.

NOTE: FLAGGERS WILL SAFELY GUIDE PEDESTRIANS THROUGH WORK AREA.

NOTE: CONTRACTOR WILL ALLOW FIRE STATION INGRESS AND EGRESS AT ALL TIMES.

NOTE: W8-24 (STEEL PLATES) AHEAD SIGNS WILL REMAIN IN PLACE FOR DURATION OF WORK.

APPROVED

TRAFFIC CONTROL PERMIT

FEB 14 2018

CITY OF SAN DIEGO
Development Services
Engineering Division
Traffic Safety Section

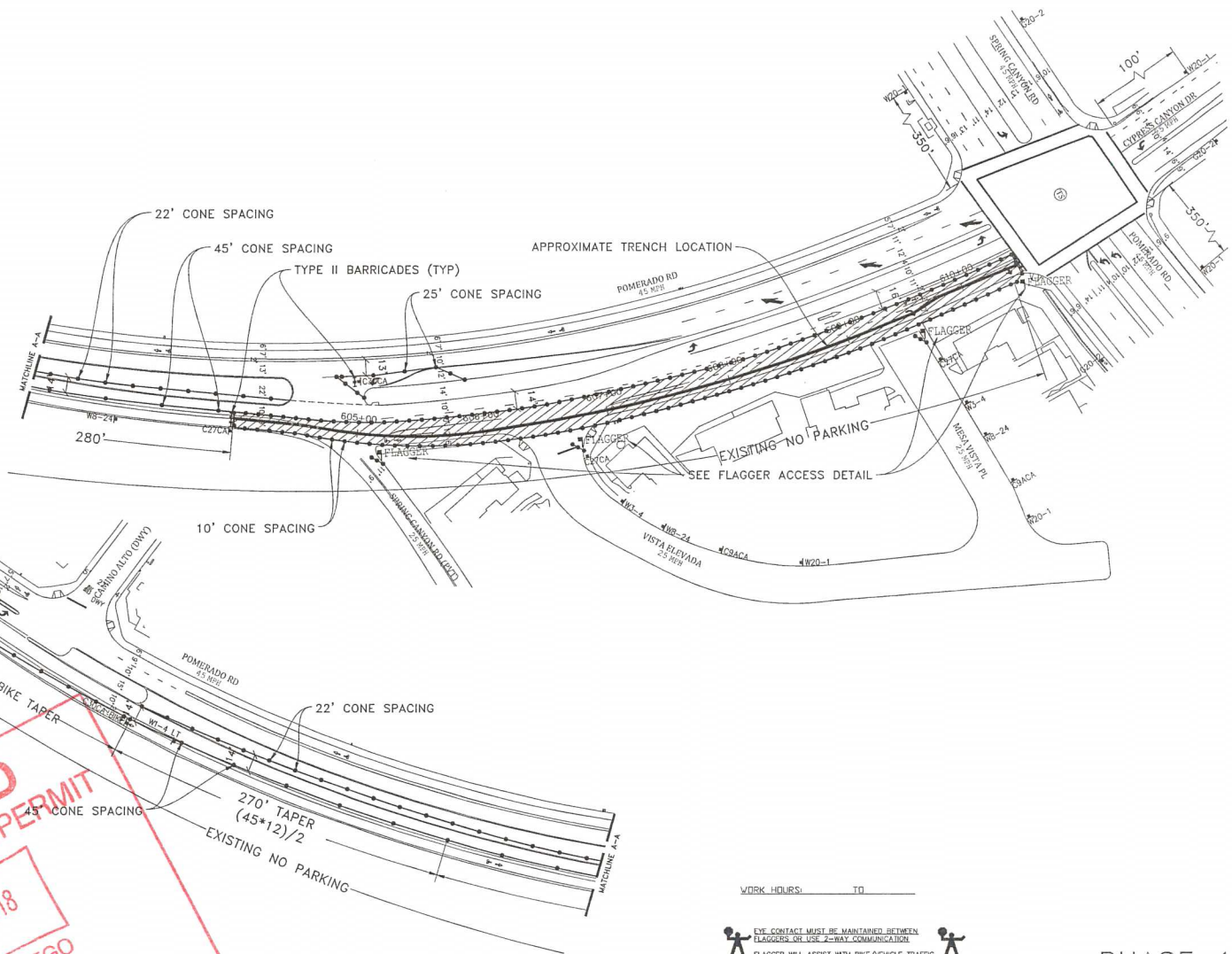

WORK HOURS: _____ TO _____

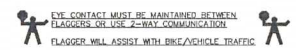

UTILITY SURVEYORS, INC.

AIRX

Gail McMorran
President

2534 EAST EL NORTE PARKWAY, SUITE C
ESCONDIDO, CA 92027
PHONE: (760) 499-2347
CELL: (760) 419-3738

PROJECT NAME: TL23071 - SYCAMORE CANYON SUBSTATION TO PENASQUITOS - 230 KV UNDERGROUND	
AIRX JOB# X160218	THOMAS GRID#:-
TYPE OF WORK: RENCHING / CONDUIT	DRAWN FOR: CALTRANS
MISC./POTHOLE#:	

PHASE 110

DATE: Mar. 24, 2017

DESIGNED BY: Clint Jones

SHEET 127 OF 148

SCALE 1"=40'

ORIGINAL PERMIT MUST BE KEPT ON JOB SITE ALL TIMES

APPROVED
TRAFFIC CONTROL PERMIT
FEB 14 2018
 CITY OF SAN DIEGO
 Development Services
 Engineering Division
 Safety Section

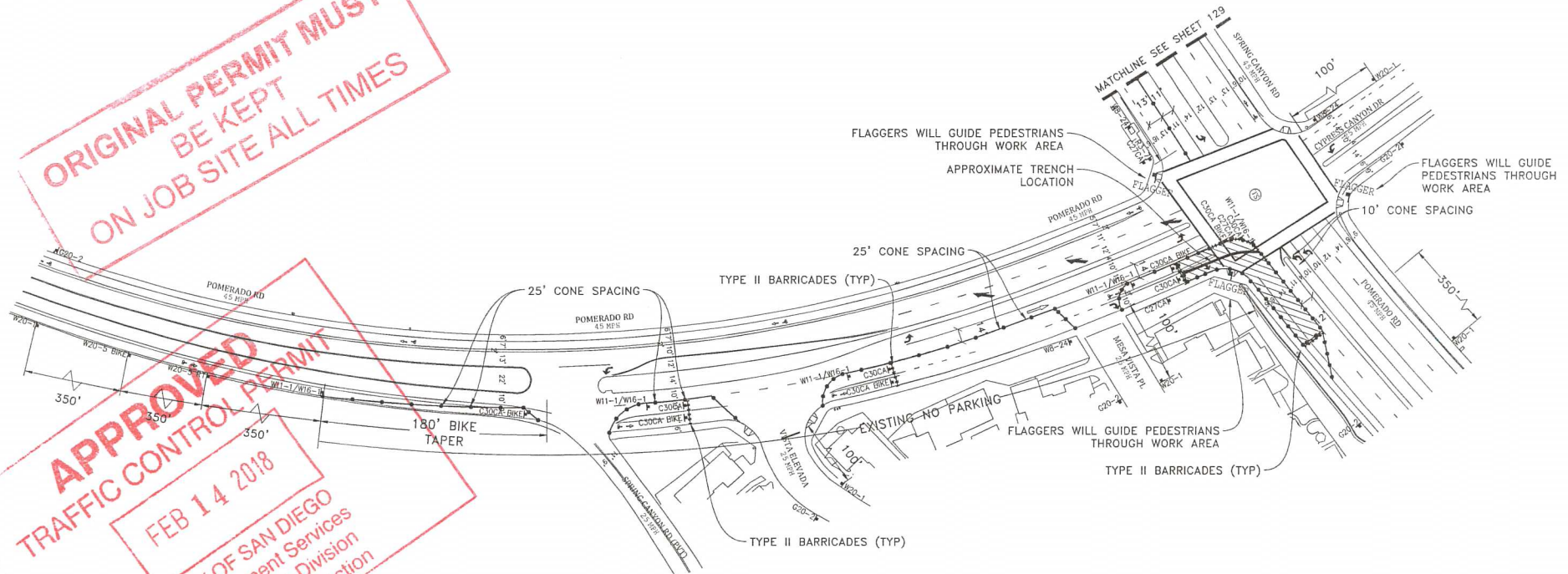

- LEGEND**
- █ SIGN
 - TRAFFIC CONES / DELINEATOR
 - ▬ BARRICADE
 - ⚓ FLAGGER
 - ↔ FLASHING ARROW SIGN
 - ▨ WORK ZONE
 - 🚌 BUS STOP

NOTE: CONTRACTOR WILL COORDINATE ALL WORK WITH FIRE STATION PRIOR TO START OF WORK

NOTE: CONTRACTOR WILL COORDINATE ALL WORK WITH TRANSIT DEPARTMENT 5 DAYS PRIOR TO START OF WORK

NOTE: CONTRACTOR WILL COORDINATE ALL WORK WITH EXISTING PROJECTS AND NOT CONFLICT WITH EXISTING TRAFFIC CONTROL

NOTE: CONTRACTOR WILL COORDINATE ALL WORK WITH RESIDENTS PRIOR TO START OF WORK

NOTE: CONTRACTOR WILL COORDINATE ALL WORK WITH BUSINESSES PRIOR TO START OF WORK

NOTE: FLAGGERS WILL PROVIDE ACCESS TO DRIVEWAYS AT ALL TIMES

NOTE: FLAGGERS WILL SAFELY GUIDE PEDESTRIANS THROUGH WORK AREA

NOTE: CONTRACTOR WILL ALLOW FIRE STATION INGRESS AND EGRESS AT ALL TIMES

NOTE: W8-24 (STEEL PLATES) AHEAD SIGNS WILL REMAIN IN PLACE FOR DURATION OF WORK

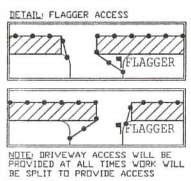

WORK HOURS: _____ TO _____

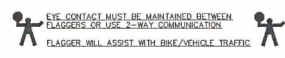

PHASE 111

UTILITY SURVEYORS, INC.

 Gail McMorran
 President
 2534 EAST EL NORTE PARKWAY, SUITE C
 ESCONDIDO, CA 92027
 PHONE: (760) 480-2347
 CELL: (760) 419-3738

PROJECT NAME: TL23071 - SYCAMORE CANYON SUBSTATION TO PENASQUITOS - 230 KV UNDERGROUND		DATE: Mar. 24, 2017
AIRX JOB#: X160218	THOMAS GRID#:-	DESIGNED BY: Clint Jones
TYPE OF WORK: RENCHING / CONDUIT	DRAWN FOR: CALTRANS	
MISC./POTHOLE#:		SHEET 128 OF 148

SCALE 1"=40'

ORIGINAL PERMIT MUST BE KEPT ON JOB SITE ALL TIMES

APPROVED
TRAFFIC CONTROL PERMIT
FEB 14 2018
CITY OF SAN DIEGO
Development Services
Engineering Division
Traffic Safety Section

- LEGEND**
- SIGN
 - TRAFFIC CONES / DELINEATOR
 - BARRICADE
 - FLAGGER
 - FLASHING ARROW SIGN
 - WORK ZONE
 - BUS STOP

NOTE: FLAGGERS WILL PROVIDE ACCESS TO DRIVEWAYS AT ALL TIMES

NOTE: FLAGGERS WILL SAFELY GUIDE PEDESTRIANS THROUGH WORK AREA

NOTE: CONTRACTOR WILL ALLOW FIRE STATION INGRESS AND EGRESS AT ALL TIMES

NOTE: W8-24 STEEL PLATES AHEAD SIGNS WILL REMAIN IN PLACE FOR DURATION OF WORK

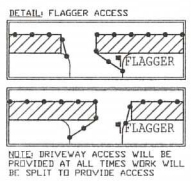

NOTE: CONTRACTOR WILL COORDINATE ALL WORK WITH FIRE STATION PRIOR TO START OF WORK

NOTE: CONTRACTOR WILL COORDINATE ALL WORK WITH TRANSIT DEPARTMENT 5 DAYS PRIOR TO START OF WORK

NOTE: CONTRACTOR WILL COORDINATE ALL WORK WITH EXISTING PROJECTS AND NOT CONFLICT WITH EXISTING TRAFFIC CONTROL

NOTE: CONTRACTOR WILL COORDINATE ALL WORK WITH RESIDENTS PRIOR TO START OF WORK

NOTE: CONTRACTOR WILL COORDINATE ALL WORK WITH BUSINESSES PRIOR TO START OF WORK

WORK HOURS: _____ TO _____

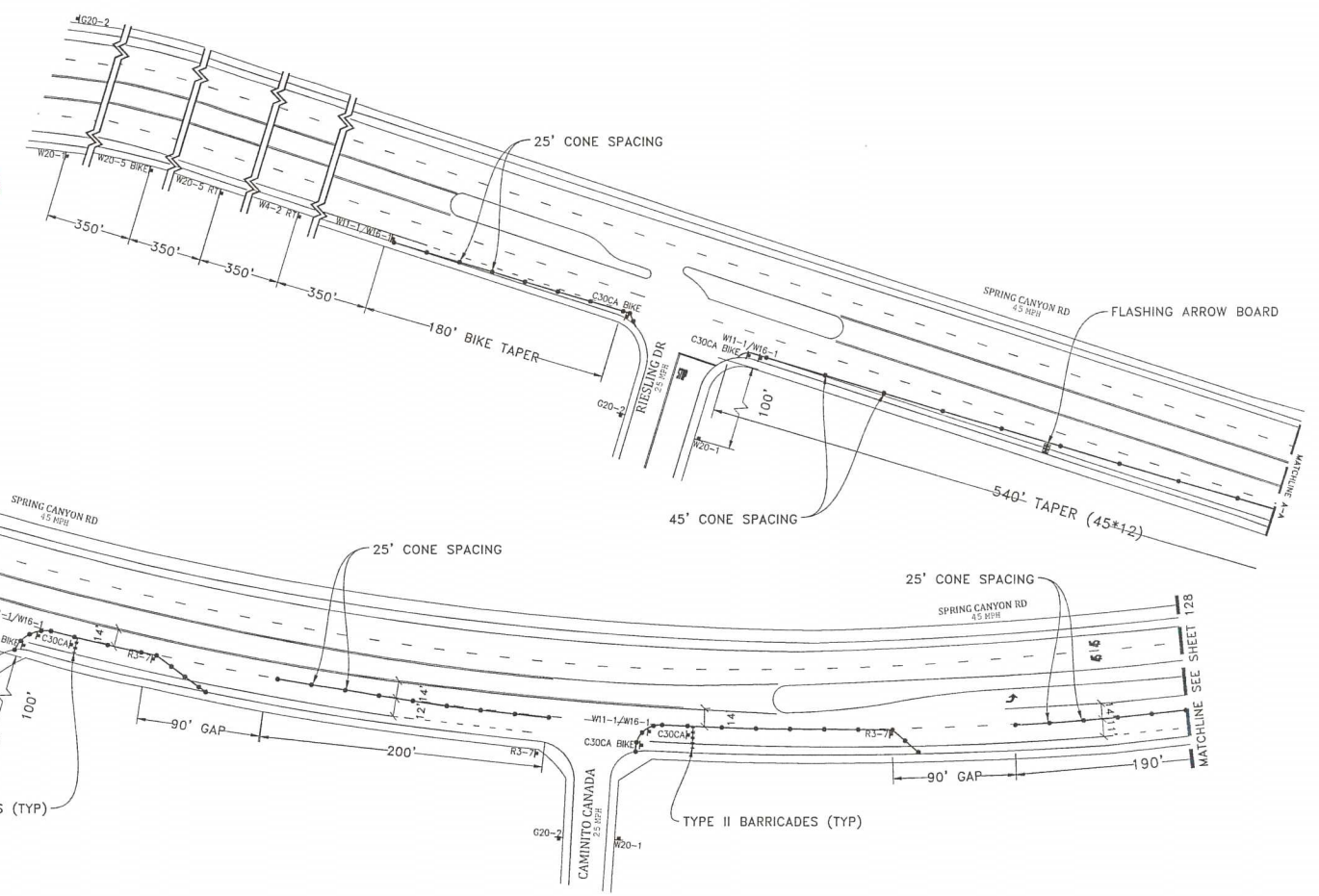
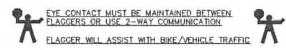

UTILITY SURVEYORS, INC.
AIRX
 Gail McMorran
 President
 2534 EAST EL NORTE PARKWAY, SUITE C
 ESCOBEDO, CA 92027
 PHONE: (760) 480-2347
 CELL: (760) 419-3738

PROJECT NAME: TL23071 - SYCAMORE CANYON SUBSTATION TO PENASQUITOS - 230 KV UNDERGROUND	
AIRX JOB#: X160218	THOMAS GRID#:-
TYPE OF WORK: RENCHING / CONDUIT	DRAWN FOR: CALTRANS
MISC./POTHOLE#:	

PHASE 111

DATE: Mar. 24, 2017
 DESIGNED BY: Clint Jones
 SHEET 129 OF 148



- NOTE: CONTRACTOR WILL COORDINATE ALL WORK WITH FIRE STATION PRIOR TO START OF WORK
- NOTE: CONTRACTOR WILL COORDINATE ALL WORK WITH TRANSIT DEPARTMENT 5 DAYS PRIOR TO START OF WORK
- NOTE: CONTRACTOR WILL COORDINATE ALL WORK WITH EXISTING PROJECTS AND NOT CONFLICT WITH EXISTING TRAFFIC CONTROL
- NOTE: CONTRACTOR WILL COORDINATE ALL WORK WITH RESIDENTS PRIOR TO START OF WORK
- NOTE: CONTRACTOR WILL COORDINATE ALL WORK WITH BUSINESSES PRIOR TO START OF WORK

- NOTE: FLAGGERS WILL PROVIDE ACCESS TO DRIVEWAYS AT ALL TIMES
- NOTE: FLAGGERS WILL SAFELY GUIDE PEDESTRIANS THROUGH WORK AREA
- NOTE: CONTRACTOR WILL ALLOW FIRE STATION INGRESS AND EGRESS AT ALL TIMES
- NOTE: W8-24 STEEL PLATES AHEAD SIGNS WILL REMAIN IN PLACE FOR DURATION OF WORK



ORIGINAL PERMIT MUST BE KEPT ON JOB SITE ALL TIMES

APPROVED TRAFFIC CONTROL PERMIT

FEB 14 2018

CITY OF SAN DIEGO
Development Services
Engineering Division
Traffic Safety Section

- LEGEND**
- SIGN
 - TRAFFIC CONES / DELINEATOR
 - BARRICADE
 - FLAGGER
 - FLASHING ARROW SIGN
 - WORK ZONE
 - BUS STOP

WORK HOURS: _____ TO _____

EYE CONTACT MUST BE MAINTAINED BETWEEN FLAGGERS OR USE 2-WAY COMMUNICATION

FLAGGER WILL ASSIST WITH BIKE/VEHICLE TRAFFIC

UTILITY SURVEYORS, INC.

AIRX

Gail McMorran
President

2534 EAST EL NORTE PARKWAY, SUITE C
ESCONDIDO, CA 92027
PHONE: (760) 486-2347
CELL: (760) 419-3738

PROJECT NAME: TL23071 - SYCAMORE CANYON SUBSTATION TO PENASQUITOS - 230 KV UNDERGROUND	
AIRX JOB#: X160218	THOMAS GRID#:-
TYPE OF WORK: FRENCHING / CONDUIT	DRAWN FOR: CALTRANS
MISC./POTHOLES#:	

PHASE 112

DATE: Mar. 24, 2017
DESIGNED BY: Clint Jones
SHEET 130 OF 148

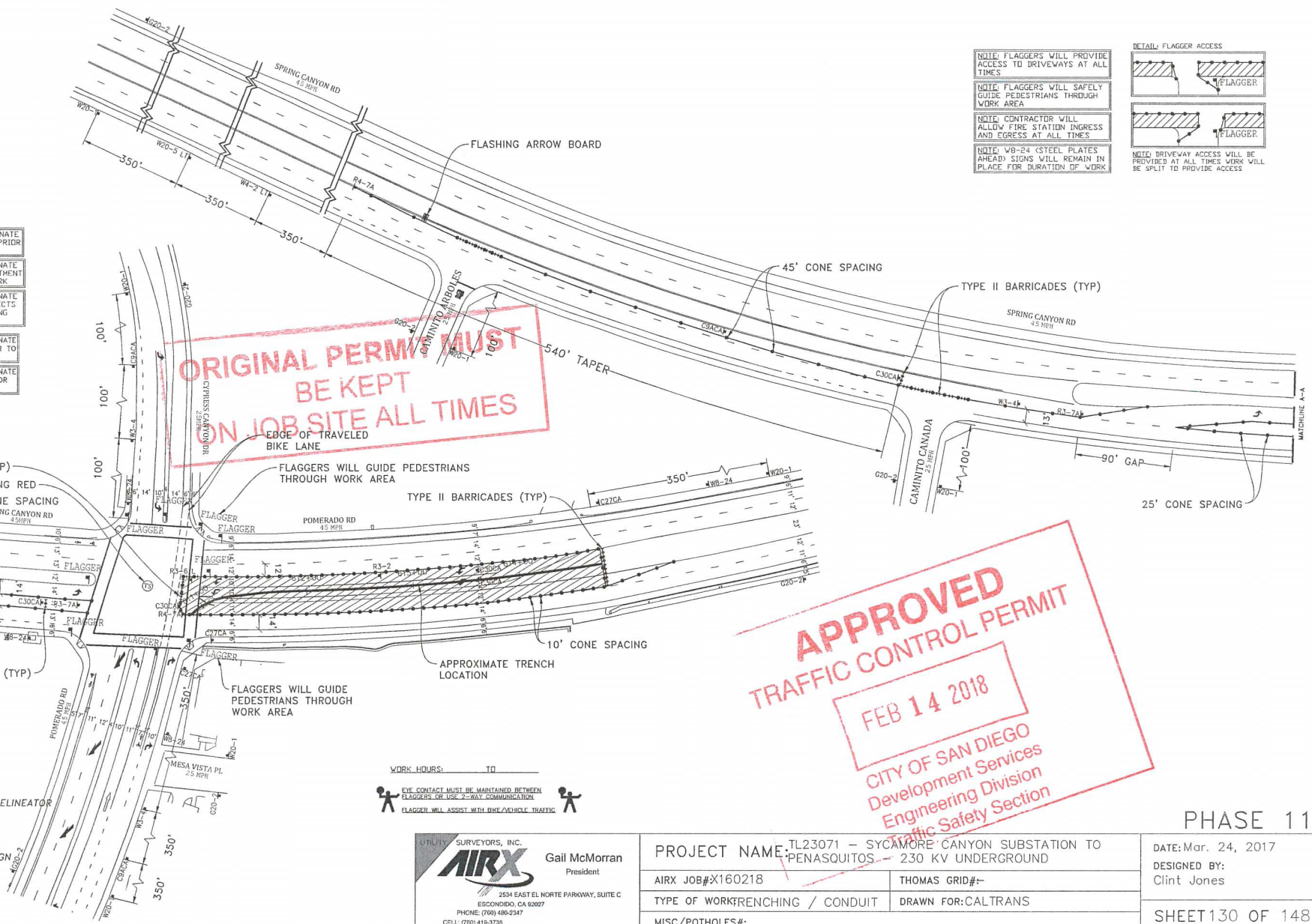



APPROVED

TRAFFIC CONTROL PERMIT

FEB 14 2018

CITY OF SAN DIEGO

Development Services

Engineering Division

Traffic Safety Section

ORIGINAL PERMIT MUST

BE KEPT

ON JOB SITE ALL TIMES

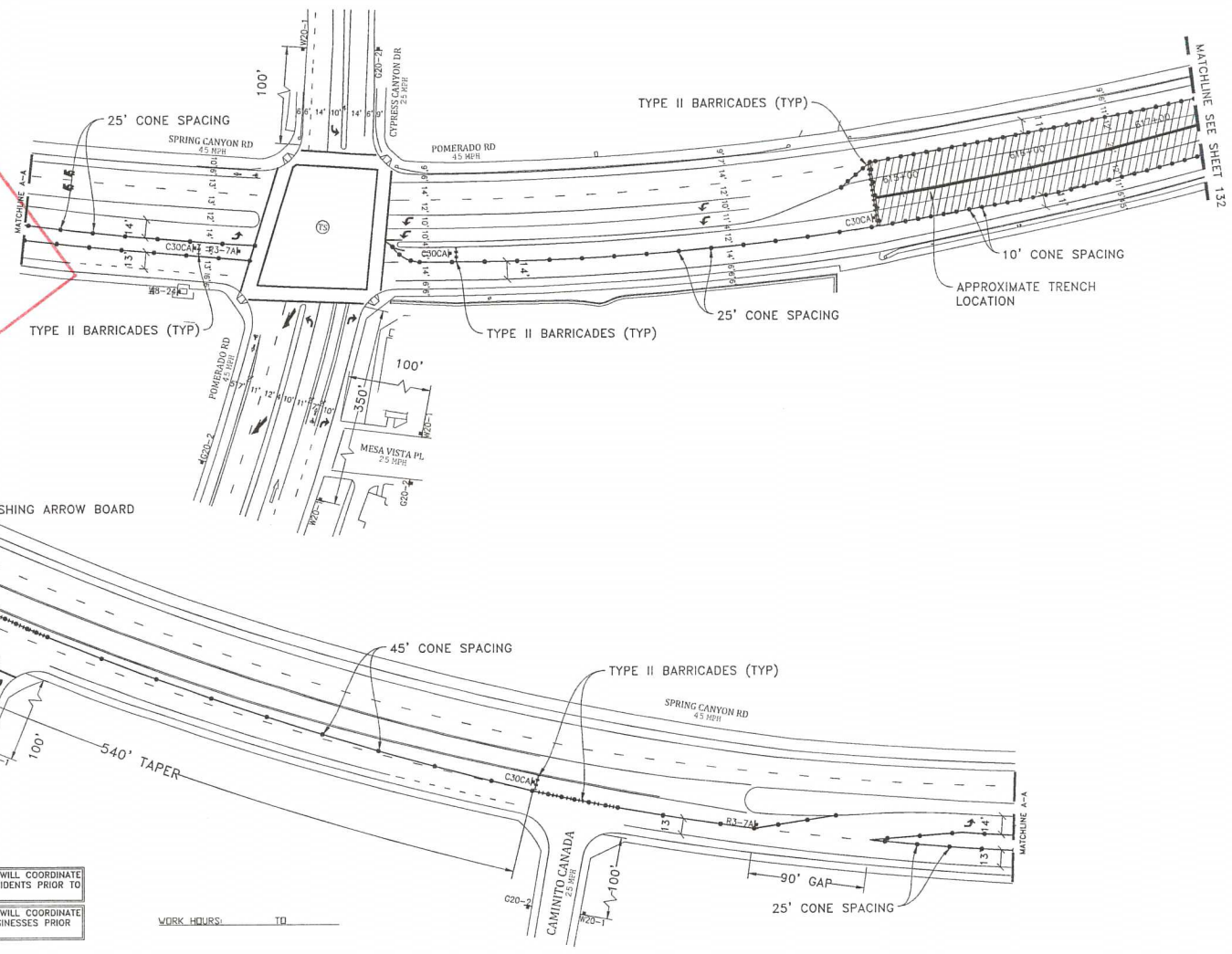

NOTE: CONTRACTOR WILL COORDINATE ALL WORK WITH FIRE STATION PRIOR TO START OF WORK

NOTE: CONTRACTOR WILL COORDINATE ALL WORK WITH TRANSIT DEPARTMENT 5 DAYS PRIOR TO START OF WORK

NOTE: CONTRACTOR WILL COORDINATE ALL WORK WITH EXISTING PROJECTS AND NOT CONFLICT WITH EXISTING TRAFFIC CONTROL

NOTE: CONTRACTOR WILL COORDINATE ALL WORK WITH RESIDENTS PRIOR TO START OF WORK

NOTE: CONTRACTOR WILL COORDINATE ALL WORK WITH BUSINESSES PRIOR TO START OF WORK

WORK HOURS: _____ TO _____

LEGEND

- SIGN
- TRAFFIC CONES / DELINEATOR
- BARRICADE
- FLAGGER
- FLASHING ARROW SIGN
- WORK ZONE
- BUS STOP

NOTE: FLAGGERS WILL PROVIDE ACCESS TO DRIVEWAYS AT ALL TIMES

NOTE: FLAGGERS WILL SAFELY GUIDE PEDESTRIANS THROUGH WORK AREA

NOTE: CONTRACTOR WILL ALLOW FIRE STATION INGRESS AND EGRESS AT ALL TIMES

NOTE: W8-24 STEEL PLATES AHEAD SIGNS WILL REMAIN IN PLACE FOR DURATION OF WORK

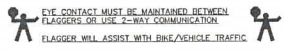
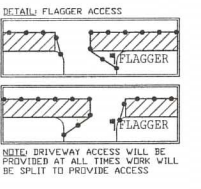

UTILITY SURVEYORS, INC.

AIRX

Gail McMorran
President

2534 EAST EL NORTE PARKWAY, SUITE C
ESCONDIDO, CA 92027
PHONE: (760) 480-2347
CELL: (760) 418-3739

PROJECT NAME: TL23071 - SYCAMORE CANYON SUBSTATION TO PENASQUITOS - 230 KV UNDERGROUND	
AIRX JOB#: X160218	THOMAS GRID#:
TYPE OF WORK: TRENCHING / CONDUIT	DRAWN FOR: CALTRANS
MISC/POTHoles#:	

PHASE 113

DATE: Mar. 1, 2017

DESIGNED BY:
Clint Jones

SHEET 131 OF 148



ORIGINAL PERMIT MUST BE KEPT ON JOB SITE ALL TIMES

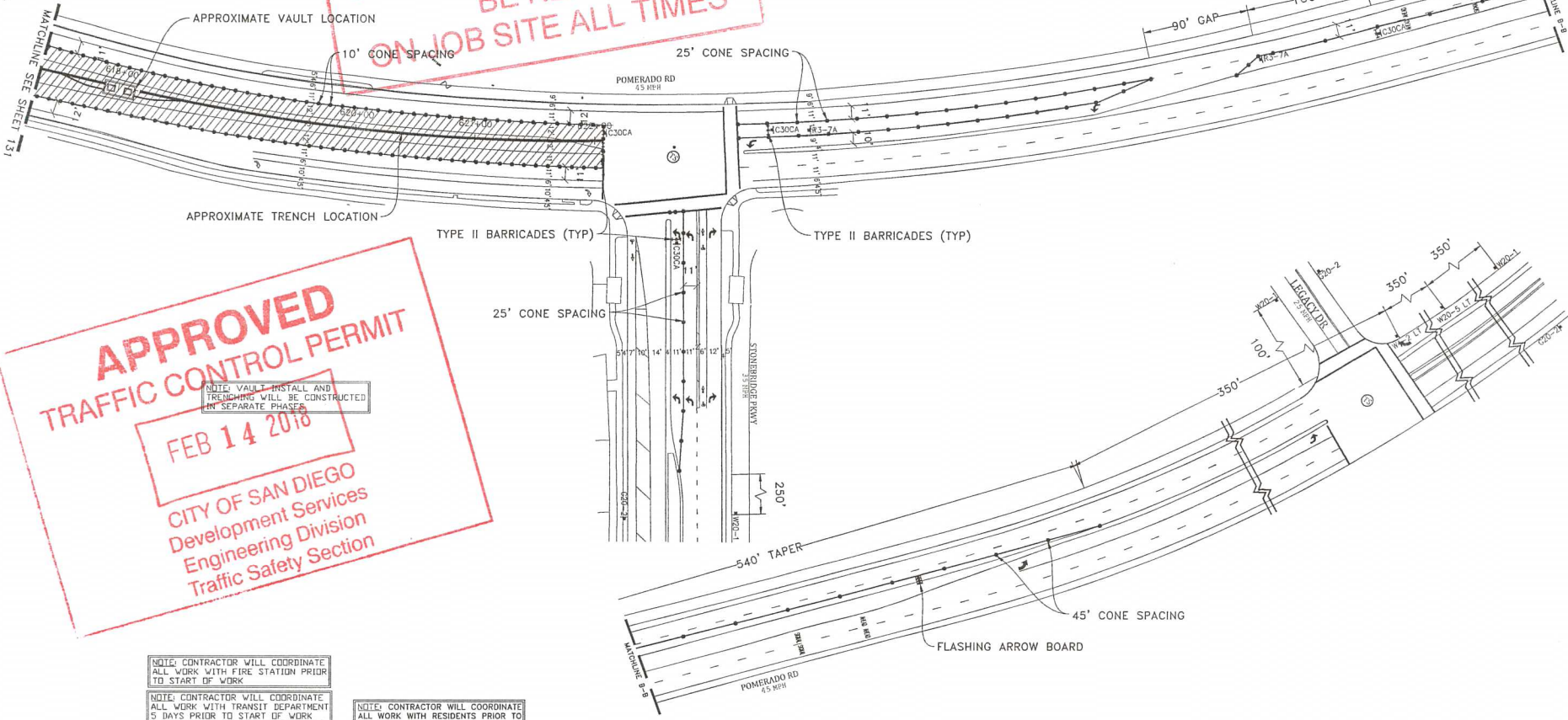

APPROVED TRAFFIC CONTROL PERMIT
FEB 14 2018
 CITY OF SAN DIEGO
 Development Services
 Engineering Division
 Traffic Safety Section

NOTE: CONTRACTOR WILL COORDINATE ALL WORK WITH FIRE STATION PRIOR TO START OF WORK

NOTE: CONTRACTOR WILL COORDINATE ALL WORK WITH TRANSIT DEPARTMENT 5 DAYS PRIOR TO START OF WORK

NOTE: CONTRACTOR WILL COORDINATE ALL WORK WITH EXISTING PROJECTS AND NOT CONFLICT WITH EXISTING TRAFFIC CONTROL

NOTE: CONTRACTOR WILL COORDINATE ALL WORK WITH RESIDENTS PRIOR TO START OF WORK

NOTE: CONTRACTOR WILL COORDINATE ALL WORK WITH BUSINESSES PRIOR TO START OF WORK

LEGEND

- SIGN
- TRAFFIC CONES / DELINEATOR
- BARRICADE
- FLAGGER
- FLASHING ARROW SIGN
- WORK ZONE
- BUS STOP

NOTE: FLAGGERS WILL PROVIDE ACCESS TO DRIVEWAYS AT ALL TIMES

NOTE: FLAGGERS WILL SAFELY GUIDE PEDESTRIANS THROUGH WORK AREA

NOTE: CONTRACTOR WILL ALLOW FIRE STATION INGRESS AND EGRESS AT ALL TIMES

NOTE: V8-24 STEEL PLATES AHEAD SIGNS WILL REMAIN IN PLACE FOR DURATION OF WORK

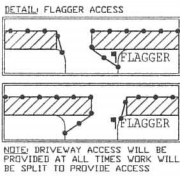

WORK HOURS: TO

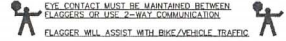

PHASE 113

UTILITY SURVEYORS, INC.
AIRX
 Gail McMorran
 President
 2534 EAST EL NORTE PARKWAY, SUITE C
 ESCONDO, CA 92027
 PHONE: (760) 480-2347
 CELL: (760) 418-3738

PROJECT NAME: TL23071 - SYCAMORE CANYON SUBSTATION TO PENASQUITOS - 230 KV UNDERGROUND	
AIRX JOB# X160218	THOMAS GRID#-
TYPE OF WORK: FRENCHING / CONDUIT	DRAWN FOR: CALTRANS
MISC./POTHOLE#:	

DATE: Mar. 23, 2017
DESIGNED BY: Clint Jones
SHEET 132 OF 148

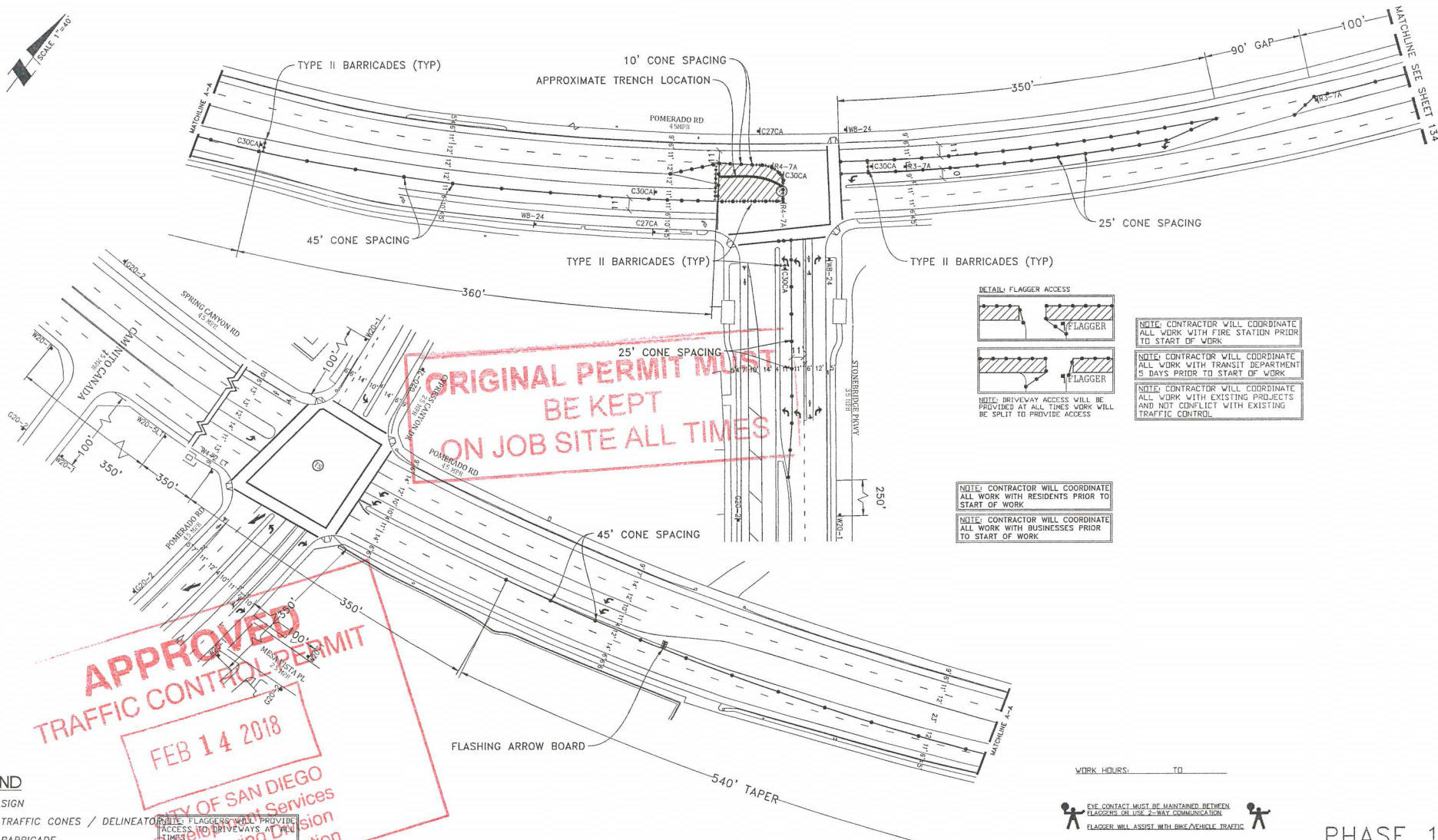

ORIGINAL PERMIT MUST BE KEPT ON JOB SITE ALL TIMES

APPROVED TRAFFIC CONTROL PERMIT
FEB 14 2018
 CITY OF SAN DIEGO
 Public Works Services
 Engineering Division
 Traffic Section

- LEGEND**
- SIGN
 - TRAFFIC CONES / DELINEATION
 - BARRICADE
 - FLAGGER
 - FLASHING ARROW SIGN
 - WORK ZONE
 - BUS STOP

NOTE: FLAGGERS WILL PROVIDE ACCESS TO DRIVEWAYS AT ALL TIMES

NOTE: FLAGGERS WILL SAFELY GUIDE PEDESTRIANS THROUGH WORK AREA

NOTE: CONTRACTOR WILL ALLOW FIRE STATION INGRESS AND EGRESS AT ALL TIMES

NOTE: W8-24 STEEL PLATES AHEAD SIGNS WILL REMAIN IN PLACE FOR DURATION OF WORK

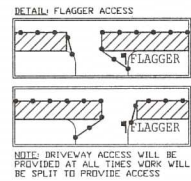

NOTE: CONTRACTOR WILL COORDINATE ALL WORK WITH FIRE STATION PRIOR TO START OF WORK

NOTE: CONTRACTOR WILL COORDINATE ALL WORK WITH TRANSIT DEPARTMENT 5 DAYS PRIOR TO START OF WORK

NOTE: CONTRACTOR WILL COORDINATE ALL WORK WITH EXISTING PROJECTS AND NOT CONFLICT WITH EXISTING TRAFFIC CONTROL

NOTE: CONTRACTOR WILL COORDINATE ALL WORK WITH RESIDENTS PRIOR TO START OF WORK

NOTE: CONTRACTOR WILL COORDINATE ALL WORK WITH BUSINESSES PRIOR TO START OF WORK

WORK HOURS: _____ TO _____

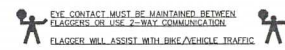

UTILITY SURVEYORS, INC.

AIRX

Gail McMorran
President

2534 EAST EL NORTE PARKWAY, SUITE C
ESCONDIDO, CA 92027
PHONE: (760) 480-2347
CELL: (760) 419-3738

PROJECT NAME: TL23071 - SYCAMORE CANYON SUBSTATION TO PENASQUITOS - 230 KV UNDERGROUND	
AIRX JOB#: X160218	THOMAS GRID#:-
TYPE OF WORK: TRENCHING / CONDUIT	DRAWN FOR: CALTRANS
MISC./POTHOLE#:	

PHASE 114

DATE: Mar. 24, 2017

DESIGNED BY:
Clint Jones

SHEET 133 OF 148



APPROVED
TRAFFIC CONTROL PERMIT
FEB 14 2018

CITY OF SAN DIEGO
 Development Services
 Engineering Division
 Traffic Safety Section

**ORIGINAL PERMIT MUST
 BE KEPT
 ON JOB SITE ALL TIMES**

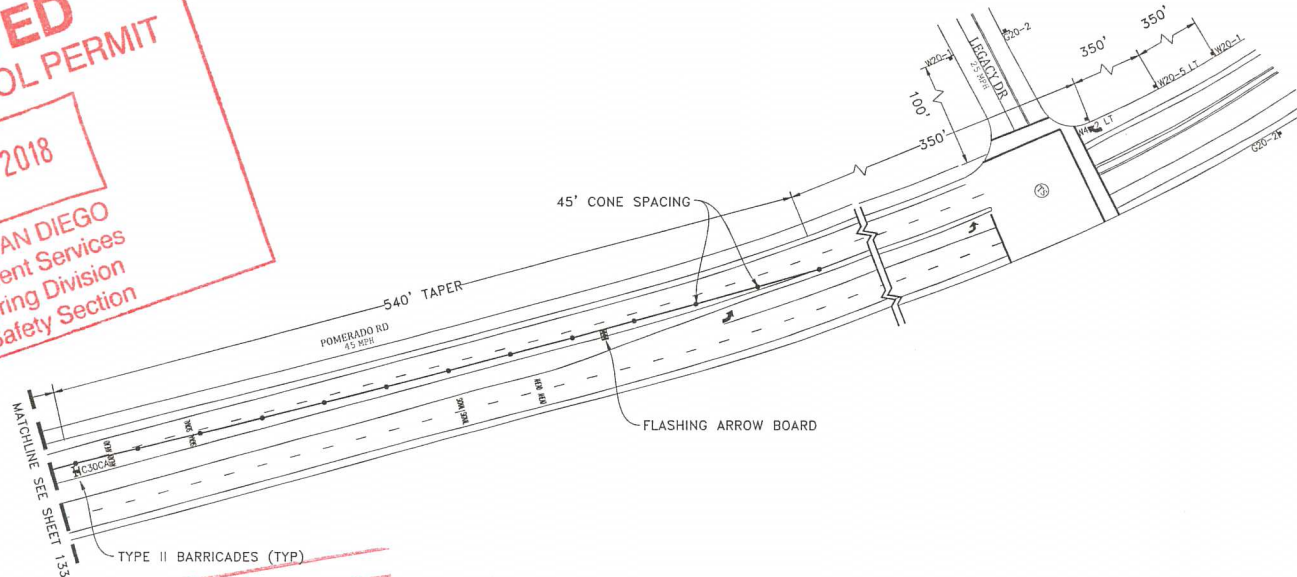

LEGEND

- SIGN
- TRAFFIC CONES / DELINEATOR
- BARRICADE
- FLAGGER
- FLASHING ARROW SIGN
- WORK ZONE
- BUS STOP

NOTE: FLAGGERS WILL PROVIDE ACCESS TO DRIVEWAYS AT ALL TIMES

NOTE: FLAGGERS WILL SAFELY GUIDE PEDESTRIANS THROUGH WORK AREA

NOTE: CONTRACTOR WILL ALLOW FIRE STATION INGRESS AND EGRESS AT ALL TIMES

NOTE: W8-24 STEEL PLATES (AHEAD) SIGNS WILL REMAIN IN PLACE FOR DURATION OF WORK

DETAIL: FLAGGER ACCESS

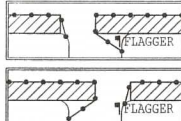

NOTE: DRIVEWAY ACCESS WILL BE PROVIDED AT ALL TIMES WORK WILL BE SPLIT TO PROVIDE ACCESS

NOTE: CONTRACTOR WILL COORDINATE ALL WORK WITH FIRE STATION PRIOR TO START OF WORK

NOTE: CONTRACTOR WILL COORDINATE ALL WORK WITH TRANSIT DEPARTMENT 5 DAYS PRIOR TO START OF WORK

NOTE: CONTRACTOR WILL COORDINATE ALL WORK WITH EXISTING PROJECTS AND NOT CONFLICT WITH EXISTING TRAFFIC CONTROL

NOTE: CONTRACTOR WILL COORDINATE ALL WORK WITH RESIDENTS PRIOR TO START OF WORK

NOTE: CONTRACTOR WILL COORDINATE ALL WORK WITH BUSINESSES PRIOR TO START OF WORK

WORK HOURS: _____ TO _____

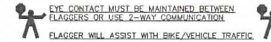

UTILITY SURVEYORS, INC.

 Gail McMorran
 President
 2534 EAST EL NORTE PARKWAY, SUITE C
 ESCOBEDO, CA 92027
 PHONE: (760) 490-2347
 CELL: (760) 419-3738

PROJECT NAME: TL23071 - SYCAMORE CANYON SUBSTATION TO PENASQUITOS - 230 KV UNDERGROUND

AIRX JOB# X160218

THOMAS GRID#:-

TYPE OF WORK: RENCHING / CONDUIT

DRAWN FOR: CALTRANS

MISC/POTHOLE#:

PHASE 114

DATE: Mar. 1, 2017

DESIGNED BY: Clint Jones

SHEET 134 OF 148



ORIGINAL PERMIT MUST
BE KEPT
ON JOB SITE ALL TIMES

APPROVED
TRAFFIC CONTROL PERMIT
FEB 14 2018
CITY OF SAN DIEGO
Development Services
Engineering
Traffic

LEGEND

- SIGN
- TRAFFIC CONES / DELINEATOR
- I BARRICADE
- ⚑ FLAGGER
- ▨ FLASHING ARROW SIGN
- ▨ WORK ZONE
- 🚌 BUS STOP

NOTE: CONTRACTOR WILL COORDINATE ALL WORK WITH FIRE STATION PRIOR TO START OF WORK

NOTE: CONTRACTOR WILL COORDINATE ALL WORK WITH TRANSIT DEPARTMENT 5 DAYS PRIOR TO START OF WORK

NOTE: CONTRACTOR WILL COORDINATE ALL WORK WITH EXISTING PROJECTS AND NOT CONFLICT WITH EXISTING TRAFFIC CONTROL

NOTE: FLAGGERS WILL PROVIDE ACCESS TO DRIVEWAYS AT ALL TIMES

NOTE: FLAGGERS WILL SAFELY GUIDE PEDESTRIANS THROUGH WORK AREA

NOTE: CONTRACTOR WILL ALLOW FIRE STATION INGRESS AND EGRESS AT ALL TIMES

NOTE: WB-24 (STEEL PLATES AHEAD) SIGNS WILL REMAIN IN PLACE FOR DURATION OF WORK

DETAIL: FLAGGER ACCESS

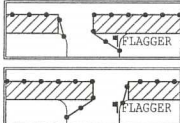

NOTE: DRIVEWAY ACCESS WILL BE PROVIDED AT ALL TIMES WORK WILL BE SPLIT TO PROVIDE ACCESS

NOTE: NO WORK IN STREET WHILE SCHOOL CHILDREN ARE PRESENT

WORK HOURS: _____ TO _____

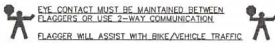

UTILITY SURVEYORS, INC.
AIRX
Gail McMorran
President
2534 EAST EL NORTE PARKWAY, SUITE C
ESCONDIDO, CA 92027
PHONE: (760) 480-2347
CELL: (760) 419-3738

PROJECT NAME: TL23071 - SYCAMORE CANYON SUBSTATION TO PENASQUITOS - 230 KV UNDERGROUND	
AIRX JOB# X160218	THOMAS GRID# 1-
TYPE OF WORK: TRENCHING / CONDUIT	DRAWN FOR: CALTRANS
MISC./POTHOLES#:	

DATE: Apr. 5, 2017
DESIGNED BY: Clint Jones
SHEET 135 OF 148

PHASE 115

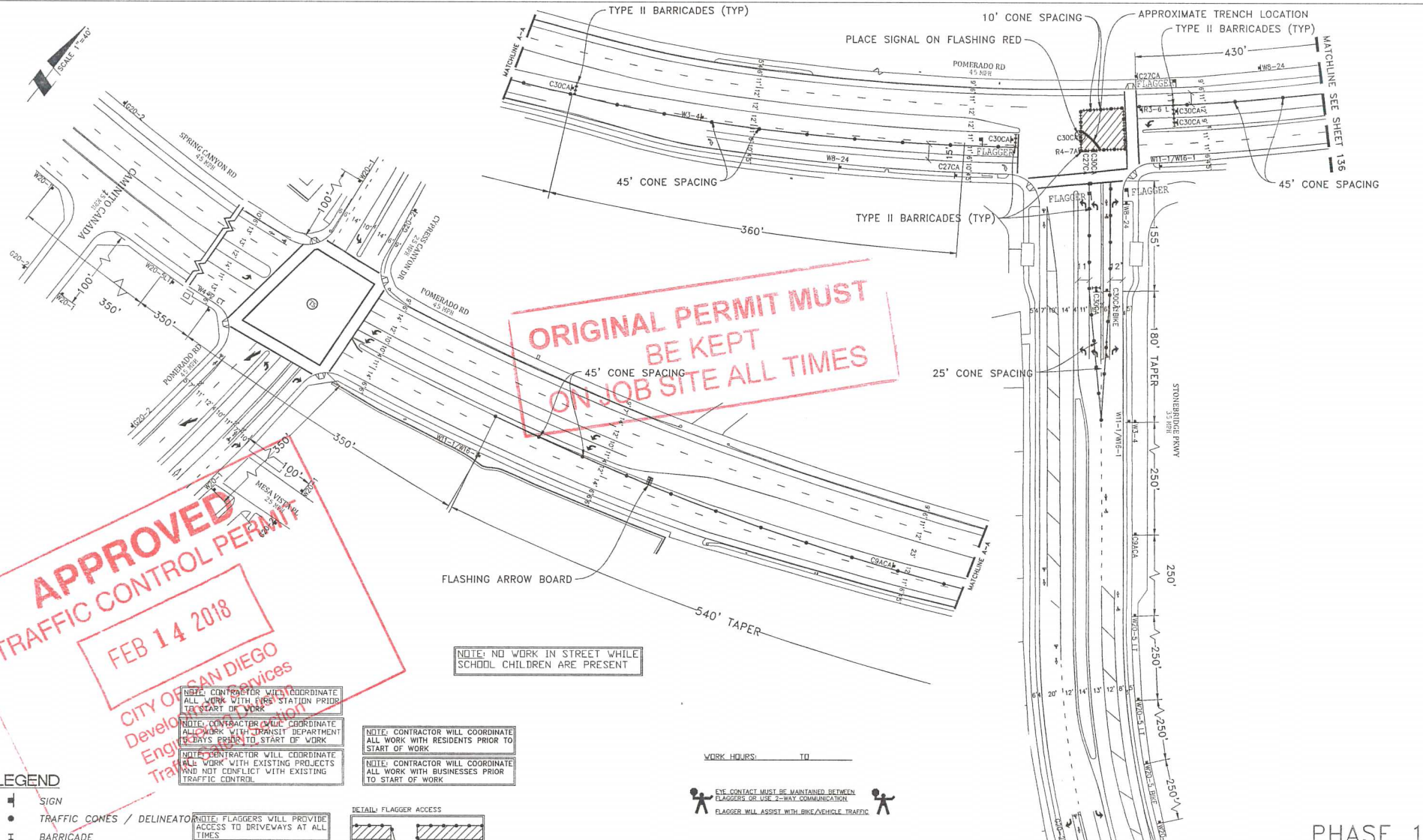



**ORIGINAL PERMIT MUST
BE KEPT
ON JOB SITE ALL TIMES**

**APPROVED
TRAFFIC CONTROL PERMIT
FEB 14 2018**
CITY OF SAN DIEGO
Engineering Services
Engineering Division
Engineering Section

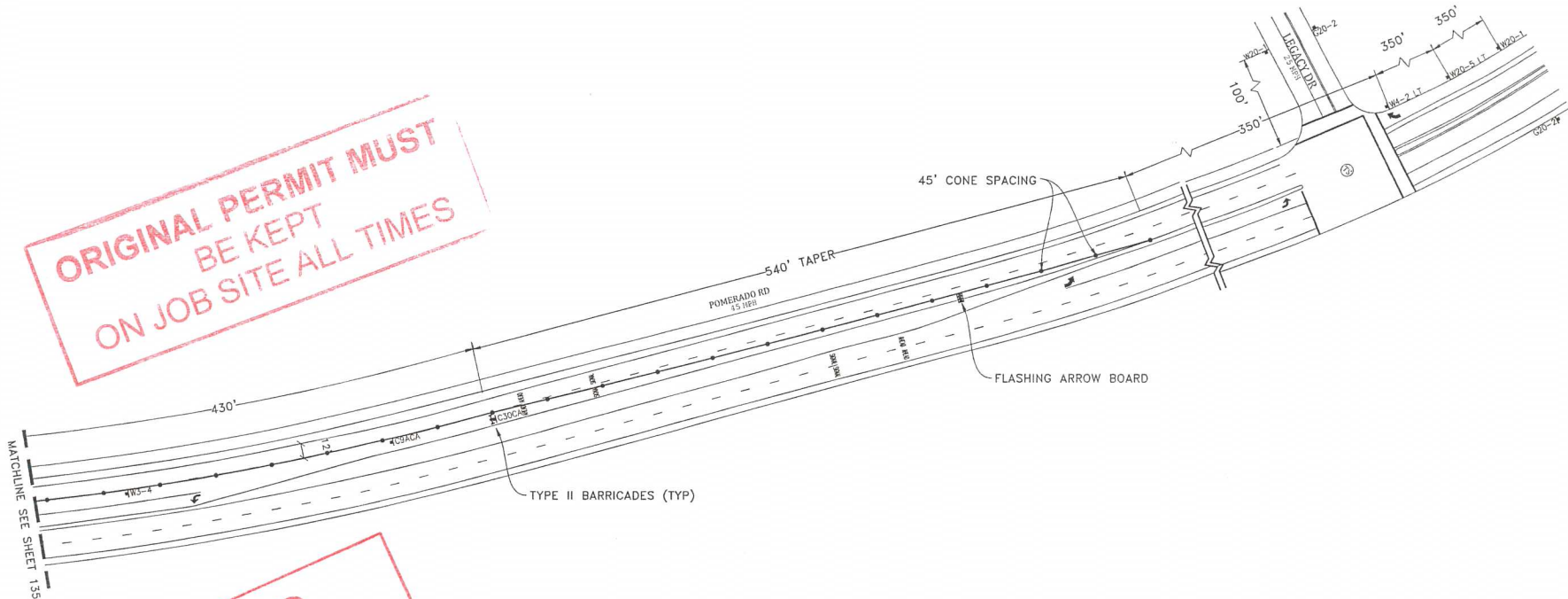

NOTE: NO WORK IN STREET WHILE SCHOOL CHILDREN ARE PRESENT

LEGEND

- SIGN
- TRAFFIC CONES / DELINEATOR
- BARRICADE
- FLAGGER
- FLASHING ARROW SIGN
- WORK ZONE
- BUS STOP

NOTE: FLAGGERS WILL PROVIDE ACCESS TO DRIVEWAYS AT ALL TIMES

NOTE: FLAGGERS WILL SAFELY GUIDE PEDESTRIANS THROUGH WORK AREA

NOTE: CONTRACTOR WILL ALLOW FIRE STATION INGRESS AND EGRESS AT ALL TIMES

NOTE: W8-24 STEEL PLATES AHEAD SIGNS WILL REMAIN IN PLACE FOR DURATION OF WORK

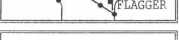

NOTE: DRIVEWAY ACCESS WILL BE PROVIDED AT ALL TIMES WORK WILL BE SPLIT TO PROVIDE ACCESS

NOTE: CONTRACTOR WILL COORDINATE ALL WORK WITH FIRE STATION PRIOR TO START OF WORK

NOTE: CONTRACTOR WILL COORDINATE ALL WORK WITH TRANSIT DEPARTMENT 5 DAYS PRIOR TO START OF WORK

NOTE: CONTRACTOR WILL COORDINATE ALL WORK WITH EXISTING PROJECTS AND NOT CONFLICT WITH EXISTING TRAFFIC CONTROL

NOTE: CONTRACTOR WILL COORDINATE ALL WORK WITH RESIDENTS PRIOR TO START OF WORK

NOTE: CONTRACTOR WILL COORDINATE ALL WORK WITH BUSINESSES PRIOR TO START OF WORK

WORK HOURS: _____ TO _____

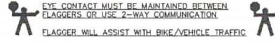

UTILITY SURVEYORS, INC.
AIRX
2534 EAST EL NORTE PARKWAY, SUITE C
ESCONDIDO, CA 92027
PHONE: (760) 460-2447
CELL: (760) 419-3738

Gail McMorran
President

PROJECT NAME: TL23071 - SYCAMORE CANYON SUBSTATION TO PENASQUITOS - 230 KV UNDERGROUND	
AIRX JOB# X160218	THOMAS GRID#:-
TYPE OF WORK: RENCHING / CONDUIT	DRAWN FOR: CALTRANS
MISC./POTHOLES#:	

PHASE 115

DATE: Mar. 23, 2017
DESIGNED BY: Clint Jones

SHEET 136 OF 148

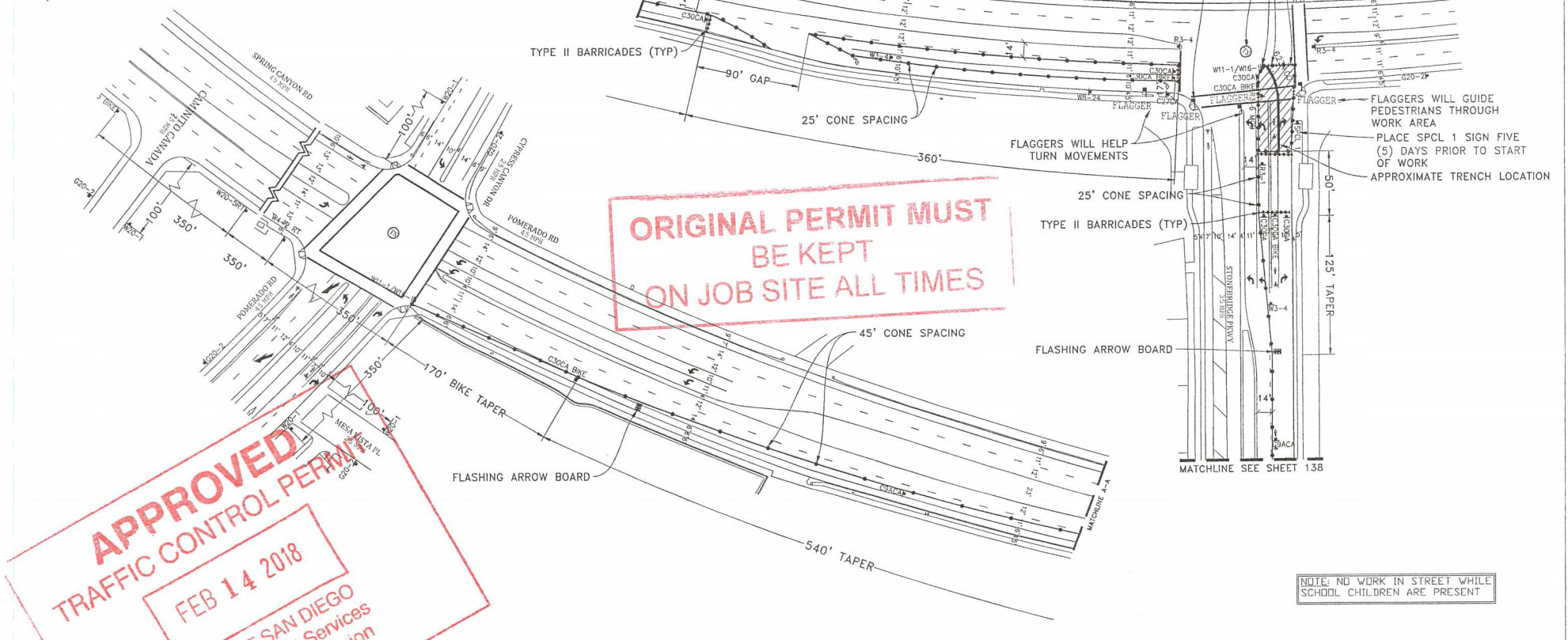

- LEGEND**
- SIGN
 - TRAFFIC CONES / DELINEATOR
 - BARRICADE
 - FLAGGER
 - FLASHING ARROW SIGN
 - WORK ZONE
 - BUS STOP

NOTE: FLAGGERS WILL PROVIDE ACCESS TO DRIVEWAYS AT ALL TIMES

NOTE: FLAGGERS WILL SAFELY GUIDE PEDESTRIANS THROUGH WORK AREA

NOTE: CONTRACTOR WILL ALLOW FIRE STATION INGRESS AND EGRESS AT ALL TIMES

NOTE: WB-24 (STEEL PLATES AHEAD) SIGNS WILL REMAIN IN PLACE FOR DURATION OF WORK

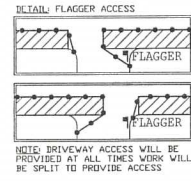

NOTE: CONTRACTOR WILL COORDINATE ALL WORK WITH FIRE STATION PRIOR TO START OF WORK

NOTE: CONTRACTOR WILL COORDINATE ALL WORK WITH TRANSIT DEPARTMENT 5 DAYS PRIOR TO START OF WORK

NOTE: CONTRACTOR WILL COORDINATE ALL WORK WITH EXISTING PROJECTS AND NOT CONFLICT WITH EXISTING TRAFFIC CONTROL

NOTE: CONTRACTOR WILL COORDINATE ALL WORK WITH RESIDENTS PRIOR TO START OF WORK

NOTE: CONTRACTOR WILL COORDINATE ALL WORK WITH BUSINESSES PRIOR TO START OF WORK

WORK HOURS: _____ TO _____

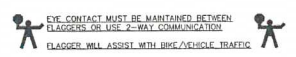

NOTE: NO WORK IN STREET WHILE SCHOOL CHILDREN ARE PRESENT

UTILITY SURVEYORS, INC.

AIRX

Gail McMorran
President

2534 EAST EL NORTE PARKWAY, SUITE C
ESCONDIDO, CA 92027
PHONE: (760) 480-2347
CELL: (760) 419-0738

PROJECT NAME: TL23071 - SYCAMORE CANYON SUBSTATION TO	
PENASQUITOS - 230 KV UNDERGROUND	
AIRX JOB#: X160218	THOMAS GRID#: -
TYPE OF WORK: TRENCHING / CONDUIT	DRAWN FOR: CALTRANS
MISC./POTHOLES#:	

PHASE 116

DATE: Mar. 24, 2017

DESIGNED BY: Clint Jones

SHEET 137 OF 148

SCALE 1"=40'

**ORIGINAL PERMIT MUST
BE KEPT
ON JOB SITE ALL TIMES**

**APPROVED
TRAFFIC CONTROL PERMIT
FEB 14 2018**

CITY OF SAN DIEGO
Development Services
Engineering Division
Traffic Safety Section

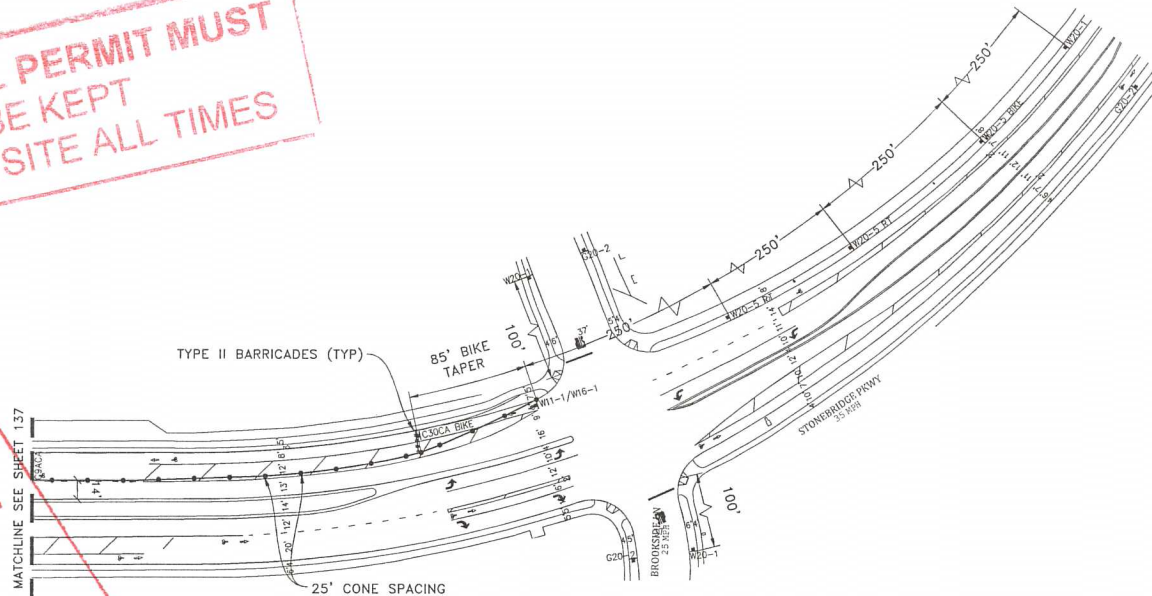

NOTE: NO WORK IN STREET WHILE SCHOOL CHILDREN ARE PRESENT

LEGEND

- SIGN
- TRAFFIC CONES / DELINEATOR
- BARRICADE
- FLAGGER
- FLASHING ARROW, SIGN
- WORK ZONE
- BUS STOP

NOTE: FLAGGERS WILL PROVIDE ACCESS TO DRIVEWAYS AT ALL TIMES

NOTE: FLAGGERS WILL SAFELY GUIDE PEDESTRIANS THROUGH WORK AREA

NOTE: CONTRACTOR WILL ALLOW FIRE STATION INGRESS AND EGRESS AT ALL TIMES

NOTE: W8-24 STEEL PLATES AHEAD SIGNS WILL REMAIN IN PLACE FOR DURATION OF WORK

DETAIL: FLAGGER ACCESS

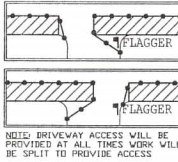

NOTE: CONTRACTOR WILL COORDINATE ALL WORK WITH FIRE STATION PRIOR TO START OF WORK

NOTE: CONTRACTOR WILL COORDINATE ALL WORK WITH TRANSIT DEPARTMENT 5 DAYS PRIOR TO START OF WORK

NOTE: CONTRACTOR WILL COORDINATE ALL WORK WITH EXISTING PROJECTS AND NOT CONFLICT WITH EXISTING TRAFFIC CONTROL

NOTE: CONTRACTOR WILL COORDINATE ALL WORK WITH RESIDENTS PRIOR TO START OF WORK

NOTE: CONTRACTOR WILL COORDINATE ALL WORK WITH BUSINESSES PRIOR TO START OF WORK

WORK HOURS: _____ TO _____

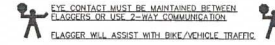

UTILITY SURVEYORS, INC.

Gail McMorran
President

2534 EAST EL NORTE PARKWAY, SUITE C
ESCONDIDO, CA 92027
PHONE: (760) 480-2347
CELL: (760) 419-3738

PROJECT NAME: TL23071 - SYCAMORE CANYON SUBSTATION TO PENASQUITOS - 230 KV UNDERGROUND

AIRX JOB# X160218

THOMAS GRID#:-

TYPE OF WORK: FENCING / CONDUIT

DRAWN FOR: CALTRANS

MISC./POTHOLE#:

PHASE 116

DATE: Mar. 1, 2017
DESIGNED BY:
Clint Jones

SHEET 138 OF 148

SCALE 1"=40'

**ORIGINAL PERMIT MUST
BE KEPT
ON JOB SITE ALL TIMES**

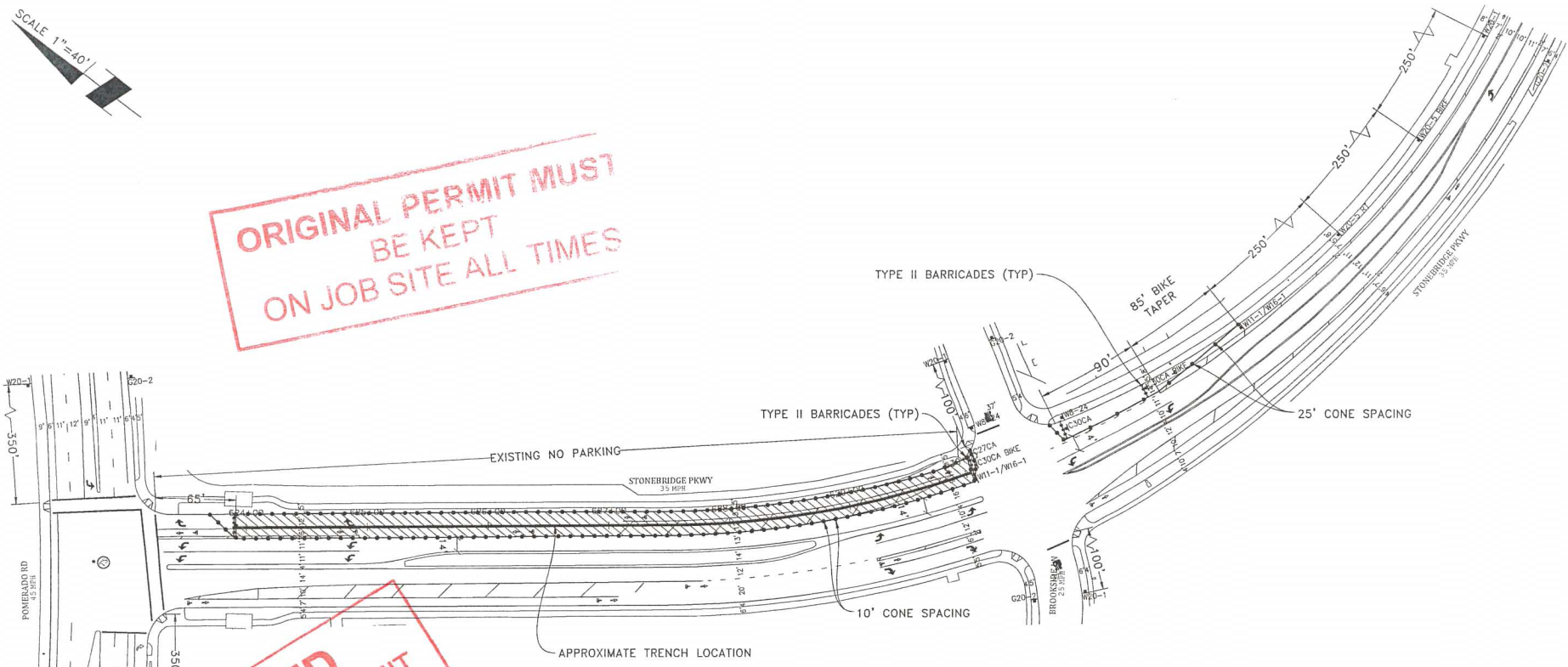

NOTE: NO WORK IN STREET WHILE SCHOOL CHILDREN ARE PRESENT

**APPROVED
TRAFFIC CONTROL PERMIT
FEB 14 2018**

- LEGEND**
- SIGN
 - TRAFFIC CONES / DELINEATOR
 - BARRICADE
 - FLAGGER
 - FLASHING ARROW SIGN
 - WORK ZONE
 - BUS STOP

NOTE: FLAGGERS WILL PROVIDE ACCESS TO DRIVEWAYS AT ALL TIMES

NOTE: FLAGGERS WILL SWEEP/GUIDE PEDESTRIANS THROUGH WORK AREA

NOTE: CONTRACTOR WILL ALLOW FIRE STATION INGRESS AND EGRESS AT ALL TIMES

NOTE: WB-24 STEEL PLATES AHEAD SIGNS WILL REMAIN IN PLACE FOR DURATION OF WORK

DETAIL: FLAGGER ACCESS

NOTE: BRIDGEWAY ACCESS WILL BE PROVIDED AT ALL TIMES WORK WILL BE SPLIT TO PROVIDE ACCESS

NOTE: CONTRACTOR WILL COORDINATE ALL WORK WITH FIRE STATION PRIOR TO START OF WORK

NOTE: CONTRACTOR WILL COORDINATE ALL WORK WITH TRANSIT DEPARTMENT 5 DAYS PRIOR TO START OF WORK

NOTE: CONTRACTOR WILL COORDINATE ALL WORK WITH EXISTING PROJECTS AND NOT CONFLICT WITH EXISTING TRAFFIC CONTROL

NOTE: CONTRACTOR WILL COORDINATE ALL WORK WITH RESIDENTS PRIOR TO START OF WORK

NOTE: CONTRACTOR WILL COORDINATE ALL WORK WITH BUSINESSES PRIOR TO START OF WORK

WORK HOURS: _____ TO _____

EYE CONTACT MUST BE MAINTAINED BETWEEN FLAGGERS OR USE 2-WAY COMMUNICATION
FLAGGER WILL ASSIST WITH BIKE/VEHICLE TRAFFIC

UTILITY SURVEYORS, INC.
AIRX
Gail McMorran
President
2534 EAST EL NORTE PARKWAY, SUITE C
ESCONDIDO, CA 92027
PHONE: (760) 480-2347
CELL: (760) 418-3738

PROJECT NAME: TL23071 - SYCAMORE CANYON SUBSTATION TO PENASQUITOS - 230 KV UNDERGROUND		DATE: Mar. 24, 2017
AIRX JOB#: X160218	THOMAS GRID#:-	DESIGNED BY: Clint Jones
TYPE OF WORK: TRENCHING / CONDUIT	DRAWN FOR: CALTRANS	
MISC./POTHOLE#:		SHEET 139 OF 148

PHASE 117

SCALE 1"=40'

ORIGINAL PERMIT MUST BE KEPT ON JOB SITE ALL TIMES

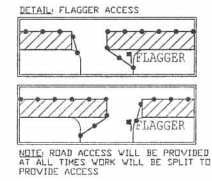
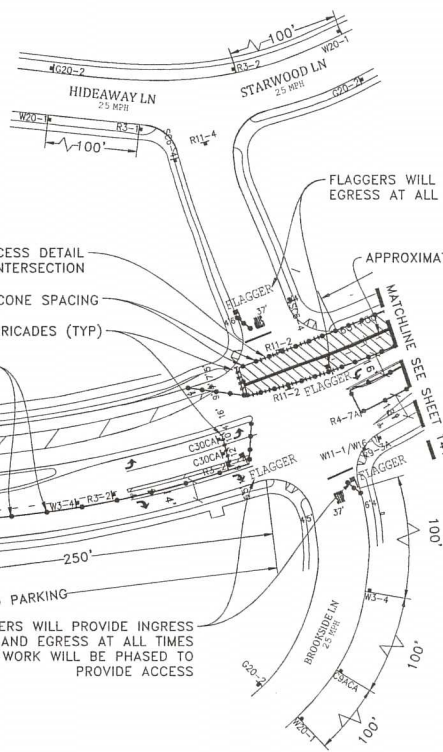
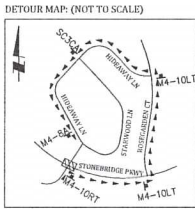

NOTE: NO WORK IN STREET WHILE SCHOOL CHILDREN ARE PRESENT

APPROVED
TRAFFIC CONTROL PERMIT
FEB 14 2018

City of San Diego
 Engineering Services
 Engineering Division
 Traffic Safety Section

- LEGEND**
- SIGN
 - TRAFFIC CONES / DELINEATOR
 - I BARRICADE
 - ⚠ FLAGGER
 - ⚡ FLASHING ARROW SIGN
 - ▨ WORK ZONE
 - 🚌 BUS STOP

NOTE: FLAGGERS WILL PROVIDE ACCESS TO DRIVEWAYS AT ALL TIMES

NOTE: FLAGGERS WILL SAFELY GUIDE PEDESTRIANS THROUGH WORK AREA

NOTE: CONTRACTOR WILL ALLOW FIRE STATION INGRESS AND EGRESS AT ALL TIMES

NOTE: W8-24 STEEL PLATES AHEAD SIGNS WILL REMAIN IN PLACE FOR DURATION OF WORK

NOTE: CONTRACTOR WILL COORDINATE ALL WORK WITH FIRE STATION PRIOR TO START OF WORK

NOTE: CONTRACTOR WILL COORDINATE ALL WORK WITH TRANSIT DEPARTMENT 5 DAYS PRIOR TO START OF WORK

NOTE: CONTRACTOR WILL COORDINATE ALL WORK WITH EXISTING PROJECTS AND NOT CONFLICT WITH EXISTING TRAFFIC CONTROL

NOTE: CONTRACTOR WILL COORDINATE ALL WORK WITH RESIDENTS PRIOR TO START OF WORK

NOTE: CONTRACTOR WILL COORDINATE ALL WORK WITH BUSINESSES PRIOR TO START OF WORK

WORK HOURS: _____ TO _____

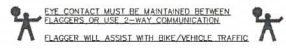

UTILITY SURVEYORS, INC.
AIRX
 Gail McMorran
 President
 2534 EAST EL NORTE PARKWAY, SUITE C
 ESCROWDO, CA 92027
 PHONE: (760) 450-2347
 CELL: (760) 419-3738

PROJECT NAME: TL23071 - SYCAMORE CANYON SUBSTATION TO PENASQUITOS - 230 KV UNDERGROUND	
AIRX JOB#: X160218	THOMAS GRID#:-
TYPE OF WORK: RENCHING / CONDUIT	DRAWN FOR: CALTRANS
MISC/POTHOLE#:	

PHASE 118

DATE: Mar. 24, 2017
 DESIGNED BY: Clint Jones

SHEET 140 OF 148



**ORIGINAL PERMIT MUST
BE KEPT
ON JOB SITE ALL TIMES**

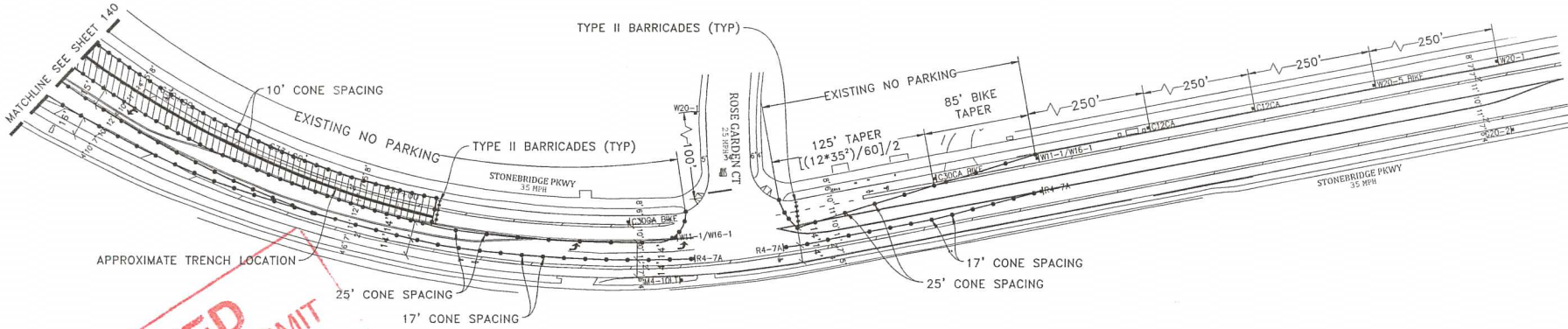
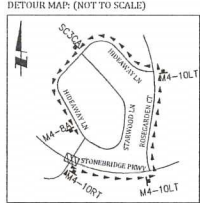

NOTE: NO WORK IN STREET WHILE SCHOOL CHILDREN ARE PRESENT

LEGEND

- SIGN
- TRAFFIC CONES / DELINEATOR
- BARRICADE
- FLAGGER
- FLASHING ARROW SIGN
- WORK ZONE
- BUS STOP

NOTE: FLAGGERS WILL PROVIDE ACCESS TO DRIVEWAYS AT ALL TIMES

NOTE: FLAGGERS WILL SAFELY TURN TRAFFIC AROUND WORK AREA

NOTE: CONTRACTOR WILL ALLOW FIRE STATION INGRESS AND EGRESS AT ALL TIMES

NOTE: W8-24 (STEEL PLATES) AHEAD SIGNS WILL REMAIN IN PLACE FOR DURATION OF WORK

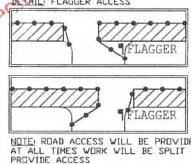

NOTE: ROAD ACCESS WILL BE PROVIDED AT ALL TIMES WORK WILL BE SPLIT TO PROVIDE ACCESS

NOTE: CONTRACTOR WILL COORDINATE ALL WORK WITH FIRE STATION PRIOR TO START OF WORK

NOTE: CONTRACTOR WILL COORDINATE ALL WORK WITH TRANSIT DEPARTMENT 5 DAYS PRIOR TO START OF WORK

NOTE: CONTRACTOR WILL COORDINATE ALL WORK WITH EXISTING PROJECTS AND NOT CONFLICT WITH EXISTING TRAFFIC CONTROL.

NOTE: CONTRACTOR WILL COORDINATE ALL WORK WITH RESIDENTS PRIOR TO START OF WORK

NOTE: CONTRACTOR WILL COORDINATE ALL WORK WITH BUSINESSES PRIOR TO START OF WORK

WORK HOURS: _____ TO _____

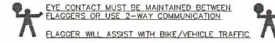

AIRX SURVEYORS, INC.
AIRX
 Gail McMorran
 President
 2534 EAST EL NORTE PARKWAY, SUITE C
 ESCONDIDO, CA 92027
 PHONE: (760) 480-2347
 CELL: (760) 419-3738

PROJECT NAME: TL23071 - SYCAMORE CANYON SUBSTATION TO PENASQUITOS - 230 KV UNDERGROUND		DATE: Mar. 1, 2017
AIRX JOB#: X160218	THOMAS GRID#:	DESIGNED BY: Clint Jones
TYPE OF WORK: RENCHING / CONDUIT	DRAWN FOR: CALTRANS	
MISC/POTHOLE#:		SHEET 141 OF 148

PHASE 118

SCALE 1"=40'

ORIGINAL PERMIT MUST BE KEPT ON JOB SITE ALL TIMES

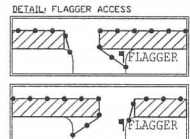

NOTE: ROAD ACCESS WILL BE PROVIDED AT ALL TIMES WORK WILL BE SPLIT TO PROVIDE ACCESS

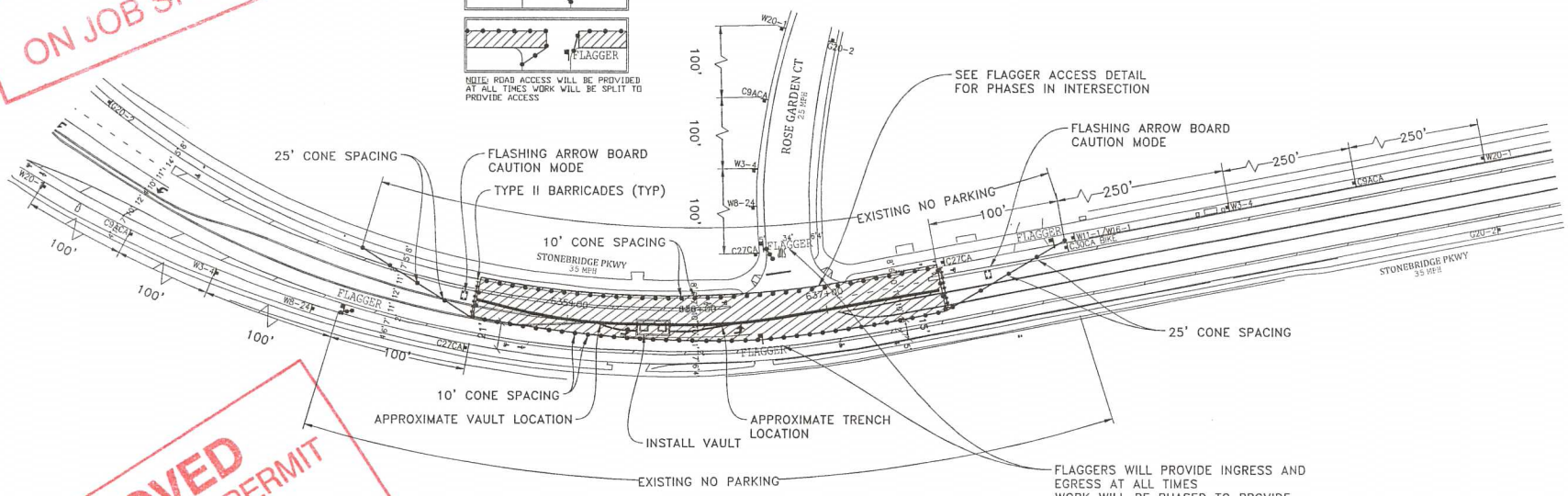

SEE FLAGGER ACCESS DETAIL FOR PHASES IN INTERSECTION

FLASHING ARROW BOARD CAUTION MODE

FLAGGERS WILL PROVIDE INGRESS AND EGRESS AT ALL TIMES WORK WILL BE PHASED TO PROVIDE ACCESS

NOTE: NO WORK IN STREET WHILE SCHOOL CHILDREN ARE PRESENT

- LEGEND**
- SIGN
 - TRAFFIC CONES / DELINEATOR
 - I BARRICADE
 - FLAGGER
 - ◄◄ FLASHING ARROW SIGN
 - ▨ WORK ZONE
 - 🚌 BUS STOP

NOTE: FLAGGERS WILL PROVIDE ACCESS TO DRIVEWAYS AT ALL TIMES

NOTE: FLAGGERS WILL SOLELY GUIDE PEDESTRIANS THROUGH WORK AREA

NOTE: CONTRACTOR WILL ALLOW FIRE STATION INGRESS AND EGRESS AT ALL TIMES

NOTE: W8-24 STEEL PLATES ARMED SIGNS WILL REMAIN IN PLACE FOR DURATION OF WORK

NOTE: CONTRACTOR WILL COORDINATE ALL WORK WITH FIRE STATION PRIOR TO START OF WORK

NOTE: CONTRACTOR WILL COORDINATE ALL WORK WITH TRANSIT DEPARTMENT 5 DAYS PRIOR TO START OF WORK

NOTE: CONTRACTOR WILL COORDINATE ALL WORK WITH EXISTING PROJECTS AND NOT CONFLICT WITH EXISTING TRAFFIC CONTROL

NOTE: CONTRACTOR WILL COORDINATE ALL WORK WITH RESIDENTS PRIOR TO START OF WORK

NOTE: CONTRACTOR WILL COORDINATE ALL WORK WITH BUSINESSES PRIOR TO START OF WORK

WORK HOURS: _____ TO _____

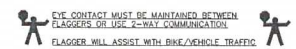

APPROVED
TRAFFIC CONTROL PERMIT
FEB 14 2018
CITY OF SAN DIEGO
Public Safety Division
Traffic Control Section

UTILITY SURVEYORS, INC.
AIRX
Gail McMorran
President
2534 EAST EL NORTE PARKWAY, SUITE C
ESCONDIDO, CA 92027
PHONE: (760) 480-2947
CELL: (760) 419-3738

PROJECT NAME: TL23071 - SYCAMORE CANYON SUBSTATION TO PENASQUITOS - 230 KV UNDERGROUND		DATE: Mar. 24, 2017
AIRX JOB#: X160218	THOMAS GRID#:-	DESIGNED BY: Clint Jones
TYPE OF WORK: RENCHING / CONDUIT	DRAWN FOR: CALTRANS	
MISC./POTHOLES#:		SHEET 142 OF 148

PHASE 119



SCALE 1"=40'

ORIGINAL PERMIT MUST BE KEPT ON JOB SITE ALL TIMES

APPROVED TRAFFIC CONTROL PERMIT
FEB 14 2018
 CITY OF SAN DIEGO
 Development Services
 Engineering Division
 Traffic Safety Section

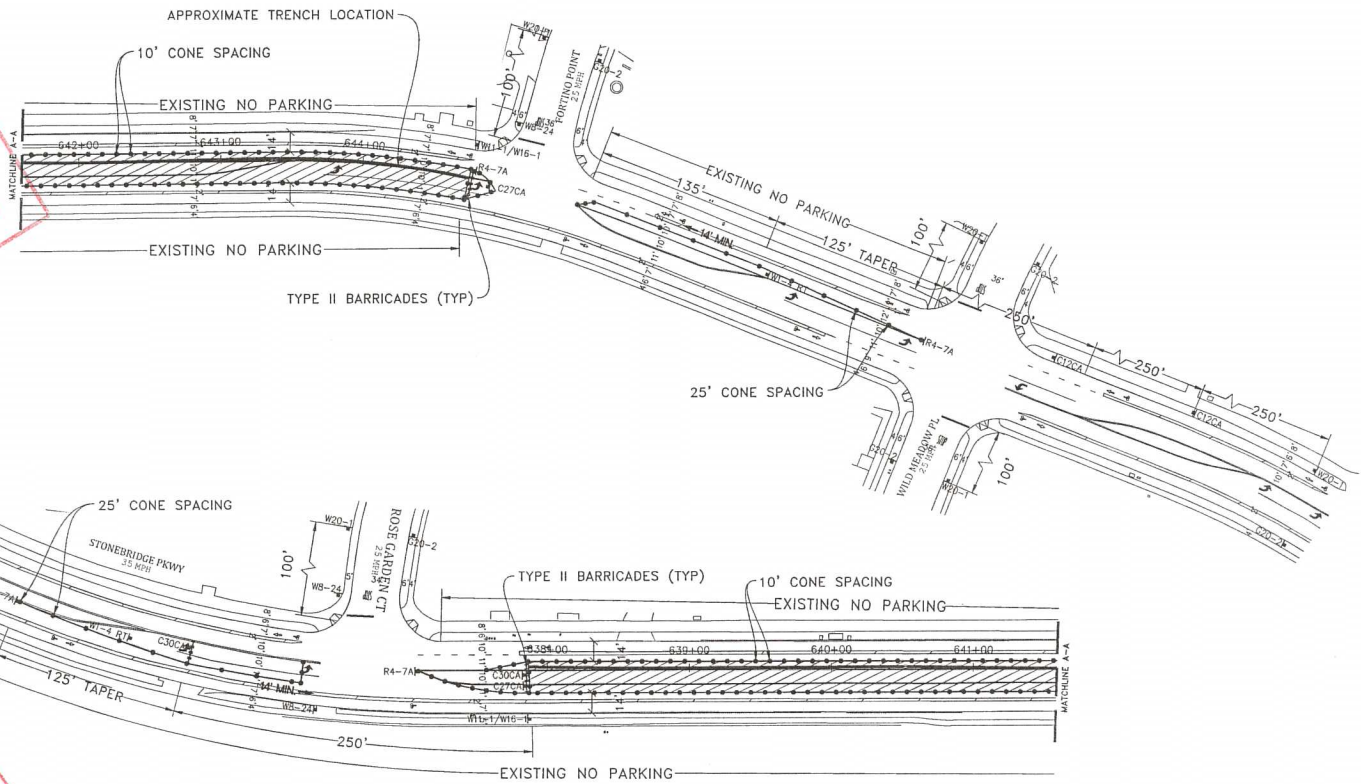

- LEGEND**
- SIGN
 - TRAFFIC CONES
 - BARRICADE
 - FLAGGER
 - FLASHING ARROW SIGN
 - WORK ZONE
 - BUS STOP

NOTE: NO WORK IN STREET WHILE SCHOOL CHILDREN ARE PRESENT

NOTE: FLAGGERS WILL PROVIDE ACCESS TO DRIVEWAYS AT ALL TIMES

NOTE: FLAGGERS WILL SAFELY GUIDE PEDESTRIANS THROUGH WORK AREA

NOTE: CONTRACTOR WILL ALLOW FIRE STATION INGRESS AND EGRESS AT ALL TIMES

NOTE: W8-24 (STEEL PLATES AHEAD) SIGNS WILL REMAIN IN PLACE FOR DURATION OF WORK

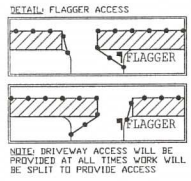

NOTE: CONTRACTOR WILL COORDINATE ALL WORK WITH FIRE STATION PRIOR TO START OF WORK

NOTE: CONTRACTOR WILL COORDINATE ALL WORK WITH TRANSIT DEPARTMENT 5 DAYS PRIOR TO START OF WORK

NOTE: CONTRACTOR WILL COORDINATE ALL WORK WITH EXISTING PROJECTS AND NOT CONFLICT WITH EXISTING TRAFFIC CONTROL

NOTE: CONTRACTOR WILL COORDINATE ALL WORK WITH RESIDENTS PRIOR TO START OF WORK

NOTE: CONTRACTOR WILL COORDINATE ALL WORK WITH BUSINESSES PRIOR TO START OF WORK

WORK HOURS: _____ TO _____

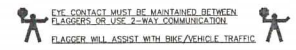

UTILITY SURVEYORS, INC.
AIRX
 Gail McMorran
 President
 2534 EAST EL NORTE PARKWAY, SUITE C
 ESCONCADO, CA 92027
 PHONE: (760) 480-2347
 CELL: (760) 419-3738

PROJECT NAME: TL23071 - SYCAMORE CANYON SUBSTATION TO PENASQUITOS - 230 KV UNDERGROUND	
AIRX JOB# X160218	THOMAS GRID#:-
TYPE OF WORK: TRENCHING / CONDUIT	DRAWN FOR: CALTRANS
MISC./POTHOLES#:	

PHASE 120
 DATE: Mar. 1, 2017
 DESIGNED BY: Clint Jones
 SHEET 143 OF 148

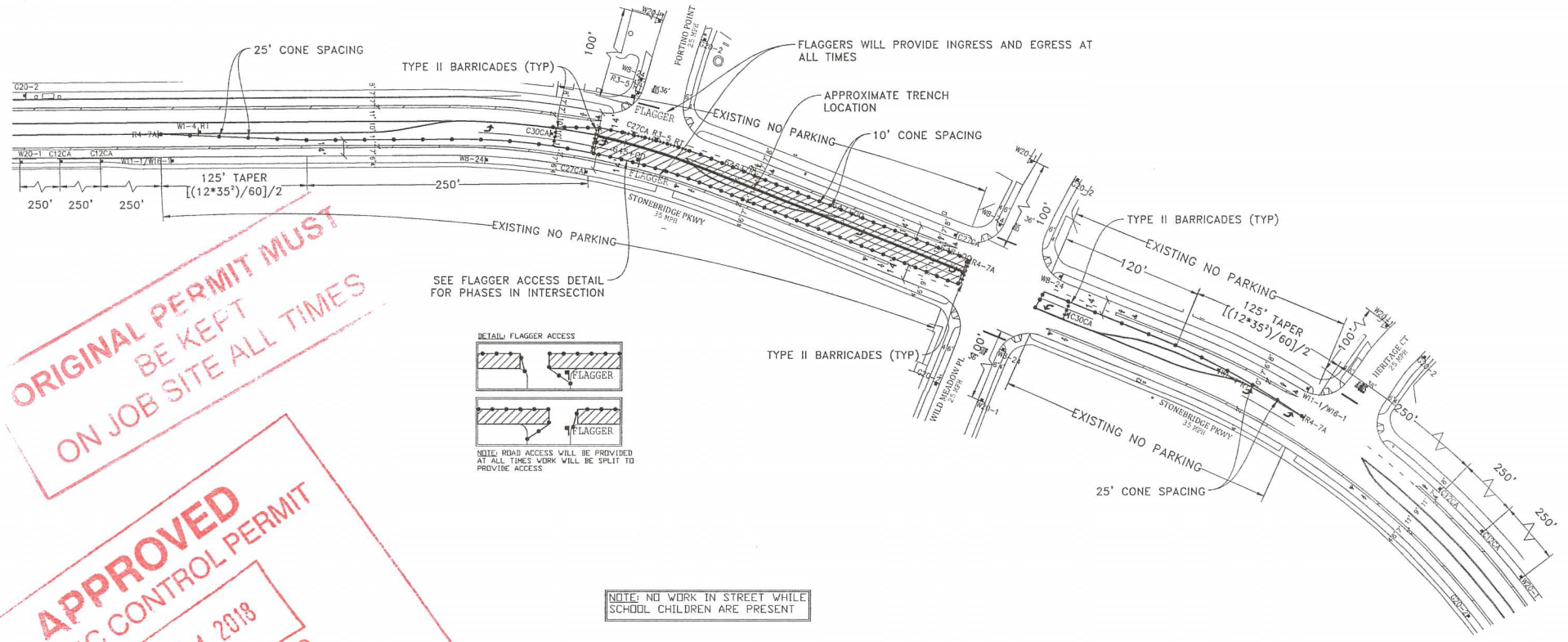

ORIGINAL PERMIT MUST BE KEPT ON JOB SITE ALL TIMES

APPROVED TRAFFIC CONTROL PERMIT
FEB 14 2018
 CITY OF SAN DIEGO
 Development Services
 Engineering Division
 Safety Section

SEE FLAGGER ACCESS DETAIL FOR PHASES IN INTERSECTION

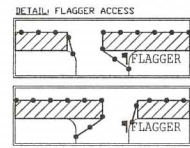

NOTE: ROAD ACCESS WILL BE PROVIDED AT ALL TIMES WORK WILL BE SPLIT TO PROVIDE ACCESS

NOTE: NO WORK IN STREET WHILE SCHOOL CHILDREN ARE PRESENT

NOTE: CONTRACTOR WILL COORDINATE ALL WORK WITH FIRE STATION PRIOR TO START OF WORK

NOTE: CONTRACTOR WILL COORDINATE ALL WORK WITH TRANSIT DEPARTMENT 5 DAYS PRIOR TO START OF WORK

NOTE: CONTRACTOR WILL COORDINATE ALL WORK WITH EXISTING PROJECTS AND NOT CONFLICT WITH EXISTING TRAFFIC CONTROL

NOTE: CONTRACTOR WILL COORDINATE ALL WORK WITH RESIDENTS PRIOR TO START OF WORK

NOTE: CONTRACTOR WILL COORDINATE ALL WORK WITH BUSINESSES PRIOR TO START OF WORK

WORK HOURS: _____ TO _____

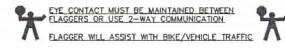

- LEGEND**
- SIGN
 - TRAFFIC CONES / DELINEATOR
 - I BARRICADE
 - ⚑ FLAGGER
 - ↔ FLASHING ARROW SIGN
 - ▨ WORK ZONE
 - 🚌 BUS STOP

NOTE: FLAGGERS WILL PROVIDE ACCESS TO DRIVEWAYS AT ALL TIMES

NOTE: FLAGGERS WILL SAFELY GUIDE PEDESTRIANS THROUGH WORK AREA

NOTE: CONTRACTOR WILL ALLOW FIRE STATION INGRESS AND EGRESS AT ALL TIMES

NOTE: WB-24 STEEL PLATES AHEAD SIGNS WILL REMAIN IN PLACE FOR DURATION OF WORK

UTILITY SURVEYORS, INC.

 Gail McMorran
 President
 2534 EAST EL NORTE PARKWAY, SUITE C
 ESCONDIDO, CA 92027
 PHONE: (760) 490-2347
 CELL: (760) 419-3739

PROJECT NAME: TL23071 - SYCAMORE CANYON SUBSTATION TO PENASQUITOS - 230 KV UNDERGROUND	
AIRX JOB#: X160218	THOMAS GRID#:-
TYPE OF WORK: TRENCHING / CONDUIT	DRAWN FOR: CALTRANS
MISC/POTHOLE#:	

DATE: Apr. 5, 2017
DESIGNED BY: Clint Jones
SHEET 144 OF 148

PHASE 121

SCALE 1"=60'

**ORIGINAL PERMIT MUST
BE KEPT
ON JOB SITE ALL TIMES**

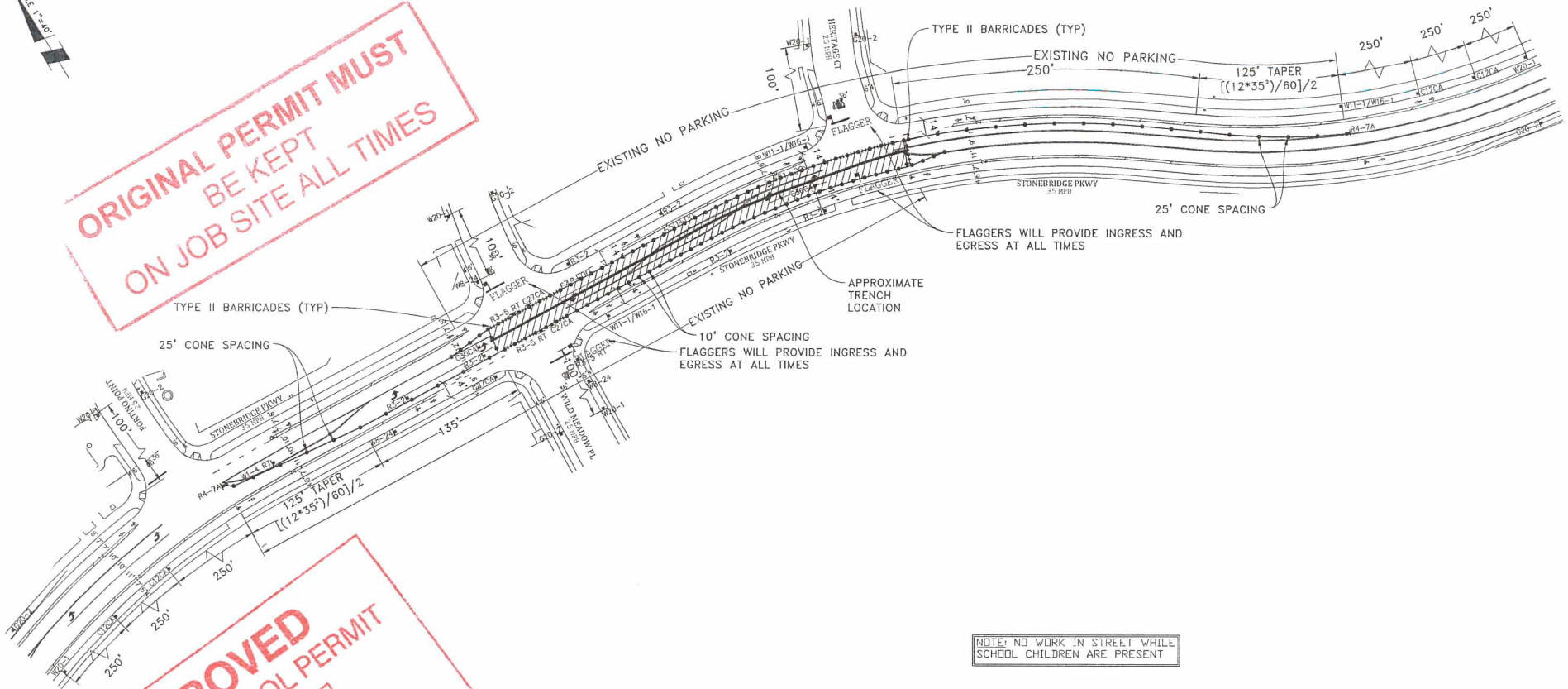

NOTE: NO WORK IN STREET WHILE SCHOOL CHILDREN ARE PRESENT

**APPROVED
TRAFFIC CONTROL PERMIT**
FEB 14 2013
CITY OF SAN DIEGO
Engineering Services
Engineering Safety Section

- LEGEND**
- SIGN
 - TRAFFIC CONES / DELINEATOR
 - BARRICADE
 - FLAGGER
 - FLASHING ARROW SIGN
 - WORK ZONE
 - BUS STOP

NOTE: FLAGGERS WILL PROVIDE ACCESS TO DRIVEWAY AT ALL TIMES
NOTE: FLAGGERS WILL SAFELY GUIDE PEDESTRIANS THROUGH WORK AREA
NOTE: CONTRACTOR WILL ALLOW FIRE STATION INGRESS AND EGRESS AT ALL TIMES
NOTE: W8-24 STEEL PLATES AHEAD SIGNS WILL REMAIN IN PLACE FOR DURATION OF WORK

NOTE: CONTRACTOR WILL COORDINATE ALL WORK WITH FIRE STATION PRIOR TO START OF WORK

NOTE: CONTRACTOR WILL COORDINATE ALL WORK WITH TRANSIT DEPARTMENT 5 DAYS PRIOR TO START OF WORK

NOTE: CONTRACTOR WILL COORDINATE ALL WORK WITH EXISTING PROJECTS AND NOT CONFLICT WITH EXISTING TRAFFIC CONTROL

NOTE: CONTRACTOR WILL COORDINATE ALL WORK WITH RESIDENTS PRIOR TO START OF WORK

NOTE: CONTRACTOR WILL COORDINATE ALL WORK WITH BUSINESSES PRIOR TO START OF WORK

WORK HOURS: _____ TO _____

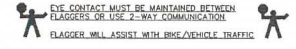

AIRX SURVEYORS, INC.
Gail McMoran
President
2534 EAST EL NORTE PARKWAY, SUITE C
ESCONDIDO, CA 92027
PHONE: (760) 480-2347
CELL: (760) 419-3738

PROJECT NAME: TL23071 - SYCAMORE CANYON SUBSTATION TO PENASQUITOS - 230 KV UNDERGROUND	
AIRX JOB# X160218	THOMAS GRID#-
TYPE OF WORK: TRENCHING / CONDUIT	DRAWN FOR: CALTRANS
MISC/POTHOLE#:	

PHASE 122
DATE: Apr. 5, 2017
DESIGNED BY: Clint Jones
SHEET 145 OF 148

SCALE 1"=40'

ORIGINAL PERMIT MUST BE KEPT ON JOB SITE ALL TIMES

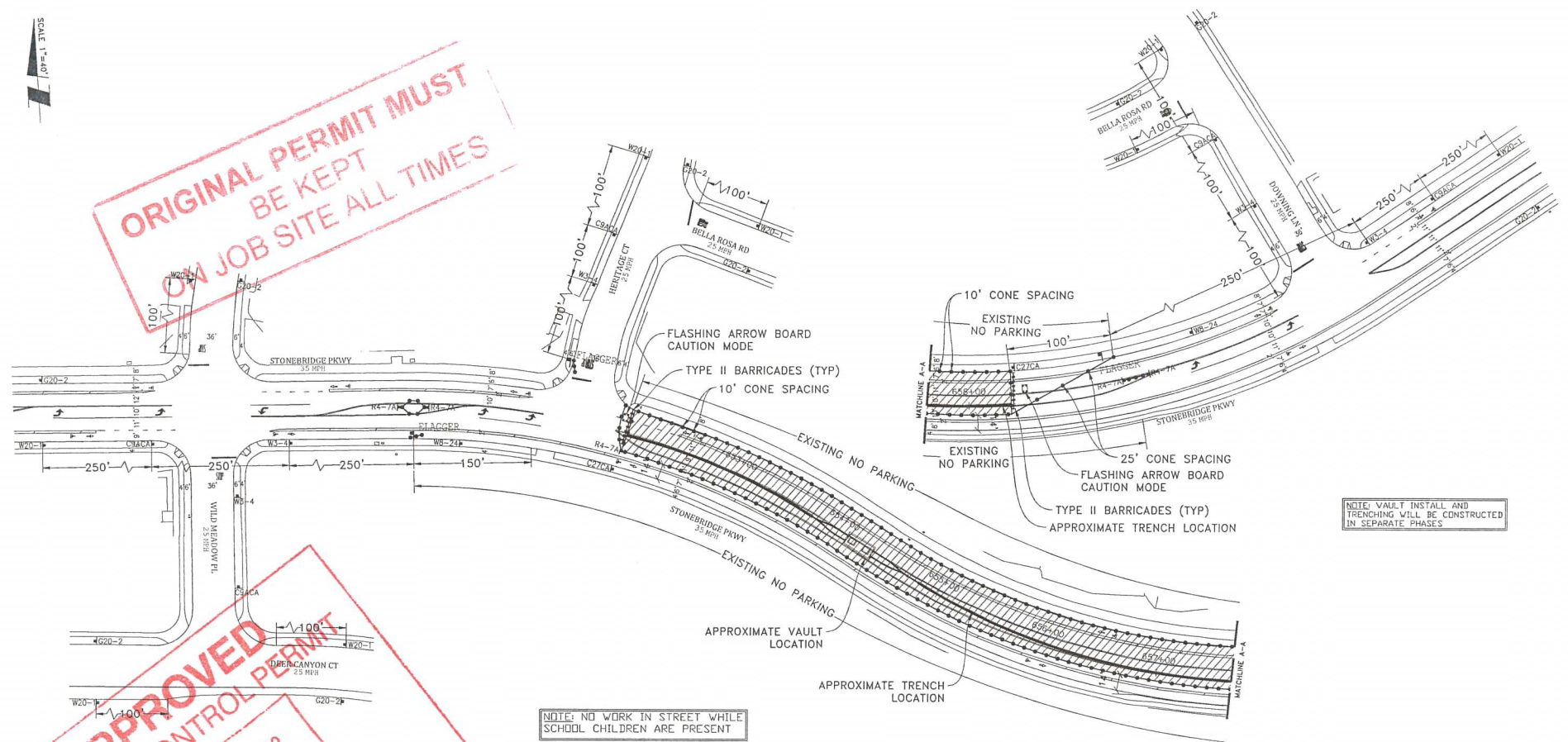

NOTE: VAULT INSTALL AND TRENCHING WILL BE CONSTRUCTED IN SEPARATE PHASES

NOTE: NO WORK IN STREET WHILE SCHOOL CHILDREN ARE PRESENT

NOTE: CONTRACTOR WILL COORDINATE ALL WORK WITH FIRE STATION PRIOR TO START OF WORK

NOTE: CONTRACTOR WILL COORDINATE ALL WORK WITH TRANSIT DEPARTMENT 5 DAYS PRIOR TO START OF WORK

NOTE: CONTRACTOR WILL COORDINATE ALL WORK WITH EXISTING PROJECTS AND NOT CONFLICT WITH EXISTING TRAFFIC CONTROL

NOTE: CONTRACTOR WILL COORDINATE ALL WORK WITH RESIDENTS PRIOR TO START OF WORK

NOTE: CONTRACTOR WILL COORDINATE ALL WORK WITH BUSINESSES PRIOR TO START OF WORK

WORK HOURS: TO

EYE CONTACT MUST BE MAINTAINED BETWEEN FLAGGERS OR USE 2-WAY COMMUNICATION. FLAGGER WILL ASSIST WITH BIKE/VEHICLE TRAFFIC.

- LEGEND**
- SIGN
 - TRAFFIC CONES / DELINEATOR
 - ▬ BARRICADE
 - ⚑ FLAGGER
 - ⚡ FLASHING ARROW SIGN
 - ▨ WORK ZONE
 - 🚌 BUS STOP

NOTE: FLAGGERS WILL PROVIDE ACCESS TO DRIVEWAYS AT ALL TIMES

NOTE: FLAGGERS WILL SAFELY GUIDE PEDESTRIANS THROUGH WORK AREA

NOTE: CONTRACTOR WILL ALLOW FIRE STATION INGRESS AND EGRESS AT ALL TIMES

NOTE: W8-24 STEEL PLATES AHEAD SIGNS WILL REMAIN IN PLACE FOR DURATION OF WORK

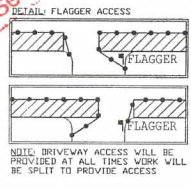

AIRX SURVEYORS, INC.
 Gail McMorran
 President
 2534 EAST ELTE PARKWAY, SUITE C
 ESCONCADO, CA 92527
 PHONE: (760) 490-2347
 CELL: (760) 419-3738

PROJECT NAME: TL23071 - SYCAMORE CANYON SUBSTATION TO PENASQUITOS - 230 KV UNDERGROUND	
AIRX JOB# X160218	THOMAS GRID#-
TYPE OF WORK: TRENCHING / CONDUIT	DRAWN FOR: CALTRANS
MISC/POTHOLE#:	

PHASE 123

DATE: Mar. 23, 2017
DESIGNED BY: Clint Jones
SHEET 146 OF 148

SCALE 1"=40'

ORIGINAL PERMIT MUST BE KEPT ON JOB SITE ALL TIMES

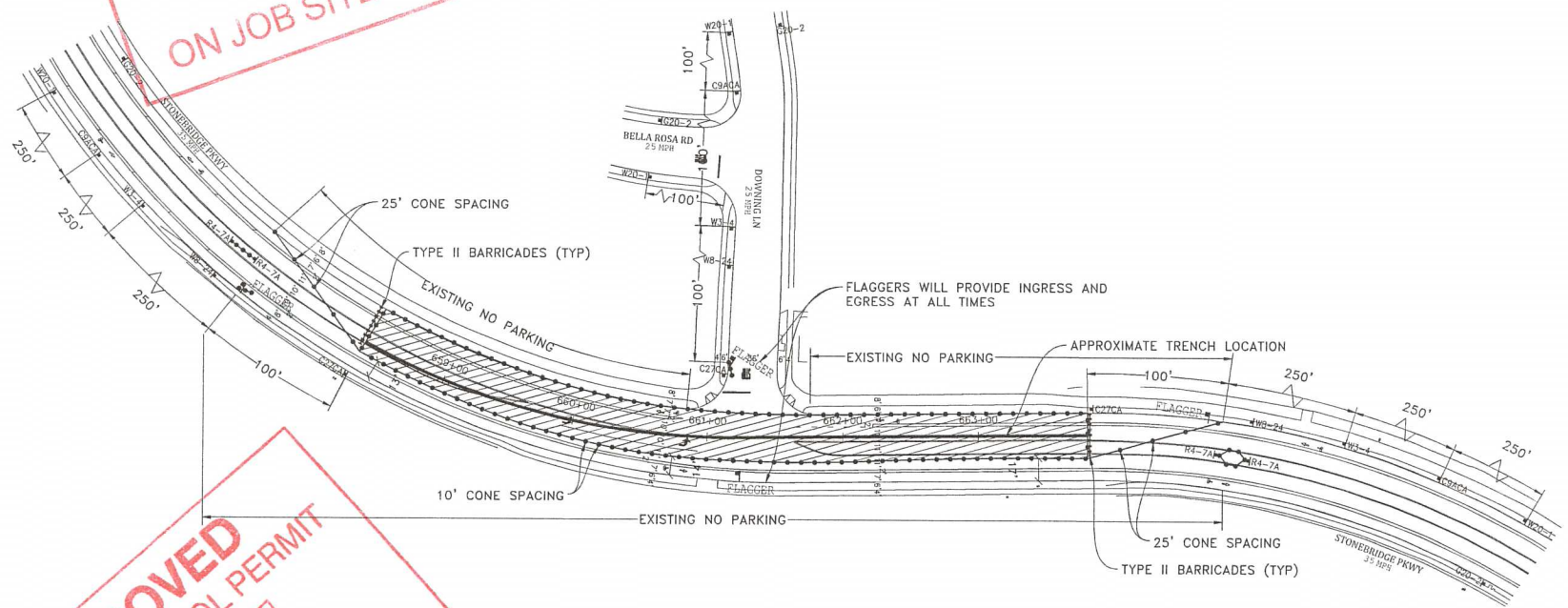

APPROVED
TRAFFIC CONTROL PERMIT
 FEB 14 2017
 SAN DIEGO
 Engineering Services
 3444 La Jolla Village Drive, Suite 100
 San Diego, CA 92161
 Phone: (619) 594-8800
 Fax: (619) 594-8801
 www.airx.com

LEGEND

- SIGN
- TRAFFIC CONES & DELINEATOR
- BARRICADE
- FLAGGER
- FLASHING ARROW SIGN
- WORK ZONE
- BUS STOP

NOTE: FLAGGERS WILL PROVIDE ACCESS TO DRIVEWAYS AT ALL TIMES

NOTE: FLAGGERS WILL SAFELY GUIDE PEDESTRIANS THROUGH WORK AREA

NOTE: CONTRACTOR WILL ALLOW FIRE STATION INGRESS AND EGRESS AT ALL TIMES

NOTE: W8-24 (STEEL PLATES AHEAD) SIGNS WILL REMAIN IN PLACE FOR DURATION OF WORK

NOTE: ROAD ACCESS WILL BE PROVIDED AT ALL TIMES WORK WILL BE SPLIT TO PROVIDE ACCESS

NOTE: CONTRACTOR WILL COORDINATE ALL WORK WITH FIRE STATION PRIOR TO START OF WORK

NOTE: CONTRACTOR WILL COORDINATE ALL WORK WITH TRANSIT DEPARTMENT 5 DAYS PRIOR TO START OF WORK

NOTE: CONTRACTOR WILL COORDINATE ALL WORK WITH EXISTING PROJECTS AND NOT CONFLICT WITH EXISTING TRAFFIC CONTROL

NOTE: CONTRACTOR WILL COORDINATE ALL WORK WITH RESIDENTS PRIOR TO START OF WORK

NOTE: CONTRACTOR WILL COORDINATE ALL WORK WITH BUSINESSES PRIOR TO START OF WORK

WORK HOURS: _____ TO _____

EYE CONTACT MUST BE MAINTAINED BETWEEN FLAGGERS OR USE 2-WAY COMMUNICATION
 FLAGGER WILL ASSIST WITH BIKE/VEHICLE TRAFFIC

UTILITY SURVEYORS, INC.
AIRX
 Gail McMorran
 President
 2534 EAST EL NORTE PARKWAY, SUITE C
 ESCONDIDO, CA 92027
 PHONE: (760) 480-2347
 CELL: (760) 419-3738

PROJECT NAME: TL23071 - SYCAMORE CANYON SUBSTATION TO PENASQUITOS - 230 KV UNDERGROUND	
AIRX JOB# X160218	THOMAS GRID#:-
TYPE OF WORK: TRENCHING / CONDUIT	DRAWN FOR: CALTRANS
MISC./POTHOLE#:	

PHASE 124
 DATE: Mar. 24, 2017
 DESIGNED BY: Clint Jones
 SHEET 147 OF 148



NOTE: VAULT INSTALL AND TRENCHING WILL BE CONSTRUCTED IN SEPARATE PHASES

ORIGINAL PERMIT MUST BE KEPT ON JOB SITE ALL TIMES

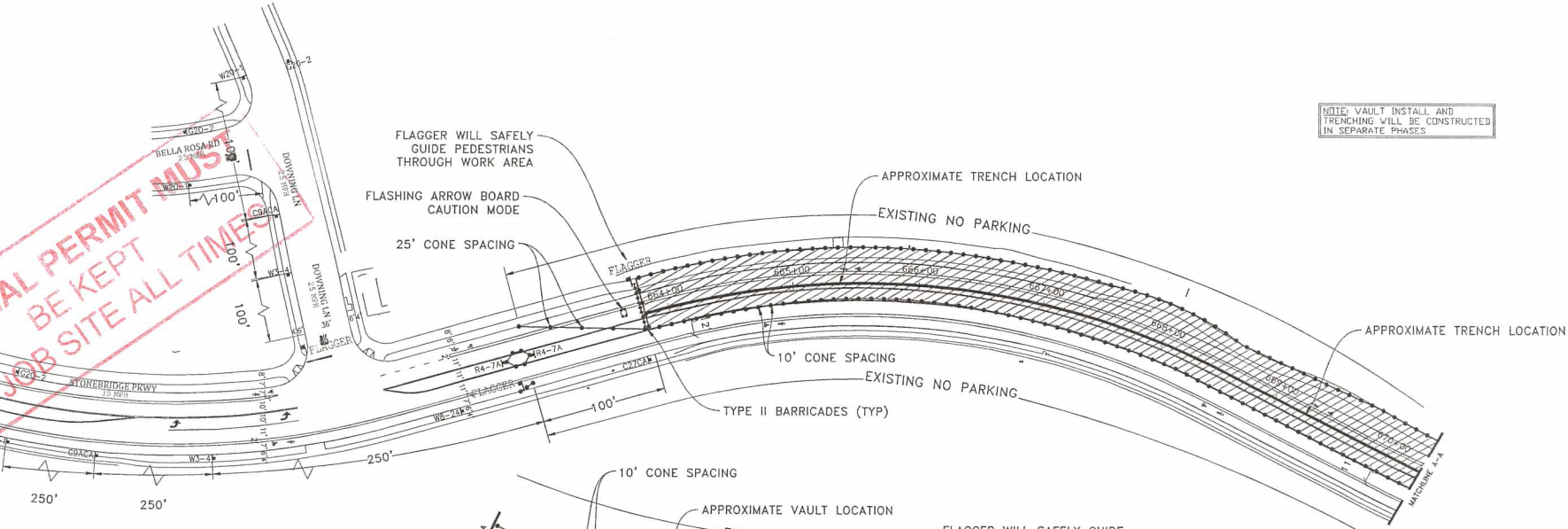

NOTE: NO WORK IN STREET WHILE SCHOOL CHILDREN ARE PRESENT

NOTE: CONTRACTOR WILL COORDINATE ALL WORK WITH FIRE STATION PRIOR TO START OF WORK

NOTE: CONTRACTOR WILL COORDINATE ALL WORK WITH TRANSIT DEPARTMENT 5 DAYS PRIOR TO START OF WORK

NOTE: CONTRACTOR WILL COORDINATE ALL WORK WITH EXISTING PROJECTS AND NOT CONFLICT WITH EXISTING TRAFFIC CONTROL

NOTE: CONTRACTOR WILL COORDINATE ALL WORK WITH RESIDENTS PRIOR TO START OF WORK

NOTE: CONTRACTOR WILL COORDINATE ALL WORK WITH BUSINESSES PRIOR TO START OF WORK

LEGEND

- SIGN
- TRAFFIC CONES / DELINEATOR
- BARRICADE
- FLAGGER
- FLASHING ARROW SIGN
- WORK ZONE
- BUS STOP

NOTE: FLAGGERS WILL PROVIDE ACCESS TO DRIVEWAYS AT ALL TIMES

NOTE: FLAGGERS WILL SAFELY GUIDE PEDESTRIANS THROUGH WORK AREA

NOTE: CONTRACTOR WILL ALLOW FIRE STATION INGRESS AND EGRESS AT ALL TIMES

NOTE: W8-24 C STEEL PLATES AHEAD SIGNS WILL REMAIN IN PLACE FOR DURATION OF WORK

DETAIL: FLAGGER ACCESS

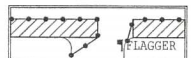

NOTE: DRIVEWAY ACCESS WILL BE PROVIDED AT ALL TIMES WORK WILL BE SPLIT TO PROVIDE ACCESS

WORK HOURS: TO

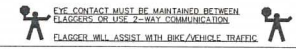

UTILITY SURVEYORS, INC.
AIRX
 Gail McMorran
 President
 2534 EAST EL NORTE PARKWAY, SUITE C
 ESCONDIDO, CA 92027
 PHONE: (760) 458-2347
 CELL: (760) 419-3735

PROJECT NAME: TL23071 - SYCAMORE CANYON SUBSTATION TO PENASQUITOS - 230 KV UNDERGROUND	
AIRX JOB# X160218	THOMAS GRID#:-
TYPE OF WORK: TRENCHING / CONDUIT	DRAWN FOR: CALTRANS
MISC./POTHOLES#:	

PHASE 125

DATE: Apr. 5, 2017
DESIGNED BY: Clint Jones
SHEET 148 OF 148