

TCP#	7	6	2	4	9	10	9	17	10	27	17
TCP#	7	6	5	5	5	10	30	17	11	17	17
TCP#											

Work Hour: From: 8:30 am .M To 3:30 pm .M Night Work Continuous Others W.O.#

Address/Project Street: STONEBRIDGE PKWY Cross Street: GREENSTONE CT

Posted Speed Limit: 35 MPH Width/Depth of Trench: Approach Speed:

Contractor/Applicant's Name: DCXcavation Address/City, State, Zip: 10641 PROSPECT AVE SANTEE CA

ACTIVITY TYPE
 STREET CLOSURE
 TRAVEL LANE CLOSURE
 TURN LANE CLOSURE
 PARKING LANE CLOSURE
 BIKE LANE CLOSURE
 SIDEWALK CLOSURE
 PEDESTRIAN BARRICADE
 DETOUR
 FLAGGING
 BUS STOPS
 DUMPSTER
 TRENCHING
 PARKING METERS
 FIBER OPTIC
 SDG&E

STREET CLASSIFICATION
 EXPRESSWAY
 FOUR-LANE MAJOR STREET
 THREE-LANE COLLECTOR
 CUL-DE-SAC
 ALLEY
 SIX-LANE PRIMARY ARTERIAL/MAJOR ST.
 FOUR-LANE COLLECTOR
 TWO-LANE COLLECTOR
 LOCAL RESIDENTIAL

- REQUIREMENTS:
- Traffic control plan shall conform to the latest edition of City of San Diego Standard Drawings, Appendix A; The Manual of Uniform Traffic Control Devices and the California Supplement; and Standard Specifications for Public Works Construction, including Regional Supplement Amendments and City of San Diego Supplement Amendments.
 - The contractor is responsible for restoring the road back to satisfactory condition including, but not limited to, paving, striping, markings, and traffic signal loop detectors within five (5) calendar days of completion of work at affected intersection or road segment.
 - The City Traffic Engineer reserves the right to observe these traffic control plans in operation and to make any changes as field conditions warrant.
 - Trenches shall be backfilled or steel-plated during non-working hours. Steel plates shall have asphaltic concrete berm on all edges. All dirt, dust, and debris shall be removed from street at end of each day and at the end of the job. The street shall be in drivable condition at all times.
 - Any work that creates an undue safety risk or creates severe congestion may be shut down by City Traffic Engineers, City Field Inspection, or the Police Department.
 - All travel lanes shall be minimum of 12 feet wide, 14 feet adjacent to bike lanes, unless otherwise approved by the City Traffic Engineer.
 - Cones and delineators shall have reflectorized sleeves for night work.
 - If parking is allowed in advance warning area, advance warning signs shall be mounted on high level devices.

APPLICANT IS RESPONSIBLE FOR FULL AND COMPLETE REPRESENTATION OF THE ACTUAL ROAD CONDITIONS SHOWN ON THIS PLAN INCLUDING, BUT NOT LIMITED TO EXISTING STRIPING, SIGNING, SIDEWALKS, AND BIKE LANES.

PRINTED NAME: GARY EVANS PHONE: 619.441.3644 DATE: 10/4/17

SIGNATURE: *Gary Evans*

AGENT OWNER CONTRACTOR SIGN/BARRICADE CO. OTHERS

COMMENTS:

TRAFFIC CONTROL PLAN/PERMIT
 Development Services Department
 1222 First Ave. San Diego, CA 92101
 (619) 446-5150

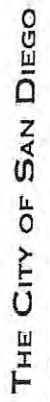

THE CITY OF SAN DIEGO
 Telephone: 619.279.0194
 Fax:

Project Contact Name: VAL CROMWELL
 Telephone: 619.279.0194
 Fax:

STREET CLASSIFICATION
 EXPRESSWAY
 FOUR-LANE MAJOR STREET
 THREE-LANE COLLECTOR
 CUL-DE-SAC
 ALLEY
 SIX-LANE PRIMARY ARTERIAL/MAJOR ST.
 FOUR-LANE COLLECTOR
 TWO-LANE COLLECTOR
 LOCAL RESIDENTIAL

9. The contractor shall post low-away/no parking signs twenty-four (24) hours in advance and shall tag the meters (where applicable).

10. Traffic control plans must be submitted in person a minimum of five (5) working days prior to the start of work within the public right-of-way.

11. Extension must be submitted in person TWO (2) WORKING DAYS IN ADVANCE OF PERMIT EXPIRATION.

12. Work days are Monday through Friday. No work on Saturdays, Sundays, or holidays unless approved and noted in "comments".

13. Contractor shall contact City Resident Engineer at (858) 627-3200 for inspection of any covered pedestrian walkway during construction of such walkway.

THE CONTRACTOR SHALL NOTIFY ALL AFFECTED AGENCIES 5 WORKING DAYS PRIOR TO STARTING WORK:

POLICE DEPARTMENT DISPATCH (619) 531-2000
 FIRE DEPARTMENT DISPATCH (858) 573-1300
 ENVIRONMENTAL SERVICES (858) 492-5060
 MTS (BUS STOPS) (619) 238-0100 EXT: 6451
 MTS (TAXI ZONES)/ MTS (TROLLEY LINES) (619) 235-2644/(619) 595-4960
 STREET DIVISION - TRAFFIC SIGNALS (619) 527-7500
 UNDERGROUND SERVICES-ALERT (800) 422-4133

AGENT OF CITY TRAFFIC ENGINEER: MK DATE: 10/4/17

DESCRIPTION: MS/KJ APPROVED BY: DATE: 10/25/17

FIRST EXTENSION:

SECOND EXTENSION:

REFERENCE TCP #:

Printed on recycled paper. Visit our web site at www.sandiego.gov/development-services.
 Upon request, this information is available in alternative formats for persons with disabilities.
 DS-269 (02-13)

TCP# 76555 : NO WORK ON 11/10/17 (CITY HOLIDAY)
 DO NOT CLOSE LANE ON 11/10/17

ORIGINAL PERMIT MUST BE KEPT ON JOB SITE ALL TIMES

APPROVED
 TRAFFIC CONTROL PERMIT
 OCT 25 2017
 CITY OF SAN DIEGO
 Development Services
 Engineering Division
 Traffic Safety Section

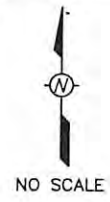

PERMIT MUST BE KEPT ON JOB SITE ALL TIMES

APPROVED
TRAFFIC CONTROL PERMIT
 OCT 25 2017
 CITY OF SAN DIEGO
 Development Services
 Engineering Division
 Traffic Safety Section

Flagger to help truck
 Access into Lane Closure

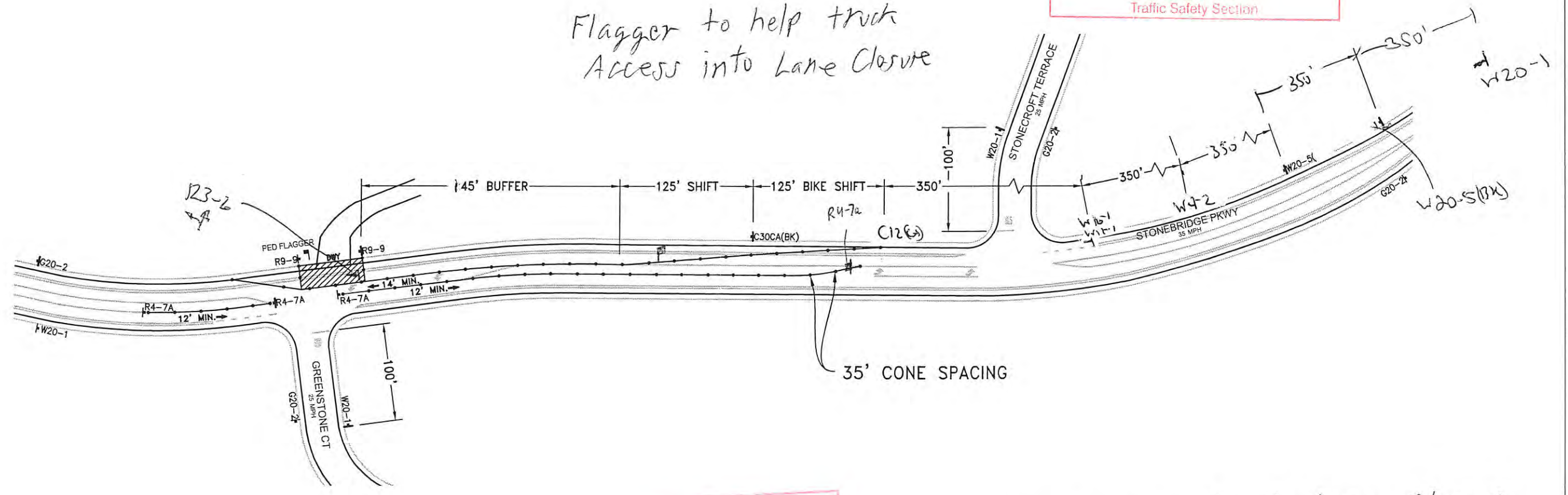

ORIGINAL PERMIT MUST BE KEPT ON JOB SITE ALL TIMES

Temporary Single Lane Closure
 to access large vehicle wide turns
 *Work for the installation of SDG&E electrical tower

TYPICAL CONSTRUCTION SIGNS:

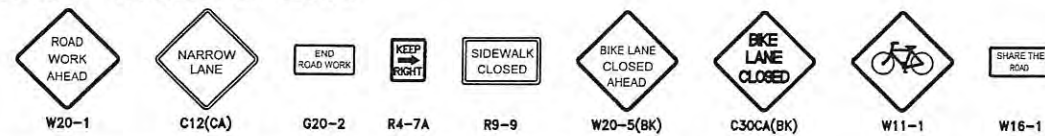

LEGEND: CONE: ● SIGN: ■ WORK AREA: ▨ TRAFFIC DIRECTION: ↓ FLASHING ARROW SIGN: ⚡ SIGNAL: ⊙ FLAGGER: ■ BARRICADE: H TEMPORARY NO PARKING: → TNP →
 REV DATE: 05-08-17 POSTED SPEED LIMIT: SEE PLAN TAPER LENGTH: SEE PLAN SIGN SPACING: SEE PLAN CONE SPACING: SEE PLAN

ALL PLANS MUST BE CHECKED AND APPROVED BY THE GOVERNMENTAL AGENCY, OR AGENCIES, HAVING JURISDICTION OVER THE ROADWAYS SHOWN ON THIS PLAN PRIOR TO THE PLAN BEING PUT INTO EFFECT. ALL PLANS ARE INTENDED TO CONFORM TO THE MANUAL ON UNIFORM TRAFFIC CONTROL DEVICES. THE CUSTOMER / CONTRACTOR IS RESPONSIBLE FOR THE ASCERTAINING ADDITIONAL AGENCY REQUIREMENTS FOR WORK HOURS ALLOWED, NOISE ABATEMENT, AND OTHER RULES AND REGULATIONS.
 THE TEMPORARY TRAFFIC CONTROLS MUST BE INSTALLED PER THE AGENCY APPROVED PLAN TO BE EFFECTIVE. FIELD CHANGES OTHER THEN MINOR ADJUSTMENT, MUST BE AUTHORIZED IN WRITING BY A REPRESENTATIVE OF THE GOVERNMENTAL AGENCY, OR AGENCIES, HAVING JURISDICTION OVER THE ROADWAY.
 PLAN IMPLEMENTATION AND DEVICE PLACEMENT SHOULD BE PERFORMED BY EXPERIENCED / TRAINED PERSONNEL.
 TEMPORARY TRAFFIC CONTROLS MUST BE MONITORED AND MAINTAINED BY THE CUSTOMER / CONTRACTOR TO REMAIN EFFECTIVE. MONITORING AND MAINTENANCE FREQUENCY IS DICTATED BY FIELD CONDITIONS, BUT NOT LESS THAN DAILY.
 HUDSON SAFET-LITE HAS NO CONTROL OVER, OR RESPONSIBILITY FOR, TRAFFIC CONTROL PLAN IMPLEMENTATION AND INSPECTIONS PERFORMED BY OTHERS. USERS AGREE TO INDEMNIFY HUDSON SAFET-LITE FOR CLAIMS MADE REGARDING FAILURE TO INSTALL, MAINTAIN OR REMOVE CONTROLS PER APPROVED TRAFFIC CONTROL PLANS.

TRAFFIC CONTROL PLAN

CONTRACTOR: DCXCAVATION VAL CROMWELL 10641 PROSPECT AVE SANTEE, CA 92071 619.312.1550	PLAN APPROVED BY: CITY OF SAN DIEGO HUDSON SAFE-T-LITE RENTALS 1215 N MARSHALL AVE EL CAJON, CA 92020 Office: 619-441-3644
DATE DRAWN: 05-08-17	SCALE: NO SCALE
DRAWN BY: RODOLFO RAMIREZ	
DRAWING NUMBER: 1 OF 1	