

Traffic Control Permit (TCP) Multiple Location List

ORIGINAL PERMIT MUST BE KEPT

APPROVED
CITY OF SAN DIEGO
Development Engineering Division
Traffic Safety

Franchise Utility Company Only - May Not Be Submitted By Contractor

To: City of San Diego, Traffic Permit Section
Date: 4/26/2017
From: (Company): SDG&E
Phone No.: 619-778-2405
Contact Person: Rod Nelson
Fax: _____
TCP No. _____

Account #: Permit #

City Use Only
Authorized # _____
By Felipe Avila 125
Yes No _____
Date Reviewed 5/18/17

- TYPE OF WORK**
- 1 = Lane Closure
 - 2 = Street Closure
 - 3 = Sidewalk Closure
 - 4 = Alley Closure
 - 5 = Parking Lane
 - 6 = Detour
 - 7 = Trenching
 - 8 = Flagging

Location	From	To	Start Date *	End Date *	Work Hours **	Thomas Bros.	Type of Work
Trade Street	Camino Santa Fe Street	End of Trade Street	5/21/17	6/9/17	9:00PM - 5:00AM	1208-J7, 1209-A7	1,5,7,8
Carroll Way	Trade Street	Carroll Road	5/21/17	6/9/17	9:00PM - 5:00AM	1209-A7	8
Kenmar Drive	Trade Street	Formula Place	5/21/17	6/9/17	9:00PM - 5:00AM	1209-A7	8
Trade Place	Trade Street	Arjons Drive	5/21/17	6/9/17	9:00PM - 5:00AM	1209-A6, A7	1,5,7,8
Silverton Ave	Trade Place	Mira Este Ct	5/21/17	6/9/17	9:00PM - 5:00AM	1209-A7, B7	8
Dunbrook Road	Trade Place	Arjons Drive	5/21/17	6/9/17	9:00PM - 5:00AM	1209-A6, B6	8
Arjons Drive	Trade Place	Dowdy Drive	5/21/17	6/9/17	9:00PM - 5:00AM	1209-A6, B6, C6	1,5,7,8
Dowdy Drive	Arjons Drive	Stromesa Ct	5/21/17	6/9/17	9:00PM - 5:00AM	1209-B6	8

Comments: Trenching crew - Phases 32 -50 only; Night work hours 9pm-5am (Sunday night through Thursday night)

Must be submitted a minimum of 2 working days prior to start of work. All columns must be filled out for proper authorization

Fax or mail to: City of San Diego • Traffic Control Permit Section • 1222 First Avenue, MS 501 • San Diego, CA 92101. Fax (619) 446-5489 Office (619) 446-5150

* Work Days: Monday Through Friday ** Work Hours : 8:30 AM - 3:30PM. Unless other hours are preapproved)

No Work on Saturdays, Sundays, or Holidays Unless Approved and Noted In Comments

Minimum of 5 working days required for construction work which affects traffic signal e-mail info to: dciafre@sandiego.gov

*No work 5/29/17 City Holiday

ATTENTION UTILITY COMPANY

Special Inspection Fees May Be Applied By City of San Diego For Any Night or Weekend Work.

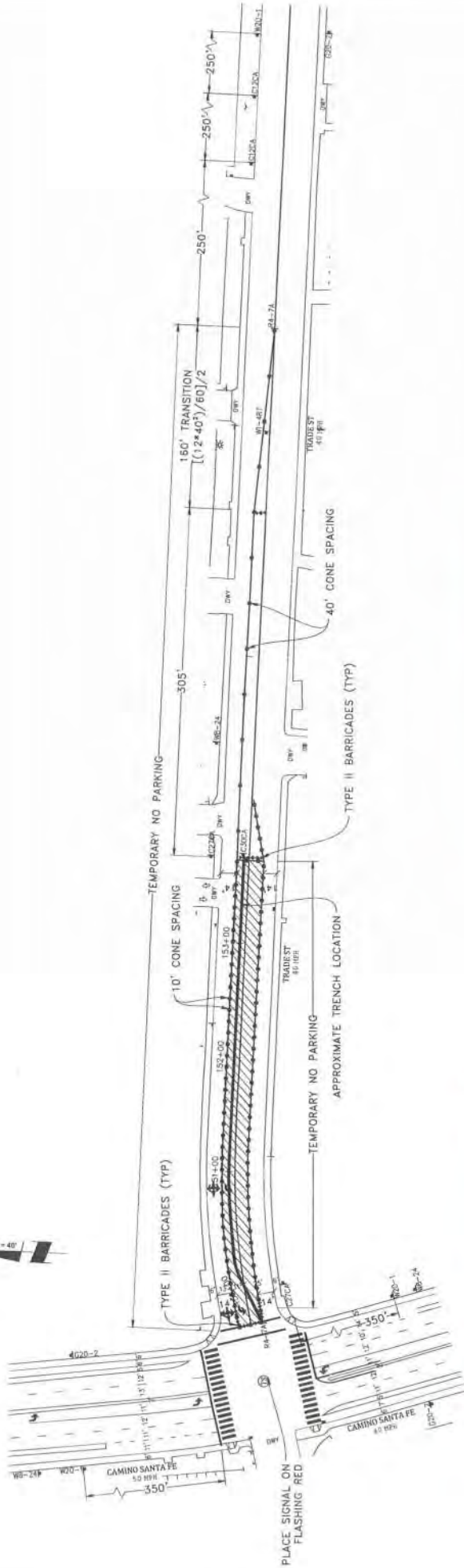

APPROVED
TRAFFIC CONTROL PERMIT

MAY 18 2017

CITY OF SAN DIEGO
 Development Services
 Engineering Division
 Traffic Safety Section

ORIGINAL PERMIT MUST
BE KEPT
ON JOB SITE ALL TIMES

- LEGEND**
- 1 SIGN
 - 8 SIGNAL
 - TRAFFIC CONES / DELINEATOR
 - BARRICADE
 - FLAGGER
 - FLASHING ARROW SIGN
 - WORK ZONE
 - BUS STOP

SAFETY FLAGGERS WILL PROVIDE TRAFFIC CONTROL AT ALL TIMES TO DRIVEWAYS AT ALL WORK AREAS

SAFETY FLAGGERS WILL SAFELY GUIDE PEDESTRIANS THROUGH WORK AREAS

NOTE: CONTRACTOR WILL MAINTAIN ALL ACCESS AT ALL TIMES

NOTE: CONTRACTOR WILL PLACE BUS STOP AHEAD SIGN TO REMAIN IN PLACE FOR DURATION OF WORK

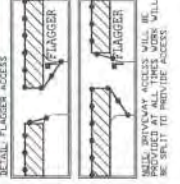

NOTE: CONTRACTOR WILL COORDINATE ALL WORK WITH FIRE STATION PRIOR TO START OF WORK

NOTE: CONTRACTOR WILL COORDINATE ALL WORK WITH TRANSIT DEPARTMENT 5 DAYS PRIOR TO START OF WORK

NOTE: CONTRACTOR WILL COORDINATE ALL WORK WITH BUSINESSES PRIOR TO START OF WORK

NOTE: CONTRACTOR WILL COORDINATE ALL WORK WITH BUSINESSES PRIOR TO START OF WORK

NOTE: CONTRACTOR WILL COORDINATE ALL WORK WITH RESIDENTS PRIOR TO START OF WORK

NOTE: CONTRACTOR WILL COORDINATE ALL WORK WITH BUSINESSES PRIOR TO START OF WORK



WORK ZONES: 11

NIGHT WORK ONLY
PHASE 32

DATE: May 15, 2017
 DESIGNED BY: Clint Jones
 SHEET 042 OF 148

PROJECT NAME: TL23071 - SYCAMORE CANYON SUBSTATION TO PENASQUITOS - 230 KV UNDERGROUND
 AIRX JOB# X160218
 TYPE OF WORK: TRENCHING / CONDUIT
 DRAWN FOR: CITY OF SAN DIEGO
 MISC: POTHOLES#

AIRX SERVICES, INC.
 Ceil McMoran
 President
 250 EAST CLAYTON PARKWAY, SUITE C
 ESCONCADO, CA 92527
 PHONE: (951) 951-2500
 CELL: (951) 919-2378

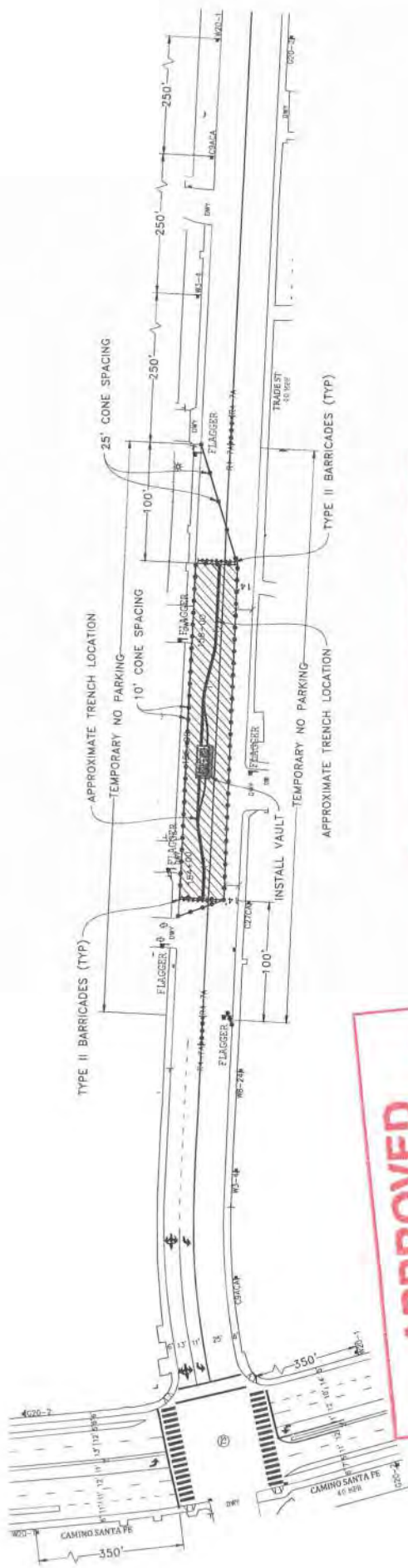

APPROVED
TRAFFIC CONTROL PERMIT
MAY 18 2017
CITY OF SAN DIEGO
Development Services
Engineering Division
Traffic Safety Section

ORIGINAL PERMIT MUST
BE KEPT
ON JOB SITE ALL TIMES

- LEGEND**
- SIGN
 - SIGNAL
 - BARRICADE
 - FLAGGER
 - FLASHING ARROW SIGN
 - WORK ZONE
 - BUS STOP

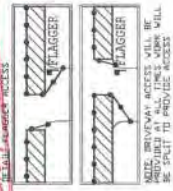

NOTE: FLAGGERS WILL PROVIDE ACCESS TO DRIVEWAYS AT ALL TIMES
NOTE: FLAGGERS WILL SAFELY REMOVE TRAFFIC THROUGH WORK AREA
NOTE: CONTRACTOR WILL ALLOW FIRE STATION INGRESS AND EGRESS AT ALL TIMES
NOTE: 18" x 24" STEEL PLATES WILL BE PROVIDED AT ALL TIMES. WORK WILL BE PAID FOR DURATION OF WORK

NOTE: CONTRACTOR WILL COORDINATE WITH ALL AGENCIES PRIOR TO START OF WORK
NOTE: CONTRACTOR WILL COORDINATE ALL WORK WITH TRANSIT DEPARTMENT 5 DAYS PRIOR TO START OF WORK
NOTE: CONTRACTOR WILL COORDINATE WITH ALL AGENCIES PRIOR TO START OF WORK
NOTE: CONTRACTOR WILL COORDINATE WITH ALL AGENCIES PRIOR TO START OF WORK

WORK HOURS: _____ TO _____
NOTE: CONTRACTOR WILL COORDINATE WITH ALL AGENCIES PRIOR TO START OF WORK
NOTE: CONTRACTOR WILL COORDINATE WITH ALL AGENCIES PRIOR TO START OF WORK



NIGHT WORK ONLY
PHASE 33

DATE: Mar. 15, 2017
DESIGNED BY: Clint James
SHEET 043 OF 148

PROJECT NAME: TL23071 - SYCAMORE CANYON SUBSTATION TO PENASQUITOS - 230 KV UNDERGROUND
AIRX JOB#: X160218
THOMAS GRID# -
TYPE OF WORK: TRENCHING / CONDUIT
DRAWN FOR: CITY OF SAN DIEGO
MISC/NOTHOLES#:

AIRX SURVEYORS, INC.
Gail McMorrin
 President
 330 EAST EL MORTO PARKWAY, SUITE C
 SAN DIEGO, CA 92107
 PHONE: (619) 444-0400
 FAX: (619) 444-0728

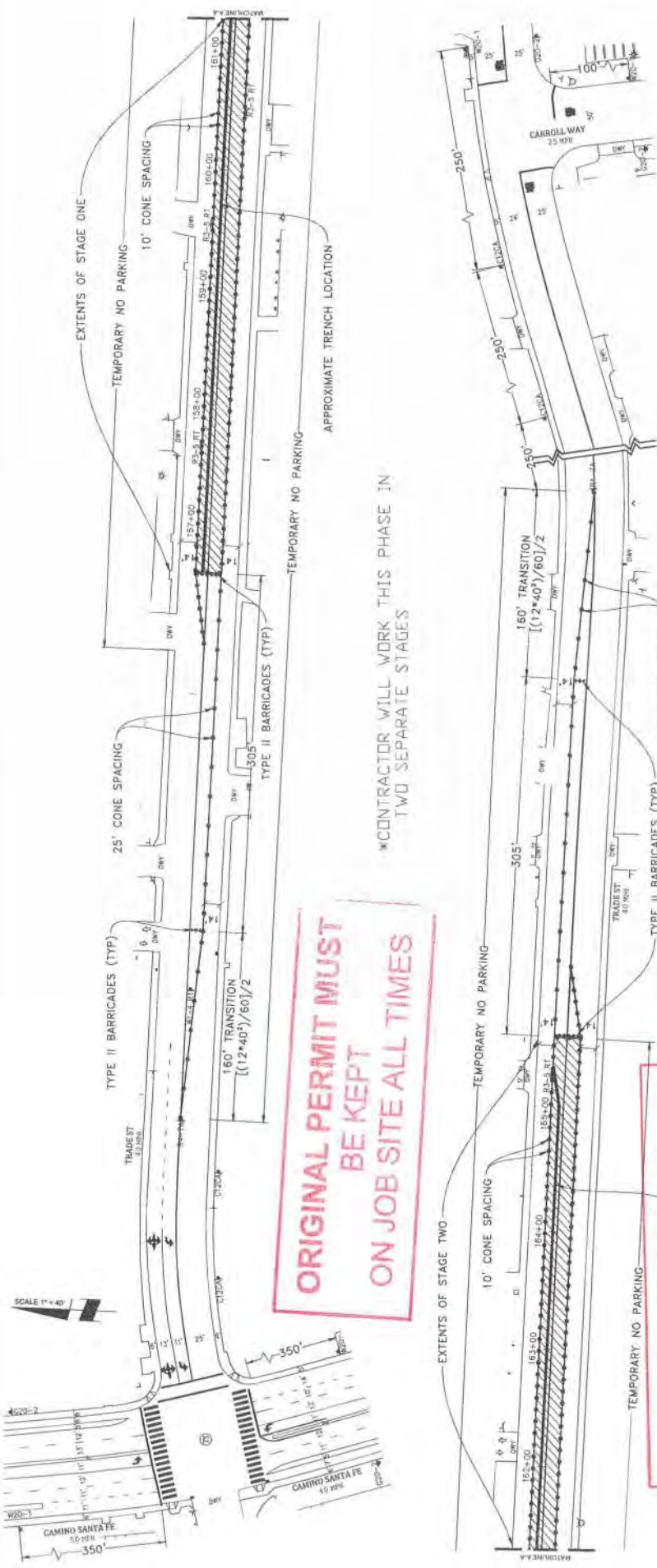

APPROVED
 APPROXIMATE TRENCH LOCATION
TRAFFIC CONTROL PERMIT
 MAY 18 2017
 CITY OF SAN DIEGO
 Department of Transportation
 Engineering Division

- LEGEND**
- SIGN
 - TRAFFIC CONES / DELINEATOR
 - BARRICADE
 - FLAGGER
 - FLASHING ARROW SIGN
 - WORK ZONE
 - BUS STOP

NOTE: CONTRACTOR WILL COORDINATE ALL WORK WITH FIRE STATION PRIOR TO START OF WORK.

NOTE: CONTRACTOR WILL COORDINATE ALL WORK WITH TRANSIT DEPARTMENT 5 DAYS PRIOR TO START OF WORK.

NOTE: CONTRACTOR WILL COORDINATE ALL WORK WITH BUSINESS PRIOR TO START OF WORK.

NOTE: CONTRACTOR WILL COORDINATE ALL WORK WITH BUSINESS PRIOR TO START OF WORK.

NOTE: CONTRACTOR WILL COORDINATE ALL WORK WITH BUSINESS PRIOR TO START OF WORK.

NOTE: CONTRACTOR WILL COORDINATE ALL WORK WITH BUSINESS PRIOR TO START OF WORK.

IRIX SURVEYORS, INC.
 Gail McMorman
 President
 2304 EAST CLAYTON AVENUE, SUITE C
 ESCOBEDO, CA 92027
 PHONE: (619) 439-2288
 GCELL / 619-439-2288

PROJECT NAME: TL23071 - SYCAMORE CANYON SUBSTATION TO PENASQUITOS - 230 KV UNDERGROUND
 AIRX JOB#: X160218
 TYPE OF WORK: TRENCHING / CONDUIT
 DRAWN FOR: CITY OF SAN DIEGO
 MISC/POTHOLE#:

DATE: Mar. 15, 2017
 DESIGNED BY: Clint Jones
 THOMAS GRID# -
 NIGHT WORK ONLY
 PHASE 3A

WORK HOURS: _____ TO _____

NOTE: CONTRACTOR WILL COORDINATE ALL WORK WITH BUSINESS PRIOR TO START OF WORK.

NOTE: CONTRACTOR WILL COORDINATE ALL WORK WITH BUSINESS PRIOR TO START OF WORK.

NOTE: CONTRACTOR WILL COORDINATE ALL WORK WITH BUSINESS PRIOR TO START OF WORK.

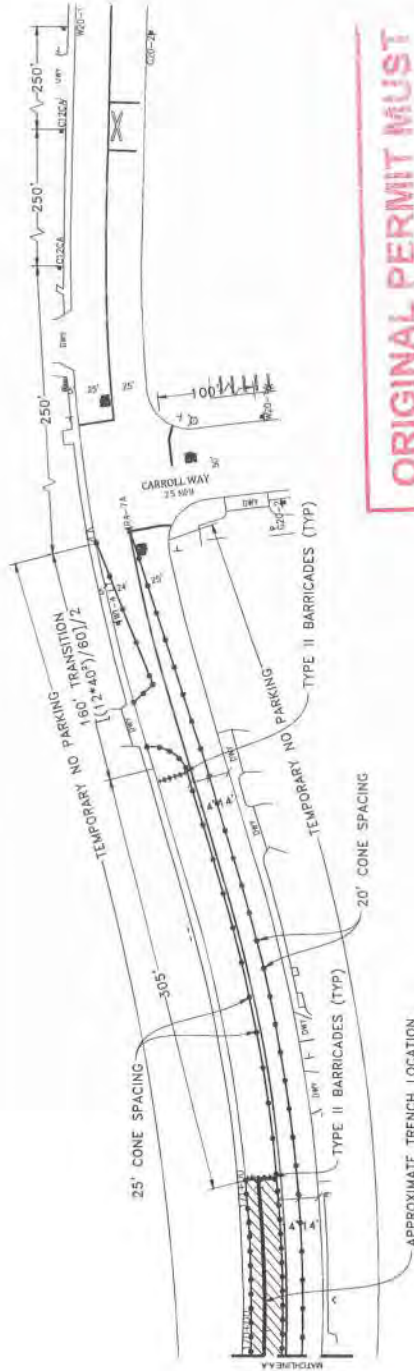
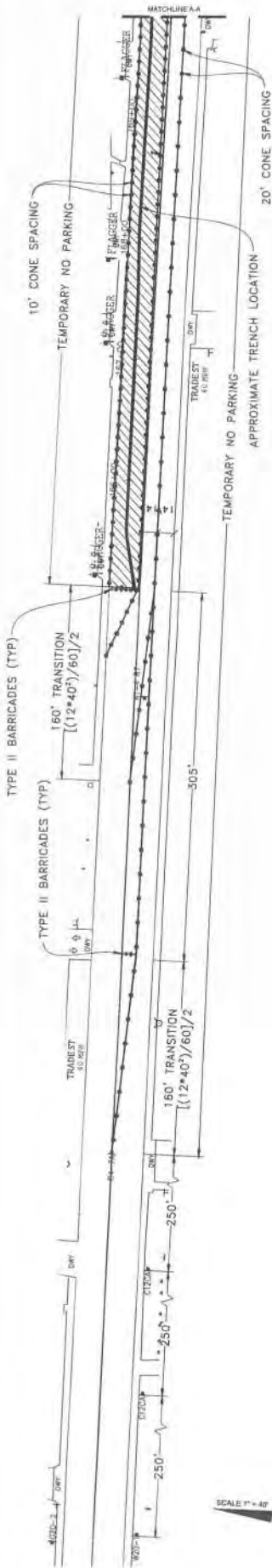

ORIGINAL PERMIT MUST
BE KEPT
ON JOB SITE ALL TIMES

APPROVED
 TRAFFIC CONTROL PERMIT
 MAY 18 2017
 CITY OF SAN DIEGO
 Development Services
 Engineering Division
 Traffic Safety Section

- LEGEND**
- SIGN
 - SIGNAL
 - ▬ TRAFFIC CONES / DELINEATOR
 - ▬ BARRICADE
 - ▬ FLAGGER
 - ▬ FLASHING ARROW SIGN
 - ▬ WORK ZONE
 - ▬ BUS STOP

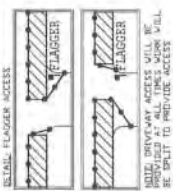

NOTE: FLAGGERS WILL PROVIDE ACCESS TO DRIVEWAYS AT ALL TIMES.

NOTE: FLAGGERS WILL SAFELY STOP TRAFFIC THROUGH WORK AREA.

NOTE: CONTRACTOR WILL ALLOW FIRE STATION INGRESS AND EGRESS AT ALL TIMES.

NOTE: W-2-24 STEEL PLATES SHALL BE USED TO MAINTAIN CLEAR EGRESS FROM WORK AREA.

NOTE: CONTRACTOR WILL COORDINATE ALL WORK WITH FIRE STATION PRIOR TO START OF WORK.

NOTE: CONTRACTOR WILL COORDINATE ALL WORK WITH TRANSIT DEPARTMENT 5 DAYS PRIOR TO START OF WORK.

NOTE: CONTRACTOR WILL COORDINATE ALL WORK WITH EXISTING TRAFFIC CONTROL.

NOTE: CONTRACTOR WILL COORDINATE ALL WORK WITH RESIDENTS PRIOR TO START OF WORK.

NOTE: CONTRACTOR WILL COORDINATE ALL WORK WITH BUSINESSES PRIOR TO START OF WORK.



WORK NUMBER: TO

SEE NOTES FOR USE OF MATERIALS BETWEEN FLAGGERS OR USE OF COMMUNICATION. FLAGGER WILL ASSIST WITH BACK/SIDE ACCESS.

NIGHT WORK ONLY
PHASE 35

DATE: Mar. 15, 2017
DESIGNED BY: Clint Jones
SHEET 045 OF 148

PROJECT NAME: TL23071 - SYCAMORE CANYON SUBSTATION TO PENASQUITOS - 230 KV UNDERGROUND
AIRX JOB#: X160218
TYPE OF WORK: TRENCHING / CONDUIT MISCELLANEOUS

THOMAS GRIDW - DRAWN FOR: CITY OF SAN DIEGO

AIRX
 Gail McMorman
 President
 208 EAST EL MONTE AVENUE, SUITE C
 PHOENIX, AZ 85027
 PHONE (602) 406-0001
 CALL (602) 419-3128

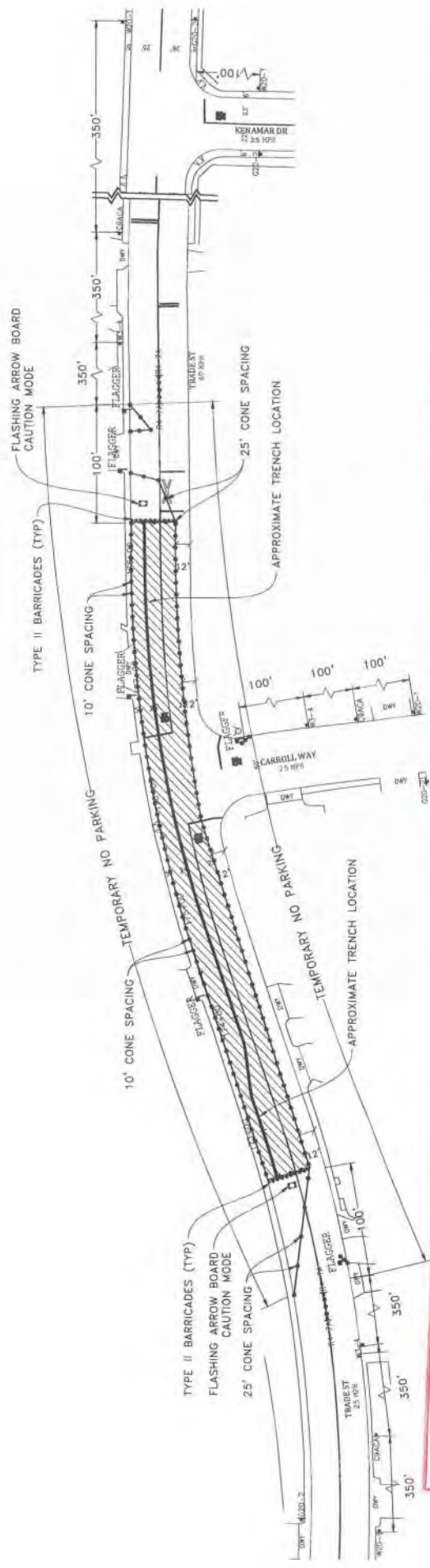

APPROVED
TRAFFIC CONTROL PERMIT

MAY 18 2017

CITY OF SAN DIEGO
Development Services
Engineering Division
Traffic Safety Section

ORIGINAL PERMIT MUST
BE KEPT
ON JOB SITE ALL TIMES

- LEGEND**
- SIGN
 - SIGNAL
 - TRAFFIC CONES / DELINEATOR
 - BARRICADE
 - FLAGGER
 - FLASHING ARROW SIGN
 - WORK ZONE
 - BUS STOP

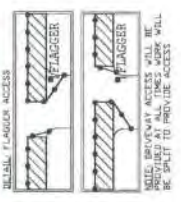

NOTE: FLAGGERS WILL PROVIDE ACCESS TO DRIVERS AT ALL TIMES

NOTE: FLAGGERS WILL SAFELY CROSS THROUGH WORK AREA

NOTE: CONTRACTOR WILL ALLOW FIRE STATION ADDRESS AND EGRESS AT ALL TIMES

NOTE: W-24, STEEL PLATES, REQUIRED AT ALL TIMES. WORK WILL BE PAID TO PROVIDE ACCESS

NOTE: CONTRACTOR WILL COORDINATE ALL WORK WITH FIRE STATION PRIOR TO START OF WORK

NOTE: CONTRACTOR WILL COORDINATE ALL WORK WITH TRANSIT DEPARTMENT 5 DAYS PRIOR TO START OF WORK

NOTE: CONTRACTOR WILL COORDINATE AND NOT CONFLICT WITH EXISTING TRAFFIC CONTROL

NOTE: CONTRACTOR WILL COORDINATE ALL WORK WITH RESIDENTS PRIOR TO START OF WORK

NOTE: CONTRACTOR WILL COORDINATE ALL WORK WITH BUSINESSES PRIOR TO START OF WORK

WORK: JUNE TO _____



NIGHT WORK ONLY
PHASE 36

ARX
SAFETY SURVEYORS, INC.
 2004 EAST CLAYMONT AVENUE, SUITE C
 SAN DIEGO, CA 92101
 PHONE: (619) 444-0047
 CELL: (619) 418-3728

Gail McMorrin
 President

PROJECT NAME: TL23071 - SYCAMORE CANYON SUBSTATION TO PENASQUITOS - 230 KV UNDERGROUND

ARX JOB#: X160218

TYPE OF WORK: TRENCHING / CONDUIT

MISC/POTHOLES#:

DATE: Mar. 15, 2017

DESIGNED BY: Clint Jones

DRAWN FOR: CITY OF SAN DIEGO

THOMAS GRID#:

SCALE = 1/8" = 1'-0"

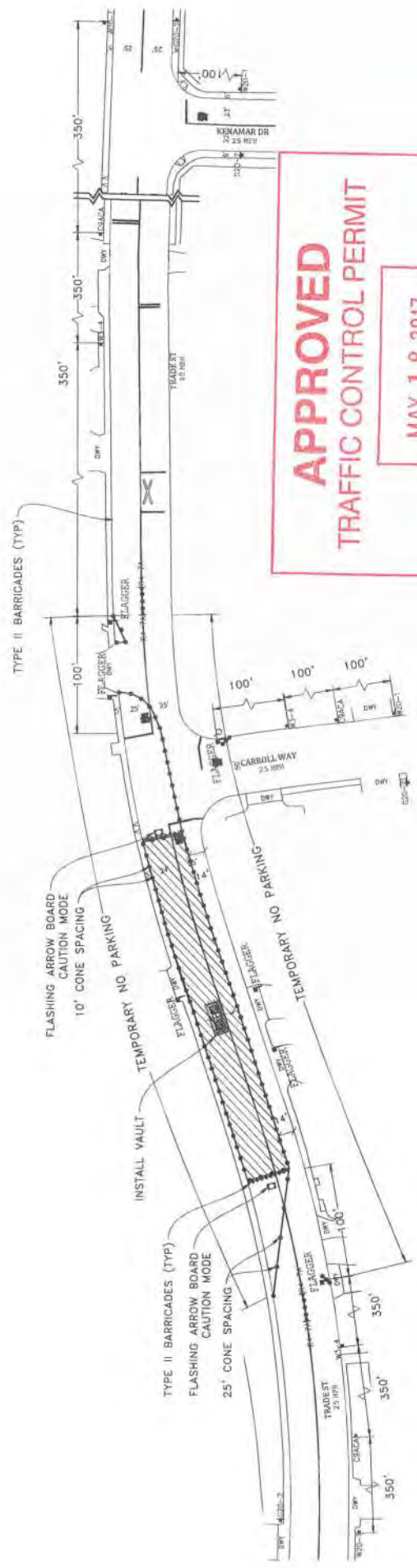

APPROVED
TRAFFIC CONTROL PERMIT

MAY 18 2017

 CITY OF SAN DIEGO
 Development Services
 Engineering Division
 Traffic Safety Section

ORIGINAL PERMIT MUST
 BE KEPT
 ON JOB SITE ALL TIMES

- LEGEND**
- SIGN
 - SIGNAL
 - TRAFFIC CONES / DELINEATOR
 - BARRICADE
 - FLAGGER
 - FLASHING ARROW SIGN
 - WORK ZONE
 - BUS STOP

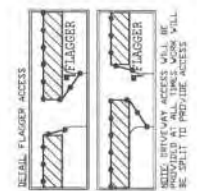

NOTE: FLAGGERS WILL PROVIDE ACCESS TO DRIVEWAYS AT ALL TIMES.

NOTE: FLAGGERS WILL SAFELY ALLOW TRAFFIC THROUGH WORK AREA.

NOTE: CONTRACTOR WILL ALLOW FIRE STATION IMPASS AND ACCESS AT ALL TIMES.

NOTE: WP-24 STEEL PLATES WILL BE PROVIDED AT ALL TIMES. WORK WILL BE STOPPED TO PROVIDE ACCESS.

NOTE: CONTRACTOR WILL COORDINATE ALL WORK WITH FIRE STATION PRIOR TO START OF WORK.

NOTE: CONTRACTOR WILL COORDINATE ALL WORK WITH TRANSIT DEPARTMENT 5 DAYS PRIOR TO START OF WORK.

NOTE: CONTRACTOR WILL COORDINATE ALL WORK WITH BUSINESS PRIOR TO START OF WORK.

NOTE: CONTRACTOR WILL COORDINATE ALL WORK WITH BUS/VEHICLE TRAFFIC PRIOR TO START OF WORK.

NOTE: CONTRACTOR WILL COORDINATE ALL WORK WITH RESIDENTS PRIOR TO START OF WORK.

NOTE: CONTRACTOR WILL COORDINATE ALL WORK WITH BUSINESSES PRIOR TO START OF WORK.

NOTE: CONTRACTOR WILL COORDINATE ALL WORK WITH SAN DIEGO POLICE DEPARTMENT PRIOR TO START OF WORK.

NOTE: CONTRACTOR WILL COORDINATE ALL WORK WITH BUS/VEHICLE TRAFFIC PRIOR TO START OF WORK.

WORK ORDER: _____ TO _____

NIGHT WORK ONLY
 PHASE 37

<p>PROJECT NAME: TL23071 - SYCAMORE CANYON SUBSTATION TO PENASQUITOS - 230 KV UNDERGROUND</p> <p>AIRX JOB#: X16021B</p> <p>TYPE OF WORK: TRENCHING / CONDUIT MISC/POTHOLES#</p>	<p>DATE: Mar. 15, 2017</p> <p>DESIGNED BY: Clint Jones</p> <p>THOMAS GRID#: _____</p> <p>DRAWN FOR: CITY OF SAN DIEGO</p>
<p>APPROVED BY:</p> <p style="text-align: right;">Gail McMoran President</p> <p style="text-align: right; font-size: 0.8em;"> AIRX SURVEYING, INC. 2024 EAST CLAYTON PARKWAY, SUITE C PHOENIX, ARIZONA 85027 CELL: (602) 438-3226 </p>	

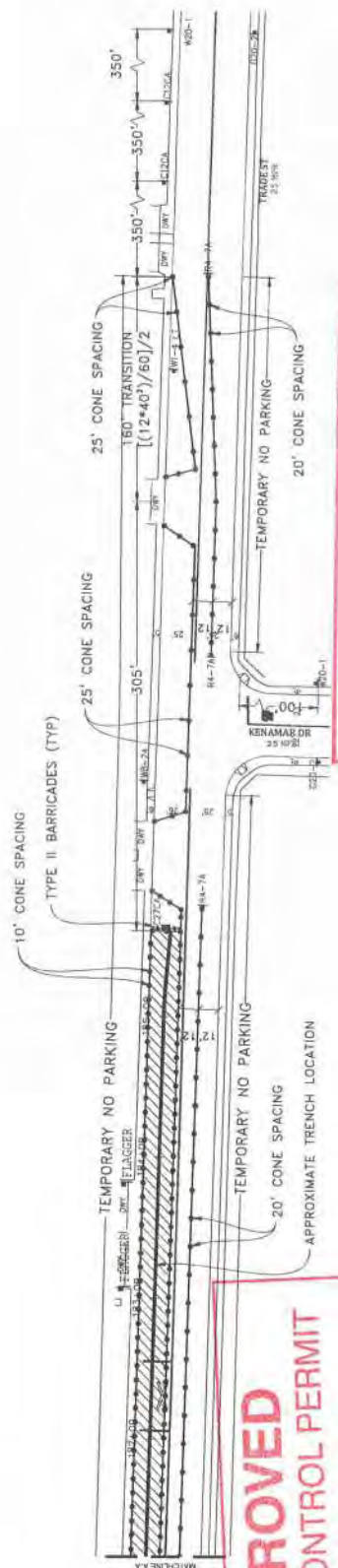
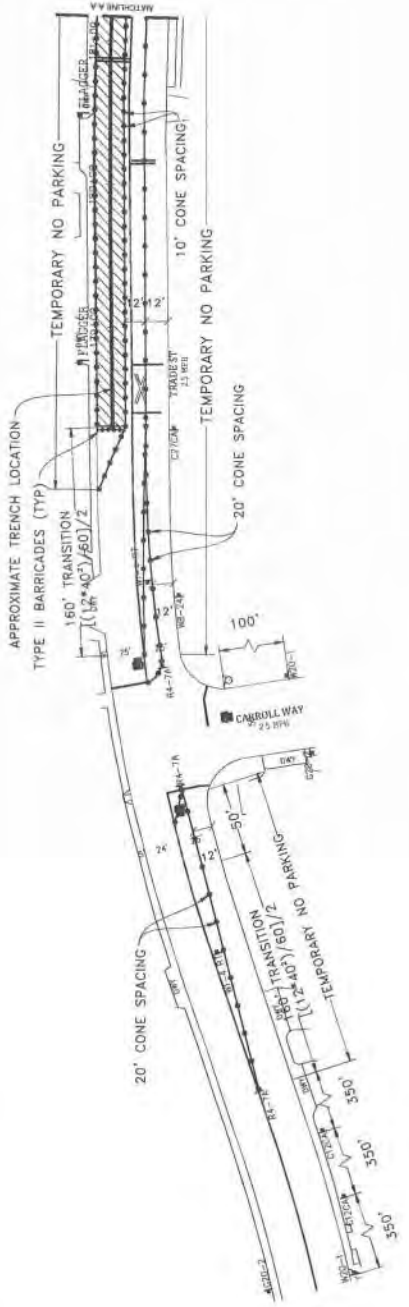

APPROVED
TRAFFIC CONTROL PERMIT

MAY 18 2017

CITY OF SAN DIEGO
 Development Services
 Engineering Division
 Traffic Safety Section

**ORIGINAL PERMIT MUST
 BE KEPT
 ON JOB SITE ALL TIMES**

- LEGEND**
- SIGN
 - SIGNAL
 - TRAFFIC CONES / DELINEATOR
 - BARRICADE
 - FLAGGER
 - FLASHING ARROW SIGN
 - WORK ZONE
 - BUS STOP

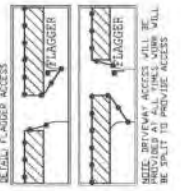

SUBMIT FLAGGERS WILL PROVIDE ACCESS TO DRIVEWAYS AT ALL TIMES. FLAGGERS WILL SAFELY GUIDE PEDESTRIANS THROUGH WORK AREA.

SUBMIT CONTRACTOR WILL ALLOW FIRE STATION INGRESS AND EGRESS AT ALL TIMES.

SUBMIT CONTRACTOR WILL PLACE 18" x 24" STEEL PLATE IN PLACE FOR DURATION OF WORK.

NOTE: CONTRACTOR WILL COORDINATE ALL WORK WITH FIRE STATION PRIOR TO START OF WORK.

NOTE: CONTRACTOR WILL COORDINATE ALL WORK WITH TRANSIT DEPARTMENT PRIOR TO START OF WORK.

NOTE: CONTRACTOR WILL COORDINATE ALL WORK WITH BUSINESS PRIOR TO START OF WORK.

NOTE: CONTRACTOR WILL COORDINATE ALL WORK WITH RESIDENTS PRIOR TO START OF WORK.

NOTE: CONTRACTOR WILL COORDINATE ALL WORK WITH BUSINESSES PRIOR TO START OF WORK.

AIRX SURVEYORS, INC.
 254 CAROL MONTGOMERY SUITE C
 ESCOBAR, CA 92027
 PHONE (619) 462-2477
 CELL (619) 459-5278

Gall McMorrin
 President

PROJECT NAME: TL23071 - SYCAMORE CANYON SUBSTATION TO PENASQUITOS - 230 KV UNDERGROUND

AIRX JOB#: X160218

TYPE OF WORK: TRENCHING / CONDUIT

MISC/POTHOLE#:

DATE: Mar 15, 2017

DESIGNED BY: Clint Jones

DRAWN FOR: CITY OF SAN DIEGO

SHEET 048 OF 148

**NIGHT WORK ONLY
 PHASE 38**

DATE: _____ TO _____

SCALE 1" = 40'

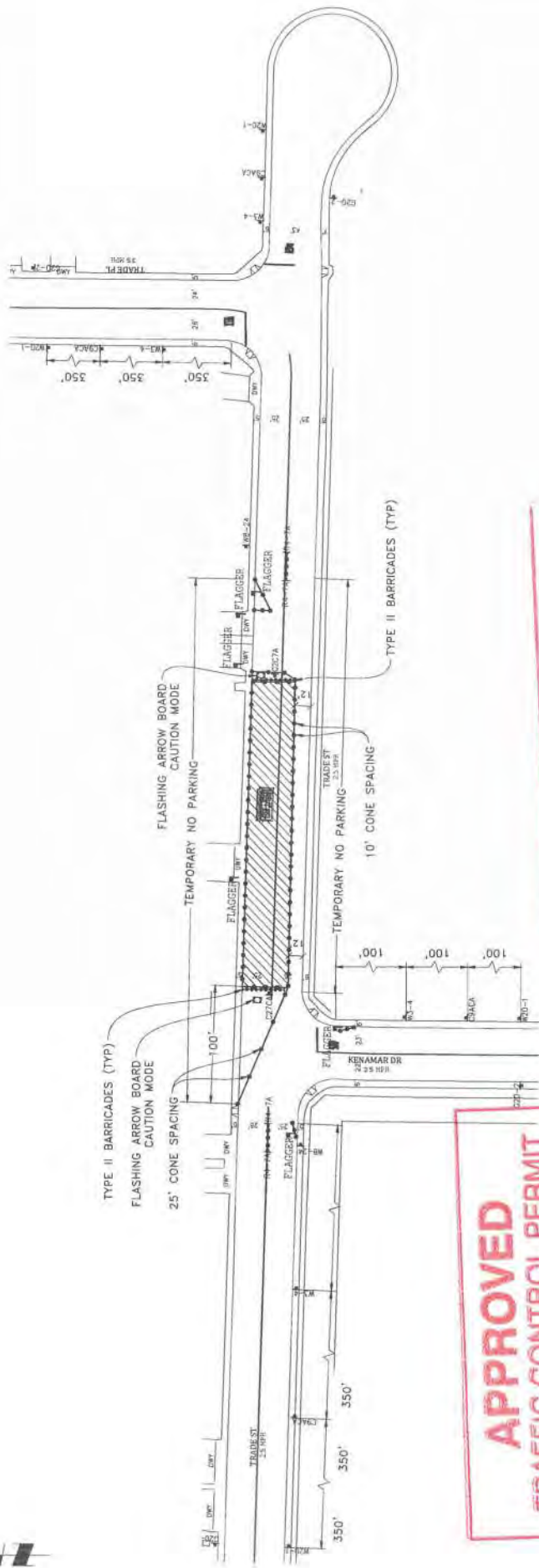

APPROVED
TRAFFIC CONTROL PERMIT
 MAY 18 2017
 CITY OF SAN DIEGO
 Development Services
 Engineering Division
 Traffic Safety Section

ORIGINAL PERMIT MUST
BE KEPT
ON JOB SITE ALL TIMES

- LEGEND**
- SIGN
 - SIGNAL
 - BARRICADE
 - ▨ FLAGGER
 - ▧ FLASHING ARROW SIGN
 - ▩ WORK ZONE
 - ☑ BUS STOP

NOTE: FLAGGERS WILL PROVIDE ACCESS TO DRIVENAYS AT ALL TIMES.
 NOTE: FLAGGERS WILL SAFELY ACCESS THROUGH WORK AREA.
 NOTE: CONTRACTOR WILL ALLOW FIRE STATION ACCESS AND EGRESS AT ALL TIMES.
 NOTE: 48" x 24" STEEL PLATES WILL BE PLACED FOR PROTECTIVE ACCESS.

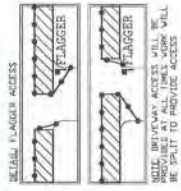

NOTE: CONTRACTOR WILL COORDINATE ALL WORK WITH FIRE STATION PRIOR TO START OF WORK.
 NOTE: CONTRACTOR WILL COORDINATE ALL WORK WITH TRANSIT DEPARTMENT 2 DAYS PRIOR TO START OF WORK.
 NOTE: CONTRACTOR WILL COORDINATE ALL WORK WITH EXISTING PROJECTS AND NOT CONFLICT WITH EXISTING TRAFFIC CONTROL.

NOTE: CONTRACTOR WILL COORDINATE ALL WORK WITH RESIDENTS PRIOR TO START OF WORK.
 NOTE: CONTRACTOR WILL COORDINATE ALL WORK WITH BUSINESSES PRIOR TO START OF WORK.



SEE SYMBOLS TO BE MAINTAINED BETWEEN FLAGGERS TO USE T.W.T. COMMUNICATION. FLAGGER WILL ASSESS WITH REGULAR INTERVAL.

WEEK HOURS: TTT

NIGHT WORK ONLY
PHASE 40

PROJECT NAME: TL23071 - SYCAMORE CANYON SUBSTATION TO PENASQUITOS - 230 KV UNDERGROUND	DATE: Mar. 15, 2017
ARX JOB#: X160218	DESIGNED BY: Clint Jones
TYPE OF WORK: TRENCHING / CONDUIT	THOMAS GRID# -
MISC/POTHOLE#:	DRAWN FOR: CITY OF SAN DIEGO
SHEET 050 OF 148	

ARX SURVEYORS, INC.
 Gail McMorrin, President
 300 EAST CLAYTON AVENUE, SUITE C
 SAN DIEGO, CA 92101
 PHONE: (619) 480-2340
 CELL: (619) 418-2728

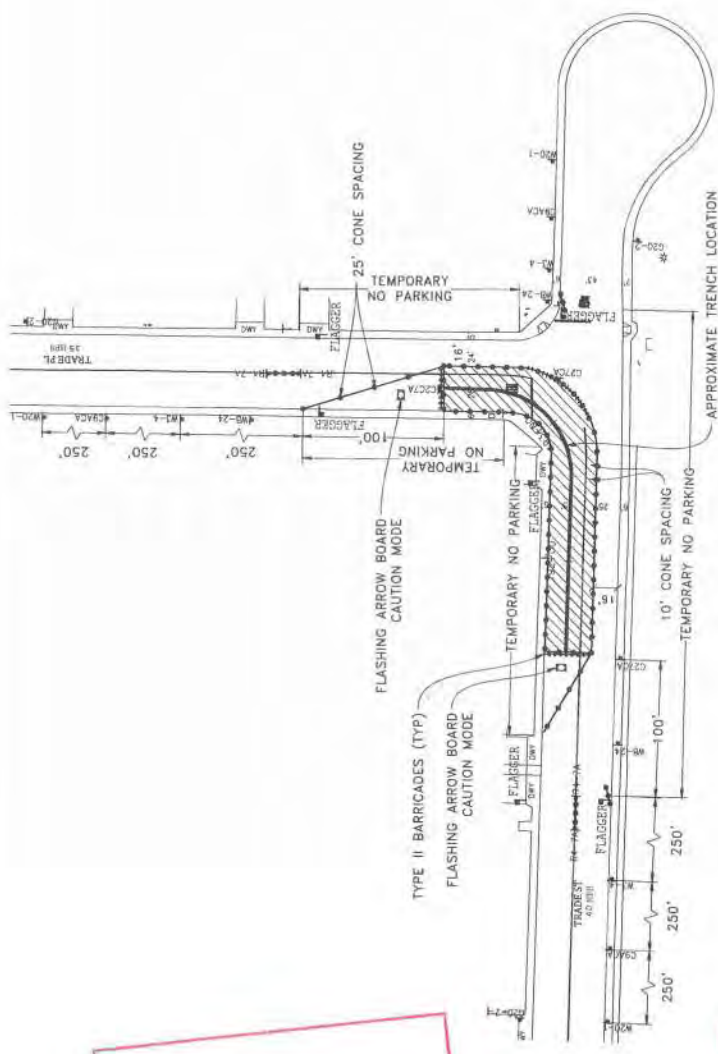

APPROVED
TRAFFIC CONTROL PERMIT

MAY 18 2017

CITY OF SAN DIEGO
 Development Services
 Engineering Division
 Traffic Safety Section

ORIGINAL PERMIT MUST
BE KEPT
ON JOB SITE ALL TIMES

NOTE: CONTRACTOR WILL COORDINATE ALL WORK WITH FIRE STATION PRIOR TO START OF WORK.

NOTE: CONTRACTOR WILL COORDINATE ALL WORK WITH RESIDENTS PRIOR TO START OF WORK.

NOTE: CONTRACTOR WILL COORDINATE ALL WORK WITH EXISTING PROJECTS AND NOT CONFLICT WITH EXISTING TRAFFIC CONTROL.

NOTE: CONTRACTOR WILL PROVIDE ACCESS TO DRIVEWAYS AT ALL TIMES.

NOTE: CONTRACTOR WILL PROVIDE ALL VEHICLES WITH SAFETY PLATES AND EGRESS AT ALL TIMES.

NOTE: VEHICLES WITH SAFETY PLATES AND EGRESS AT ALL TIMES WILL BE SUBJECT TO INSPECTION BY AGENCY.

NOTE: CONTRACTOR WILL COORDINATE ALL WORK WITH RESIDENTS PRIOR TO START OF WORK.

NOTE: CONTRACTOR WILL COORDINATE ALL WORK WITH BUSINESSES PRIOR TO START OF WORK.

- LEGEND**
- SIGN
 - TRAFFIC CONES / DELINEATOR
 - BARRICADE
 - FLAGGER
 - FLASHING ARROW SIGN
 - WORK ZONE
 - BUS STOP

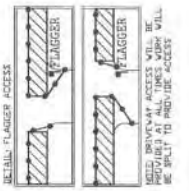

NOTE: CONTRACTOR WILL COORDINATE ALL WORK WITH FIRE STATION PRIOR TO START OF WORK.

NOTE: CONTRACTOR WILL COORDINATE ALL WORK WITH RESIDENTS PRIOR TO START OF WORK.

NOTE: CONTRACTOR WILL COORDINATE ALL WORK WITH EXISTING PROJECTS AND NOT CONFLICT WITH EXISTING TRAFFIC CONTROL.

NOTE: CONTRACTOR WILL PROVIDE ACCESS TO DRIVEWAYS AT ALL TIMES.

NOTE: CONTRACTOR WILL PROVIDE ALL VEHICLES WITH SAFETY PLATES AND EGRESS AT ALL TIMES.

NOTE: VEHICLES WITH SAFETY PLATES AND EGRESS AT ALL TIMES WILL BE SUBJECT TO INSPECTION BY AGENCY.

NOTE: CONTRACTOR WILL COORDINATE ALL WORK WITH RESIDENTS PRIOR TO START OF WORK.

NOTE: CONTRACTOR WILL COORDINATE ALL WORK WITH BUSINESSES PRIOR TO START OF WORK.

- LEGEND**
- SIGN
 - TRAFFIC CONES / DELINEATOR
 - BARRICADE
 - FLAGGER
 - FLASHING ARROW SIGN
 - WORK ZONE
 - BUS STOP

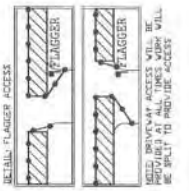

NIGHT WORK ONLY
PHASE 41

WORK HOURS: 5:00PM - 11:30PM

ALL CONTACTS SHALL BE MAINTAINED THROUGHOUT THE PROJECT.

FLAGGER WILL ASSIST WITH TRAFFIC CONTROL.

PROJECT NAME: TL23071 - SYCAMORE CANYON SUBSTATION TO PENASQUITOS - 230 KV UNDERGROUND

DATE: Mar. 29, 2017

DESIGNED BY: Clint Jones

THOMAS GRID# -

DRAWN FOR: CITY OF SAN DIEGO

SHEET 051 OF 148

PROJECT NAME: TL23071 - SYCAMORE CANYON SUBSTATION TO PENASQUITOS - 230 KV UNDERGROUND

DATE: Mar. 29, 2017

DESIGNED BY: Clint Jones

THOMAS GRID# -

DRAWN FOR: CITY OF SAN DIEGO

SHEET 051 OF 148

PROJECT NAME: TL23071 - SYCAMORE CANYON SUBSTATION TO PENASQUITOS - 230 KV UNDERGROUND

DATE: Mar. 29, 2017

DESIGNED BY: Clint Jones

THOMAS GRID# -

DRAWN FOR: CITY OF SAN DIEGO

SHEET 051 OF 148

ARX SURVEYORS, INC.

Gail McMoran
 President

2034 EAST CLAYMONT PARKWAY, SUITE D
 ESCONDIDO, CA 92027
 PHONE: (760) 943-3228
 CELL: (760) 418-3228

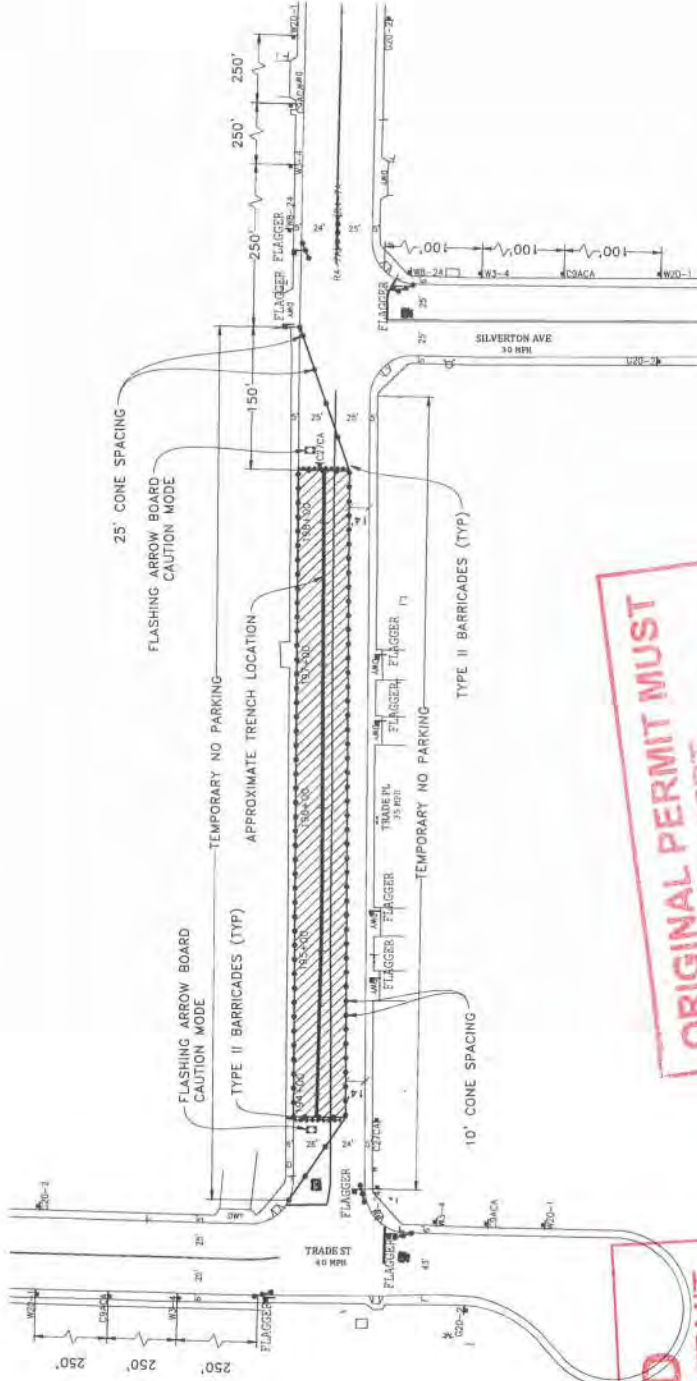

ORIGINAL PERMIT MUST BE KEPT ON JOB SITE ALL TIMES

APPROVED TRAFFIC CONTROL PERMIT
 MAY 18 2017
 CITY OF SAN DIEGO
 Development Services
 Engineering Division
 Traffic Safety Section

- LEGEND**
- 1 SIGNAL
 - 2 TRAFFIC CONES / DELINEATOR
 - 3 BARRICADE
 - 4 FLAGGER
 - 5 FLASHING ARROW SIGN
 - 6 WORK ZONE
 - 7 BUS STOP

NOTE: FLAGGERS WILL PROVIDE ACCESS TO DRIVERS AT ALL TIMES.
 NOTE: FLAGGERS WILL SAFELY GUIDE PEDESTRIANS THROUGH WORK AREA.
 NOTE: CONTRACTOR WILL PROVIDE ACCESS BY ALL TIMES.
 NOTE: PEDESTRIAN ACCESS WILL BE MAINTAINED THROUGHOUT THE DURATION OF WORK.

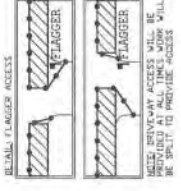

NOTE: CONTRACTOR WILL COORDINATE ALL WORK WITH FIRE STATION PRIOR TO START OF WORK.
 NOTE: CONTRACTOR WILL COORDINATE ALL WORK WITH PEDESTRIAN DEPARTMENT PRIOR TO START OF WORK.
 NOTE: CONTRACTOR WILL COORDINATE ALL WORK WITH EXISTING PROJECTS AND NOT CONFLICT WITH EXISTING TRAFFIC CONTROL.

NOTE: CONTRACTOR WILL COORDINATE ALL WORK WITH PEDESTRIAN DEPARTMENT PRIOR TO START OF WORK.
 NOTE: CONTRACTOR WILL COORDINATE ALL WORK WITH EXISTING PROJECTS AND NOT CONFLICT WITH EXISTING TRAFFIC CONTROL.

NOTE: CONTRACTOR WILL COORDINATE ALL WORK WITH PEDESTRIAN DEPARTMENT PRIOR TO START OF WORK.
 NOTE: CONTRACTOR WILL COORDINATE ALL WORK WITH EXISTING PROJECTS AND NOT CONFLICT WITH EXISTING TRAFFIC CONTROL.



WORK HOURS: 5:00PM TO 5:00AM
 THE CONTRACTOR SHALL BE RESPONSIBLE FOR THE PROTECTION OF ALL UTILITIES AND STRUCTURES TO REMAIN.
 FLAGGER WILL ASSESS AND BE RESPONSIBLE FOR ALL DAMAGE TO UTILITIES AND STRUCTURES.

**NIGHT WORK ONLY
 PHASE 42**

PROJECT NAME: TL23071 - SYCAMORE CANYON SUBSTATION TO PENASQUITOS - 230 KV UNDERGROUND	DATE: Mar. 29, 2017
AIRX JOB# X160218	DESIGNED BY: Clint James
TYPE OF WORK: TRENCHING / CONDUIT	THOMAS GRID# -
MISC/POTHoles#	DRAWN FOR: CITY OF SAN DIEGO
SHEET 052 OF 148	

AIRX
 SURVEYORS, INC.
 Gail McMoran
 President
 204 CAPITAL WORTH PARKWAY, SUITE C
 SAN DIEGO, CA 92108
 PHONE: (619) 464-2474
 CELL: (619) 448-3728

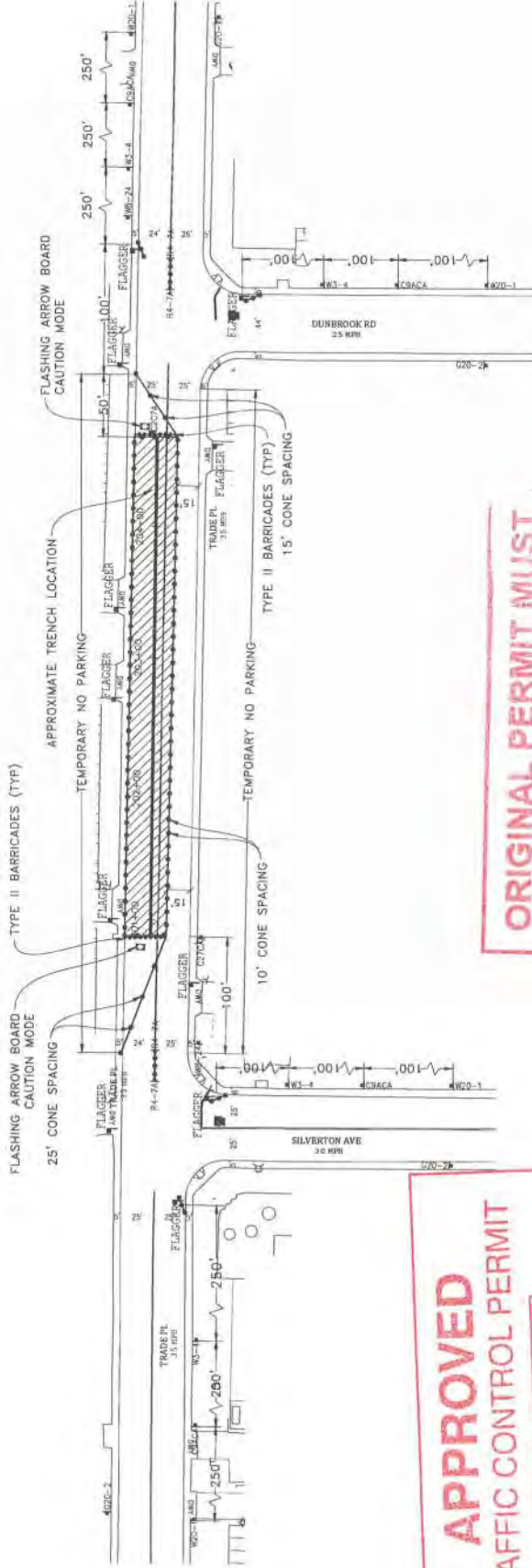

APPROVED
TRAFFIC CONTROL PERMIT

MAY 18 2017

CITY OF SAN DIEGO
Development Services
Engineering Division
Traffic Safety Section

**ORIGINAL PERMIT MUST
BE KEPT
ON JOB SITE ALL TIMES**

LEGEND

- SIGN
- TRAFFIC CONES / DELINEATOR
- BARRICADE
- FLAGGER
- FLASHING ARROW SIGN
- WORK ZONE
- BUS STOP

NOTE: FLAGGERS WILL PROVIDE ACCESS TO DRIVEWAYS AT ALL TIMES

NOTE: FLAGGERS WILL SAFELY TRAFFIC TRAMS THROUGH WORK AREA

NOTE: CONTRACTOR WILL ALLOW FIRE STATION INGRESS AND EGRESS AT ALL TIMES

NOTE: 18" x 24" STEEL PLATES WILL BE PROVIDED AT EACH END OF TRENCH TO PROVIDE ACCESS

REGULAR FLAGGER ACCESS



NOTE: DRIVEWAY ACCESS WILL BE PROVIDED AT EACH END OF TRENCH TO PROVIDE ACCESS

NOTE: CONTRACTOR WILL COORDINATE ALL WORK WITH FIRE STATION PRIOR TO START OF WORK

NOTE: CONTRACTOR WILL COORDINATE ALL WORK WITH TRANSIT DEPARTMENT 5 DAYS PRIOR TO START OF WORK

NOTE: CONTRACTOR WILL COORDINATE ALL WORK WITH BUSINESSES PRIOR TO START OF WORK

NOTE: CONTRACTOR WILL COORDINATE ALL WORK WITH RESIDENTS PRIOR TO START OF WORK

NOTE: CONTRACTOR WILL COORDINATE ALL WORK WITH BUSINESSES PRIOR TO START OF WORK

WORK HOURS - 6:00PM TO 3:00AM

USE CONE TRAFFIC CONTROL TO MAINTAIN TRAFFIC CONTROL TO USE 2-DAY COMMUNICATION PLAN TO MAINTAIN TRAFFIC CONTROL

**NIGHT WORK ONLY
PHASE 44**

DATE: Mar. 29, 2017
DESIGNED BY: Clint James
SHEET 054 OF 148

PROJECT NAME: TL23071 - SYCAMORE CANYON SUBSTATION TO PENASQUITOS - 230 KV UNDERGROUND
AIRX JOB#: X1160218
TYPE OF WORK: TRENCHING / CONDUIT
MISCELLANEOUS: THOMAS GRID -

AIRX
GAIL MCMORMAN
President
201 EAST CLAYTON AVE, SUITE G
SAN DIEGO, CA 92101
PHONE: (619) 444-3247
CELL: (619) 418-3728

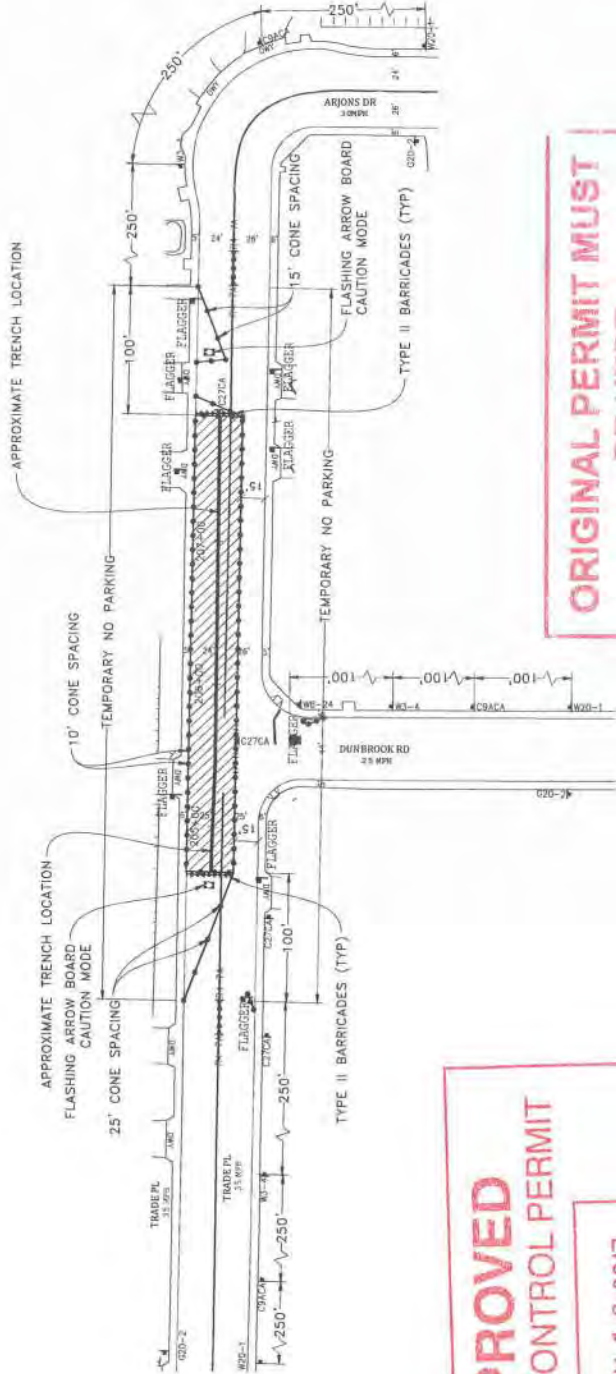

APPROVED
TRAFFIC CONTROL PERMIT

MAY 1 8 2017

CITY OF SAN DIEGO
 Development Services
 Engineering Division
 Traffic Safety Section

**ORIGINAL PERMIT MUST
 BE KEPT
 ON JOB SITE ALL TIMES**

- LEGEND**
- SIGN
 - SIGNAL
 - TRAFFIC CONES / DELINEATOR
 - BARRICADE
 - FLASHER
 - FLASHING ARROW SIGN
 - WORK ZONE
 - BUS STOP

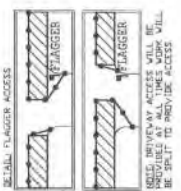

NOTE: FLAGGERS WILL PROVIDE ACCESS TO DRIVEWAYS AT ALL TIMES

NOTE: FLAGGERS WILL SAFELY STRAIN THROUGH WORK AREA

NOTE: CONTRACTORS WILL ALLOW FIRE STATION INGRESS AND EGRESS AT ALL TIMES

NOTE: 48"x24" STEEL PLATES W/ E-60 SIGNS WILL REMAIN IN PLACE FOR DURATION OF PERMIT

NOTE: CONTRACTOR WILL COORDINATE ALL WORK WITH FIRE STATION PRIOR TO START OF WORK

NOTE: CONTRACTOR WILL COORDINATE ALL WORK WITH RESIDENTS PRIOR TO START OF WORK

NOTE: CONTRACTOR WILL COORDINATE ALL WORK WITH EXISTING PROJECTS AND NOT CONFLICT WITH EXISTING TRAFFIC CONTROL

NOTE: CONTRACTOR WILL COORDINATE ALL WORK WITH BUSINESSES PRIOR TO START OF WORK

NOTE: CONTRACTOR WILL COORDINATE ALL WORK WITH BUSINESSES PRIOR TO START OF WORK

WORK HOURS _____ TO _____

NIGHT WORK ONLY

PHASE 45

NOTE: EYE CONTACT MUST BE MAINTAINED BETWEEN FLAGGER AND ALL VEHICLES IN THE WORK ZONE

AIRX SURVEYORS, INC.

Gail McMorrin
 President

2504 EAST CLAYTON PARKWAY, SUITE C
 ESCONDIDO CA 92027
 PHONE: 760.434.3407
 CELL: 760.434.3278

PROJECT NAME: TL23071 - SYCAMORE CANYON SUBSTATION TO PENASQUITOS - 230 KV UNDERGROUND	DATE: Mar. 29, 2017
ARX JOB#: X160218	DESIGNED BY: Clint Jones
TYPE OF WORK: TRENCHING / CONDUIT	THOMAS GRID# -
MISC/POTHOLE#:	DRAWN FOR: CITY OF SAN DIEGO

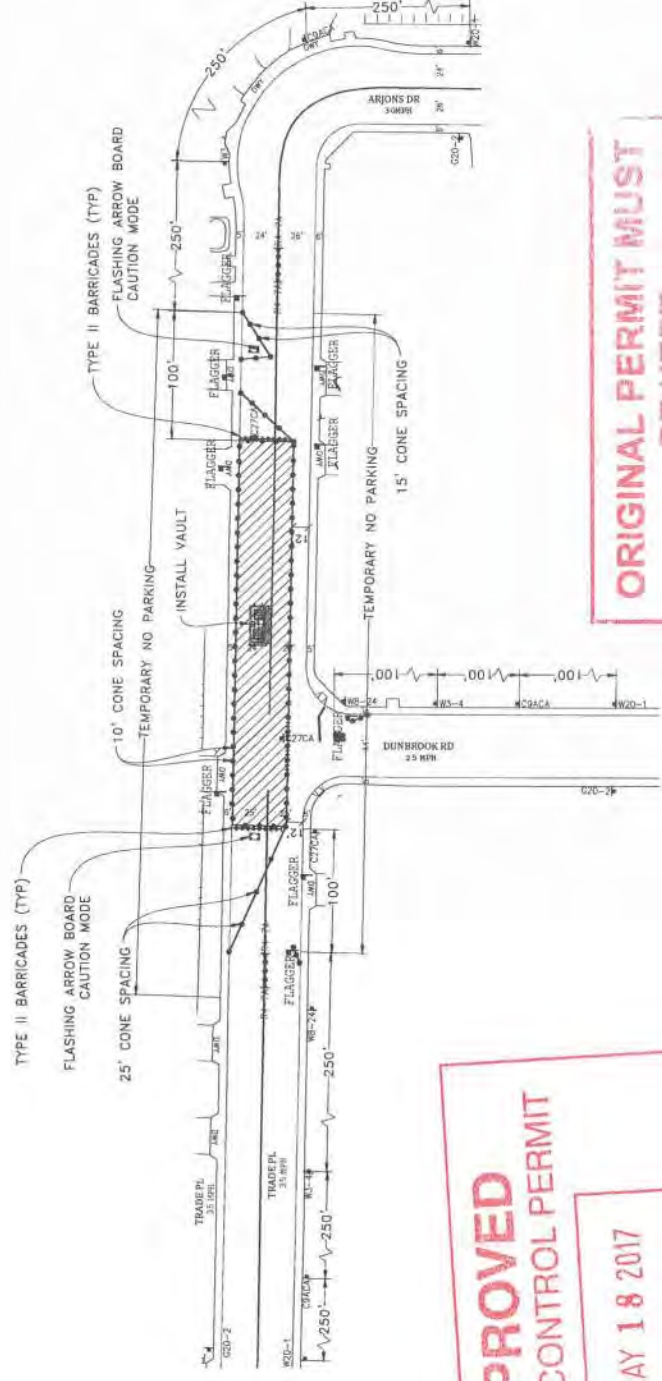

SCALE 1" = 40'

**ORIGINAL PERMIT MUST
BE KEPT
ON JOB SITE ALL TIMES**

**APPROVED
TRAFFIC CONTROL PERMIT**

MAY 18 2017

**CITY OF SAN DIEGO
Development Services
Engineering Division
Traffic Safety Section**

- LEGEND**
- SIGN
 - SIGNAL
 - TRAFFIC CONES / DELINEATOR
 - BARRICADE
 - FLAGGER
 - FLASHING ARROW SIGN
 - WORK ZONE
 - BUS STOP

- DETAIL FLAGGER ACCESS**
- NOTE: CONTRACTOR WILL COORDINATE ALL WORK WITH FIRE STATION HOUS TO START OF WORK.
 - NOTE: CONTRACTOR WILL COORDINATE ALL WORK WITH TRANSIT DEPARTMENT 5 DAYS PRIOR TO START OF WORK.
 - NOTE: CONTRACTOR WILL COORDINATE ALL WORK WITH BUS STOP LOCATIONS AND NOT CONFLICT WITH EXISTING TRAFFIC CONTROL.
 - NOTE: CONTRACTOR WILL PROVIDE ACCESS TO DRIVEWAYS AT ALL TIMES.
 - NOTE: FLAGGERS WILL SAPELY CROSS EXISTING THROUGH WORK AREA.
 - NOTE: CONTRACTOR WILL ALLOW FINE STATION INGRESS AND EGRESS AT ALL TIMES.
 - NOTE: VET-PA STEEL PLATES PLACE FOR INSTALLATION OF BUS STOP.

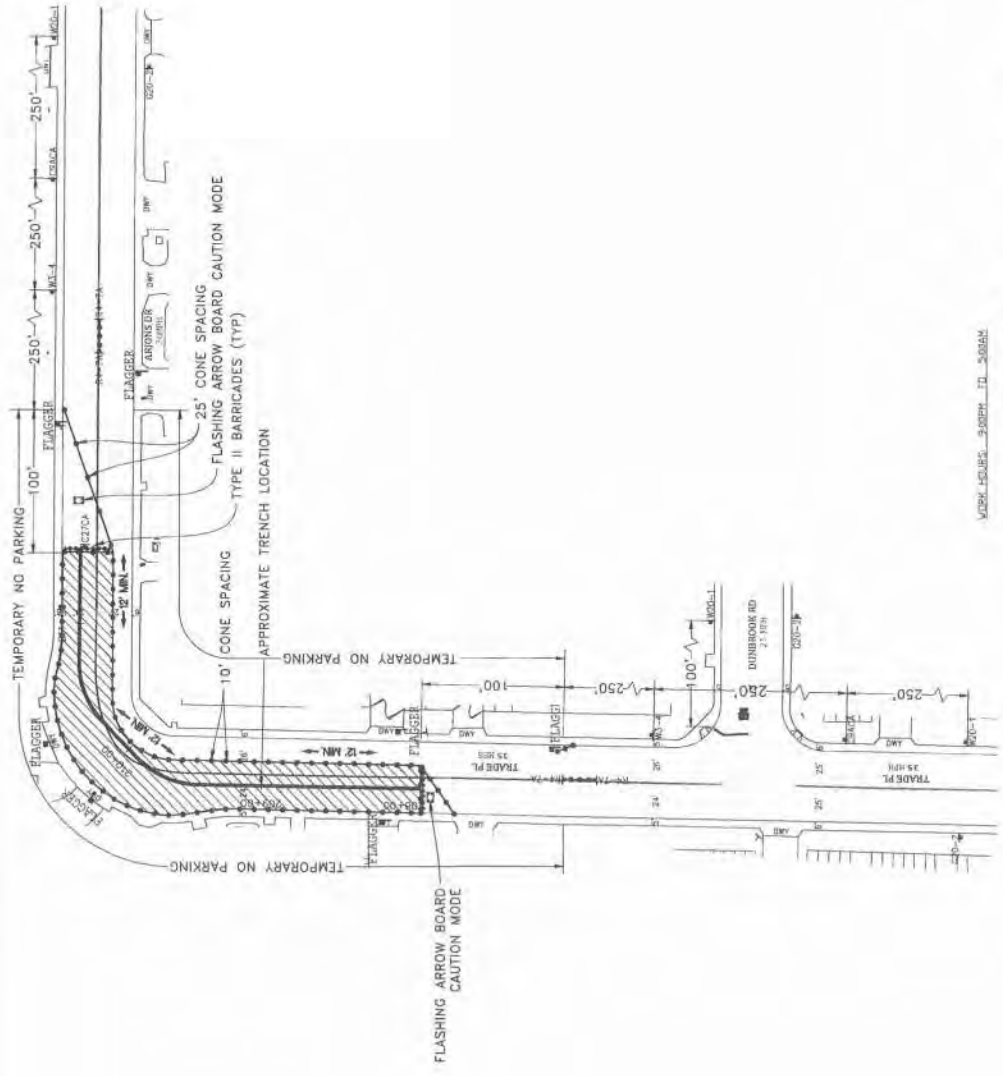

WORK LIGHTS - SUPPLY TO - 50624

THE CONTRACTOR MUST BE MAINTAINED BETWEEN FLAGGERS OR USE 2 1/2" DIA. COMMUNICATION FLAGGER WILL ASSIST WITH ONE ANCHOR LINE BARRICADE

**NIGHT WORK ONLY
PHASE 47**

PROJECT NAME: TL23071 - SYCAMORE CANYON SUBSTATION TO PENASQUITOS - 230 KV UNDERGROUND

AIRX JOB#: X150218

TYPE OF WORK: TRENCHING / CONDUIT

MISCIPOTHOLE#:

DATE: Mar. 29, 2017

DESIGNED BY: Clint Jones

THOMAS GRDF -

DRAWN FOR: CITY OF SAN DIEGO

DR. GAIL MCMORRAN
PRESIDENT

2551 CANTON HORNS PARKWAY, SUITE C
RICHMOND, CA 94807
PHONE: (925) 461-8001
CELL: (925) 419-3228

UTILITY SURVEYORS, INC.

AIRX

SHEET 057 OF 148

APPROVED TRAFFIC CONTROL PERMIT

MAY 18 2017

CITY OF SAN DIEGO
Development Services
Engineering Division
Traffic Safety Section

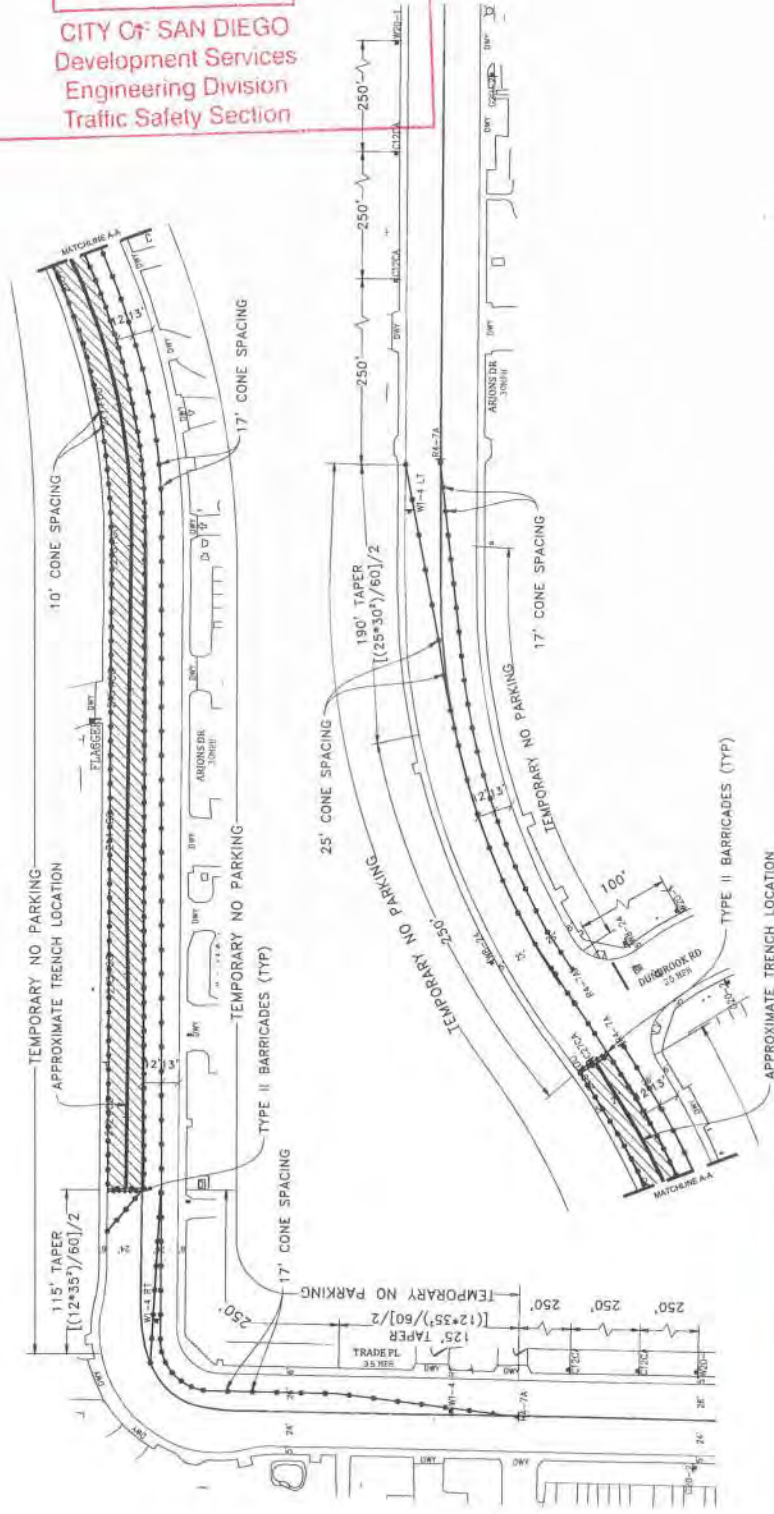

SCALE 1" = 40'

NIGHT WORK ONLY
PHASE 48

DATE: Mar. 29, 2017
DESIGNED BY:
Clint Jones

SHEET 058 OF 148

PROJECT NAME: TL23071 - SYCAMORE CANYON SUBSTATION TO
PENASQUITOS - 230 KV UNDERGROUND

AIRX JOB#: X15021B

TYPE OF WORK: TRENCHING / CONDUIT
DRAWN FOR: CITY OF SAN DIEGO

MISOPOTHOLE#:

Gail McMorran
President



NOTE: CONTRACTOR WILL COORDINATE ALL WORK WITH FIRE STATION PRIOR TO START OF WORK.
NOTE: CONTRACTOR WILL COORDINATE ALL WORK WITH TRANSIT DEPARTMENT 5 DAYS PRIOR TO START OF WORK.
NOTE: CONTRACTOR WILL COORDINATE ALL WORK WITH BUSINESSES PRIOR TO START OF WORK AND NOT CONFLICT WITH EXISTING TRAFFIC CONTROL.

WORK SQUARES: 300PM TO 5:00PM

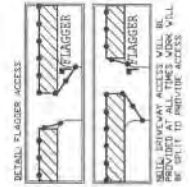

ORIGINAL PERMIT MUST
BE KEPT
ON JOB SITE ALL TIMES

LEGEND

- SIGN
- SIGNAL
- TRAFFIC CONES / DELINEATOR
- BARRICADE
- FLAGGER
- FLASHING ARROW SIGN
- WORK ZONE
- BUS STOP

NOTE: FLAGGERS WILL PROVIDE ACCESS TO DRIVEWAYS AT ALL TIMES.
NOTE: FLAGGERS WILL SAFELY TRAFFIC THROUGH WORK AREA.
NOTE: CONTRACTOR WILL ALLOW FIRE STATION INGRESS AND EGRESS AT ALL TIMES.
NOTE: VIB-RAP STEEL PLATES SHALL BE USED FOR DURATION OF WORK.

**ORIGINAL PERMIT MUST
BE KEPT
ON JOB SITE ALL TIMES**

**APPROVED
TRAFFIC CONTROL PERMIT**

MAY 18 2017

**CITY OF SAN DIEGO
Development Services
Engineering Division
Traffic Safety Section**

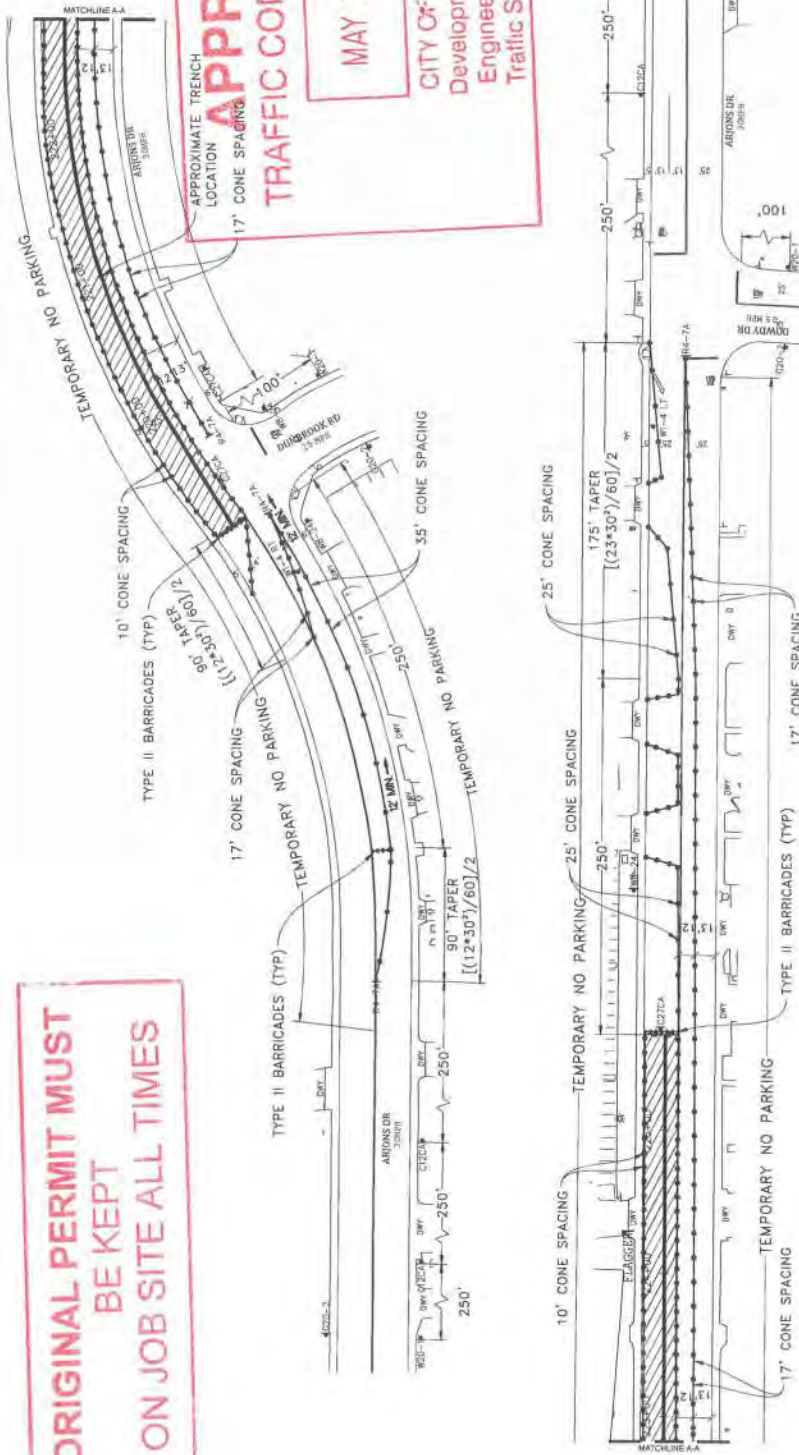

NOTE: CONTRACTOR WILL COORDINATE ALL WORK WITH RESIDENTS PRIOR TO START OF WORK

NOTE: CONTRACTOR WILL COORDINATE ALL WORK WITH TRANSIT DEPARTMENT 5 DAYS PRIOR TO START OF WORK

NOTE: CONTRACTOR WILL COORDINATE ALL WORK WITH EXISTING PROJECTS THROUGH THE CITY OF SAN DIEGO TRAFFIC CONTROL

NOTE: CONTRACTOR WILL COORDINATE ALL WORK WITH RESIDENTS PRIOR TO START OF WORK

NOTE: CONTRACTOR WILL COORDINATE ALL WORK WITH TRANSIT DEPARTMENT 5 DAYS PRIOR TO START OF WORK

NOTE: CONTRACTOR WILL COORDINATE ALL WORK WITH EXISTING PROJECTS THROUGH THE CITY OF SAN DIEGO TRAFFIC CONTROL

- LEGEND**
- SIGNAL
 - TRAFFIC CONES / DELINEATOR
 - BARRICADE
 - FLAGGER
 - FLASHING ARROW SIGN
 - WORK ZONE
 - BUS STOP

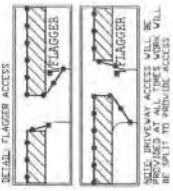

NOTE: CONTRACTOR WILL COORDINATE ALL WORK WITH RESIDENTS PRIOR TO START OF WORK

NOTE: CONTRACTOR WILL COORDINATE ALL WORK WITH TRANSIT DEPARTMENT 5 DAYS PRIOR TO START OF WORK

NOTE: CONTRACTOR WILL COORDINATE ALL WORK WITH EXISTING PROJECTS THROUGH THE CITY OF SAN DIEGO TRAFFIC CONTROL

NOTE: CONTRACTOR WILL COORDINATE ALL WORK WITH RESIDENTS PRIOR TO START OF WORK

NOTE: CONTRACTOR WILL COORDINATE ALL WORK WITH TRANSIT DEPARTMENT 5 DAYS PRIOR TO START OF WORK

NOTE: CONTRACTOR WILL COORDINATE ALL WORK WITH EXISTING PROJECTS THROUGH THE CITY OF SAN DIEGO TRAFFIC CONTROL

WORK HOURS: 5:00PM TO 5:00AM



**NIGHT WORK ONLY
PHASE 49**

DATE: Mar. 29, 2017
DESIGNED BY: Clint Jones
SHEET 059 OF 148

PROJECT NAME: TL23071 - SYCAMORE CANYON SUBSTATION TO PENASQUITOS - 230 KV UNDERGROUND

AIRX JOB#: X150218

THOMAS GRID# -

TYPED FOR: CITY OF SAN DIEGO

MISC/POTHOLES# -

AIRX
by PENWOODS, INC.

Gail McMoran
President

1353 EAST DEL MARTE PARKWAY, SUITE C
SAN DIEGO, CA 92108
PHONE: (619) 460-2347
FAX: (619) 419-0728

**ORIGINAL PERMIT MUST
BE KEPT
ON JOB SITE ALL TIMES**

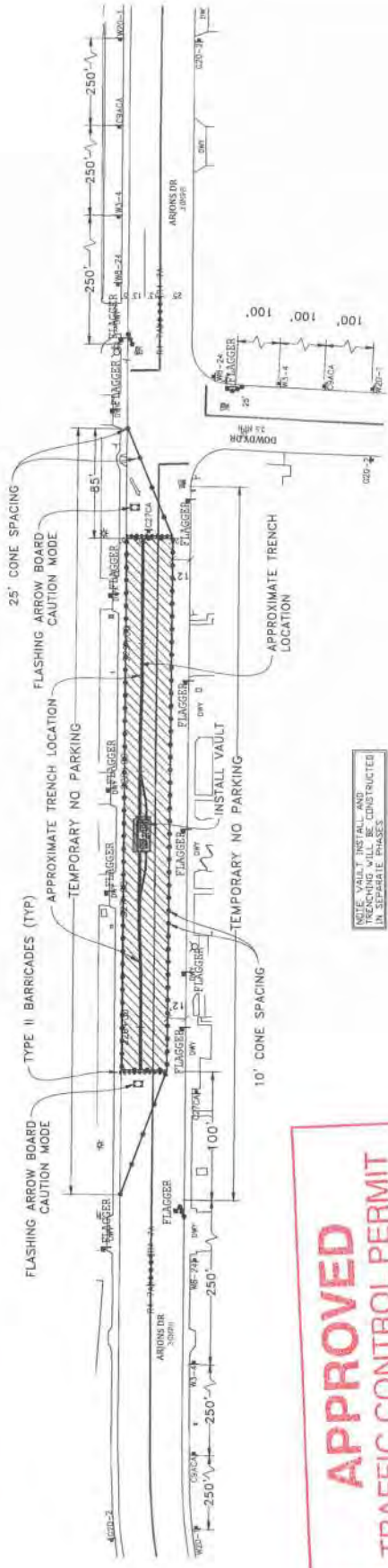

**APPROVED
TRAFFIC CONTROL PERMIT**

MAY 18 2017

CITY OF SAN DIEGO
Development Services
Engineering Division
Traffic Safety Section

- LEGEND**
- SIGN
 - SIGNAL
 - TRAFFIC CONES / DELINEATOR
 - BARRICADE
 - FLAGGER
 - FLASHING ARROW SIGN
 - WORK ZONE
 - BUS STOP

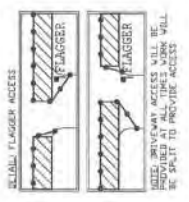

NOTE: FLAGGERS WILL PROVIDE ACCESS TO DRIVEWAYS AT ALL TIMES.

NOTE: CONTRACTOR WILL SUPPLY GUIDE POSTS/STRAPS THROUGH WORK AREA.

NOTE: CONTRACTOR WILL ALLOW FIRE STATION IMPASS AND EGRESS AT ALL TIMES.

NOTE: 18" X 24" STEEL PLATES TO BE PROVIDED TO BE PLACED IN PLACE FOR DURATION OF WORK.

NOTE: CONTRACTOR WILL COORDINATE ALL WORK WITH THE STATION PRIOR TO START OF WORK.

NOTE: CONTRACTOR WILL COORDINATE ALL WORK WITH TRANSIT DEPARTMENT 5 DAYS PRIOR TO START OF WORK.

NOTE: CONTRACTOR WILL COORDINATE ALL WORK WITH EXISTING PROJECTS WITH EXISTING TRAFFIC CONTROL.

NOTE: CONTRACTOR WILL COORDINATE ALL WORK WITH RESIDENTS PRIOR TO START OF WORK.

NOTE: CONTRACTOR WILL COORDINATE ALL WORK WITH BUSINESSES PRIOR TO START OF WORK.

WORK ZONES: 800PM TO 5:00AM

EXCESSIVE SPEEDS MUST BE MAINTAINED BETWEEN FLAGGERS. SEE THE SIGN COMMUNICATION.



**NIGHT WORK ONLY
PHASE 50**

DATE: MAY 29, 2017
DESIGNED BY: CLINT JONES
SHEET 060 OF 148

PROJECT NAME: TL23071 - SYCAMORE CANYON SUBSTATION TO PENASQUITOS - 230 KV UNDERGROUND
AIRX JOB#: X150218
TYPE OF WORK: TRENCHING / CONDUIT
MISCPOTHLES#

THOMAS GRID# -
DRAWN FOR: CITY OF SAN DIEGO

AIRX SUPPLY, INC.
1800 EAST GILBERT AVENUE, SUITE C
SAN DIEGO, CA 92107
PHONE: (619) 463-2947
CALL: (619) 419-1738

Gail McMoran
President