

Traffic Control Permit (TCP) Multiple Location List

(Franchise Utility Company Only - May Not Be Submitted By Contractor)

ORIGINAL PERMIT MUST
BE KEPT
ON JOB SITE ALL TIMES

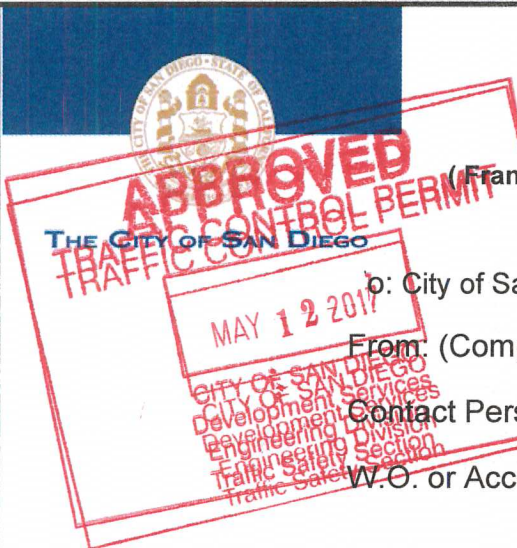

To: City of San Diego, Traffic Permit Section

Date: 5/10/2017

From (Company): SDG&E

Phone No.: 619-778-2405

Contact Person: Rod Nelson

Fax.: _____

W.O. or Account #: Permit # _____

TCP No. _____

City Use Only

Authorized # _____

By Felipe Ariza /RS

Yes No

Date Reviewed 5/11/17

TYPE OF WORK

- 1 = Lane Closure
- 2 = Street Closure
- 3 = Sidewalk Closure
- 4 = Alley Closure
- 5 = Parking Lane
- 6 = Detour
- 7 = Trenching
- 8 = Flagging

Location	From	To	Start Date *	End Date *	Work Hours **	Thomas Bros.	Type of Work
Trade Street	Camino Santa Fe	Carroll Way	5/15/17	6/2/17	9:00PM - 5:00AM	1208-J7, 1209-A7	1,5,7,8
Miralani Drive	Arjons Drive	Camino Ruiz	5/15/17	6/2/17	9:00PM - 5:00AM	1209-C6	1,5,7,8
Activity Road	Camino Ruiz	Black Mountain Road	5/15/17	6/2/17	9:00PM - 5:00AM	1209-D6, E6	1,5,7,8
Black Mountain Road	Kearny Villa Road	Miramar Road	5/15/17	6/2/17	9:00PM - 5:00AM	1209-E6	1,5,7,8

Comments: Vault Crew - Phase 33 (from previous issued permit), Phases 53, 56, 64, 69, and 74 only (Night work hours 9pm - 5am, Sunday night to Thursday night)

Must be submitted a minimum of 2 working days prior to start of work. All columns must be filled out for proper authorization
 Fax or mail to: City of San Diego • Traffic Control Permit Section • 1222 First Avenue, MS 501 • San Diego, CA 92101. Fax (619) 446-5489 Office (619) 446-5150
 * Work Days: Monday Through Friday ** Work Hours : 8:30 AM - 3:30PM. Unless other hours are preapproved)
 No Work on Saturdays, Sundays, or Holidays Unless Approved and Noted In Comments
 Minimum of 5 working days required for construction work which affects traffic signal e-mail info to: dciafre@sandiego.gov

ATTENTION UTILITY COMPANY

Special Inspection Fees May Be Applied By City of San Diego For Any Night or Weekend Work.

** No work 5/29/17 City Holiday*

APPROVED
TRAFFIC CONTROL PERMIT

MAY 12 2017

CITY OF SAN DIEGO
Development Services
Engineering Division
Traffic Safety Section

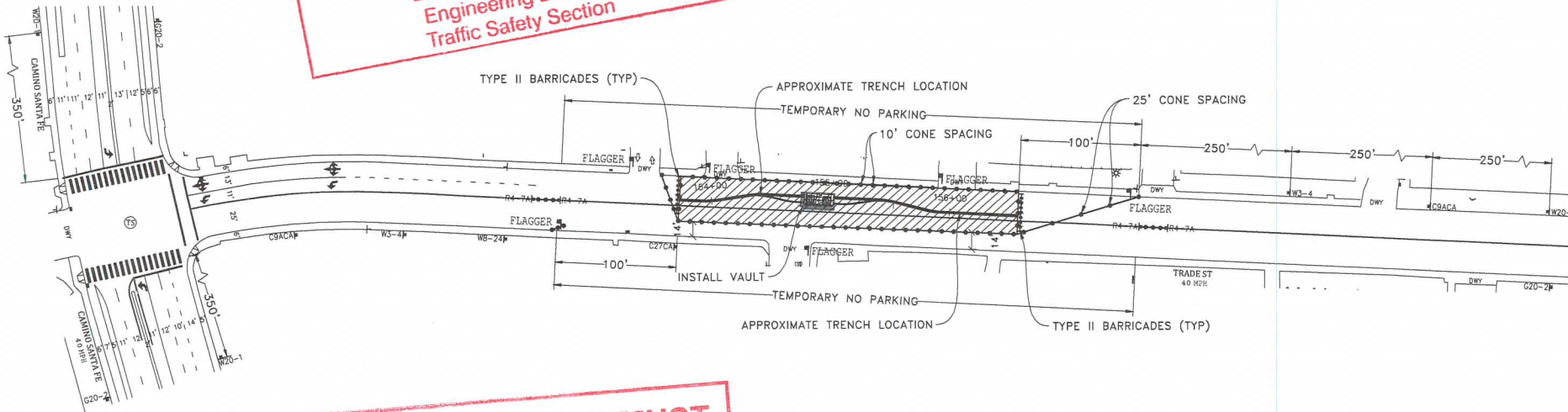

ORIGINAL PERMIT MUST
BE KEPT
ON JOB SITE ALL TIMES

LEGEND

- SIGN
- SIGNAL
- TRAFFIC CONES / DELINEATOR
- BARRICADE
- FLAGGER
- FLASHING ARROW SIGN
- WORK ZONE
- BUS STOP

NOTE: FLAGGERS WILL PROVIDE ACCESS TO DRIVEWAYS AT ALL TIMES

NOTE: FLAGGERS WILL SAFELY GUIDE PEDESTRIANS THROUGH WORK AREA

NOTE: CONTRACTOR WILL ALLOW FIRE STATION INGRESS AND EGRESS AT ALL TIMES

NOTE: W8-24 (STEEL PLATES AHEAD) SIGNS WILL REMAIN IN PLACE FOR DURATION OF WORK

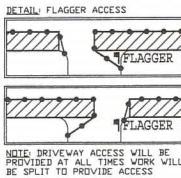

NOTE: CONTRACTOR WILL COORDINATE ALL WORK WITH FIRE STATION PRIOR TO START OF WORK

NOTE: CONTRACTOR WILL COORDINATE ALL WORK WITH TRANSIT DEPARTMENT 5 DAYS PRIOR TO START OF WORK

NOTE: CONTRACTOR WILL COORDINATE ALL WORK WITH EXISTING PROJECTS AND NOT CONFLICT WITH EXISTING TRAFFIC CONTROL

NOTE: CONTRACTOR WILL COORDINATE ALL WORK WITH RESIDENTS PRIOR TO START OF WORK

NOTE: CONTRACTOR WILL COORDINATE ALL WORK WITH BUSINESSES PRIOR TO START OF WORK

WORK HOURS: _____ TO _____

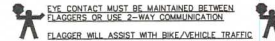

NIGHT WORK ONLY
PHASE 33

UTILITY SURVEYORS, INC.
AIRX
2534 EAST EL NORTE PARKWAY, SUITE C
ESCONDIDO, CA 92027
PHONE: (760) 490-0347
CELL: (760) 419-3738

Gail McMorran
President

PROJECT NAME: TL23071 - SYCAMORE CANYON SUBSTATION TO PENASQUITOS - 230 KV UNDERGROUND	
AIRX JOB#: X160218	THOMAS GRID#: -
TYPE OF WORK: TRENCHING / CONDUIT	DRAWN FOR: CITY OF SAN DIEGO
MISC/POTHOLE#:	

DATE: Mar. 15, 2017
DESIGNED BY:
Clint Jones

SHEET 043 OF 148



APPROVED
TRAFFIC CONTROL PERMIT
MAY 12 2017
 CITY OF SAN DIEGO
 Development Services
 Engineering Division
 Traffic Safety Section

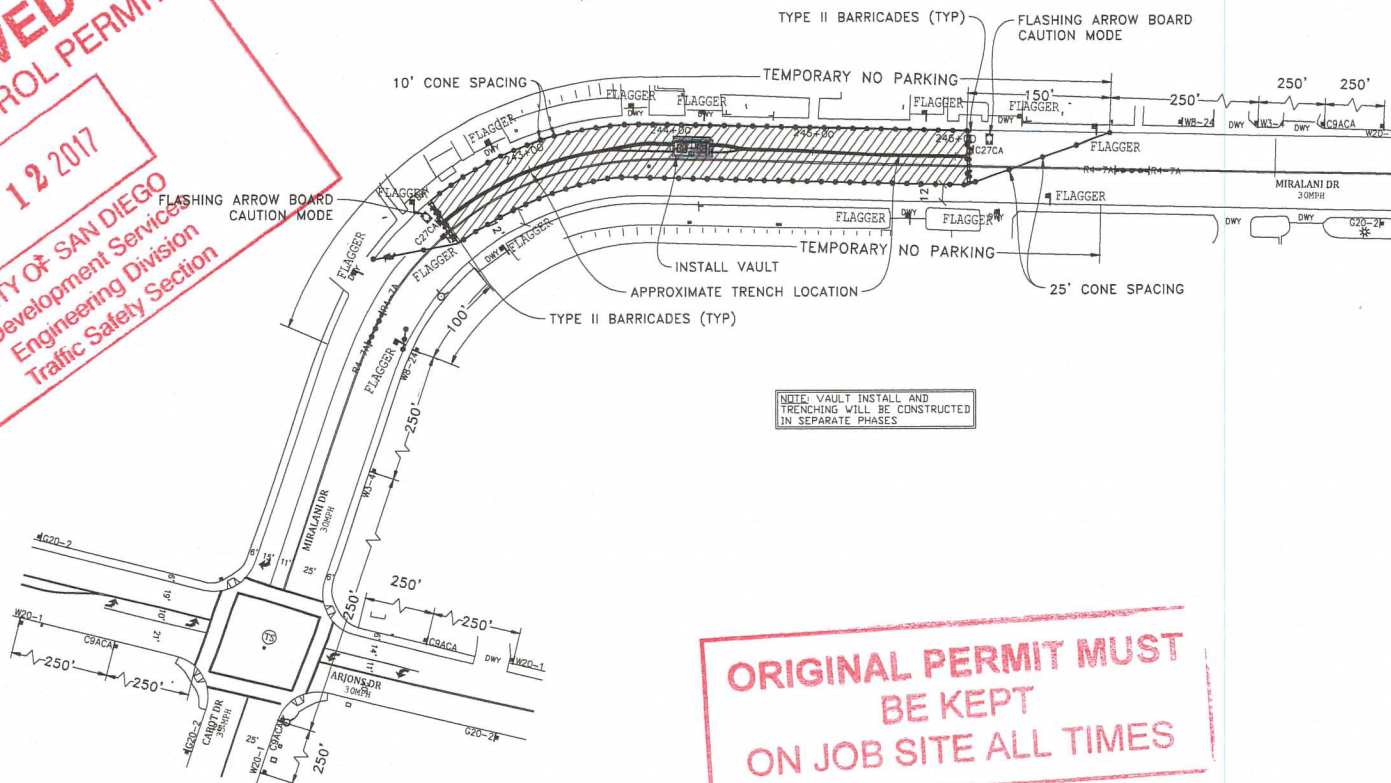

NOTE: VAULT INSTALL AND TRENCHING WILL BE CONSTRUCTED IN SEPARATE PHASES

ORIGINAL PERMIT MUST
BE KEPT
ON JOB SITE ALL TIMES

LEGEND

- SIGN
- SIGNAL
- TRAFFIC CONES / DELINEATOR
- BARRICADE
- FLAGGER
- FLASHING ARROW SIGN
- WORK ZONE
- BUS STOP

NOTE: FLAGGERS WILL PROVIDE ACCESS TO DRIVEWAYS AT ALL TIMES

NOTE: FLAGGERS WILL SAFELY GUIDE PEDESTRIANS THROUGH WORK AREA

NOTE: CONTRACTOR WILL ALLOW FIRE STATION INGRESS AND EGRESS AT ALL TIMES

NOTE: WB-24 (STEEL PLATES AHEAD) SIGNS WILL REMAIN IN PLACE FOR DURATION OF WORK

DETAIL: FLAGGER ACCESS

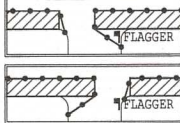

NOTE: DRIVEWAY ACCESS WILL BE PROVIDED AT ALL TIMES WORK WILL BE SPLIT TO PROVIDE ACCESS

NOTE: CONTRACTOR WILL COORDINATE ALL WORK WITH FIRE STATION PRIOR TO START OF WORK

NOTE: CONTRACTOR WILL COORDINATE ALL WORK WITH TRANSIT DEPARTMENT 5 DAYS PRIOR TO START OF WORK

NOTE: CONTRACTOR WILL COORDINATE ALL WORK WITH EXISTING PROJECTS AND NOT CONFLICT WITH EXISTING TRAFFIC CONTROL

NOTE: CONTRACTOR WILL COORDINATE ALL WORK WITH RESIDENTS PRIOR TO START OF WORK

NOTE: CONTRACTOR WILL COORDINATE ALL WORK WITH BUSINESSES PRIOR TO START OF WORK

WORK HOURS: 9:00PM TO 5:00AM

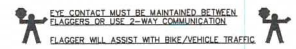

NIGHT WORK ONLY
PHASE 53

UTILITY SURVEYORS, INC.
Gail McMorran
 President
 2534 EAST EL NORTE PARKWAY, SUITE C
 ESCONDIDO, CA 92027
 PHONE: (760) 450-2347
 CELL: (760) 418-3738

PROJECT NAME: TL23071 - SYCAMORE CANYON SUBSTATION TO PENASQUITOS - 230 KV UNDERGROUND	
AIRX JOB#: X160218	THOMAS GRID#: -
TYPE OF WORK: TRENCHING / CONDUIT	DRAWN FOR: CITY OF SAN DIEGO
MISCELLANEOUS#:	

DATE: Mar. 29, 2017
DESIGNED BY: Clint Jones
SHEET 064 OF 148

APPROVED
TRAFFIC CONTROL PERMIT

MAY 12 2017

CITY OF SAN DIEGO
Development Services
Engineering Division
Traffic Safety Section

**ORIGINAL PERMIT MUST
BE KEPT
ON JOB SITE ALL TIMES**

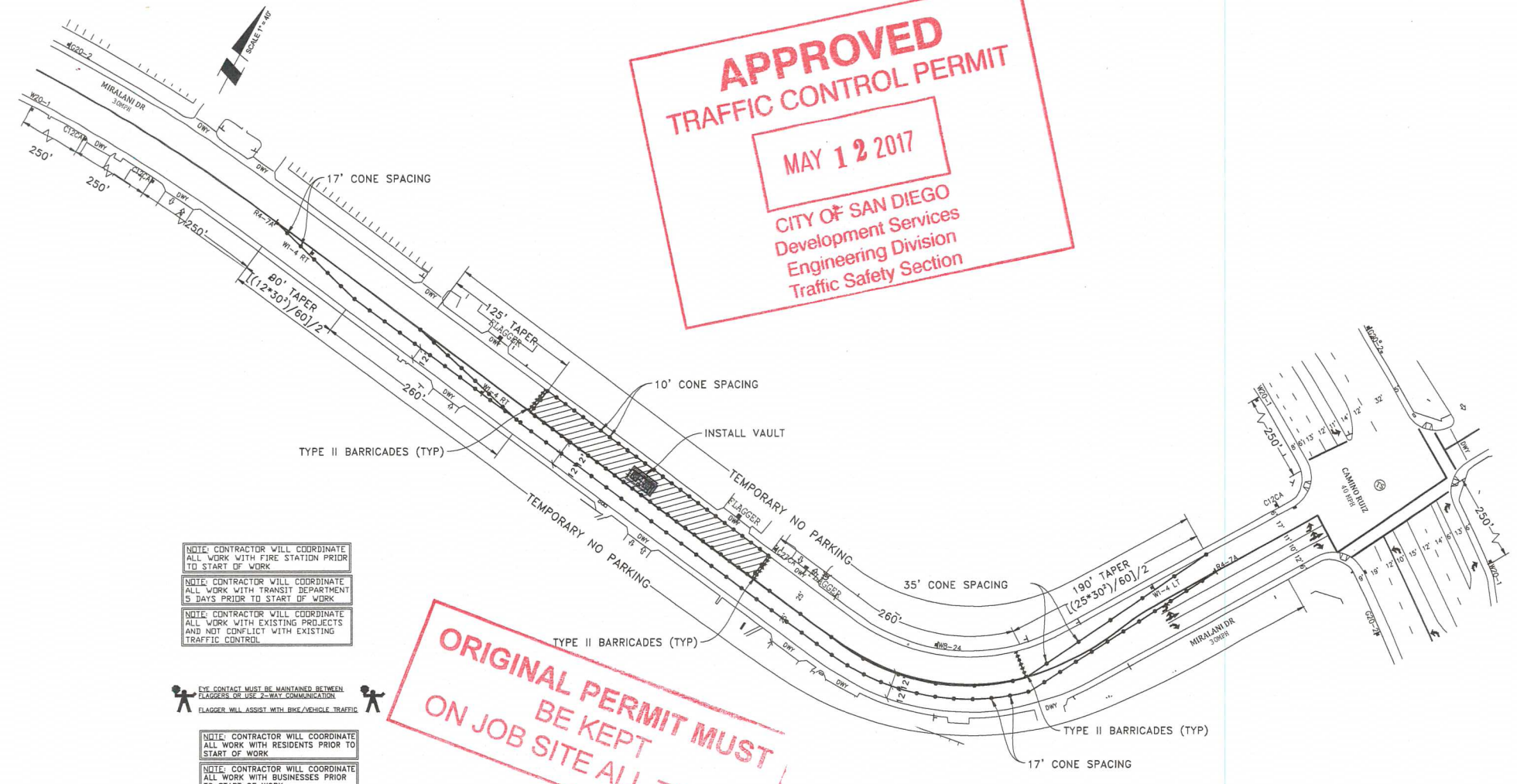

- NOTE: CONTRACTOR WILL COORDINATE ALL WORK WITH FIRE STATION PRIOR TO START OF WORK
- NOTE: CONTRACTOR WILL COORDINATE ALL WORK WITH TRANSIT DEPARTMENT 5 DAYS PRIOR TO START OF WORK
- NOTE: CONTRACTOR WILL COORDINATE ALL WORK WITH EXISTING PROJECTS AND NOT CONFLICT WITH EXISTING TRAFFIC CONTROL

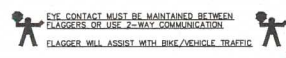

- NOTE: CONTRACTOR WILL COORDINATE ALL WORK WITH RESIDENTS PRIOR TO START OF WORK
- NOTE: CONTRACTOR WILL COORDINATE ALL WORK WITH BUSINESSES PRIOR TO START OF WORK

LEGEND

- SIGN
- SIGNAL
- TRAFFIC CONES / DELINEATOR
- BARRICADE
- FLAGGER
- FLASHING ARROW SIGN
- WORK ZONE
- BUS STOP

- NOTE: FLAGGERS WILL PROVIDE ACCESS TO DRIVEWAYS AT ALL TIMES
- NOTE: FLAGGERS WILL SAFELY GUIDE PEDESTRIANS THROUGH WORK AREA
- NOTE: CONTRACTOR WILL ALLOW FIRE STATION INGRESS AND EGRESS AT ALL TIMES
- NOTE: WB-24 (STEEL PLATES AHEAD) SIGNS WILL REMAIN IN PLACE FOR DURATION OF WORK

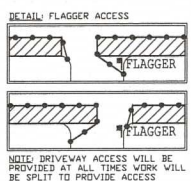

WORK HOURS: 9:00PM TO 5:00AM

UTILITY SURVEYORS, INC.
AIRX
Gail McMorran
President
2534 EAST EL NORTE PARKWAY, SUITE C
ESCONDIDO, CA 92027
PHONE: (760) 450-2347
CELL: (760) 418-3758

PROJECT NAME: TL23071 - SYCAMORE CANYON SUBSTATION TO PENASQUITOS - 230 KV UNDERGROUND	
AIRX JOB#: X160218	THOMAS GRID#: --
TYPE OF WORK: TRENCHING / CONDUIT	DRAWN FOR: CITY OF SAN DIEGO
MISCELLANEOUS#:	

**NIGHT WORK ONLY
PHASE 56**

DATE: Mar. 29, 2017
DESIGNED BY: Clint Jones
SHEET 067 OF 148

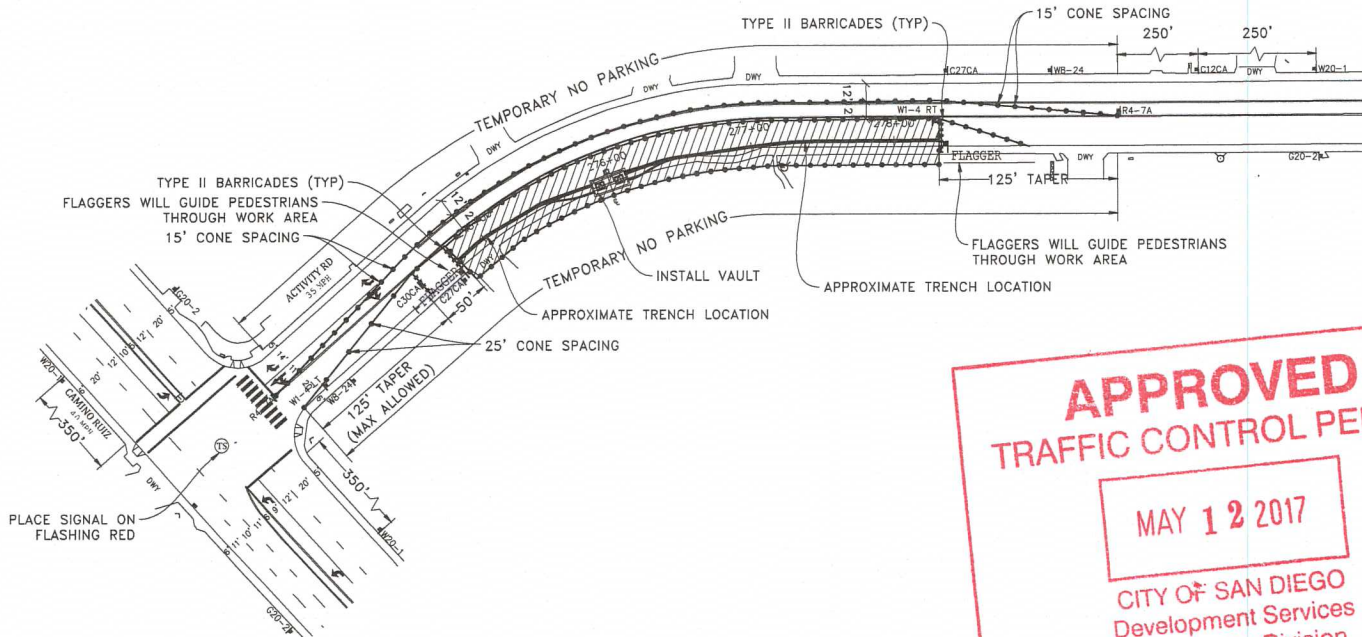

APPROVED
TRAFFIC CONTROL PERMIT

MAY 12 2017

CITY OF SAN DIEGO
Development Services
Engineering Division
Traffic Safety Section

ORIGINAL PERMIT MUST
BE KEPT
ON JOB SITE ALL TIMES

NOTE: VAULT INSTALL AND TRENCHING WILL BE CONSTRUCTED IN SEPARATE PHASES

NOTE: CONTRACTOR WILL COORDINATE ALL WORK WITH FIRE STATION PRIOR TO START OF WORK

NOTE: CONTRACTOR WILL COORDINATE ALL WORK WITH TRANSIT DEPARTMENT 5 DAYS PRIOR TO START OF WORK

NOTE: CONTRACTOR WILL COORDINATE ALL WORK WITH EXISTING PROJECTS AND NOT CONFLICT WITH EXISTING TRAFFIC CONTROL



NOTE: CONTRACTOR WILL COORDINATE ALL WORK WITH RESIDENTS PRIOR TO START OF WORK

NOTE: CONTRACTOR WILL COORDINATE ALL WORK WITH BUSINESSES PRIOR TO START OF WORK

WORK HOURS: 9:00PM TO 5:00AM

EYE CONTACT MUST BE MAINTAINED BETWEEN FLAGGERS OR USE 2-WAY COMMUNICATION
FLAGGER WILL ASSIST WITH BIKE/VEHICLE TRAFFIC

LEGEND

-  SIGN
-  SIGNAL
-  TRAFFIC CONES / DELINEATOR
-  BARRICADE
-  FLAGGER
-  FLASHING ARROW SIGN
-  WORK ZONE
-  BUS STOP

NOTE: FLAGGERS WILL PROVIDE ACCESS TO DRIVEWAYS AT ALL TIMES

NOTE: FLAGGERS WILL SAFELY GUIDE PEDESTRIANS THROUGH WORK AREA

NOTE: CONTRACTOR WILL ALLOW FIRE STATION INGRESS AND EGRESS AT ALL TIMES

NOTE: WB-24 (STEEL PLATES AHEAD) SIGNS WILL REMAIN IN PLACE FOR DURATION OF WORK

DETAIL: FLAGGER ACCESS

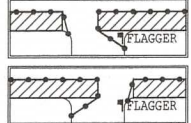

NOTE: DRIVEWAY ACCESS WILL BE PROVIDED AT ALL TIMES WORK WILL BE SPLIT TO PROVIDE ACCESS

UTILITY SURVEYORS, INC.

AIRX

Gail McMoran
President

2534 EAST EL NORTE PARKWAY, SUITE C
ESCONDIDO, CA 92027
PHONE: (760) 400-2347
CELL: (760) 419-3738

PROJECT NAME: TL23071 - SYCAMORE CANYON SUBSTATION TO PENASQUITOS - 230 KV UNDERGROUND	
AIRX JOB#: X160218	THOMAS GRID#: -
TYPE OF WORK: TRENCHING / CONDUIT	DRAWN FOR: CITY OF SAN DIEGO
MISC/POTHoles#:	

DATE: Mar. 29, 2017
DESIGNED BY: Clint Jones
SHEET 077 OF 148

NIGHT WORK ONLY
PHASE 64



ORIGINAL PERMIT MUST BE KEPT ON JOB SITE ALL TIMES

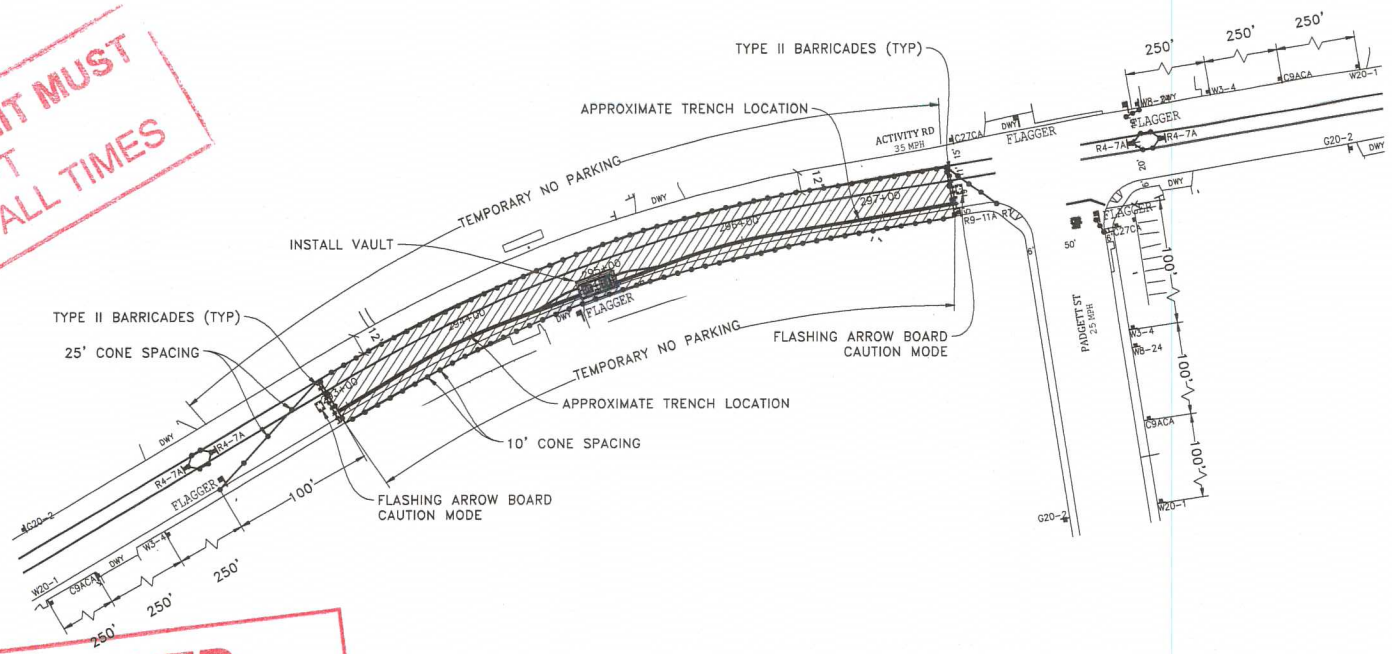

APPROVED
TRAFFIC CONTROL PERMIT
MAY 12 2017
 CITY OF SAN DIEGO
 Development Services
 Engineering Division
 Traffic Safety Section

NOTE: VAULT INSTALL AND TRENCHING WILL BE CONSTRUCTED IN SEPARATE PHASES

NOTE: CONTRACTOR WILL COORDINATE ALL WORK WITH FIRE STATION PRIOR TO START OF WORK

NOTE: CONTRACTOR WILL COORDINATE ALL WORK WITH TRANSIT DEPARTMENT 5 DAYS PRIOR TO START OF WORK

NOTE: CONTRACTOR WILL COORDINATE ALL WORK WITH EXISTING PROJECTS AND NOT CONFLICT WITH EXISTING TRAFFIC CONTROL

NOTE: CONTRACTOR WILL COORDINATE ALL WORK WITH RESIDENTS PRIOR TO START OF WORK

NOTE: CONTRACTOR WILL COORDINATE ALL WORK WITH BUSINESSES PRIOR TO START OF WORK

WORK HOURS: 9:00PM TO 5:00AM

EYE CONTACT MUST BE MAINTAINED BETWEEN FLAGGERS OR USE 2-WAY COMMUNICATION
 FLAGGER WILL ASSIST WITH BIKE / VEHICLE TRAFFIC

LEGEND

- SIGN
- SIGNAL
- TRAFFIC CONES / DELINEATOR
- ▬ BARRICADE
- ▨ FLAGGER
- ▧ FLASHING ARROW SIGN
- ▩ WORK ZONE
- 🚌 BUS STOP

NOTE: FLAGGERS WILL PROVIDE ACCESS TO DRIVEWAYS AT ALL TIMES

NOTE: FLAGGERS WILL SAFELY GUIDE PEDESTRIANS THROUGH WORK AREA

NOTE: CONTRACTOR WILL ALLOW FIRE STATION INGRESS AND EGRESS AT ALL TIMES

NOTE: WB-24 (STEEL PLATES AHEAD) SIGNS WILL REMAIN IN PLACE FOR DURATION OF WORK

DETAIL: FLAGGER ACCESS

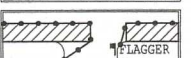
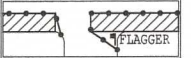

NOTE: DRIVEWAY ACCESS WILL BE PROVIDED AT ALL TIMES WORK WILL BE SPLIT TO PROVIDE ACCESS

UTILITY SURVEYORS, INC.
AIRX
 Gail McMorran
 President
 2534 EAST EL NORTE PARKWAY, SUITE C
 ESCONDIDO, CA 92027
 PHONE: (760) 480-2347
 CELL: (760) 419-3758

PROJECT NAME: TL23071 - SYCAMORE CANYON SUBSTATION TO PENASQUITOS - 230 KV UNDERGROUND	
AIRX JOB#: X160218	THOMAS GRID#: -
TYPE OF WORK: TRENCHING / CONDUIT	DRAWN FOR: CITY OF SAN DIEGO
MISC/POTHOLE#:	

DATE: Mar. 29, 2017
 DESIGNED BY: Clint Jones
SHEET 082 OF 148

NIGHT WORK ONLY
PHASE 69

SCALE 1" = 40'

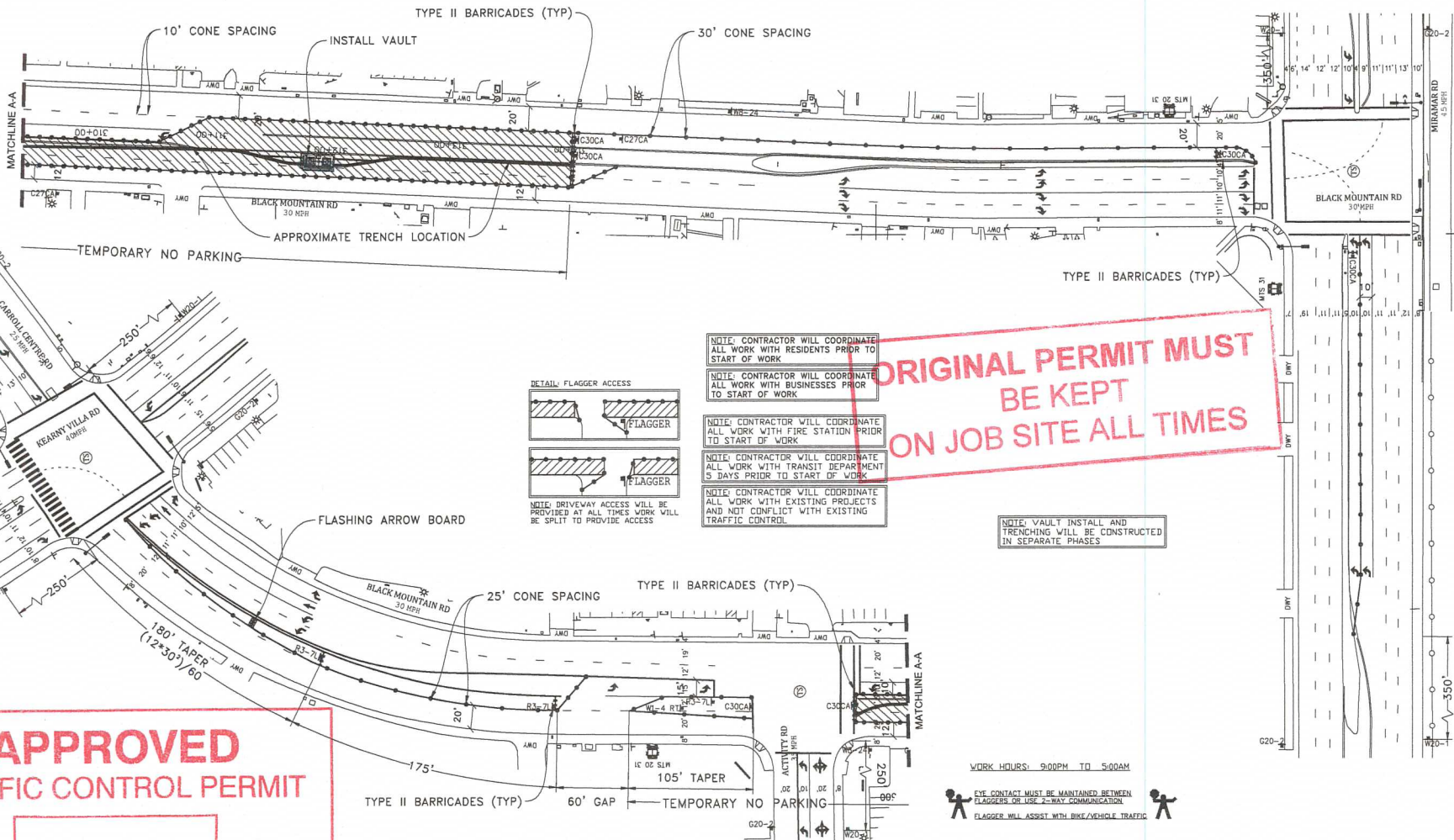

ORIGINAL PERMIT MUST BE KEPT ON JOB SITE ALL TIMES

APPROVED TRAFFIC CONTROL PERMIT

MAY 12 2017

- LEGEND**
- SIGN
 - SIGNAL
 - TRAFFIC CONES / DELINEATOR
 - BARRICADE
 - FLAGGER
 - FLASHING ARROW SIGN
 - WORK ZONE
 - BUS STOP

NOTE: FLAGGERS WILL PROVIDE ACCESS TO DRIVEWAYS AT ALL TIMES

NOTE: FLAGGERS WILL SAFELY BLOCK OFF TRAFFIC FROM WORK AREA

NOTE: CITY OF SAN DIEGO Engineering Division Traffic Safety Section

NOTE: WB-24 (STEEL) PLATES AHEAD SIGNS WILL REMAIN IN PLACE FOR DURATION OF WORK

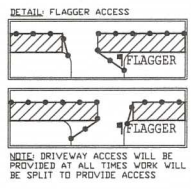

- NOTE: CONTRACTOR WILL COORDINATE ALL WORK WITH RESIDENTS PRIOR TO START OF WORK
- NOTE: CONTRACTOR WILL COORDINATE ALL WORK WITH BUSINESSES PRIOR TO START OF WORK
- NOTE: CONTRACTOR WILL COORDINATE ALL WORK WITH FIRE STATION PRIOR TO START OF WORK
- NOTE: CONTRACTOR WILL COORDINATE ALL WORK WITH TRANSIT DEPARTMENT 5 DAYS PRIOR TO START OF WORK
- NOTE: CONTRACTOR WILL COORDINATE ALL WORK WITH EXISTING PROJECTS AND NOT CONFLICT WITH EXISTING TRAFFIC CONTROL

NOTE: VAULT INSTALL AND TRENCHING WILL BE CONSTRUCTED IN SEPARATE PHASES

WORK HOURS: 9:00PM TO 5:00AM

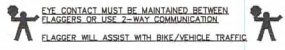

UTILITY SURVEYORS, INC.

Gail McMorran
President

2534 EAST EL NORTE PARKWAY, SUITE C
ESCONDIDO, CA 92027
PHONE: (951) 480-2247
CELL: (760) 419-3738

PROJECT NAME: TL23071 - SYCAMORE CANYON SUBSTATION TO PENASQUITOS - 230 KV UNDERGROUND	
AIRX JOB#: X160218	THOMAS GRID# -
TYPE OF WORK: TRENCHING / CONDUIT	DRAWN FOR: CITY OF SAN DIEGO
MISC/POTHLES#:	

**NIGHT WORK ONLY
PHASE 74**

DATE: Mar. 29, 2017
DESIGNED BY: Clint Jones
SHEET 087 OF 148