

**ORIGINAL**

Decision No. 82033

BEFORE THE PUBLIC UTILITIES COMMISSION OF THE STATE OF CALIFORNIA

In the Matter of the Investigation	)	Case No. 5437
into the rates, rules, regulations,	)	
charges, allowances, and practices	)	Petition for Modification
of all common carriers, highway	)	No. 246
carriers and city carriers relating	)	(Filed April 23, 1973)
to the transportation of sand, rock,	)	
gravel and related items (commodities)	)	Petition for Modification
for which rates are provided in	)	No. 250
Minimum Rate Tariff No. 17-A).	)	(Filed June 28, 1973)

OPINION AND ORDER

Minimum Rate Tariff 17-A (MRT 17-A) names minimum rates for the transportation by dump truck carriers of property including rock, sand, and gravel. These rates include zone rates which apply from defined production areas to designated delivery zones, which are described in Southern California Production Area and Delivery Zone Directory 1 (Directory 1). By these petitions California Dump Truck Owners Association seeks establishment of two new production areas in San Diego County, and new minimum zone rates therefrom to delivery zones in San Diego County.

Petition No. 246 states that C. R. Stevens, an individual doing business as C. R. Stevens Trucking, Route 1, Box 844, Escondido, subleases property in the vicinity of the upper end of Lake Hodges from Consolidated Rock Company. The proposed production area in Petition No. 246 is described, as follows:

"All points northerly of Highland Valley Road and within a one mile radius of the intersection of said Highland Valley Road and an unnamed road leading southerly from Highland Valley Road approximately 2½ miles easterly of Pomerado Road. This area is in the vicinity of the upper end of Lake Hodges."

Petition No. 250 states that Consolidated Rock Company leases property in the vicinity of Willow Glen and Dehesa Road in San Diego County. The proposed production area in Petition No. 250 is described, as follows:

"All points southerly of Dehesa Rd. and private road leading to the Consolidated Rock Company production plant approximately 1.2 miles east of the intersection of Willow Glen and Dehesa Rd. in San Diego County."

According to the petitions, C. R. Stevens and Consolidated Rock Company produce several thousand tons of sand per month from each of the above-described areas and transport it to various locations in San Diego County in their own dump trucks and in for-hire dump trucks. At present the transportation of shipments of sand from points in the proposed production areas by dump truck carriers is subject to hourly rates in Minimum Rate Tariff 7. Petitioner states that hourly rates result in variable amounts per ton even between the same points because of varying capacities and performance of five-axle units of equipment. It is explained that sales are on a fixed price per ton basis, and that hourly rates make quotations for sales purposes difficult because of the variations in transportation costs. Minimum rates which apply for the transportation of rock, sand, and gravel by for-hire dump truck carriers from most commercial rock products plants in San Diego County are zone rates which are set forth in MRT 17-A. Petitioner requests establishment of zone rates from the proposed production areas on the same bases as zone rates from other San Diego County production areas to eliminate possible discrimination with respect to competing sources of the same commodity now subject to zone rates.

The petitions set forth tie-in times and mileages which were run in five-axle trucks from the proposed production areas to the existing traverse network. The petitions also include sections of the basic traverse maps of the respective areas showing the

existing adjacent delivery zones and nodes. Petitioner requests that new nodes, times, and distances be adopted for use in tying the new production areas into the traverse network. Petitioner stated that it does not have the facilities to recommend node numbers or to run new zone rates which assertedly are procedural matters involving computer work normally performed by the Commission staff.

Revised traverse map sections were prepared by the Commission's Transportation Division to show the necessary nodes, round trip times, and one-way distances between the proposed production areas, and the existing traverse network. They are attached hereto in Appendix A. Utilizing these data, cost figures have been calculated and corresponding rates developed in accordance with the established formulae. The times, distances, costs, and resulting zone rates are included in the respective files in these petitions as Exhibits Nos. 246-1 and 250-1.

Petitioner explains that it was directed to file these petitions by its San Diego chapter. It states that Petition No. 246 was supported by C. R. Stevens and Consolidated Rock Company, and that the San Diego County Rock Producers Association has no objection to it. Petitioner states that Petition No. 250 was supported by Consolidated Rock Company and the San Diego County Rock Producers Association. Petitioner believes that these are noncontroversial matters and requests ex parte disposition.

Copies of verified Petitions Nos. 246 and 250 were served on known organizations and other interested parties on or about April 19 and June 26, 1973, respectively. Petitions Nos. 246 and 250 were listed on the Commission's Daily Calendars of April 24 and June 29, 1973, respectively. No objection to the granting of the petitions has been received.

It is clear that the establishment of the zone rates which are sought by petitioner would produce rates for the transportation of shipments from the proposed production areas which are the same, in kind and character, as the zone rates in MRT 17-A which apply from other production areas to delivery zones in San Diego County. In the circumstances the Commission finds that designations of the properties involved as production areas and the establishment of zone rates therefrom as hereinafter provided will result in just, reasonable, and nondiscriminatory minimum rates for the transportation to which said rates would apply. The two production areas (modified to reflect certain corrections in boundary descriptions) and zone rates therefrom should be established. The petitions should be granted. A public hearing thereon is not necessary.

IT IS ORDERED that:

(1) Directory 1 (Appendix A of Decision No. 69469, as amended) is further amended by incorporating therein, to become effective November 24, 1973, First Revised Page 252.3 and First Revised Page 252.4, attached hereto and by this reference made a part hereof.

(2) Minimum Rate Tariff 17-A (Appendix C of Decision No. 80578, as amended) is further amended by incorporating therein to become effective November 24, 1973, First Revised Page 8-PP, Original Page 8-QQ, First Revised Page 8-R, and Original Page 8-RR, attached hereto and by this reference made a part hereof.

C. 5437, Pet. 246, et al. af \*

(3) In all other respects Decisions Nos. 69469 and 80578, as amended, shall remain in full force and effect.

The effective date of this order shall be twenty days after the date hereof.

Dated at San Francisco, California, this 24<sup>th</sup> day  
of OCTOBER, 1973.

[Signature]  
President  
William [Signature]  
[Signature]  
[Signature]  
[Signature]  
Commissioners

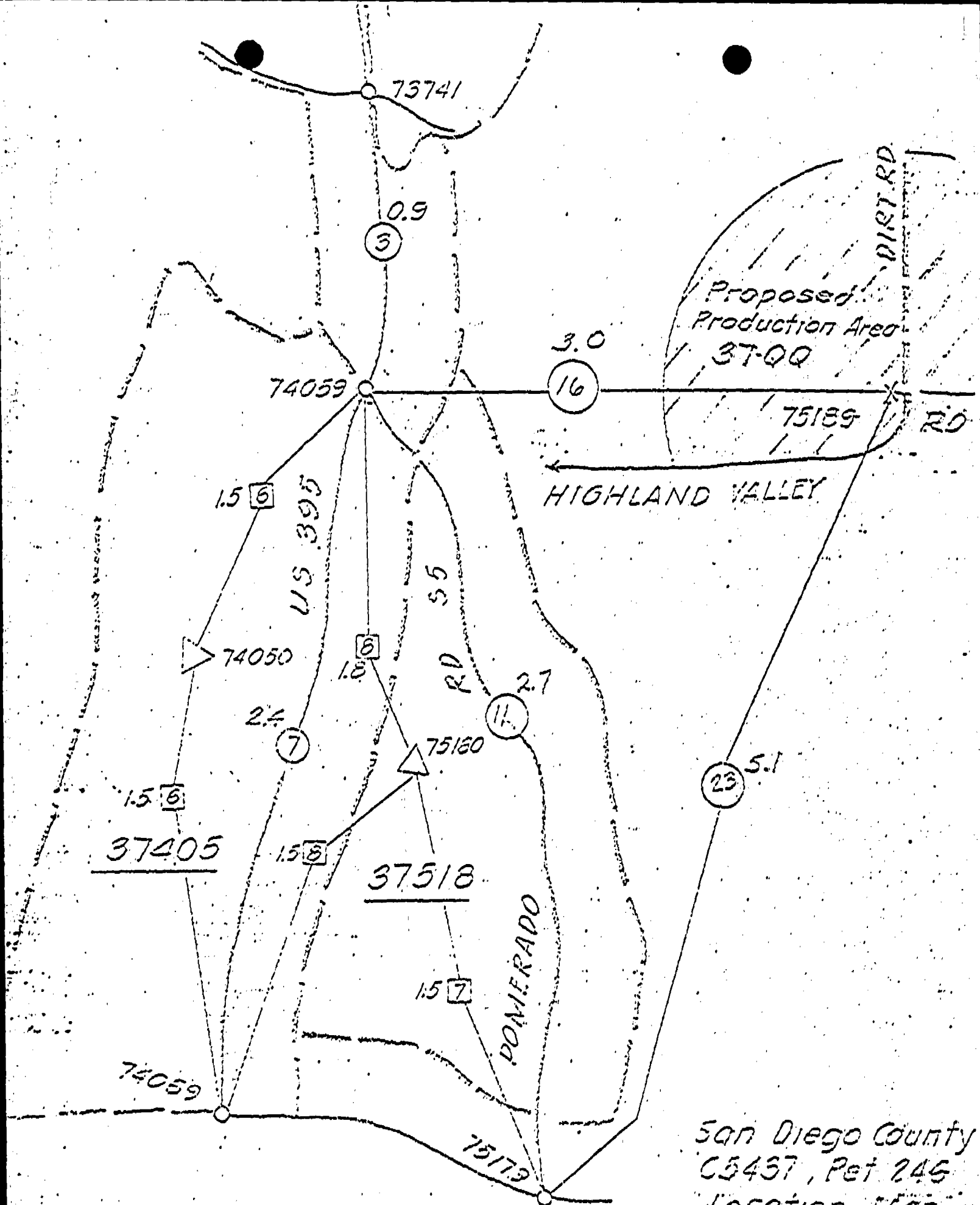

San Diego County  
C5437, Pet 246  
Location Map  
APPENDIX A Sht 1



SECTION 6--SAN DIEGO COUNTY PRODUCTION AREAS AND  
DELIVERY ZONES (Continued)

SAN DIEGO COUNTY PRODUCTION AREAS	AREA
Beginning at the intersection of Rancho Fanita Dr. and Mission Gorge Rd.; west on Mission Gorge Rd. and Fr. Junipero Serra Rd. a distance of 1-1/2 miles (vicinity of Old Mission Dam); north to the San Diego River; easterly along the San Diego River to a point where the northerly extension of Rancho Fanita Dr. intersects the San Diego River; southerly on said extension to the point of beginning.	37-0
All of the land included in the northwest quarter of the northwest quarter of Section 2, T. 19 S., R. 2 W., SBDM (westerly side of Dairy Mart Rd., southerly of the Tia Juana River).	37-00
Beginning at the junction of Riverford Rd. and Woodside Ave.; southwesterly along Woodside Ave. to Magnolia Ave.; northerly along Magnolia Ave. to (Old) Magnolia Ave.; westerly along (Old) Magnolia Ave. to Cottonwood Ave.; northerly along Cottonwood Ave. to Mast St.; easterly along Mast St. to Magnolia Ave.; northerly along Magnolia Ave. to El Nopal; easterly along El Nopal to Riverford Rd.; southerly along Riverford Rd. to the point of beginning.	37-P
All of the land included in the northeast quarter of Section 2, T. 19 S., R. 2 W., SBDM, lying southwesterly of Interstate Hwy. 5 (near Cottonwood Rd. and adjacent to and astride the Tia Juana River).	37-PP
Beginning at the junction of Cherry Rd. and Westhill Rd.; southwesterly and westerly along Cherry Rd. to Golden Ridge Rd.; southwesterly along Golden Ridge Rd. to its junction with Jessica Ln.; westerly along a direct line to a point southeast of the junction of Shadowhill Rd. and Meadow Terrace Dr.; northwest to said junction; northwesterly along Shadowhill Rd. to Woodside Ave.; northeasterly and easterly along Woodside Avenue to Marilla Dr.; southerly along Marilla Dr. to Westhill Rd.; southerly along Westhill Rd. to the point of beginning.	37-Q
All points northerly of Highland Valley Rd. and within a one-mile radius of the intersection of said Highland Valley Rd. and an unnamed road leading northerly from Highland Valley Rd. approximately 2.7 miles easterly of Pomerado Rd. This area is in the vicinity of the upper end of Lake Hodges.	*37-QQ
Beginning at the intersection of Lakeside Ave. and State Hwy. 67; southerly along State Hwy. 67 to Woodside Ave.; westerly along Woodside Ave. to Riverford Rd.; northerly along Riverford Rd. to Riverside Dr.; easterly along Riverside Dr. to Lakeside Ave.; easterly along Lakeside Ave. to the point of beginning.	37-R
All points southerly of Dehesa Rd. and within a one-mile radius of the intersection of Dehesa Rd. and the private road leading to the Consolidated Rock Company production plant approximately 1.2 miles east of the intersection of Willow Glen and Dehesa Rd. in San Diego County.	*37-RR
Beginning at the junction of Willow Rd. and Virden St.; southerly along Virden St. to El Monte Rd.; southerly along El Monte Rd. and Julian Ave. to Lake Jennings Park Rd.; westerly along Lake Jennings Park Rd. and Maple View St. to State Hwy. 67; northerly along State Hwy. 67 to Morena Ave.; northeasterly along Morena Ave. to Willow Rd.; easterly along Willow Rd. to the point of beginning.	37-S

\* Addition, Decision No.

82033

EFFECTIVE

ISSUED BY THE PUBLIC UTILITIES COMMISSION OF THE STATE OF CALIFORNIA,  
SAN FRANCISCO, CALIFORNIA.

Correction



SECTION 6--SAN DIEGO COUNTY PRODUCTION AREAS AND  
 DELIVERY ZONES (Continued)

AREA	SAN DIEGO COUNTY PRODUCTION AREAS
37-T	Beginning at the intersection of Friars Rd. and Murphy Canyon Rd.; northerly along Murphy Canyon Rd. to Aero Dr.; westerly along Aero Dr. to Marathon Dr.; southerly along Marathon Dr. to Fermi Ave.; westerly along Fermi Ave. to Mission Village Dr.; southerly along Mission Village Dr. to Friars Rd.; easterly along Friars Rd. to the point of beginning.
37-U	Beginning at a point on Mission Gorge Rd. 500 ft. easterly of the junction of Mission Gorge Rd. and Conestoga Wy.; due north 1/2 mile; westerly along a line parallel to and 1/2 mile northerly of Mission Gorge Rd. to a point exactly 1/2 mile north of a point on Mission Gorge Rd. 1 mile westerly of the junction of Mission Gorge Rd. and Conestoga Wy.; southerly along said line to Mission Gorge Rd.; easterly along Mission Gorge Rd. to the point of beginning.
37-V	Beginning at a point on Mission Gorge Rd. 500 ft. easterly of the junction of Mission Gorge Rd. and Conestoga Wy.; due north 1/2 mile; easterly along a line parallel to and 1/2 mile northerly of Mission Gorge Rd. to Fr. Junipero Serra Rd.; southerly along Fr. Junipero Serra Rd. to Mission Gorge Rd.; westerly along Mission Gorge Rd. to the point of beginning.
37-W	Beginning at the intersection of U.S. Hwy. 395 and the San Diego River; northerly along U.S. Hwy. 395 to Genesee Ave.; easterly along Genesee Ave. and its easterly extension to Interstate Hwy. 805; southerly along Interstate Hwy. 805 to the San Diego River; westerly along the San Diego River to the point of beginning.
37-X	Beginning at the intersection of Murphy Canyon Rd. and the San Diego River; northerly along Murphy Canyon Rd. to Friars Rd.; westerly along Friars Rd. to Mission Village Rd.; northerly along Mission Village Rd. to Irvington Rd.; westerly along Irvington Rd. and its westerly extension to Interstate Hwy. 805; southerly along Interstate Hwy. 805 to the San Diego River; easterly along the San Diego River to the point of beginning.
37-Y	Beginning at the intersection of Twain Ave. and Mission Gorge Rd.; westerly along Twain Ave. to the San Diego River; northerly and northeasterly along the San Diego River to Zion Ave.; easterly along Zion Ave. to Mission Gorge Rd.; southerly along Mission Gorge Rd. to the point of beginning.
37-Z	Beginning at a point on El Monte Rd. exactly 1 mile easterly of Virden St.; easterly along El Monte Rd. to the entrance to El Monte Park; north 1/2 mile; westerly along a line parallel to and 1/2 mile northerly of El Monte Rd. to a point 1/2 mile north of a point on El Monte Rd. exactly 1 mile easterly of Virden St.; south 1/2 mile to the point of beginning.

No change on this page, Decision No. **82033**

EFFECTIVE

Correction

ISSUED BY THE PUBLIC UTILITIES COMMISSION OF THE STATE OF CALIFORNIA,  
 SAN FRANCISCO, CALIFORNIA.

## SECTION 8 - ZONE RATES IN CENTS PER TON (CONTINUED)

COMMODITIES AS DESCRIBED IN ITEM 60

 FROM SAN DIEGO COUNTY PRODUCTION AREA 37-PP  
 TO THE DELIVERY ZONES SET FORTH BELOW

ZONE	RATE	ZONE	RATE	ZONE	RATE	ZONE	RATE	ZONE	RATE	ZONE	RATE	ZONE	RATE
37422	123												
37423	117												
37424	126												
37436	117												
37437	111												
37439	107												
37440	108												
37441	103												
37450	96												
37451	96												
37452	88												
37453	87												
37539	92												
37540	87												
37901	80												
37902	78												
37903	73												
37904	82												
37911	70												
37912	63												
37914	56												
37915	69												
37917	39												
37918	49												
37924	40												
37925	34												
37926	44												
37930	30												
37931	33												
37940	67												

NO CHANGE  
DECISION NO.

82033

EFFECTIVE

ISSUED BY THE PUBLIC UTILITIES COMMISSION OF THE STATE OF CALIFORNIA,

CORRECTION

SAN FRANCISCO, CALIFORNIA

## SECTION 8 - ZONE RATES IN CENTS PER TON

## COMMODITIES AS DESCRIBED IN ITEM 60

FROM SAN DIEGO COUNTY PRODUCTION AREA 37-QQ  
TO THE DELIVERY ZONES SET FORTH BELOW

ZONE	RATE	ZONE	RATE	ZONE	RATE	ZONE	RATE	ZONE	RATE	ZONE	RATE	ZONE	RATE
30066	348	37131	152	37318	108	37368	101	37443	140	37540	149	37934	211
30067	360	37132	153	37319	97	37369	90	37444	133	37541	133	37935	213
30068	348	37133	186	37320	99	37370	78	37445	172	37542	153	37940	231
30069	331	37134	180	37321	100	37371	67	37446	190	37543	147		
30070	332	37135	174	37322	114	37372	57	37447	159	37601	162		
30071	344	37136	187	37323	119	37373	61	37448	148	37602	168		
30093	342	37137	177	37324	135	37374	48	37449	147	37603	159		
30094	331	37138	194	37325	134	37375	52	37450	144	37604	151		
30095	325	37139	174	37326	129	37401	146	37451	139	37605	163		
30096	327	37140	165	37327	140	37402	135	37452	152	37606	167		
30097	304	37141	169	37328	152	37403	134	37453	154	37607	180		
30098	295	37142	163	37329	156	37404	126	37454	160	37608	186		
30099	315	37143	151	37330	155	37405	43	37501	61	37609	194		
30100	300	37201	154	37331	148	37406	56	37502	49	37610	157		
30101	286	37202	165	37332	147	37407	70	37503	58	37611	164		
30102	279	37203	174	37333	137	37408	80	37504	55	37801	181		
30103	286	37204	187	37334	128	37409	88	37505	63	37802	177		
30116	266	37205	178	37335	126	37410	95	37506	74	37901	157		
30117	255	37206	167	37336	117	37411	104	37507	86	37902	160		
30118	247	37207	159	37337	107	37412	98	37508	100	37903	159		
37101	248	37208	145	37338	95	37413	111	37509	120	37904	167		
37102	261	37209	131	37339	89	37414	124	37510	117	37905	169		
37103	233	37210	118	37340	92	37415	119	37511	123	37906	177		
37104	240	37211	104	37341	87	37416	148	37512	127	37907	182		
37105	256	37212	95	37342	84	37417	132	37513	114	37908	183		
37106	249	37213	86	37343	71	37418	142	37514	99	37909	191		
37107	231	37214	118	37344	101	37419	157	37515	83	37910	186		
37108	228	37215	99	37345	118	37420	157	37516	63	37911	180		
37109	218	37216	79	37346	128	37421	129	37517	49	37912	170		
37110	205	37217	75	37347	119	37422	106	37518	46	37913	168		
37111	196	37218	78	37348	123	37423	113	37519	61	37914	180		
37112	204	37219	77	37349	130	37424	113	37520	75	37915	191		
37113	216	37220	69	37350	130	37425	122	37521	72	37916	197		
37114	225	37301	141	37351	129	37426	136	37522	77	37917	205		
37115	209	37302	152	37352	112	37427	157	37523	97	37918	190		
37116	200	37303	140	37353	130	37428	167	37524	115	37919	211		
37117	188	37304	127	37354	137	37429	151	37525	138	37920	196		
37118	194	37305	127	37355	147	37430	158	37526	167	37921	204		
37119	190	37306	139	37356	147	37431	144	37527	159	37922	217		
37120	186	37307	152	37357	133	37432	151	37528	153	37923	206		
37121	177	37308	162	37358	143	37433	141	37529	143	37924	196		
37122	180	37309	163	37359	137	37434	128	37530	135	37925	197		
37123	169	37310	158	37360	134	37435	131	37531	152	37926	207		
37124	177	37311	166	37361	121	37436	125	37532	162	37927	218		
37125	179	37312	154	37362	108	37437	120	37533	176	37928	238		
37126	178	37313	153	37363	103	37438	129	37534	172	37929	222		
37127	169	37314	145	37364	132	37439	134	37535	156	37930	211		
37128	160	37315	143	37365	126	37440	135	37537	153	37931	206		
37129	157	37316	126	37366	124	37441	138	37538	144	37932	209		
37130	157	37317	117	37367	111	37442	138	37539	139	37933	218		

DECISION NO.

82033

EFFECTIVE

ISSUED BY THE PUBLIC UTILITIES COMMISSION OF THE STATE OF CALIFORNIA

CORRECTION

SAN FRANCISCO, CALIFORNIA

## SECTION 8 - ZONE RATES IN CENTS PER TON (CONTINUED)

## COMMODITIES AS DESCRIBED IN ITEM 60

 FROM SAN DIEGO COUNTY PRODUCTION AREA 37-R  
 TO THE DELIVERY ZONES SET FORTH BELOW

ZONE	RATE	ZONE	RATE	ZONE	RATE	ZONE	RATE	ZONE	RATE	ZONE	RATE	ZONE	RATE
30066	437	37132	252	37319	196	37369	190	37444	119	37541	80	37935	156
30067	449	37133	275	37320	199	37370	177	37445	136	37542	31	37940	173
30068	437	37134	268	37321	200	37371	166	37446	154	37543	28		
30069	420	37135	263	37322	213	37372	156	37447	123	37601	34		
30070	421	37136	235	37323	219	37373	161	37448	112	37602	42		
30071	433	37137	265	37324	235	37374	148	37449	110	37603	38		
30094	420	37138	282	37325	233	37375	152	37450	99	37604	35		
30095	414	37139	274	37326	228	37401	172	37451	94	37605	46		
30096	416	37140	265	37327	240	37402	161	37452	106	37606	55		
30097	393	37141	269	37328	249	37403	157	37453	111	37607	67		
30098	384	37142	263	37329	245	37404	152	37454	115	37608	74		
30099	403	37143	251	37330	239	37405	156	37501	160	37609	81		
30100	388	37201	254	37331	239	37406	137	37502	148	37610	44		
30101	374	37202	264	37332	232	37407	132	37503	158	37611	52		
30102	367	37203	274	37333	236	37408	131	37504	155	37601	50		
30103	375	37204	246	37334	227	37409	121	37505	163	37602	53		
30116	354	37205	278	37335	225	37410	110	37506	166	37901	109		
30117	343	37206	266	37336	216	37411	119	37507	153	37902	105		
30118	336	37207	258	37337	206	37412	124	37508	138	37903	102		
37101	337	37208	245	37338	194	37413	137	37509	123	37904	93		
37102	349	37209	231	37339	188	37414	118	37510	130	37905	85		
37103	322	37210	217	37340	191	37415	145	37511	125	37906	80		
37104	329	37211	203	37341	186	37416	142	37512	113	37907	91		
37105	345	37212	194	37342	183	37417	142	37513	100	37908	86		
37106	338	37213	186	37343	170	37418	149	37514	85	37909	95		
37107	320	37214	218	37344	201	37419	154	37515	86	37910	103		
37108	317	37215	198	37345	217	37420	149	37516	107	37911	106		
37109	307	37216	178	37346	218	37421	123	37517	123	37912	112		
37110	293	37217	174	37347	208	37422	100	37518	129	37913	112		
37111	284	37218	177	37348	203	37423	92	37519	121	37914	121		
37112	293	37219	177	37349	205	37424	102	37520	118	37915	107		
37113	305	37220	169	37350	211	37425	116	37521	109	37916	101		
37114	317	37301	240	37351	221	37426	129	37522	99	37917	117		
37115	300	37302	251	37352	211	37427	140	37523	71	37918	133		
37116	297	37303	240	37353	229	37428	150	37524	48	37919	160		
37117	287	37304	226	37354	222	37429	133	37525	34	37920	147		
37118	294	37305	227	37355	218	37430	121	37526	39	37921	153		
37119	290	37306	238	37356	211	37431	125	37527	45	37922	165		
37120	286	37307	251	37357	211	37432	120	37528	55	37923	152		
37121	276	37308	250	37358	206	37433	120	37529	61	37924	138		
37122	280	37309	262	37359	196	37434	117	37530	78	37925	140		
37123	268	37310	252	37360	189	37435	108	37531	76	37926	146		
37124	276	37311	265	37361	196	37436	92	37532	65	37927	159		
37125	279	37312	254	37362	205	37437	86	37533	45	37928	180		
37126	278	37313	252	37363	203	37438	85	37534	52	37929	165		
37127	268	37314	244	37364	182	37439	89	37536	65	37930	154		
37128	259	37315	242	37365	188	37440	94	37537	76	37931	148		
37129	256	37316	226	37366	187	37441	93	37538	93	37932	152		
37130	256	37317	217	37367	198	37442	106	37539	90	37933	161		
37131	252	37318	207	37368	200	37443	104	37540	95	37934	154		

NO CHANGE,  
DECISION NO.

82033

EFFECTIVE

 ISSUED BY THE PUBLIC UTILITIES COMMISSION OF THE STATE OF CALIFORNIA,  
 CORRECTION

SAN FRANCISCO, CALIFORNIA

## SECTION 8 - ZONE RATES IN CENTS PER TON

## COMMODITIES AS DESCRIBED IN ITEM 60

FROM SAN DIEGO COUNTY PRODUCTION AREA 37-RR  
TO THE DELIVERY ZONES SET FORTH BELOW

ZONE	RATE	ZONE	RATE	ZONE	RATE	ZONE	RATE	ZONE	RATE	ZONE	RATE	ZONE	RATE
30066	435	37131	304	37318	259	37368	225	37443	122	37540	106	37934	155
30067	467	37132	304	37319	248	37369	236	37444	137	37541	92	37935	157
30068	455	37133	293	37320	251	37370	229	37445	153	37542	76	37940	167
30069	438	37134	286	37321	252	37371	218	37446	171	37543	72		
30070	439	37135	281	37322	265	37372	208	37447	136	37601	71		
30071	451	37136	273	37323	271	37373	213	37448	130	37602	58		
30093	449	37137	284	37324	287	37374	200	37449	129	37603	70		
30094	438	37138	300	37325	285	37375	204	37450	117	37604	77		
30095	432	37139	306	37326	280	37401	190	37451	112	37606	67		
30096	434	37140	294	37327	277	37402	181	37452	117	37606	76		
30097	411	37141	301	37328	267	37403	175	37453	122	37607	74		
30098	402	37142	309	37329	263	37404	170	37454	126	37608	73		
30099	421	37143	303	37330	257	37405	188	37501	212	37609	77		
30100	406	37201	306	37331	257	37406	176	37502	200	37610	84		
30101	392	37202	316	37332	250	37407	165	37503	210	37611	91		
30102	385	37203	326	37333	262	37408	156	37504	207	37801	55		
30103	393	37204	338	37334	253	37409	146	37505	215	37802	42		
30116	372	37205	330	37335	277	37410	135	37506	218	37901	120		
30117	361	37206	318	37336	268	37411	144	37507	206	37902	116		
30118	354	37207	310	37337	258	37412	149	37508	190	37903	113		
37101	355	37208	297	37338	246	37413	162	37509	175	37904	105		
37102	367	37209	283	37339	240	37414	143	37510	182	37905	96		
37103	340	37210	269	37340	243	37415	170	37511	177	37906	92		
37104	347	37211	255	37341	238	37416	167	37512	166	37907	94		
37105	363	37212	246	37342	235	37417	160	37513	152	37908	78		
37106	356	37213	238	37343	222	37418	167	37514	137	37909	89		
37107	338	37214	270	37344	253	37419	172	37515	137	37910	97		
37108	335	37215	250	37345	246	37420	167	37516	159	37911	108		
37109	325	37216	250	37346	236	37421	148	37517	175	37912	114		
37110	312	37217	226	37347	226	37422	125	37518	181	37913	123		
37111	302	37218	229	37348	221	37423	117	37519	173	37914	115		
37112	311	37219	229	37349	223	37424	127	37520	162	37915	101		
37113	323	37220	221	37350	229	37425	141	37521	161	37916	95		
37114	335	37301	292	37351	239	37426	149	37522	151	37917	111		
37115	319	37302	303	37352	255	37427	158	37523	123	37918	127		
37116	315	37303	292	37353	250	37428	168	37524	100	37919	171		
37117	319	37304	278	37354	240	37429	151	37525	86	37920	158		
37118	339	37305	279	37355	236	37430	140	37526	74	37921	164		
37119	342	37306	290	37356	229	37431	144	37527	80	37922	166		
37120	338	37307	303	37357	229	37432	138	37528	90	37923	152		
37121	328	37308	268	37358	224	37433	138	37529	97	37924	139		
37122	332	37309	280	37359	215	37434	142	37530	97	37925	140		
37123	320	37310	270	37360	207	37435	130	37531	91	37926	140		
37124	328	37311	288	37361	214	37436	117	37532	80	37927	153		
37125	331	37312	299	37362	223	37437	111	37533	71	37928	174		
37126	330	37313	304	37363	233	37438	110	37534	68	37929	162		
37127	320	37314	296	37364	200	37439	107	37536	76	37930	148		
37128	311	37315	294	37365	206	37440	117	37537	88	37931	149		
37129	308	37316	278	37366	206	37441	112	37538	104	37932	152		
37130	308	37317	269	37367	216	37442	127	37539	108	37933	161		

DECISION NO. 82033

EFFECTIVE

ISSUED BY THE PUBLIC UTILITIES COMMISSION OF THE STATE OF CALIFORNIA,  
CORRECTION SAN FRANCISCO, CALIFORNIA.