

ORIGINAL

Decision No. 83336

BEFORE THE PUBLIC UTILITIES COMMISSION OF THE STATE OF CALIFORNIA

In the Matter of the Investigation }  
into the rates, rules, regulations, }  
charges, allowances, and practices }  
of all common carriers, highway }  
carriers and city carriers relating }  
to the transportation of sand, rock, }  
gravel and related items (commodi- }  
ties for which rates are provided }  
in Minimum Rate Tariffs Nos. 7-A }  
and 17-A). }

Case No. 5437  
Petition for Modification  
No. 275  
(Filed May 31, 1974)

OPINION AND ORDER

Petitioner, Werner Corporation, a California corporation doing business as Foster Sand and Gravel Company (Foster), is engaged in the business of producing, marketing, and distributing rock, sand, and gravel at a new commercial production plant located in Riverside County. By this petition Foster seeks to have those production facilities designated as a dump truck production area in Southern California Production Area and Delivery Zone Directory 1 (Directory 1), and zone rates established therefrom in Minimum Rate Tariff 17-A (MRT 17-A) to delivery zones in Los Angeles, Orange, Riverside, and San Bernardino counties.

The description of the proposed production area is as follows:

All that real property located within the easterly 660 feet of all of the southwest one quarter of Section 11 and the westerly 660 feet of all of the southeasterly one quarter of Section 11, Township 5 South, Range 6 West, San Bernardino B & M in Riverside County. This property is located generally 1 mile south of the intersection of State Highway 71 and Maitri Road in Mayhew Canyon in the Glen Ivy Area, 7 miles south of Corona, California.

At present the transportation of shipments of rock, sand, and gravel from the subject facilities by for-hire dump truck carriers is subject to distance or hourly rates in Minimum Rate Tariff 7-A. However, the minimum rates which apply for the transportation of rock, sand, and gravel by dump truck carriers from many commercial rock products plants in southern California are zone rates which are set forth in MRT 17-A. Foster states that establishment of a new production area at its Riverside County plant and zone rates therefrom will result in rate parity with competing producers. Assertedly, this will eliminate rate discrimination now favoring those competitors.

Foster's new facility is stated to be of the same general type and character as facilities maintained by other producers for processing rock, sand and/or gravel as to size and grade. It is completely modern in design and automated. Approximately 90 percent of the loading will be performed from overhead hoppers. The scale is automated and certified and will insure fast and accurate weighing. With such modern facilities petitioner believes that the terminal end loading times will not be in excess of and probably will be less than those upon which the zone rates are based.

Appended to the application are the results of a test traverse made by Foster to determine the times and distances necessary to tie the production facilities into the traverse network, and a sketch map showing the location of the proposed production area and existing reference points. Petitioner submits that establishment of the sought zone rates should be non-controversial and that the petition can be disposed of properly by ex parte procedure.

The Transportation Division in its advice of participation recommends that in the absence of protest the petition may be granted ex parte. The advice of participation also contains a revised description of the proposed production area. It is stated that petitioner concurs with the staff description which reads as follows:

All the real property encompassed by the area  
2600 feet south, 700 feet west, 700 feet east,  
and 40 feet north of the Foster Sand and Gravel  
Company scale house located approximately  
1 mile south of the intersection of State High-  
way 71 and Maitri Road in Mayhew Canyon,  
Riverside County.

The staff advice of participation is included in the file in this proceeding as Exhibit 1.

The staff has prepared a traverse map section showing the proposed production area and the tie-in data to the traverse network. The traverse map section is attached hereto as Appendix A. The staff also has prepared a runout of round trip times, one-way miles, costs, and resulting zone rates. These data are included in the file in this petition as Exhibit 2.

Copies of the verified petition were served on known carrier and shipper organizations on or about May 31, 1974. The petition was listed on the Commission's Daily Calendar of June 6, 1974. No objection to the granting of the petition has been received.

It is clear that the establishment of the zone rates which are sought by petitioner would provide rates for the transportation of petitioner's shipments which are the same in kind and character as the zone rates in MRT 17-A which apply from other production areas in Riverside County. In the circumstances the

Commission finds that the designation of Foster's Riverside County plant area as a production area (as described in Exhibit 1) and the establishment of zone rates therefrom as hereinafter provided will result in just, reasonable, and nondiscriminatory minimum rates for the transportation to which the rates would apply. The production area and rates therefrom should be established. The petition should be granted. A public hearing is not necessary.

IT IS ORDERED that:

1. Directory 1 (Appendix A of Decision No. 69469, as amended) and Minimum Rate Tariff 17-A (Appendix C of Decision No. 80578, as amended) are further amended by incorporating therein, to become effective September 1, 1974, the revised pages attached hereto in Appendix B and by this reference made a part hereof.
2. Common carriers subject to the Public Utilities Act, to the extent that they are subject to Decision No. 80578, as amended, are directed to establish in their tariffs the amendments necessary to conform with the further adjustments ordered herein.
3. Tariff publications authorized to be made by common carriers as a result of this order shall be filed not earlier than the effective date of this order and may be made effective not earlier than the tenth day after the effective date of this order, and may be made effective on not less than ten days' notice to the Commission and to the public if filed not later than sixty days after the effective date of the minimum rate tariff pages incorporated in this order.
4. Common carriers, in establishing and maintaining the amendments authorized hereinabove, are hereby authorized to depart from the provisions of Section 460 of the Public Utilities Code to the extent necessary to adjust long- and short-haul departures now maintained under outstanding authorizations; such outstanding authorizations are hereby modified only to the extent necessary to comply with this order; and schedules containing the amendments published

under this authority shall make reference to the prior orders authorizing long- and short-haul departures and to this order.

5. In all other respects Decisions Nos. 69469 and 80578 shall remain in full force and effect.

The effective date of this order is the date hereof.

Dated at San Francisco, California, this 26<sup>th</sup> day of AUGUST, 1974.

Vernon L. Sturgeon  
President  
William J. Gussis

Stanley  
Donald  
Commissioners

Lobster.

William J. Gussis, Commissioner

# APPENDIX A

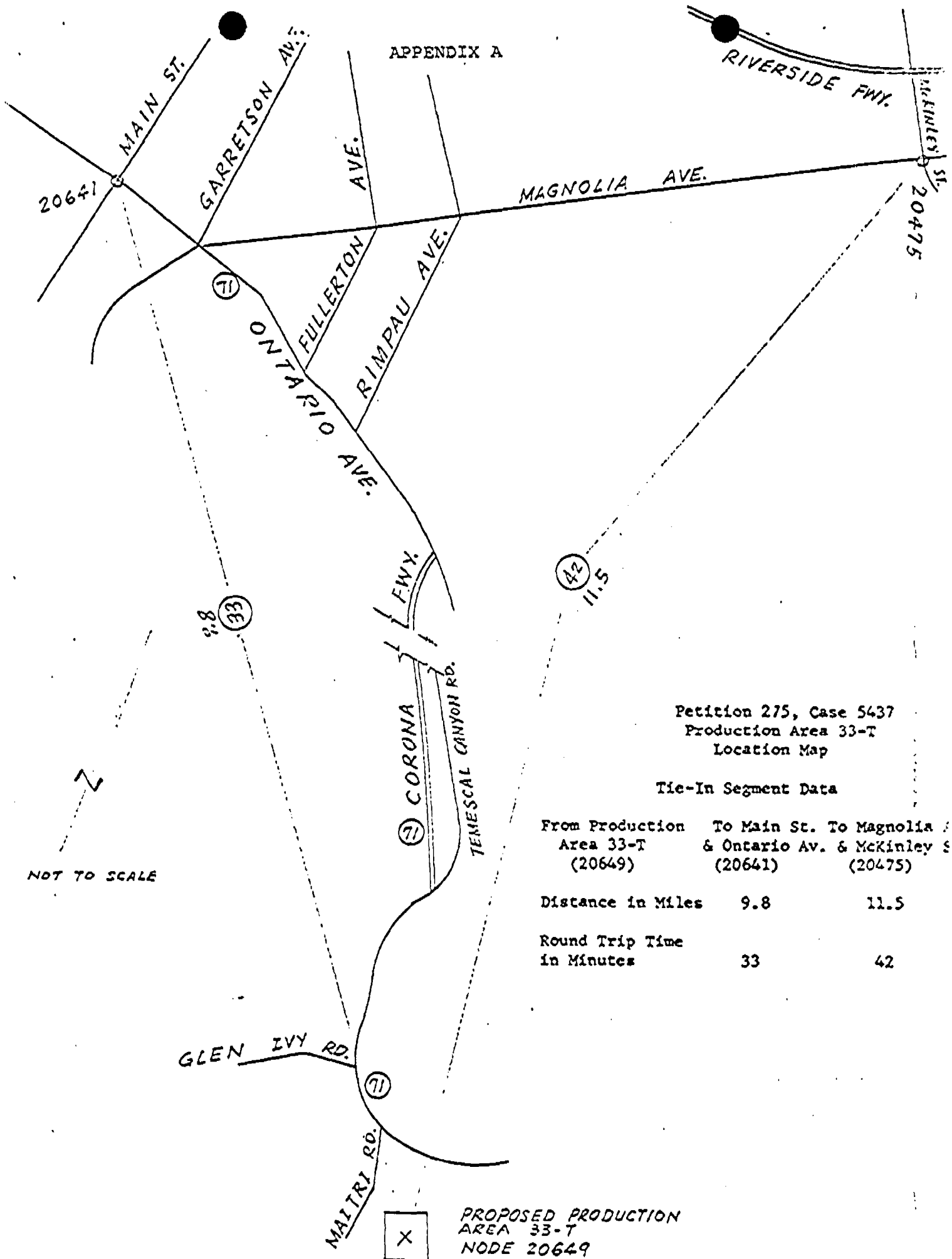

APPENDIX B

LIST OF REVISED PAGES TO DIRECTORY 1

FOURTH REVISED PAGE 183

FOURTH REVISED PAGE 184

LIST OF REVISED PAGES TO  
MINIMUM RATE TARIFF 17-A

ORIGINAL PAGE 6-T

ORIGINAL PAGE 6-T-1

ORIGINAL PAGE 6-T-2

(END OF APPENDIX B)

SECTION 4

Descriptions of Production Areas  
and Delivery Zones Located in  
Riverside County

No change on this page, Decision No. 83336

EFFECTIVE

Correction

ISSUED BY THE PUBLIC UTILITIES COMMISSION OF THE STATE OF CALIFORNIA,  
SAN FRANCISCO, CALIFORNIA.



| SECTION 4--RIVERSIDE COUNTY PRODUCTION AREAS AND DELIVERY ZONES  |   |
|--|---|
| RIVERSIDE COUNTY PRODUCTION AREAS  | AREA  |
| Beginning at the intersection of 26th Street and Bloomington Boulevard easterly along 26th Street and its easterly prolongation to the west bank of the Santa Ana River; northerly along the west bank of the Santa Ana River to Crestmore Avenue; westerly along Crestmore Avenue to Agua Mansa Road; northeasterly along Agua Mansa Road to Wilson Drive; westerly along the westerly prolongation of Wilson Drive to Bloomington Boulevard; southerly along Bloomington Boulevard to the point of beginning.  | 33-C  |
| Beginning at the intersection of Milliken Avenue and Patton Road; east along Patton Road to Wineville Avenue; south along Wineville Avenue to Highway U.S. 60; northwesterly along Highway U.S. 60 to Milliken Avenue; north along Milliken Avenue to the point of beginning.  | 33-F  |
| Beginning at the intersection of the north prolongation of Rimpau Avenue and the main line of The Atchison, Topeka and Santa Fe Railway Company; easterly along said main line to its intersection with the Temescal Branch Line of The Atchison, Topeka and Santa Fe Railway Company; southerly along said branch line to 6th Street; west along 6th Street to Rimpau Avenue; north along Rimpau Avenue and its prolongation to the point of beginning.   | 33-G  |
| Beginning at the intersection of the Riverside-San Bernardino County Line with the northerly boundary line of Section 19, Township 3 South, Range 7 West; easterly along the northerly boundary line of Section 19, Township 3 South, Range 7 West to State Highway 71; southerly along State Highway 71 to the southerly boundary line of Section 19, Township 3 South, Range 7 West; westerly along the southerly boundary of Section 19, Township 3 South, Range 7 West to the Riverside-San Bernardino County Line; northerly along said line to the point of beginning.   | 33-O  |
| Beginning at a point on Cajalco Street (a private road) 1,800 feet southeasterly of Magnolia Avenue; thence northeast 4/10ths of a mile; thence southeast 2,000 feet; thence southwest to Cajalco Street; thence northwesterly along Cajalco Street to the point of beginning. (Portions of Lots 3, 4 and 5 of Cajalco Tract No. 1 located within Section 32, T.3S., R.6W., SBEM.)   | 33-R  |
| Beginning at the bridge numbered 7.1 on the Elsinore Branch Line of The Atchison, Topeka and Santa Fe Railway Company; thence southerly along the railroad right-of-way to Temescal Canyon Road; southeasterly along Temescal Canyon Road to the private road leading to Rancho El Hermosa; northeasterly along said private road to the east bank of Temescal Wash; northerly along the east bank of Temescal Wash to Clay Road; westerly along Clay Road to the west bank of Temescal Wash; northerly along the west bank of Temescal Wash to a point directly west from point of beginning; thence directly east along an imaginary line to point of beginning. | 33-S  |
| All the real property encompassed by the area 2600 feet south, 700 feet west, 700 feet east and 40 feet north of the Foster Sand and Gravel Company scale house located approximately 1 mile south of the intersection of State Highway 71 and Mairi Road in Mayhew Canyon, Riverside County.  | *33-T   |
| * Addition, Decision No. <b>83336</b>  |   |
| EFFECTIVE  |   |
| Correction   | ISSUED BY THE PUBLIC UTILITIES COMMISSION OF THE STATE OF CALIFORNIA,<br>SAN FRANCISCO, CALIFORNIA. |

## SECTION 6 - ZONE RATES IN CENTS PER TON

## COMMODITIES AS DESCRIBED IN ITEM 60

FROM RIVERSIDE COUNTY PRODUCTION AREA 33-T  
TO THE DELIVERY ZONES SET FORTH BELOW

| ZONE  | RATE | ZONE  | RATE | ZONE  | RATE | ZONE  | RATE | ZONE  | RATE | ZONE  | RATE | ZONE  | RATE |
|-------|------|-------|------|-------|------|-------|------|-------|------|-------|------|-------|------|
| 19001 | 366  | 19051 | 368  | 19101 | 306  | 19151 | 295  | 19201 | 312  | 19251 | 326  | 19314 | 291  |
| 19002 | 363  | 19052 | 359  | 19102 | 298  | 19152 | 307  | 19202 | 300  | 19252 | 314  | 19315 | 288  |
| 19003 | 353  | 19053 | 352  | 19103 | 301  | 19153 | 310  | 19203 | 314  | 19253 | 333  | 19316 | 275  |
| 19004 | 352  | 19054 | 345  | 19104 | 301  | 19154 | 326  | 19204 | 297  | 19254 | 322  | 19317 | 280  |
| 19005 | 357  | 19055 | 337  | 19105 | 297  | 19155 | 312  | 19205 | 276  | 19255 | 313  | 19318 | 239  |
| 19006 | 361  | 19056 | 331  | 19106 | 289  | 19156 | 320  | 19206 | 283  | 19256 | 301  | 19319 | 235  |
| 19007 | 348  | 19057 | 323  | 19107 | 303  | 19157 | 334  | 19207 | 248  | 19257 | 296  | 19320 | 245  |
| 19008 | 350  | 19058 | 312  | 19108 | 322  | 19158 | 332  | 19208 | 246  | 19258 | 285  | 19321 | 235  |
| 19009 | 358  | 19059 | 308  | 19109 | 318  | 19159 | 339  | 19209 | 257  | 19259 | 275  | 19322 | 224  |
| 19010 | 370  | 19060 | 326  | 19110 | 324  | 19160 | 352  | 19210 | 270  | 19260 | 272  | 19323 | 222  |
| 19011 | 402  | 19061 | 317  | 19111 | 318  | 19161 | 367  | 19211 | 290  | 19261 | 262  | 19324 | 213  |
| 19012 | 386  | 19062 | 330  | 19112 | 326  | 19162 | 380  | 19212 | 300  | 19262 | 255  | 19325 | 205  |
| 19013 | 382  | 19063 | 317  | 19113 | 329  | 19163 | 395  | 19213 | 294  | 19263 | 254  | 19326 | 196  |
| 19014 | 372  | 19064 | 324  | 19114 | 353  | 19164 | 404  | 19214 | 299  | 19264 | 263  | 19327 | 189  |
| 19015 | 363  | 19065 | 314  | 19115 | 375  | 19165 | 416  | 19215 | 297  | 19265 | 272  | 19328 | 184  |
| 19016 | 350  | 19066 | 313  | 19116 | 341  | 19166 | 314  | 19216 | 298  | 19266 | 283  | 19329 | 179  |
| 19017 | 340  | 19067 | 305  | 19117 | 339  | 19167 | 306  | 19217 | 286  | 19267 | 282  | 19330 | 176  |
| 19018 | 340  | 19068 | 305  | 19118 | 336  | 19168 | 314  | 19218 | 286  | 19268 | 285  | 19331 | 176  |
| 19019 | 336  | 19069 | 322  | 19119 | 334  | 19169 | 301  | 19219 | 274  | 19269 | 305  | 19332 | 182  |
| 19020 | 331  | 19070 | 314  | 19120 | 328  | 19170 | 292  | 19220 | 272  | 19270 | 314  | 19333 | 192  |
| 19021 | 343  | 19071 | 330  | 19121 | 328  | 19171 | 284  | 19221 | 250  | 19271 | 322  | 19334 | 200  |
| 19022 | 340  | 19072 | 334  | 19122 | 316  | 19172 | 282  | 19222 | 244  | 19272 | 316  | 19335 | 209  |
| 19023 | 346  | 19073 | 335  | 19123 | 307  | 19173 | 277  | 19223 | 251  | 19273 | 342  | 19336 | 209  |
| 19024 | 356  | 19074 | 343  | 19124 | 282  | 19174 | 262  | 19224 | 260  | 19274 | 325  | 19337 | 232  |
| 19025 | 351  | 19075 | 347  | 19125 | 282  | 19175 | 270  | 19225 | 267  | 19275 | 343  | 19338 | 244  |
| 19026 | 343  | 19076 | 360  | 19126 | 289  | 19176 | 265  | 19226 | 272  | 19276 | 330  | 19339 | 253  |
| 19027 | 342  | 19077 | 368  | 19127 | 294  | 19177 | 265  | 19227 | 280  | 19277 | 328  | 19340 | 251  |
| 19028 | 341  | 19078 | 377  | 19128 | 293  | 19178 | 267  | 19228 | 292  | 19278 | 321  | 19341 | 279  |
| 19029 | 338  | 19079 | 407  | 19129 | 299  | 19179 | 272  | 19229 | 296  | 19279 | 320  | 19342 | 282  |
| 19030 | 336  | 19080 | 395  | 19130 | 291  | 19180 | 279  | 19230 | 281  | 19280 | 311  | 19343 | 268  |
| 19031 | 324  | 19081 | 381  | 19131 | 292  | 19181 | 285  | 19231 | 272  | 19281 | 305  | 19344 | 257  |
| 19032 | 316  | 19082 | 373  | 19132 | 285  | 19182 | 294  | 19232 | 257  | 19282 | 299  | 19345 | 244  |
| 19033 | 321  | 19083 | 374  | 19133 | 275  | 19183 | 295  | 19233 | 254  | 19283 | 298  | 19346 | 245  |
| 19034 | 330  | 19084 | 364  | 19134 | 285  | 19184 | 301  | 19234 | 249  | 19284 | 290  | 19347 | 238  |
| 19035 | 330  | 19085 | 358  | 19135 | 293  | 19185 | 310  | 19235 | 236  | 19285 | 287  | 19348 | 224  |
| 19036 | 332  | 19086 | 353  | 19136 | 320  | 19186 | 319  | 19236 | 241  | 19286 | 294  | 19349 | 214  |
| 19037 | 338  | 19087 | 349  | 19137 | 337  | 19187 | 329  | 19237 | 233  | 19287 | 334  | 19350 | 199  |
| 19038 | 333  | 19088 | 344  | 19138 | 347  | 19188 | 319  | 19238 | 262  | 19301 | 311  | 19351 | 188  |
| 19039 | 323  | 19089 | 337  | 19139 | 321  | 19189 | 307  | 19239 | 279  | 19302 | 299  | 19352 | 164  |
| 19040 | 325  | 19090 | 324  | 19140 | 326  | 19190 | 290  | 19240 | 299  | 19303 | 291  | 19353 | 161  |
| 19041 | 330  | 19091 | 315  | 19141 | 305  | 19191 | 279  | 19241 | 289  | 19304 | 307  | 19354 | 166  |
| 19042 | 343  | 19092 | 306  | 19142 | 297  | 19192 | 247  | 19242 | 277  | 19305 | 298  | 19355 | 155  |
| 19043 | 352  | 19093 | 304  | 19143 | 285  | 19193 | 263  | 19243 | 280  | 19306 | 290  | 19356 | 156  |
| 19044 | 363  | 19094 | 301  | 19144 | 285  | 19194 | 278  | 19244 | 265  | 19307 | 284  | 19357 | 145  |
| 19045 | 370  | 19095 | 297  | 19145 | 281  | 19195 | 284  | 19245 | 254  | 19308 | 275  | 19358 | 143  |
| 19046 | 380  | 19096 | 309  | 19146 | 270  | 19196 | 294  | 19246 | 248  | 19309 | 272  | 19359 | 154  |
| 19047 | 385  | 19097 | 302  | 19147 | 280  | 19197 | 304  | 19247 | 272  | 19310 | 260  | 19360 | 160  |
| 19048 | 393  | 19098 | 303  | 19148 | 275  | 19198 | 303  | 19248 | 283  | 19311 | 267  | 19361 | 161  |
| 19049 | 385  | 19099 | 306  | 19149 | 276  | 19199 | 311  | 19249 | 288  | 19312 | 276  | 19362 | 196  |
| 19050 | 378  | 19100 | 305  | 19150 | 281  | 19200 | 319  | 19250 | 331  | 19313 | 284  | 19363 | 201  |

CHANGE, DECISION NO.

83336

EFFECTIVE

ISSUED BY THE PUBLIC UTILITIES COMMISSION OF THE STATE OF CALIFORNIA,  
CORRECTION SAN FRANCISCO, CALIFORNIA.

## SECTION 6 - ZONE RATES IN CENTS PER TON

## COMMODITIES AS DESCRIBED IN ITEM 60

FROM RIVERSIDE COUNTY PRODUCTION AREA 33-T  
TO THE DELIVERY ZONES SET FORTH BELOW

| ZONE  | RATE | ZONE  | RATE | ZONE  | RATE | ZONE  | RATE | ZONE  | RATE | ZONE  | RATE | ZONE  | RATE |
|-------|------|-------|------|-------|------|-------|------|-------|------|-------|------|-------|------|
| 19364 | 200  | 19426 | 194  | 19606 | 342  | 19733 | 424  | 30041 | 198  | 30099 | 213  | 33043 | 131  |
| 19365 | 205  | 19427 | 187  | 19607 | 331  | 19734 | 441  | 30042 | 190  | 30100 | 224  | 33044 | 116  |
| 19366 | 211  | 19428 | 194  | 19608 | 375  | 19735 | 460  | 30043 | 184  | 30101 | 234  | 33045 | 102  |
| 19367 | 224  | 19429 | 211  | 19609 | 363  | 19736 | 481  | 30044 | 173  | 30102 | 246  | 33046 | 94   |
| 19368 | 229  | 19430 | 223  | 19610 | 377  | 19737 | 492  | 30045 | 173  | 30103 | 258  | 33047 | 87   |
| 19369 | 237  | 19431 | 216  | 19700 | 360  | 19738 | 505  | 30046 | 167  | 30116 | 254  | 33048 | 82   |
| 19370 | 246  | 19432 | 220  | 19701 | 367  | 19739 | 532  | 30047 | 161  | 30117 | 266  | 33049 | 90   |
| 19371 | 263  | 19433 | 233  | 19702 | 380  | 19760 | 567  | 30048 | 166  | 30118 | 268  | 33050 | 84   |
| 19372 | 264  | 19434 | 223  | 19703 | 394  | 19761 | 587  | 30049 | 180  | 33001 | 229  | 33051 | 131  |
| 19373 | 274  | 19435 | 235  | 19704 | 407  | 19762 | 410  | 30050 | 170  | 33002 | 226  | 33052 | 141  |
| 19374 | 260  | 19436 | 215  | 19705 | 420  | 30001 | 145  | 30051 | 165  | 33003 | 214  | 33053 | 157  |
| 19375 | 258  | 19437 | 210  | 19706 | 395  | 30002 | 154  | 30052 | 178  | 33004 | 219  | 33054 | 157  |
| 19376 | 249  | 19438 | 206  | 19707 | 400  | 30003 | 163  | 30053 | 187  | 33005 | 132  | 33055 | 212  |
| 19377 | 252  | 19439 | 185  | 19708 | 399  | 30004 | 173  | 30054 | 187  | 33006 | 129  | 33056 | 196  |
| 19378 | 250  | 19440 | 191  | 19709 | 404  | 30005 | 180  | 30055 | 189  | 33007 | 139  | 33057 | 194  |
| 19379 | 253  | 19441 | 196  | 19710 | 386  | 30006 | 190  | 30056 | 199  | 33008 | 138  | 33058 | 185  |
| 19380 | 236  | 19442 | 209  | 19711 | 392  | 30007 | 185  | 30057 | 211  | 33009 | 144  | 33059 | 175  |
| 19381 | 228  | 19443 | 224  | 19712 | 382  | 30008 | 173  | 30058 | 217  | 33010 | 128  | 33060 | 166  |
| 19382 | 228  | 19444 | 226  | 19713 | 373  | 30009 | 164  | 30059 | 222  | 33011 | 118  | 33061 | 162  |
| 19383 | 224  | 19445 | 232  | 19714 | 367  | 30010 | 144  | 30060 | 217  | 33012 | 128  | 33062 | 152  |
| 19384 | 208  | 19446 | 228  | 19715 | 369  | 30011 | 139  | 30061 | 208  | 33013 | 131  | 33063 | 82   |
| 19385 | 213  | 19447 | 229  | 19716 | 385  | 30012 | 158  | 30062 | 197  | 33014 | 137  | 33064 | 82   |
| 19397 | 174  | 19448 | 217  | 19717 | 382  | 30013 | 168  | 30063 | 192  | 33015 | 127  | 33065 | 171  |
| 19398 | 167  | 19449 | 217  | 19726 | 348  | 30014 | 169  | 30064 | 177  | 33016 | 124  | 33066 | 180  |
| 19399 | 160  | 19450 | 206  | 19727 | 363  | 30015 | 180  | 30065 | 174  | 33017 | 174  | 33067 | 222  |
| 19401 | 209  | 19451 | 196  | 19728 | 375  | 30016 | 191  | 30066 | 185  | 33018 | 164  | 33068 | 227  |
| 19402 | 200  | 19452 | 187  | 19729 | 387  | 30017 | 201  | 30067 | 208  | 33019 | 157  | 33069 | 230  |
| 19403 | 190  | 19453 | 207  | 19730 | 400  | 30018 | 194  | 30068 | 197  | 33020 | 114  | 33070 | 236  |
| 19404 | 169  | 19454 | 216  | 19731 | 416  | 30019 | 187  | 30069 | 203  | 33021 | 115  | 33071 | 230  |
| 19405 | 180  | 19455 | 225  | 19732 | 430  | 30020 | 177  | 30070 | 202  | 33022 | 113  | 33072 | 248  |
| 19406 | 186  | 19456 | 229  | 19733 | 447  | 30021 | 168  | 30071 | 194  | 33023 | 109  | 33073 | 237  |
| 19407 | 192  | 19457 | 240  | 19734 | 466  | 30022 | 155  | 30072 | 192  | 33024 | 106  | 33074 | 230  |
| 19408 | 193  | 19458 | 235  | 19735 | 485  | 30023 | 148  | 30073 | 181  | 33025 | 119  | 33075 | 196  |
| 19409 | 213  | 19459 | 230  | 19736 | 503  | 30024 | 142  | 30074 | 190  | 33026 | 124  | 33076 | 189  |
| 19410 | 207  | 19460 | 230  | 19737 | 527  | 30025 | 130  | 30075 | 200  | 33027 | 111  | 33077 | 180  |
| 19411 | 217  | 19461 | 219  | 19738 | 552  | 30026 | 167  | 30076 | 208  | 33028 | 108  | 33078 | 194  |
| 19412 | 219  | 19462 | 214  | 19739 | 573  | 30027 | 163  | 30077 | 213  | 33029 | 105  | 33079 | 191  |
| 19413 | 229  | 19463 | 221  | 19740 | 591  | 30028 | 152  | 30078 | 205  | 33030 | 95   | 33080 | 192  |
| 19414 | 244  | 19464 | 229  | 19741 | 609  | 30029 | 155  | 30079 | 205  | 33031 | 100  | 33081 | 192  |
| 19415 | 243  | 19465 | 242  | 19742 | 630  | 30030 | 160  | 30080 | 203  | 33032 | 88   | 33082 | 205  |
| 19416 | 246  | 19466 | 246  | 19743 | 653  | 30031 | 167  | 30081 | 189  | 33033 | 94   | 33083 | 258  |
| 19417 | 254  | 19467 | 223  | 19744 | 671  | 30032 | 174  | 30090 | 209  | 33034 | 104  | 33084 | 247  |
| 19418 | 251  | 19468 | 221  | 19745 | 689  | 30033 | 186  | 30091 | 222  | 33035 | 111  | 33085 | 233  |
| 19419 | 241  | 19469 | 210  | 19746 | 713  | 30034 | 198  | 30092 | 214  | 33036 | 153  | 33086 | 221  |
| 19420 | 239  | 19600 | 346  | 19747 | 435  | 30035 | 204  | 30093 | 214  | 33037 | 158  | 33087 | 211  |
| 19421 | 232  | 19601 | 346  | 19748 | 456  | 30036 | 212  | 30094 | 224  | 33038 | 168  | 33088 | 203  |
| 19422 | 230  | 19602 | 354  | 19749 | 478  | 30037 | 216  | 30095 | 233  | 33039 | 178  | 33089 | 196  |
| 19423 | 217  | 19603 | 359  | 19750 | 490  | 30038 | 205  | 30096 | 220  | 33040 | 164  | 33090 | 196  |
| 19424 | 212  | 19604 | 314  | 19751 | 395  | 30039 | 216  | 30097 | 241  | 33041 | 147  | 33091 | 204  |
| 19425 | 202  | 19605 | 326  | 19752 | 408  | 30040 | 202  | 30098 | 249  | 33042 | 141  | 33092 | 203  |

CHANGE, DECISION NO. 83336

EFFECTIVE

ISSUED BY THE PUBLIC UTILITIES COMMISSION OF THE STATE OF CALIFORNIA,  
CORRECTION SAN FRANCISCO, CALIFORNIA.

## SECTION 6 - ZONE RATES IN CENTS PER TON

COMMODITIES AS DESCRIBED IN ITEM 60

FROM RIVERSIDE COUNTY PRODUCTION AREA 33-T  
TO THE DELIVERY ZONES SET FORTH BELOW

| ZONE  | RATE | ZONE  | RATE | ZONE  | RATE | ZONE | RATE | ZONE | RATE | ZONE | RATE | ZONE | RATE |
|-------|------|-------|------|-------|------|------|------|------|------|------|------|------|------|
| 33093 | 211  | 36039 | 161  | 36089 | 120  |      |      |      |      |      |      |      |      |
| 33094 | 220  | 36040 | 171  | 36090 | 129  |      |      |      |      |      |      |      |      |
| 33095 | 227  | 36041 | 167  | 36091 | 128  |      |      |      |      |      |      |      |      |
| 33096 | 238  | 36042 | 153  | 36092 | 118  |      |      |      |      |      |      |      |      |
| 33097 | 224  | 36043 | 151  | 36301 | 202  |      |      |      |      |      |      |      |      |
| 33098 | 215  | 36044 | 148  | 36302 | 217  |      |      |      |      |      |      |      |      |
| 33099 | 208  | 36045 | 149  | 36303 | 232  |      |      |      |      |      |      |      |      |
| 33100 | 216  | 36046 | 156  | 36304 | 248  |      |      |      |      |      |      |      |      |
| 33101 | 215  | 36047 | 159  | 36305 | 266  |      |      |      |      |      |      |      |      |
| 33102 | 221  | 36048 | 162  | 36306 | 284  |      |      |      |      |      |      |      |      |
| 33103 | 230  | 36049 | 153  | 36307 | 298  |      |      |      |      |      |      |      |      |
| 33104 | 212  | 36050 | 149  | 36308 | 309  |      |      |      |      |      |      |      |      |
| 36001 | 196  | 36051 | 148  | 36309 | 318  |      |      |      |      |      |      |      |      |
| 36002 | 184  | 36052 | 138  | 36310 | 303  |      |      |      |      |      |      |      |      |
| 36003 | 188  | 36053 | 135  | 36311 | 299  |      |      |      |      |      |      |      |      |
| 36004 | 186  | 36054 | 134  | 36312 | 311  |      |      |      |      |      |      |      |      |
| 36005 | 186  | 36055 | 144  | 36313 | 325  |      |      |      |      |      |      |      |      |
| 36006 | 182  | 36056 | 152  | 36314 | 339  |      |      |      |      |      |      |      |      |
| 36007 | 173  | 36057 | 163  | 36315 | 353  |      |      |      |      |      |      |      |      |
| 36008 | 173  | 36058 | 153  | 36316 | 365  |      |      |      |      |      |      |      |      |
| 36009 | 181  | 36059 | 150  | 36317 | 378  |      |      |      |      |      |      |      |      |
| 36010 | 186  | 36060 | 144  | 36318 | 389  |      |      |      |      |      |      |      |      |
| 36011 | 181  | 36061 | 155  | 36319 | 400  |      |      |      |      |      |      |      |      |
| 36012 | 167  | 36062 | 167  | 36320 | 412  |      |      |      |      |      |      |      |      |
| 36013 | 167  | 36063 | 178  | 36321 | 419  |      |      |      |      |      |      |      |      |
| 36014 | 171  | 36064 | 184  | 36322 | 417  |      |      |      |      |      |      |      |      |
| 36015 | 175  | 36065 | 191  | 36323 | 405  |      |      |      |      |      |      |      |      |
| 36016 | 180  | 36066 | 197  | 36324 | 391  |      |      |      |      |      |      |      |      |
| 36017 | 171  | 36067 | 203  | 36325 | 378  |      |      |      |      |      |      |      |      |
| 36018 | 166  | 36068 | 212  | 36326 | 285  |      |      |      |      |      |      |      |      |
| 36019 | 160  | 36069 | 214  | 36327 | 268  |      |      |      |      |      |      |      |      |
| 36020 | 155  | 36070 | 208  | 36328 | 252  |      |      |      |      |      |      |      |      |
| 36021 | 161  | 36071 | 193  | 36329 | 239  |      |      |      |      |      |      |      |      |
| 36022 | 160  | 36072 | 164  | 36330 | 223  |      |      |      |      |      |      |      |      |
| 36023 | 169  | 36073 | 136  | 36331 | 207  |      |      |      |      |      |      |      |      |
| 36024 | 177  | 36074 | 136  | 36332 | 193  |      |      |      |      |      |      |      |      |
| 36025 | 168  | 36075 | 146  |       |      |      |      |      |      |      |      |      |      |
| 36026 | 167  | 36076 | 137  |       |      |      |      |      |      |      |      |      |      |
| 36027 | 162  | 36077 | 128  |       |      |      |      |      |      |      |      |      |      |
| 36028 | 173  | 36078 | 126  |       |      |      |      |      |      |      |      |      |      |
| 36029 | 181  | 36079 | 131  |       |      |      |      |      |      |      |      |      |      |
| 36030 | 189  | 36080 | 136  |       |      |      |      |      |      |      |      |      |      |
| 36031 | 170  | 36081 | 142  |       |      |      |      |      |      |      |      |      |      |
| 36032 | 173  | 36082 | 146  |       |      |      |      |      |      |      |      |      |      |
| 36033 | 189  | 36083 | 137  |       |      |      |      |      |      |      |      |      |      |
| 36034 | 178  | 36084 | 134  |       |      |      |      |      |      |      |      |      |      |
| 36035 | 166  | 36085 | 128  |       |      |      |      |      |      |      |      |      |      |
| 36036 | 157  | 36086 | 123  |       |      |      |      |      |      |      |      |      |      |
| 36037 | 154  | 36087 | 117  |       |      |      |      |      |      |      |      |      |      |
| 36038 | 158  | 36088 | 115  |       |      |      |      |      |      |      |      |      |      |

CHANGE, DECISION NO.

83336

EFFECTIVE

ISSUED BY THE PUBLIC UTILITIES COMMISSION OF THE STATE OF CALIFORNIA,  
CORRECTION SAN FRANCISCO, CALIFORNIA.