

T/MG

Decision 88 03 031 MAR 09 1988**ORIGINAL**

## BEFORE THE PUBLIC UTILITIES COMMISSION OF THE STATE OF CALIFORNIA

In the Matter of the Application )  
 of LOS ANGELES COUNTY TRANSPORTATION )  
 COMMISSION )  
 for an order authorizing the )  
 construction of two light rail )  
 vehicle tracks at separated grade )  
 above Firestone Boulevard and the )  
 relocation of two existing Southern )  
 Pacific Transportation Company )  
 tracks at separated grade above )  
 Firestone Boulevard, CPUC crossing )  
 No. BBH 489.44B in the County of )  
 Los Angeles, California. )

Application 87-12-034  
 (Filed December 16, 1987)

## O P I N I O N

As part of the project to construct a light rail transit (LRT) system, the Los Angeles County Transportation Commission (LACTC) requests authority to remove the existing Firestone Boulevard steel grade separation crossing structure to permit the construction of two light rail vehicle (LRV) tracks and to relocate two tracks of Southern Pacific Transportation Company's (SPT) Wilmington Branch Line, all at separated grades over Firestone Boulevard in Los Angeles County.

The Long Beach-Los Angeles Rail Transit Project is part of an on-going transit development process in which the Long Beach-Los Angeles corridor and thirteen other corridors have been identified as candidates for transit improvements. The project is being planned as a conventional LRT system from downtown



Los Angeles to downtown Long Beach to serve between 54,000 and 76,000 passengers per day. Mitigation measures will either eliminate or reduce the severity of the adverse impacts to acceptable levels.

LACTC is the lead agency for this project under the California Environmental Quality Act of 1970 (CEQA), as amended, Public Resources Code Sections 21000, et seq. After preparation and review of the Environmental Impact Report (EIR), LACTC approved the project. On March 29, 1985, a Notice of Determination was filed with the Secretary for Resources and with the Los Angeles County Clerk which found that "The project will have a significant impact on the environment."

The Commission is a responsible agency for this project under CEQA and has reviewed and considered the lead agency's EIR.

The site of the existing SPT steel grade separation structure to be removed at Firestone Boulevard has been inspected by the Commission staff, who have discussed this matter with LACTC engineering consultants and reviewed the proposed new grade separations plans, portions of which have been incorporated in the appendix attached to this order. However, the staff and LACTC are not in agreement over the need for the installation of railings on the LRV aerial structures.

Pending the resolution of the need for LACTC to install railings on its aerial structures and so that the project will not be unduly delayed, we will issue an order granting authority to remove the existing grade separation structure and to permit the construction of the LRV tracks and the relocated SPT tracks at separated grades. A later final order will be issued at such time as the need for the installation of the aerial structure railings is resolved.



LACTC has met the filing requirements of the Commission's Rules of Practice and Procedure including Rule 40, which relates to the construction of a railroad track across a public highway. Detailed drawings of the grade separations and street geometrics are in the appendix attached to the application and to this order.

LACTC wishes to commence construction of this portion of its LRT system as soon as possible. It is therefore requested that the usual 30-day effective date on an order be waived. We will make our order effective immediately.

Notice of the application was published in the Commission's Daily Calendar on December 21, 1987. No protests have been received. A public hearing is not necessary.

Findings of Fact

1. LACTC requests authority under Public Utilities Code 1201-1205; to remove the existing railroad steel grade separation structure at Firestone Boulevard, to construct two LRV tracks and to relocate two tracks of SPT's Wilmington Branch Line, all at separated grades over Firestone Boulevard in Los Angeles County.

2. Construction of the LRV tracks and relocation of the SPT tracks at separated grades as well as removal of the existing grade separation structure, is an essential element in the construction of the LRT system.

3. Public convenience, necessity, and safety require removal of the existing grade separation and construction of the new grade separations across Firestone Boulevard as set forth in the appendix.

4. It has not been determined if there is need for railings on LRV aerial structures.

5. LACTC is the lead agency for this project under CEQA, as amended.



6. The Commission is a responsible agency for this project and has reviewed and considered the lead agency's FEIR.

7. The Long Beach-Los Angeles Rail Transit Project will have a significant impact on the environment; however, mitigation measures will reduce the severity of the adverse impacts to acceptable levels.

8. A Statement of Overriding Considerations was adopted for the project.

Conclusions of Law

1. This requested authority to construct crossings should be granted .

2. This proceeding should remain open until final resolution of the need for LACTC to install railings on its aerial structures is determined.

INTERIM ORDER

IT IS ORDERED that:

1. The Los Angeles County Transportation Commission (LACTC) is authorized to: remove the existing Firestone Boulevard grade separation steel structure, identified as crossing BBH-489.43-B, to construct two LRV tracks, to be identified as Crossing 84L-7.2-B, and to relocate two tracks of Southern Pacific Transportation Company's (SPT) Wilmington Branch Line to be identified as Crossing BBH-489.43-B, all at separated grades over Firestone Boulevard in Los Angeles County, at the location and substantially as shown on the appendix plans attached to the application and this order.

2. For the relocation of the two SPT tracks, clearances shall be in accordance with General Order (GO) 26-D. Walkways shall conform to GO 118.



3. Construction and maintenance costs shall be borne in accordance with an agreement which has been entered into between the parties. A copy of the agreement has been filed with the Commission.

4. Within 30 days after completion of the work under this order, LACTC shall notify the Commission in writing that the authorized work has been completed.

5. This authorization shall expire if not exercised within three years unless time is extended or if the above conditions are not complied with. Authorization may be revoked or modified if public convenience, necessity, or safety so require.

6. This proceeding shall remain open to allow for resolution of the question whether LACTC should install railings on its aerial structures.

7. The application is granted as set forth above.  
This order is effective today.

Dated MAR 09 1988, at San Francisco, California.

STANLEY W. HULETT  
President  
DONALD VIAL  
FREDERICK R. DUDA  
C. MITCHELL WILK  
JOHN B. OHANIAN  
Commissioners

I CERTIFY THAT THIS DECISION  
WAS APPROVED BY THE ABOVE  
COMMISSIONERS TODAY.

*Victor Weiss*  
Victor Weiss, Executive Director



THE NEXT 1  
DOCUMENTS  
ARE POOR  
ORIGINALS

MICROFILMING SERVICES  
WILL NOT ASSUME  
RESPONSIBILITY FOR THE  
IMAGE QUALITY

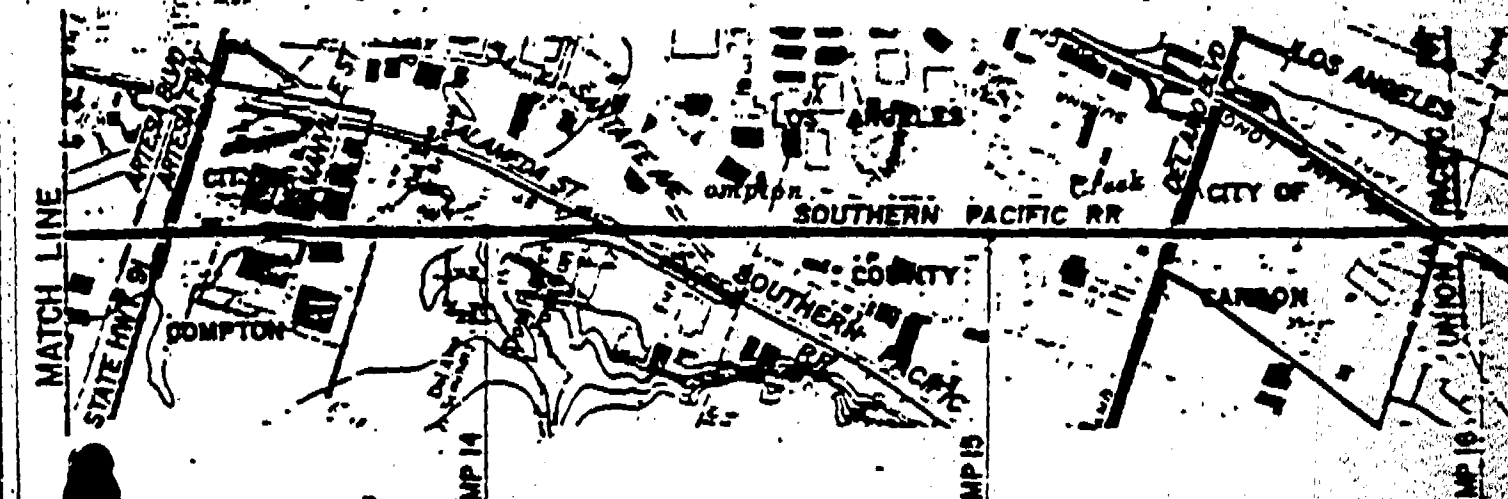
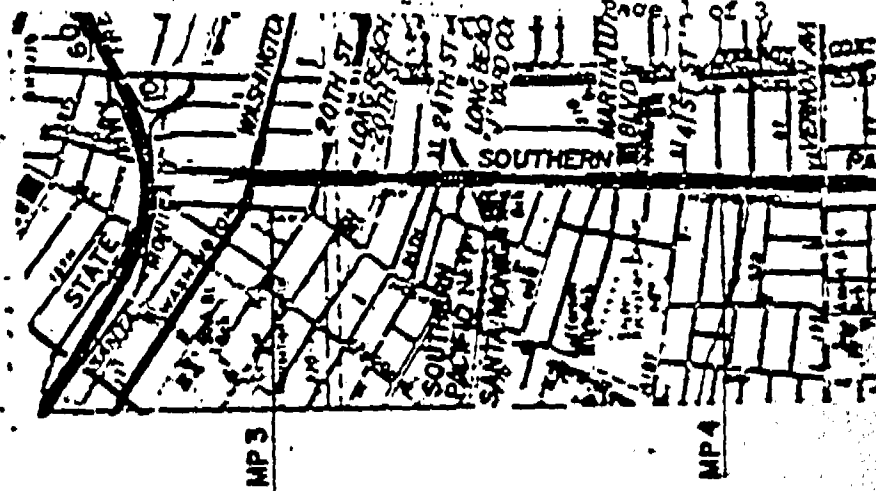
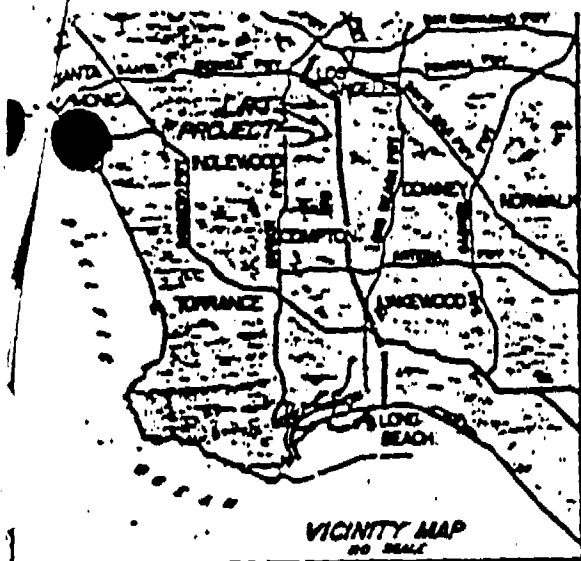

[illegible]



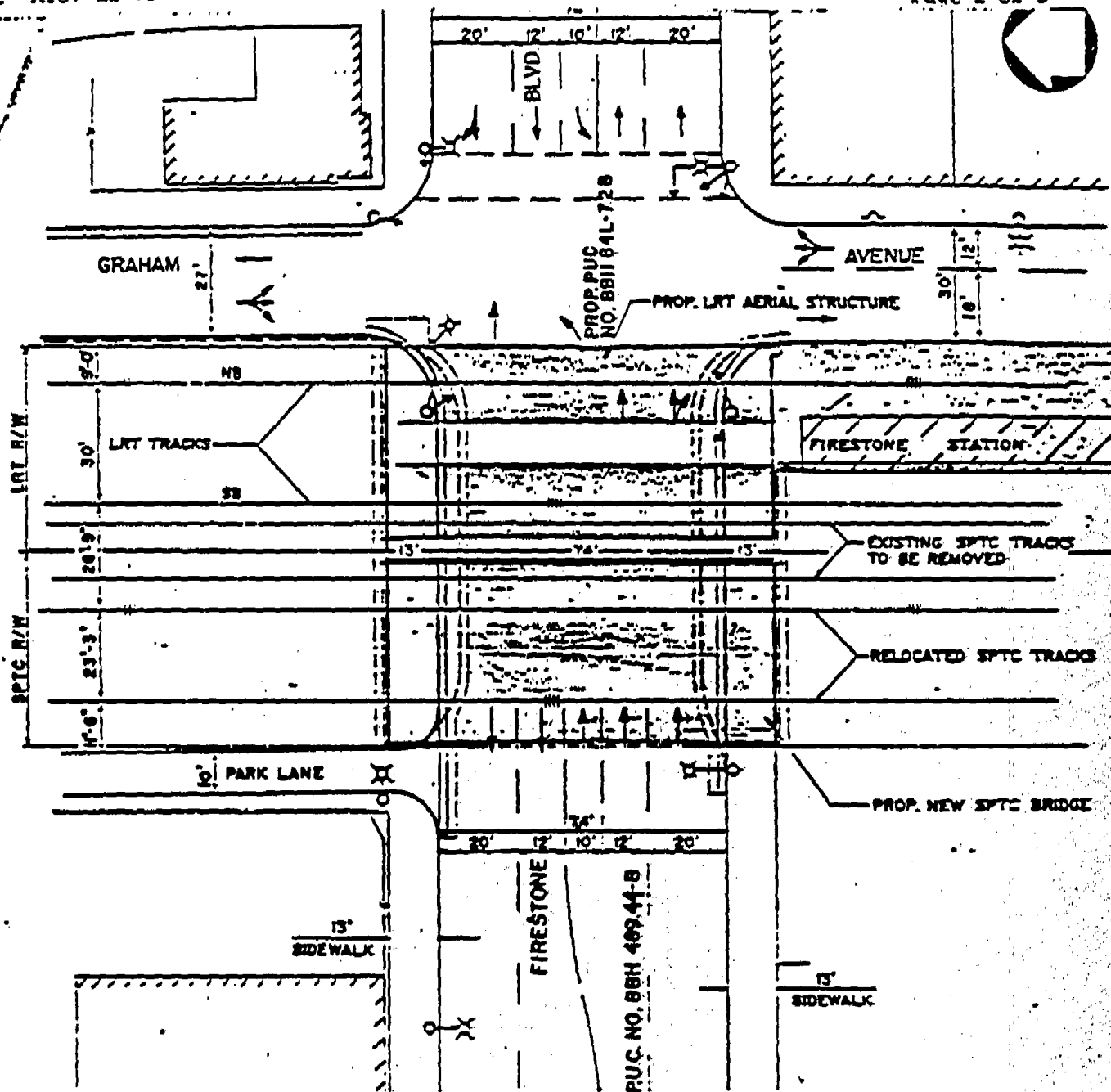

**FIRESTONE BOULEVARD  
PLAN**

**LEGEND**

- MAST ARM TRAFFIC SIGNAL
- TRAFFIC SIGNAL
- POWER POLE
- STREET LIGHT
- EXISTING BUILDING
- EXIST. CURB & GUTTER TO BE REMOVED
- FINAL CURB & GUTTER RETAINING WALL

																																																																																																																																																																																																																																																																																																																																																																																																																																																																																																																																																																																																																																																																																																																																																																																																																																																																																																																																																																																																																																																																																																																																																																																																																																																																																																																																																																																																																					</
--	--	--	--	--	--	--	--	--	--	--	--	--	--	--	--	--	--	--	--	--	--	--	--	--	--	--	--	--	--	--	--	--	--	--	--	--	--	--	--	--	--	--	--	--	--	--	--	--	--	--	--	--	--	--	--	--	--	--	--	--	--	--	--	--	--	--	--	--	--	--	--	--	--	--	--	--	--	--	--	--	--	--	--	--	--	--	--	--	--	--	--	--	--	--	--	--	--	--	--	--	--	--	--	--	--	--	--	--	--	--	--	--	--	--	--	--	--	--	--	--	--	--	--	--	--	--	--	--	--	--	--	--	--	--	--	--	--	--	--	--	--	--	--	--	--	--	--	--	--	--	--	--	--	--	--	--	--	--	--	--	--	--	--	--	--	--	--	--	--	--	--	--	--	--	--	--	--	--	--	--	--	--	--	--	--	--	--	--	--	--	--	--	--	--	--	--	--	--	--	--	--	--	--	--	--	--	--	--	--	--	--	--	--	--	--	--	--	--	--	--	--	--	--	--	--	--	--	--	--	--	--	--	--	--	--	--	--	--	--	--	--	--	--	--	--	--	--	--	--	--	--	--	--	--	--	--	--	--	--	--	--	--	--	--	--	--	--	--	--	--	--	--	--	--	--	--	--	--	--	--	--	--	--	--	--	--	--	--	--	--	--	--	--	--	--	--	--	--	--	--	--	--	--	--	--	--	--	--	--	--	--	--	--	--	--	--	--	--	--	--	--	--	--	--	--	--	--	--	--	--	--	--	--	--	--	--	--	--	--	--	--	--	--	--	--	--	--	--	--	--	--	--	--	--	--	--	--	--	--	--	--	--	--	--	--	--	--	--	--	--	--	--	--	--	--	--	--	--	--	--	--	--	--	--	--	--	--	--	--	--	--	--	--	--	--	--	--	--	--	--	--	--	--	--	--	--	--	--	--	--	--	--	--	--	--	--	--	--	--	--	--	--	--	--	--	--	--	--	--	--	--	--	--	--	--	--	--	--	--	--	--	--	--	--	--	--	--	--	--	--	--	--	--	--	--	--	--	--	--	--	--	--	--	--	--	--	--	--	--	--	--	--	--	--	--	--	--	--	--	--	--	--	--	--	--	--	--	--	--	--	--	--	--	--	--	--	--	--	--	--	--	--	--	--	--	--	--	--	--	--	--	--	--	--	--	--	--	--	--	--	--	--	--	--	--	--	--	--	--	--	--	--	--	--	--	--	--	--	--	--	--	--	--	--	--	--	--	--	--	--	--	--	--	--	--	--	--	--	--	--	--	--	--	--	--	--	--	--	--	--	--	--	--	--	--	--	--	--	--	--	--	--	--	--	--	--	--	--	--	--	--	--	--	--	--	--	--	--	--	--	--	--	--	--	--	--	--	--	--	--	--	--	--	--	--	--	--	--	--	--	--	--	--	--	--	--	--	--	--	--	--	--	--	--	--	--	--	--	--	--	--	--	--	--	--	--	--	--	--	--	--	--	--	--	--	--	--	--	--	--	--	--	--	--	--	--	--	--	--	--	--	--	--	--	--	--	--	--	--	--	--	--	--	--	--	--	--	--	--	--	--	--	--	--	--	--	--	--	--	--	--	--	--	--	--	--	--	--	--	--	--	--	--	--	--	--	--	--	--	--	--	--	--	--	--	--	--	--	--	--	--	--	--	--	--	--	--	--	--	--	--	--	--	--	--	--	--	--	--	--	--	--	--	--	--	--	--	--	--	--	--	--	--	--	--	--	--	--	--	--	--	--	--	--	--	--	--	--	--	--	--	--	--	--	--	--	--	--	--	--	--	--	--	--	--	--	--	--	--	--	--	--	--	--	--	--	--	--	--	--	--	--	--	--	--	--	--	--	--	--	--	--	--	--	--	--	--	--	--	--	--	--	--	--	--	--	--	--	--	--	--	--	--	--	--	--	--	--	--	--	--	--	--	--	--	--	--	--	--	--	--	--	--	--	--	--	--	--	--	--	--	--	--	--	--	--	--	--	--	--	--	--	--	--	--	--	--	--	--	--	--	--	--	--	--	--	--	--	--	--	--	--	--	--	--	--	--	--	--	--	--	--	--	--	--	--	--	--	--	--	--	--	--	--	--	--	--	--	--	--	--	--	--	--	--	--	--	--	--	--	--	--	--	--	--	--	--	--	--	--	--	--	--	--	--	--	--	--	--	--	--	--	--	--	--	--	--	--	--	--	--	--	--	--	--	--	--	--	--	--	--	--	--	--	--	--	--	--	--	--	--	--	--	--	--	--	--	--	--	--	--	--	--	--	--	--	--	--	--	--	--	--	--	--	--	--	--	--	--	--	--	--	--	--	--	--	--	--	--	--	--	--	--	--	--	--	--	--	--	--	--	--	--	--	--	--	--	--	--	--	--	--	--	--	--	--	--	--	--	--	--	--	--	--	--	--	--	--	--	--	--	--	--	--	--	--	--	--	--	--	--	--	--	--	--	--	--	--	--	--	--	--	--	--	--	--	--	--	--	--	--	--	--	--	--	--	--	--	--	--	--	--	--	--	--	--	--	--	--	--	--	--	--	--	--	--	--	--	--	--	--	--	--	--	--	--	--	--	--	--	--	--	--	--	--	--	--	--	--	--	--	--	--	--	--	--	--	--	--	--	--	--	--	--	--	--	--	--	--	--	--	--	--	--	--	--	--	--	--	--	--	--	--	--	--	--	--	--	--	--	--	--	--	--	--	--	--	--	--	--	--	--	--	--	--	--	--	--	--	--	--	--	--	--	--	--	--	--	--	--	--	--	--	--	--	--	--	--	--	--	--	--	--	--	--	--	--	--	--	--	--	--	--	--	--	--	--	--	--	--	--	--	--	--	--	--	--	--	--	--	--	--	--	--	--	--	--	--	--	--	--	--	--	--	--	--	--	--	--	--	--	--	--	--	--	--	--	--	--	--	--	--	--	--	--	--	--	--	--	--	--	--	--	--	--	--	--	--	--	--	--	--	--	--	--	--	--	--	--	--	--	--	--	--	--	--	--	--	--	--	--	--	--	--	--	--	--	--	--	--	--	--	--	--	--	--	--	--	--	--	--	--	--	--	--	--	--	--	--	--	--	--	--	--	----



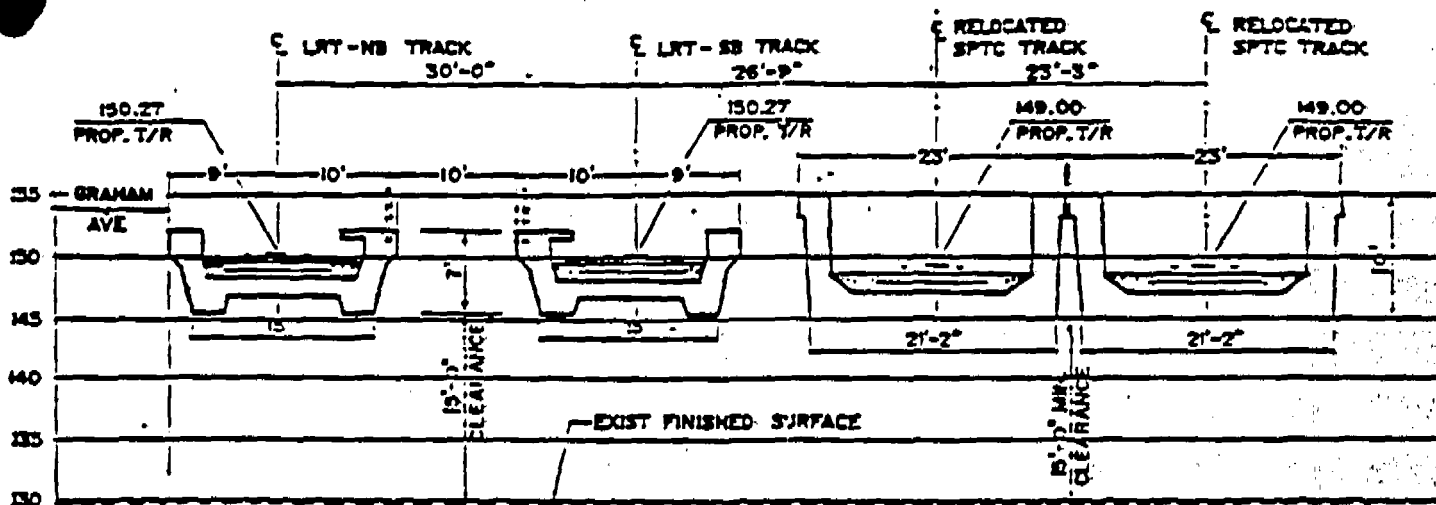

**RAILROAD CROSS-SECTION**

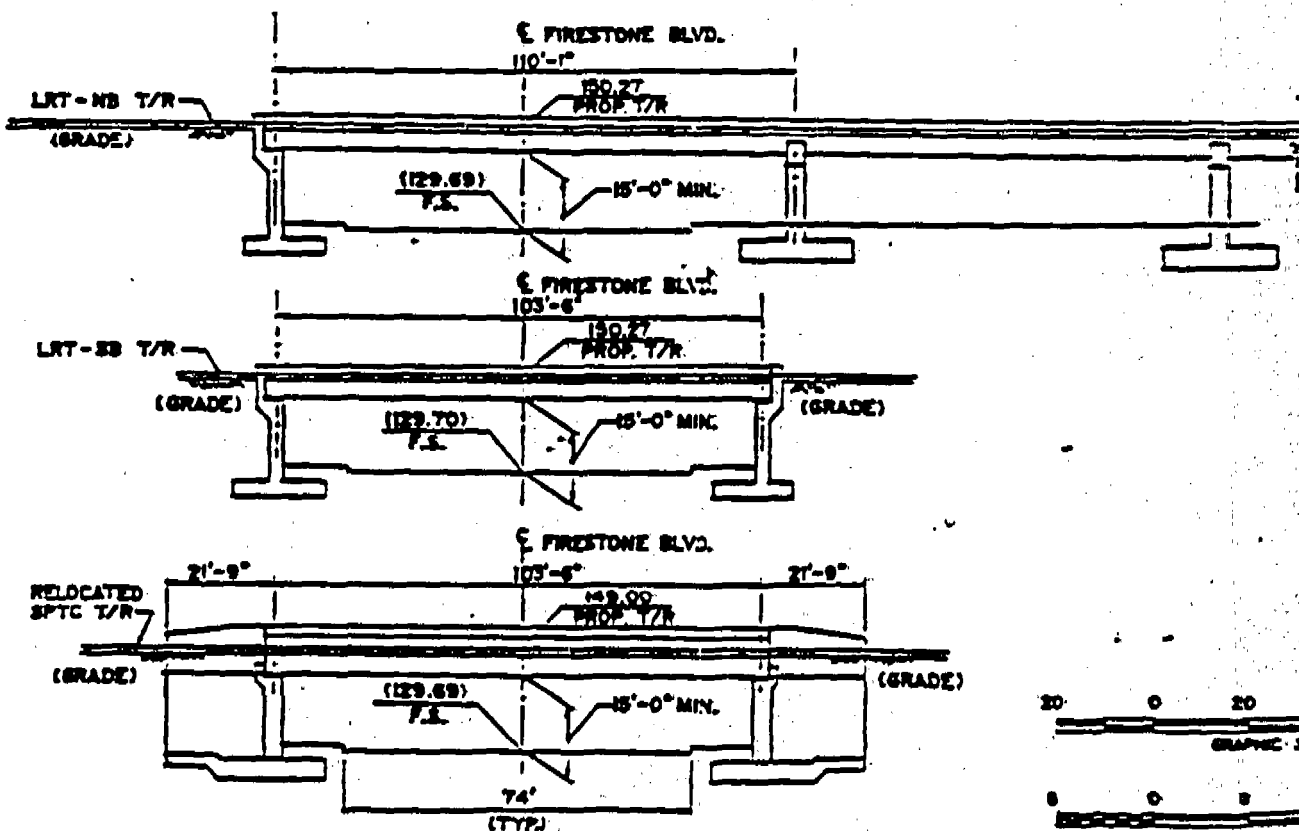

**RAILROAD PROFILE**

**EXHIBIT B**

GELES COUNTY TRANSPORTATION COMMISSION  
is Long Beach-Los Angeles Rail Transit Project

PROPOSED SPTC TRACK RELOCATION AND CONSTRUCTION  
OF LACTC LRT TRACK  
AT FIRESTONE BOULEVARD GRADE SEPARATION  
CPUC CROSSING No. 38H 489.44B DOT CROSSING No. 747858K

CONTRACT NO.  
SHEET NO.

TORRES RAIL CONSULTANTS

Southern California Rail Consultants

10/1/2010



Decision \_\_\_\_\_

BEFORE THE PUBLIC UTILITIES COMMISSION OF THE STATE OF CALIFORNIA

In the Matter of the Application of )  
LOS ANGELES COUNTY TRANSPORTATION )  
COMMISSION )  
for an order authorizing the )  
construction of two light rail vehicle )  
tracks at separated grade above )  
Firestone Boulevard and the relocation )  
of two existing Southern Pacific )  
Transportation Company tracks at )  
separated grade above Firestone )  
Boulevard, CPUC Crossing No. BBH )  
489.44B in the County of Los Angeles, )  
California. )

Application 87-12-034  
(Filed December 16, 1987)

O P I N I O N

As part of the project to construct a light rail transit (LRT) system, the Los Angeles County Transportation Commission (LACTC) requests authority to remove the existing Firestone Boulevard steel grade separation crossing structure to permit the construction of two light rail vehicle (LRV) tracks and to relocate two tracks of Southern Pacific Transportation Company's (SPT) Wilmington Branch Line, all at separated grades over Firestone Boulevard in Los Angeles County.

The Long Beach-Los Angeles Rail Transit Project is part of an on going transit development process in which the Long Beach-Los Angeles corridor and thirteen other corridors have been identified as candidates for transit improvements. The project is being planned as a conventional LRT system from downtown Los Angeles to downtown Long Beach to serve between 54,000 and 76,000 passengers per day. Mitigation measures will either eliminate or reduce the severity of the adverse impacts to acceptable levels.

LACTC is the lead agency for this project under the California Environmental Quality Act of 1970 (CEQA), as amended,



Public Resources Code Sections 21000, et seq. After preparation and review of the Environmental Impact Report (EIR), LACTC approved the project. On March 29, 1985, a Notice of Determination was filed with the Secretary for Resources and with the Los Angeles County Clerk which found that "The project will have a significant impact on the environment".

The Commission is a responsible agency for this project under CEQA and has reviewed and considered the lead agency's EIR.

The site of the existing SPT steel grade separation structure to be removed at Firestone Boulevard has been inspected by the Commission staff, who have discussed this matter with LACTC engineering consultants and reviewed the proposed new grade separation plans, portions of which have been incorporated in the appendix attached to this order. The staff recommends the Commission authorize LACTC's proposed grade separations at Firestone Boulevard.

LACTC has met the filing requirements of the Commission's Rules of Practice and Procedure including Rule 40, which relates to the construction of a railroad track across a public highway. Detailed drawings of the grade separations and street geometrics are in the appendix attached to this order.

LACTC wishes to commence construction of this portion of its LRT system in February 1988. It is therefore requested that the usual 30-day effective date on an order be waived. We will make our order effective immediately.

Notice of the application was published in the Commission's Daily Calendar on December 21, 1987. No protests have been received. A public hearing is not necessary.

#### Findings of Fact

1. LACTC requests authority under Public Utilities Code 1201-1205; to remove the existing railroad steel grade separation structure at Firestone Boulevard, to construct two LRV tracks and to relocate two tracks of Southern Pacific Transportation Company's



SPT's Wilmington Branch Line, all at separated grades over Firestone Boulevard in Los Angeles County.

2. Construction of the LRV tracks and relocation of the SPT tracks at separated grades as well as removal of the existing grade separation structure, is an essential element in the construction of the LRT system.

3. Public convenience, necessity, and safety require removal of the existing grade separation and construction of the new grade separations across Firestone Boulevard as set forth in the appendix.

4. LACTC is the lead agency for this project under CEQA, as amended.

5. The Commission is a responsible agency for this project and has reviewed and considered the lead agency's FEIR.

6. The Long Beach-Los Angeles Rail Transit Project will have a significant impact on the environment; however, mitigation measures will reduce the severity of the adverse impacts to acceptable levels.

7. A Statement of Overriding Considerations was adopted for the project.

#### Conclusions of Law

1. The application should be granted as set forth in the following order.

2. The usual 30-day effective date on an order should be waived as LACTC wishes to commence construction of the project in February 1988.



O R D E R

IT IS ORDERED that:

1. The Los Angeles County Transportation Commission (LACTC) is authorized to: remove the existing Firestone Boulevard grade separation steel structure, identified as crossing BBH-489.43-B, to construct two LRV tracks, to be identified as Crossing 84L-7.2-B, and to relocate two tracks of Southern Pacific Transportation Company's (SPT) Wilmington Branch Line to be identified as Crossing BBH-489.43-B, all at separated grades over Firestone Boulevard in Los Angeles County, at the location and substantially as shown on the appendix plans attached to the application and this order.

2. Clearances shall be in accordance with General Order (GO) 26-D. Walkways shall conform to GO 118.

3. Construction and maintenance costs shall be borne in accordance with an agreement which has been entered into between the parties. A copy of the agreement has been filed with the Commission.

4. Within 30 days after completion of the work under this order, LACTC shall notify the Commission in writing that the authorized work has been completed.

5. This authorization shall expire if not exercised within three years unless time is extended or if the above conditions are not complied with. Authorization may be revoked or modified if public convenience, necessity, or safety so require.



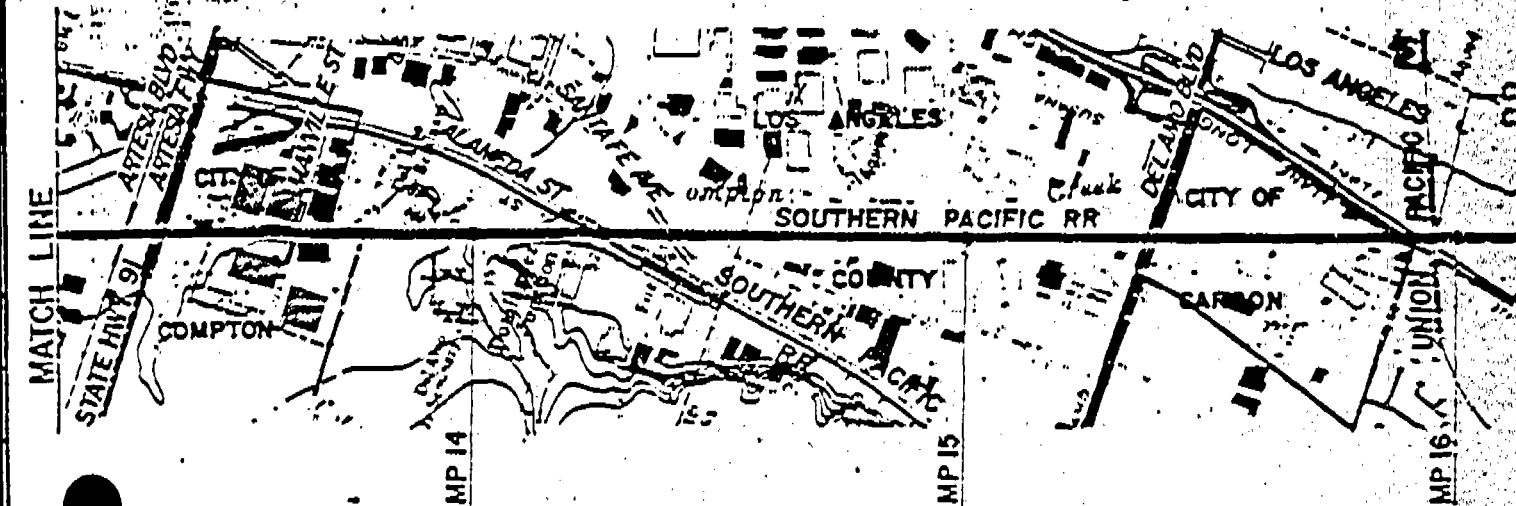
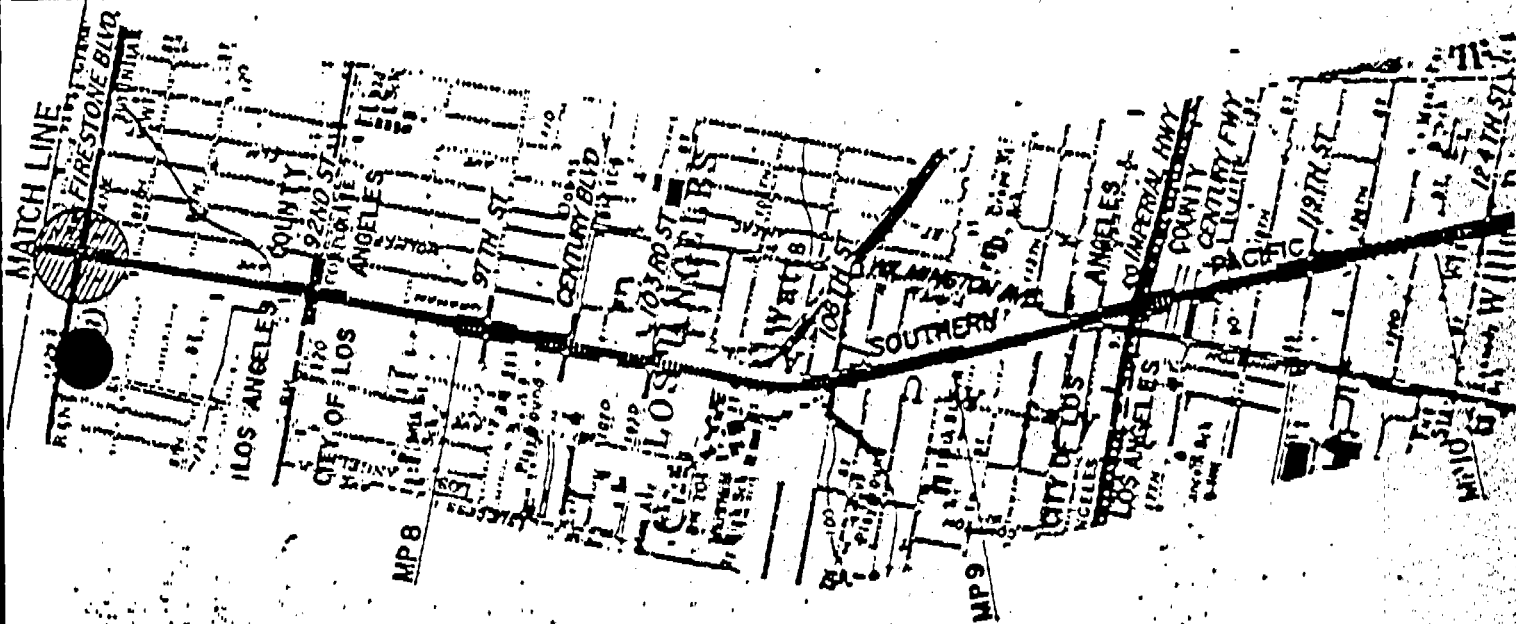
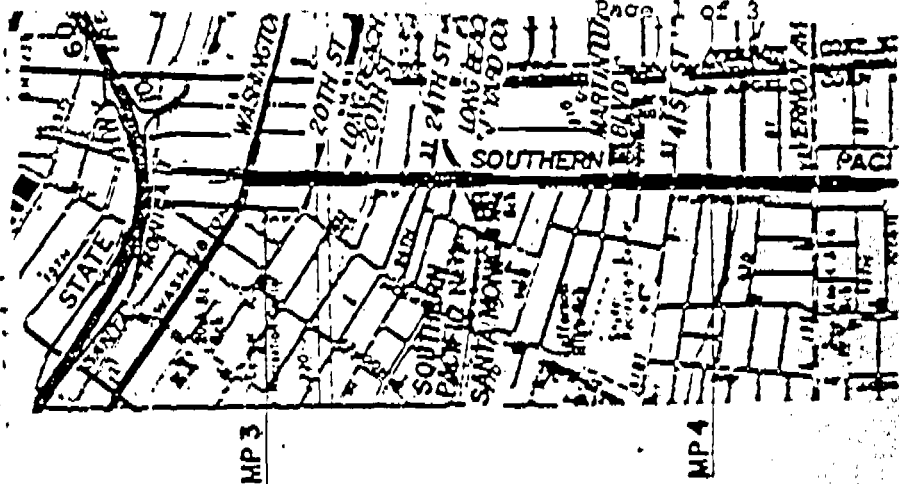
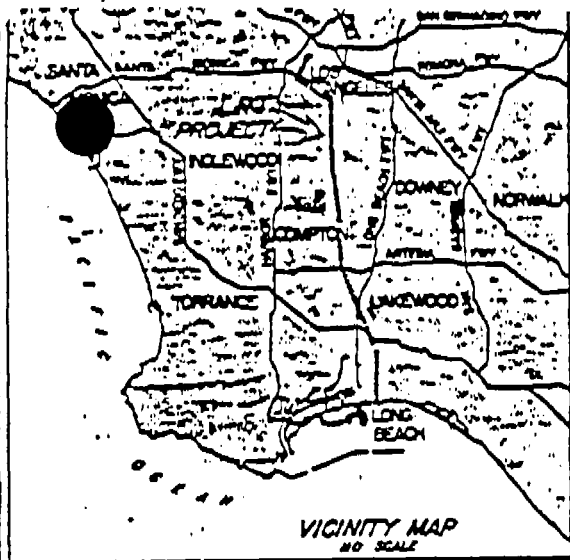

<p>REVISIONS</p> <table border="1"> <tr> <th>REV</th> <th>DATE</th> <th>DESCRIPTION</th> <th>BY</th> <th>APP</th> </tr> <tr><td> </td><td> </td><td> </td><td> </td><td> </td></tr> <tr><td> </td><td> </td><td> </td><td> </td><td> </td></tr> <tr><td> </td><td> </td><td> </td><td> </td><td> </td></tr> <tr><td> </td><td> </td><td> </td><td> </td><td> </td></tr> </table>	REV	DATE	DESCRIPTION	BY	APP																					<p>DESIGNED BY</p> <p>DRAWN BY</p> <p>CHECKED BY</p> <p>APPROVED BY</p> <p>DATE</p>	<p>LOS ANGELES The Low</p> <p>Southern California</p> <p>SUBMITTED</p>
REV	DATE	DESCRIPTION	BY	APP																							



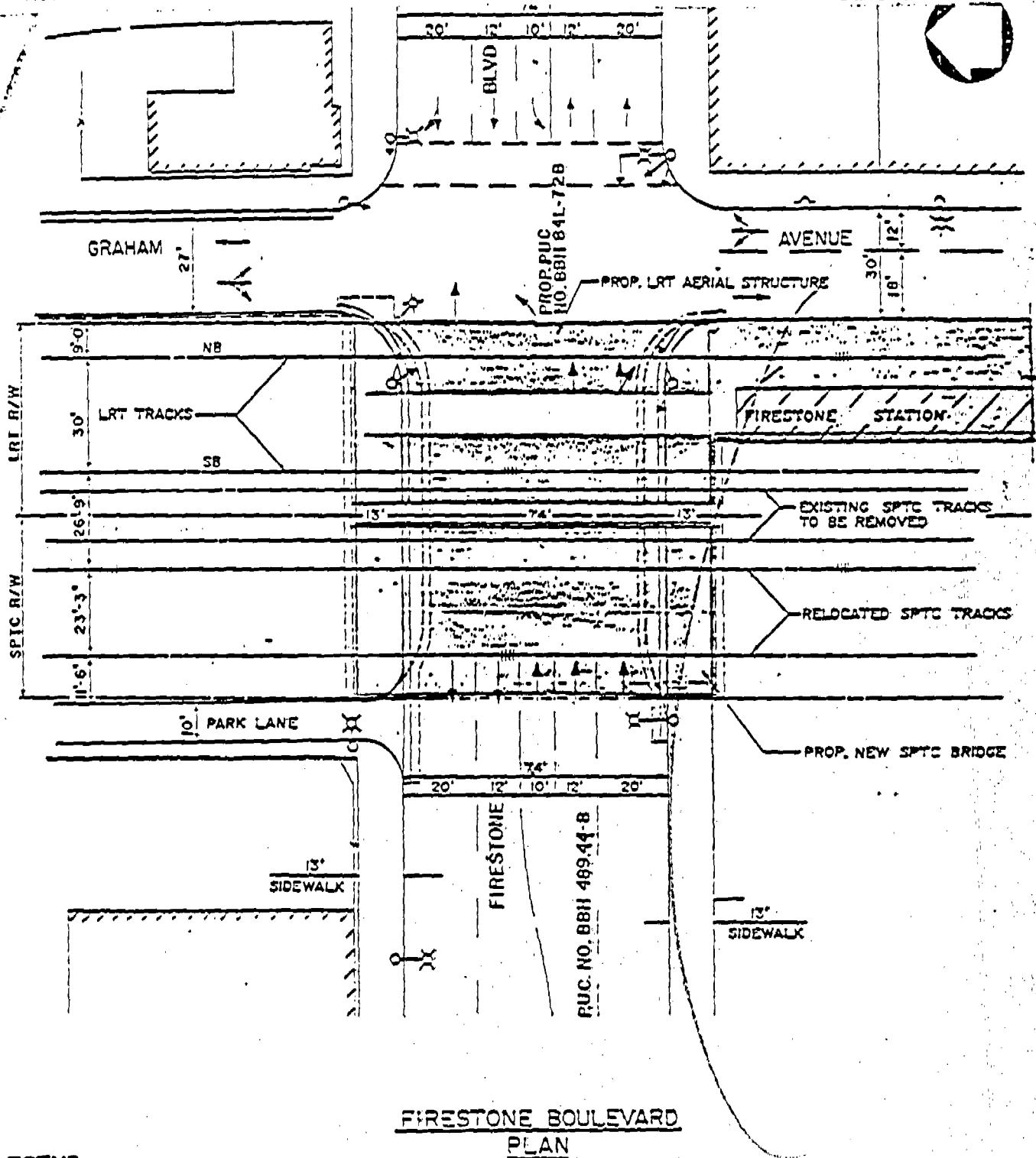

**LEGEND**

- MAST ARM TRAFFIC SIGNAL
- TRAFFIC SIGNAL
- POWER POLE
- STREET LIGHT
- EXISTING BUILDING
- EXIST. CURB & GUTTER TO BE REMOVED
- FINAL CURB & GUTTER RETAINING WALL

PREPARED BY: _____ CHECKED BY: _____ APPROVED BY: _____ DATE: _____		LOS ANGELES THE CL SOUTHERN CALIFORNIA SUBMITTED: _____
REV. DATE: _____ DESCRIPTION: _____		



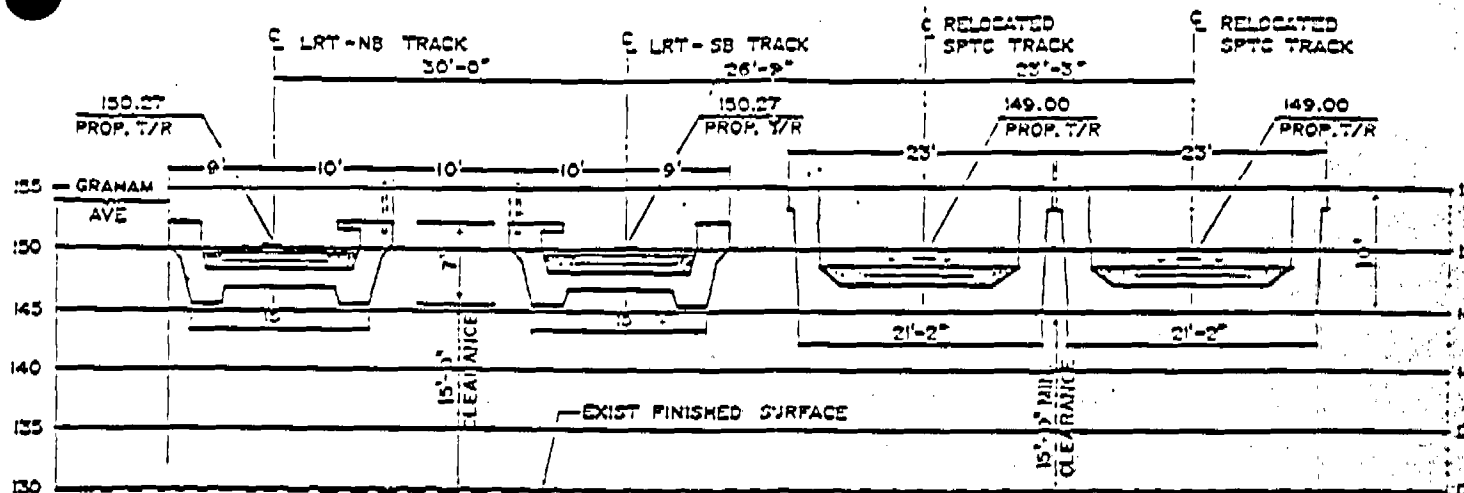

RAILROAD CROSS-SECTION

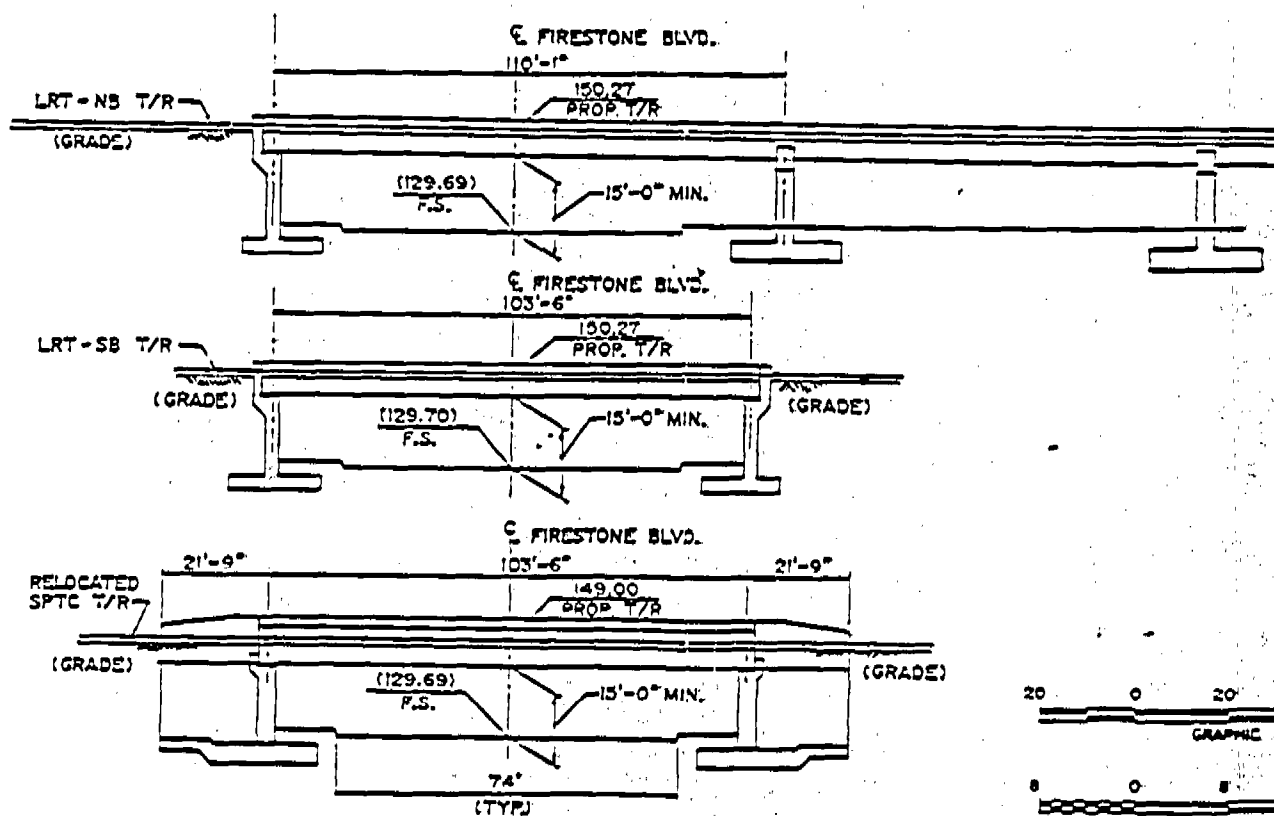

RAILROAD PROFILE

EXHIBIT B

ANGELES COUNTY TRANSPORTATION COMMISSION  
Long Beach-Los Angeles Rail Transit Project

Tomlin Rail Consultants

Southern California Rail Consultants

Project Engineer:  
Professional Engineer & Surveyor, with  
Professional Engineer & Surveyor License  
No. 10000, State of California

PROPOSED SPTC TRACK RELOCATION AND CONSTRUCTION  
OF LACTC LRT TRACK  
AT FIRESTONE BOULEVARD GRADE SEPARATION  
C.P.U.C. CROSSING No. 88H 489.448 D.O.T. CROSSING No. 747858K  
PROPOSED LACTC CROSSING NO. 841-728

CONTRACT NO.  
DRAWING NO.  
REV. SHEET NO.  
SCALE: 1" = 40'



6. The application is granted as set forth above.

This order is effective today.

Dated \_\_\_\_\_, at San Francisco, California.