

ORIGINAL

Decision 88 09 019 SEP 14 1988

BEFORE THE PUBLIC UTILITIES COMMISSION OF THE STATE OF CALIFORNIA

Application of the State of California,)	
Department of Transportation, for an)	
order authorizing the Department to:)	
Widen Existing Grade Separations)	Application 88-06-040
(Benicia-Martinez and Mococo) over the)	(Filed June 23, 1988)
tracks of the Southern Pacific)	
Transportation Company in Contra Costa)	
and Solano Counties.)	
)	

O P I N I O N

The State of California, Department of Transportation (Caltrans), requests authority to widen the Mococo Overhead and the Benicia-Martinez Bridge and Overhead along Interstate Route(I) 680 at separated grades over Southern Pacific Transportation Company's (SPT) tracks in Martinez, Contra Costa County.

Caltrans also requests authority to widen the Benicia-Martinez Bridge and Overhead at separated grades over SPT's tracks in Benicia, Solano County.

The existing structure provides width for only two standard lanes in each direction at both structures. The proposed widening on the Benicia-Martinez Bridge consists of widening on the outside in both directions and the proposed widening on Mococo Overhead consists of widening in the median between the two existing structures. The widening will provide for three lanes of travel in each direction at both structures. The project will increase roadway capacity and improve safety on I-680.

Caltrans is the lead agency for this project under the California Environmental Quality Act of 1970 (CEQA), as amended, Public Resources (PR) Code Sections 21000, et seq. Caltrans has determined that the project is exempt from CEQA under PR Code Section 21080.13.

The Commission is a responsible agency for this project under CEQA and has reviewed and considered the lead agency's exemption determination. The site of the proposed project has been inspected by the Commission's Traffic Engineering staff. The staff examined the need for and safety of widening of the crossings. The staff recommends that the sought authority be granted.

Application 88-06-040 meets the filing requirements of the Commission's Rules of Practice and Procedure, including Rule 38, which relates to the construction of a public highway across a railroad. Sketches of the crossings are set forth as Appendix A.

Notice of the application was published in the Commission's Daily Calender on June 28, 1988. No protests have been received. A public hearing is not necessary.

Findings of Fact

1. Caltrans requests authority under Public Utilities Code Sections 1201-1205 to widen the Mococo Overhead and the Benicia-Martinez Bridge and Overhead at separated grades over SPT's tracks in Martinez, Contra Costa County.
2. Authority is also requested to widen the Benicia-Martinez Bridge and Overhead at separated grades over SPT's tracks in Benicia, Solano County.
3. Widening of the overheads is required to increase roadway capacity.
4. Public convenience, necessity, and safety require widening of the Mococo Overhead and the Benicia-Martinez Bridge and Overhead.
5. Caltrans is the lead agency for this project under CEQA, as amended.
6. The Commission is a responsible agency for this project and has reviewed and considered the lead agency's exemption determination.
7. It can be seen with certainty that there is no possibility that the activity in question may have a significant effect on the environment.

Conclusions of Law

1. The application should be granted as set forth in the following order.
2. The activity is not covered by the requirements set forth in CEQA and, therefore, the guidelines (14 Cal. Admin. Code - Div. 6) concerning the evaluation of projects and the preparation and review of environmental documents do not apply.

O R D E R

IT IS ORDERED that:

1. The State of California, Department of Transportation (Caltrans), is authorized to widen the Mococo Overhead and the Benicia-Martinez Bridge and Overhead along I-680 at separated grades over Southern Pacific Transportation Company's (SPT) tracks in Martinez, Contra Costa County, at the location and substantially as shown by plans attached to the application, identified as Crossings B-36.1-A and A-36.4-A respectively.
2. Caltrans is further authorized to widen the Benicia-Martinez Bridge and Overhead at separated grades over SPT's tracks in Benicia, Solano County, identified as Crossing A-37.0-AC.
3. Clearances shall be in accordance with General Order (GO) 26-D.
4. Walkways shall conform to GO 118. Walkways adjacent to any trackage subject to rail operations shall be maintained free of obstructions and shall be promptly restored to their original conditions in the event of damage during construction.
5. Construction and maintenance costs shall be borne in accordance with an agreement to be entered into between the parties. A copy of the agreement, together with plans of the crossings approved by SPT, shall be filed with the Commission prior to commencing construction. Should the parties fail to agree, the Commission will apportion the costs of construction and maintenance by further order.

6. Within 30 days after completion of the work under this order, Caltrans shall notify the Commission in writing that the authorized work has been completed.

7. This authorization shall expire if not exercised within three years unless time is extended or if the above conditions are not complied with. Authorization may be revoked or modified if public convenience, necessity, or safety so require.

8. The application is granted as set forth above.

This order becomes effective 30 days from today.

Dated SEP 14 1988, at San Francisco, California.

STANLEY W. HULETT
President

DONALD VIAL
FREDERICK R. DUDA
G. MITCHELL WILK
JOHN B. OHANIAN
Commissioners

I CERTIFY THAT THIS DECISION
WAS APPROVED BY THE ABOVE
COMMISSIONERS TODAY.

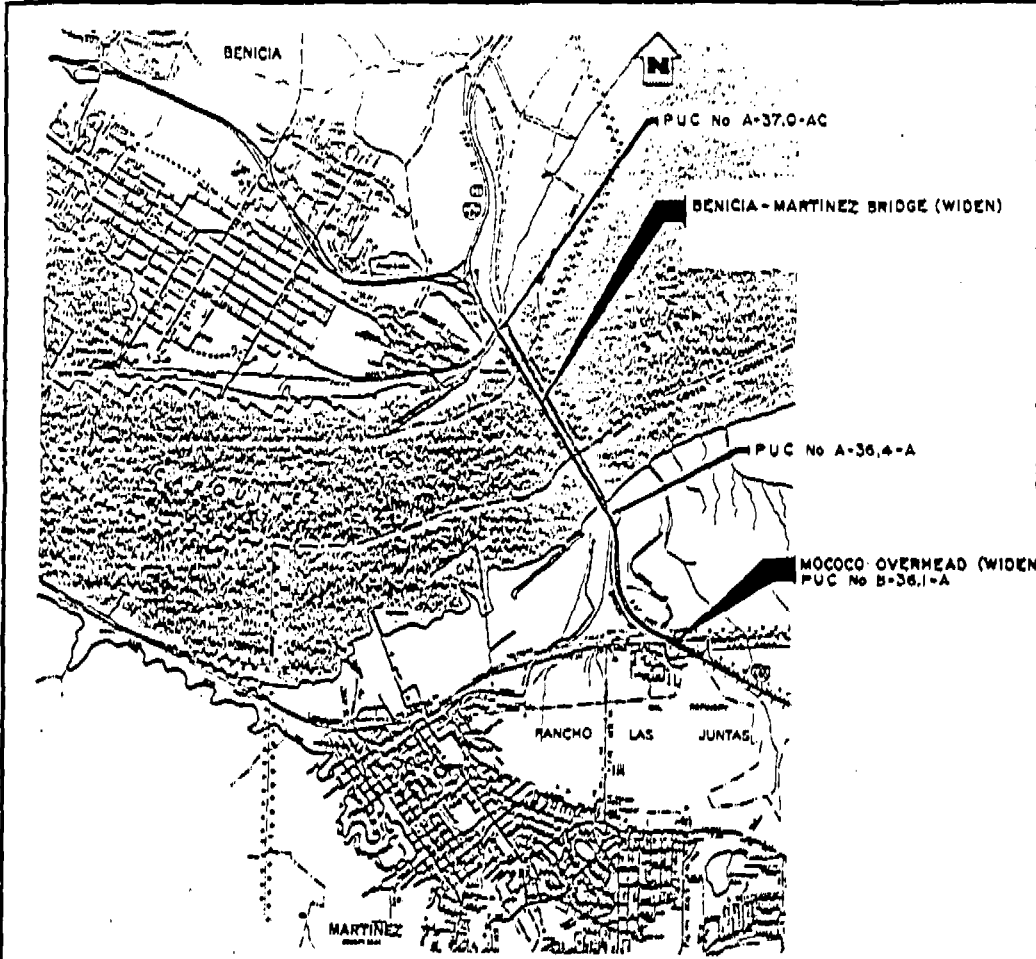

Victor Weisser, Executive Director

Dist	COUNTY	MAP
04	SONOMA	680
SHEET OFFICE OF STRUCTURES DIVISION PUBLIC UTILITIES COMMISSION		
DATE: 10/15/54		

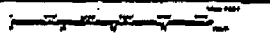
VICINITY MAP

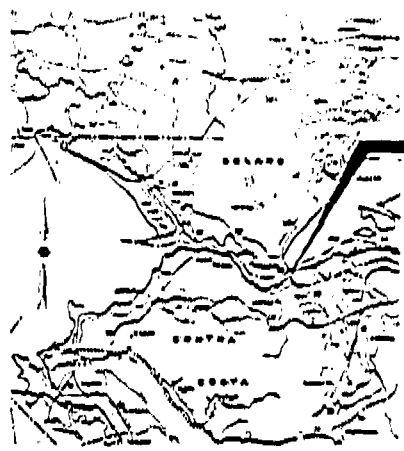

LOCATION MAP

PROJECT LOCATION

A.88-06-040 TASC/jpk

REDUCED PLAN
 USE SCALE BELOW

State of CALIFORNIA DEPARTMENT OF TRANSPORTATION	STRUCTURES - DESIGN 2	PUBLIC UTILITIES COMMISSION SHEET - EXHIBIT "E"
	MADE BY: ACCP	
CU 10-522 WD 10-522	VARIOUS WORK	BENICIA-MARTINEZ BRIDGE (WIDEN) MOCOCO OVERHEAD (WIDEN)

APPENDIX A
 SHEET 1 OF 3

DATE	COUNTY	ROUTE	POST MILE	STATION
04 (SOL. P.C.)	080			
CHIEF OFFICE OF STRUCTURE DESIGN HIGHWAY DIVISION 1200 CALIFORNIA ST. S.F.				

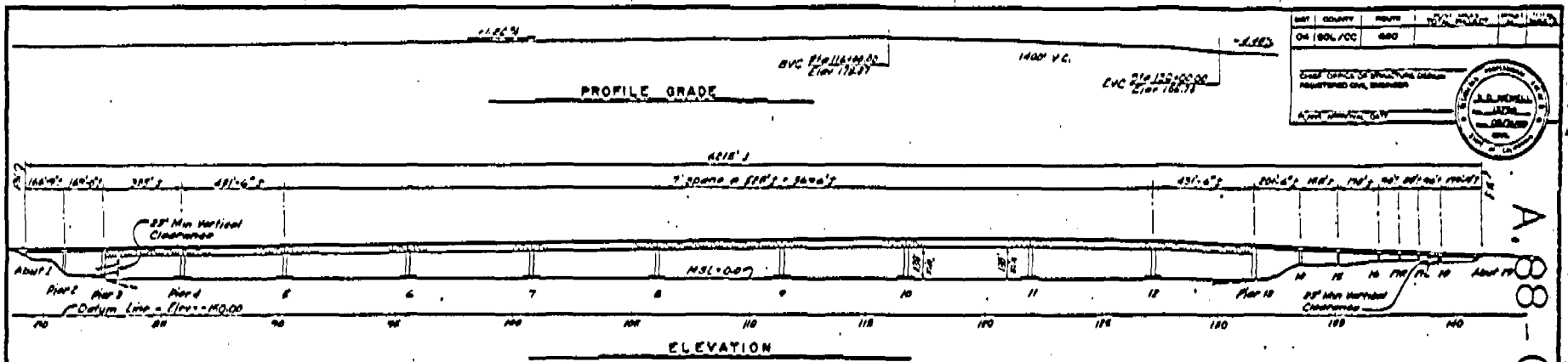

- Location (A) Existing Overhead PUC No. A-37,0-AC. See Sheet 3
- Location (B) Existing Overhead PUC No. A-36,4-A. See Sheet 3

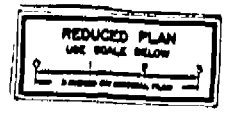
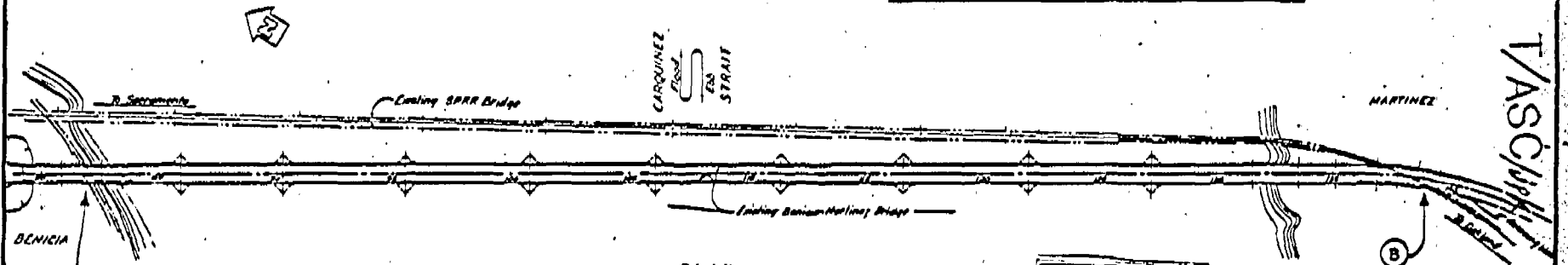
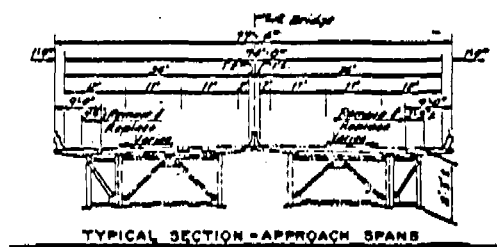

State of CALIFORNIA DEPARTMENT OF TRANSPORTATION	STRUCTURED DESIGN 2 <small>DESIGNED BY KEM</small>	PROJECT NO. 20-103 WORK NO.	BENICIA-MARTINEZ BRIDGE (WIDEN) PUBLIC UTILITIES COMMISSION SHEET - EXHIBIT "B"
	<small>STANDARD SHEET NO. 2000</small> <small>THIS SHEET IS PART OF THE PROJECT PLAN</small>	<small>DATE 10-1-63</small> <small>BY KEM</small>	<small>DATE 10-1-63</small> <small>BY KEM</small>

APPENDIX A
SHEET 2 OF 3

A. 08-06-040 TASC/SPK

DATE	BY	REVISION
04	CC	000
TYPICAL SECTION TO SHOW THE LOCATION OF THE OVERHEAD STRUCTURE AND THE POSITION OF THE TRACKS.		
SHOW THE POSITION OF THE TRACKS AND THE POSITION OF THE OVERHEAD STRUCTURE.		
SHOW THE POSITION OF THE TRACKS AND THE POSITION OF THE OVERHEAD STRUCTURE.		



A. 88#06.040. TASC/INK

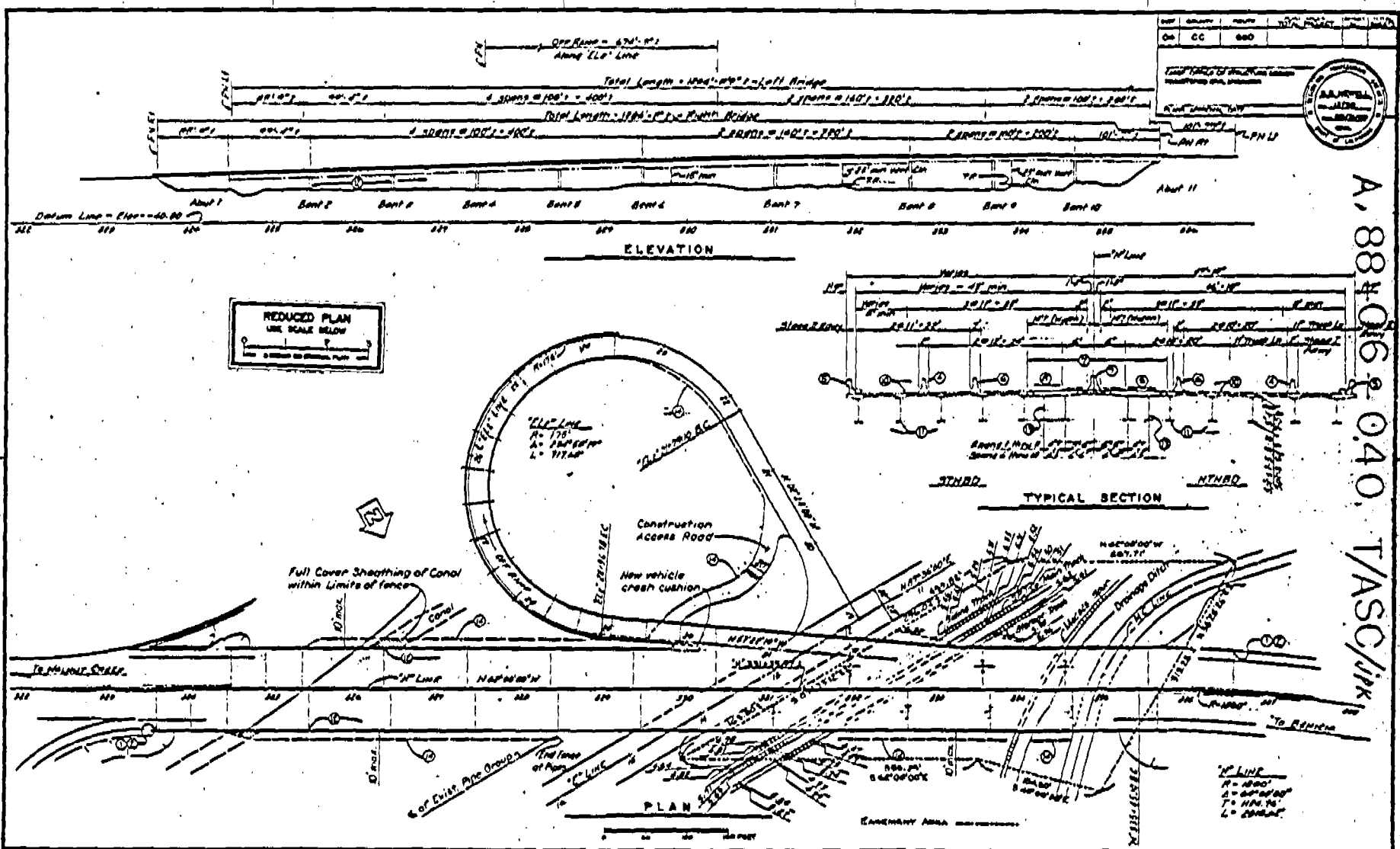

STATE OF CALIFORNIA DEPARTMENT OF TRANSPORTATION DIVISION OF HIGHWAYS	STRUCTURES - DESIGN 2 DRAWN BY: E.C.P.	SHEET NO. 28-171 PROJECT NO. 100	MOCOCO OVERHEAD (WIDEN) PUBLIC UTILITIES COMMISSION SHEET - EXHIBIT "B"
		CIVIL ENGINEER LICENSE NO. 10000	DATE: 1960

APPENDIX A
SHEET 3 OF 3