

ORIGINAL

Decision 89-01-032 JAN 27 1989

BEFORE THE PUBLIC UTILITIES COMMISSION OF THE STATE OF CALIFORNIA

In the Matter of the Application of the )  
County of Los Angeles for an order )  
authorizing the County to construct ) Application 88-10-004  
the bike path along the west levee ) (Filed October 3, 1988)  
of the Coyote Creek Flood Control Channel )  
under the Southern Pacific Transportation )  
Company West Santa Ana Branch Line at )  
approximate crossing BBL-503.21. )

O P I N I O N

As part of a project to construct Coyote Creek Bike Path (West Side) from Meyer Road to Centralia Street, total length 6 miles, the County of Los Angeles (County) requests authority to construct a Bike Path at separated grades on the west levee of Coyote Creek Flood Control Channel under the tracks of Southern Pacific Transportation Company's (SPT) West Santa Ana Branch Line at the conjunction of the boundaries of the City of Cypress (Orange County) and the Cities of Lakewood and Cerritos (Los Angeles County).

The proposed grade separation will provide an off-road commuting route from the southeast area of Los Angeles County to the Long Beach area and will connect to the existing San Gabriel River Bikeway extending from Long Beach Harbor to Santa Fe Dam.

County is the lead agency for this project under the California Environmental Quality Act of 1970 (CEQA), as amended, Public Resources (PR) Code Sections 21000, et seq. County has determined that the project is categorically exempt from CEQA under Section 15304 (h) of the CEQA Guidelines (14 Cal. Admin. Code-Div. 6). Section 15304 applies to activities involving the minor alterations to land with subsection (h) being applicable to the creation of bicycle paths on existing rights-of-way.

The Commission is a responsible agency for this project under CEQA and has reviewed and considered the lead agency's categorical exemption determination.

The site of the proposed Bike Path Undercrossing has been inspected by the Commission's Traffic Engineering staff. After a review and analysis of future train traffic and bikeway geometrics of the area, the staff recommends that approval be granted to construct the bikeway crossing at separated grades.

City has met the filing requirements of the Commission's Rules of Practice and Procedure including Rule 38, which relates to the construction of public highways across railroad tracks.

Notice of the application and amendment were published in the Commission's Daily Calendar on October 6, 1988. No protests have been received. A public hearing is not necessary.

Findings of Fact

1. County requests authority under Public Utilities Code Sections 1201-1205 to construct the Coyote Creek Channel Bike Path Undercrossing at separated grades under the tracks of SPT's West Santa Ana Branch Line in Los Angeles County.

2. Construction of the Bike Path Undercrossing is required to provide an off-road commuting route for bicyclists providing access from the southeast area of Los Angeles County to the Long Beach area.

3. Public convenience and necessity require construction of the Bike Path Undercrossing at separated grades.

4. County is the lead agency for this project under CEQA, as amended.

5. The Commission is a responsible agency for this project and has reviewed and considered the lead agency's categorical exemption determination.

6. The project will not have a significant effect on the environment.

Conclusions of Law

1. The application should be granted as set forth in the following order.
2. The activity is not covered by the requirements set forth in CEQA and, therefore, the Guidelines (14 Cal. Admin. Code - Div. 6) concerning the evaluation of projects and the preparation and review of environmental documents do not apply.

O R D E R

IT IS ORDERED that:

1. The County of Los Angeles (County) is authorized to construct a Bike Path crossing at separated grades under the tracks of the Southern Pacific Transportation Company's (SPT) West Santa Ana Branch Line in Los Angeles County, at the location and substantially as shown on plans attached to the application and Appendix A of this order, to be identified as Crossing B-503.21-BD.
2. Clearances shall conform to GO 26-D. Walkways shall conform to GO 118.
3. Construction and maintenance costs shall be borne in accordance with an agreement to be entered into between the parties. A copy of the agreement, together with plans approved by SPT, shall be filed with the Commission prior to commencing construction. Should the parties fail to agree, the Commission will apportion the costs of construction and maintenance by further order.
4. Within 30 days after completion of the work under this order, County shall notify the Commission in writing that the authorized work has been completed.
5. This authorization shall expire if not exercised within three years unless time is extended or if the above conditions are not complied with. Authorization may be revoked or modified if public convenience, necessity, or safety so require.

6. The application is granted as set forth above.

This order becomes effective 30 days from today.

Dated JAN 27 1989, at San Francisco, California

G. MITCHELL WILK  
President  
FREDERICK R. DUDA  
STANLEY W. HULETT  
JOHN B. CHANIAN  
Commissioners

I CERTIFY THAT THIS DECISION  
WAS APPROVED BY THE ABOVE  
COMMISSIONERS TODAY.

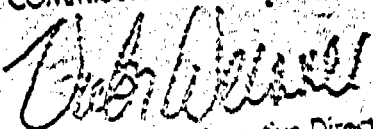
  
Victor Weisner, Executive Director

# COUNTY C DEPARTMENT

CASH C

COYOTE

MEYER

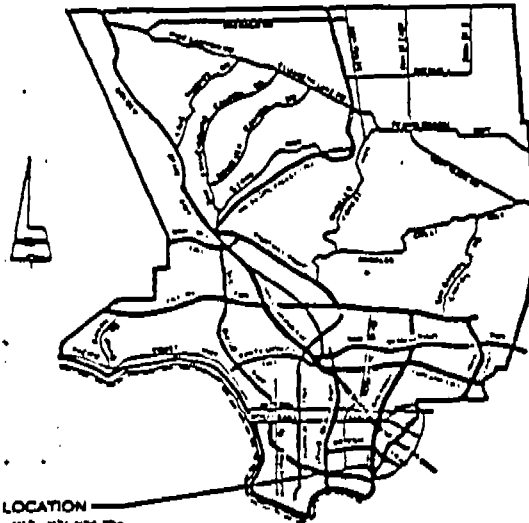

PROJECT LOCATION  
S.D. 144, 445 W.B. 124, 124, 124  
T.D. 61, 61, 61

VICINITY MAP

## CONVENTIONAL SYMBOLS FOR EXISTING TOPOGRAPHY

CURB  
CURB & GUTTER  
GUTTER  
PAVEMENT: CONCRETE  
ASPHALT  
WALK  
BARRICADE  
BUILDING  
DEAD MAN, GUY POLE  
FENCE  
FIRE HYDRANT  
MANHOLE  
PIPE  
POLE  
R.R. XING POST  
SIGN  
SIGNAL: CONTROL BOX  
FLASHING  
TRAFFIC  
LOOP  
STREET LIGHT  
TREES: PALM  
OTHER  
VALVE  
WALLS: BRICK/BLOCK  
CONCRETE  
STONE  
WELL OR VAULT  
WHEELCHAIR RAMP  
GUARDRAIL  
RAILROAD



PROJECT NUMBER: 144-445  
SHEET: 1  
DATE: 10/1/88  
BY: T/RRT/sc

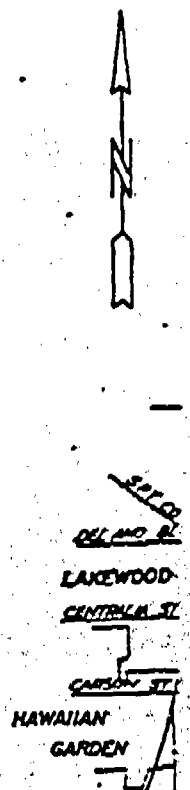

# CITY OF LOS ANGELES DEPARTMENT OF PUBLIC WORKS

ASH CONTRACT NO. 2340R

## COYOTE CREEK BIKE PATH (WEST SIDE)

MEYER ROAD TO CENTRALIA STREET

TOTAL LENGTH 6.0 MILES

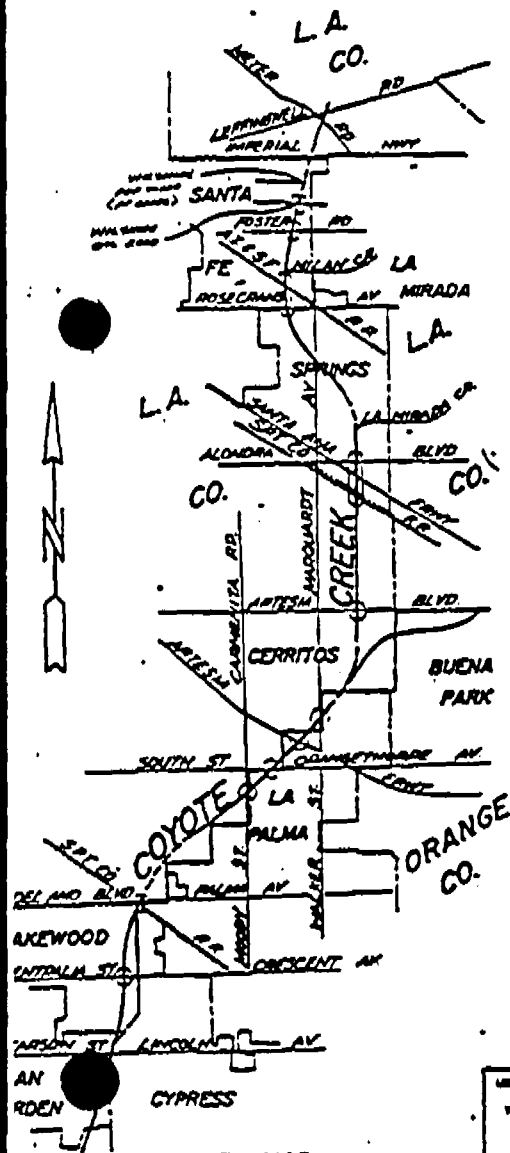

KEY MAP  
NO SCALE

LOS ANGELES COUNTY ROAD DEPARTMENT  
THE INFORMATION SHOWN HEREON IS  
**PRELIMINARY**  
MAY 19 1988  
SURVEYING AND DESIGN DIVISION

## INDEX

SHEET NO. 1 TITLE SHEET  
SHEET NO.  
SHEET NO.

## CONSTRUCTION LEGEND

ITEMS UNDERLINED TO BE CONSTRUCTED

- ① PORTLAND CEMENT CONCRETE CURB AND GUTTER
- ② PORTLAND CEMENT CONCRETE CURB
- ③ ASPHALT CONCRETE CURB
- ④ PORTLAND CEMENT CONCRETE GUTTER
- ⑤ 4" PORTLAND CEMENT CONCRETE SIDEWALK
- ⑥ 6" PORTLAND CEMENT CONCRETE SIDEWALK
- ⑦ 6" REINFORCED PCC (PLAY WORK) PER SECT. A-A, SMT. 2.
- ⑧ ASPHALT CONCRETE PAVEMENT
- ⑨ ASPHALT CONCRETE PAVEMENT ON BASE MATERIAL
- ⑩ ASPHALT CONCRETE PAVEMENT VARIABLE THICKNESS
- ⑪ REINFORCING FABRIC FOR ASPHALT CONCRETE PAVEMENT
- ⑫ SLURRY SEAL
- ⑬ COLD-MILL ASPHALT CONCRETE PAVEMENT
- ⑭ DRIVEWAY
- ⑮ ALLEY INTERSECTION
- ⑯ CROSS GUTTER
- ⑰ RETAINING STRUCTURE
- ⑱ DRAINAGE SYSTEM AS SHOWN ON SHEET INDICATED
- ⑲ HOUSE WALK AND/OR STEPS AS SHOWN ON HOUSE WALK
- ⑳ WHEELCHAIR RAMP
- ㉑ 6" REINFORCED PCC (SLOPE WORK) PER SECTION A-A, SMT. 2
- ㉒ BIKE PATH ACCESS LOCATION PER DETAIL ON SMT. 3
- ㉓ MOTORCYCLE BARRIER WITH CROSS BAR PER DET. ON SMT.
- ㉔ STD CHAIN LINK FENCE OR GATE, 10' HIGH AS SHOWN ON
- ㉕ NO GATE, POST, CLIP OR GATE

APPROVED	BY [Signature]	DATE [Date]	APPROVED	BY [Signature]	DATE [Date]
APPROVED	BY [Signature]	DATE [Date]	APPROVED	BY [Signature]	DATE [Date]
APPROVED	BY [Signature]	DATE [Date]	APPROVED	BY [Signature]	DATE [Date]
APPROVED	BY [Signature]	DATE [Date]	APPROVED	BY [Signature]	DATE [Date]
PROJECT NAME			PROJECT NUMBER		
COYOTE CREEK			2340R		

FORBIDI

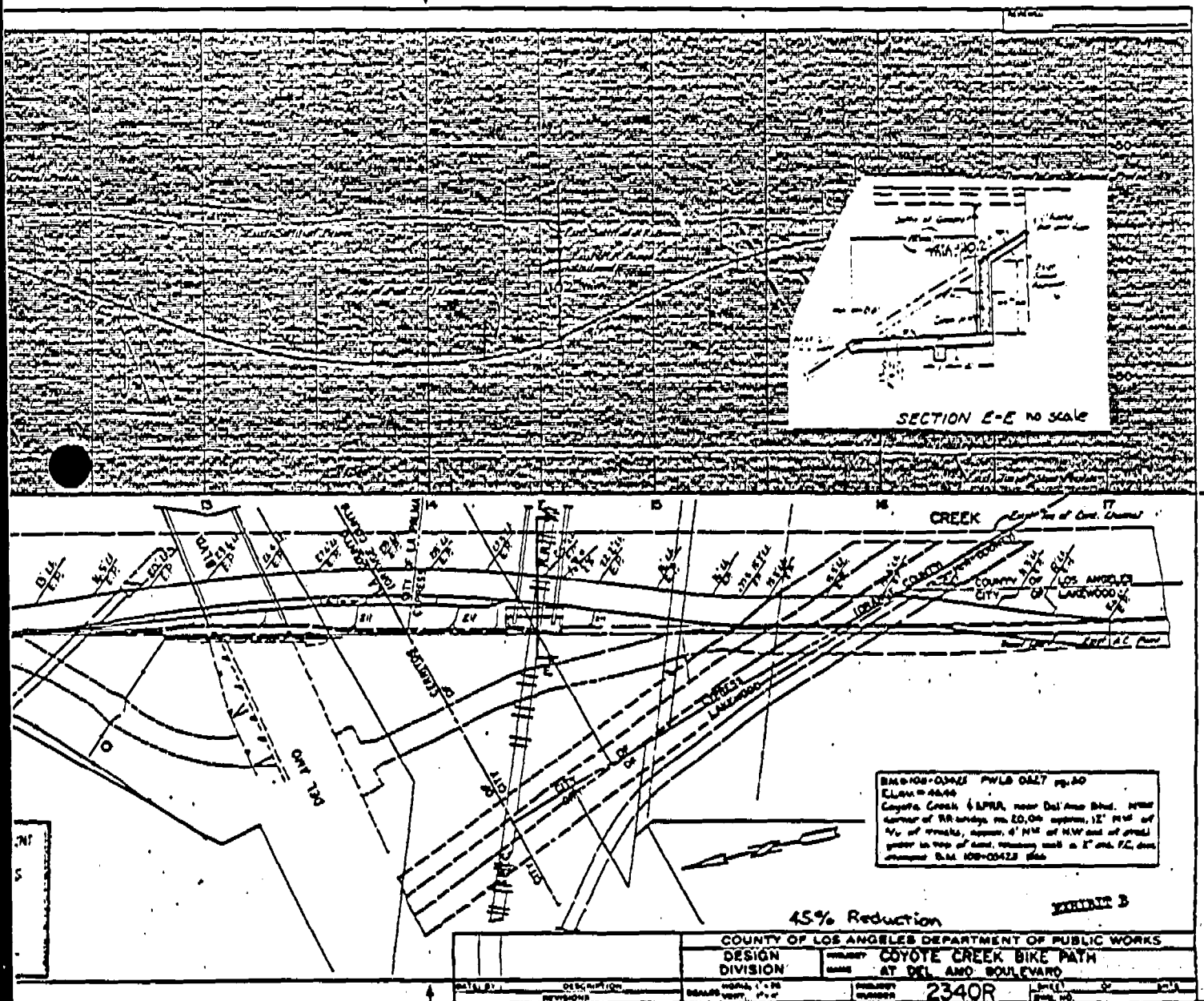

ORIGINAL

Decision 89 01 032

JAN 27 1989

BEFORE THE PUBLIC UTILITIES COMMISSION OF THE STATE OF CALIFORNIA

In the Matter of the Application of the  
County of Los Angeles for an order  
authorizing the County to construct  
the bike path along the west levee  
of the Coyote Creek Flood Control Channel  
under the Southern Pacific Transportation Company  
West Santa Ana Branch Line at  
approximate crossing BBL-503.21.

)  
)  
) Application 88-10-004  
) (Filed October 3, 1988)  
)  
)  
)

OPINION

As part of a project to construct Coyote Creek Bike Path (West Side) from Meyer Road to Centralia Street, total length 6 miles, the County of Los Angeles (County) requests authority to construct a Bike Path at separated grades on the west levee of Coyote Creek Flood Control Channel under the tracks of Southern Pacific Transportation Company's (SPT) West Santa Ana Branch Line at the conjunction of the boundaries of the City of Cypress (Orange County) and the Cities of Lakewood and Cerritos (Los Angeles County).

The proposed grade separation will provide an off-road commuting route from the southeast area of Los Angeles County to the Long Beach area and will connect to the existing San Gabriel River Bikeway extending from Long Beach Harbor to Santa Fe Dam.

County is the lead agency for this project under the California Environmental Quality Act of 1970 (CEQA), as amended, Public Resources (PR) Code Sections 21000, et seq. County has determined that the project is categorically exempt from CEQA under Section 15304 (h) of the CEQA Guidelines (14 Cal. Admin. Code-Div. 6). Section 15304 applies to activities involving the minor alterations to land with subsection (h) being applicable to the creation of bicycle paths on existing rights-of-way.