

Mailed

DEC 4 1991

Decision 91-12-005 December 4, 1991

BEFORE THE PUBLIC UTILITIES COMMISSION OF THE STATE OF CALIFORNIA (PUC)

In the Matter of the Application of SOUTHERN CALIFORNIA EDISON COMPANY (U338-E), a corporation and SAN DIEGO GAS & ELECTRIC COMPANY (U902-E), a corporation, for Certificate of Public Convenience and Necessity to Exercise their Rights, Privileges and Franchise granted to Applicants by Ordinance No. 543 and Ordinance No. 1713 of the County of Orange, State of California, to Construct, Operate, Alter, Maintain and Use an Electric Distribution and Transmission System within said County.

ORIGINAL

Application 3020804 (Petition for Modification filed October 10, 1990)

OPINION

By a series of decisions,¹ Southern California Edison Company (Edison) and San Diego Gas & Electric Company (SDG&E), jointly referred to as petitioners, have been authorized from time to time to realign their common boundary. By this petition for modification, petitioners seek a further realignment of their boundary in Orange County. Edison furnishes electric service to customers generally throughout Orange County, except in the southwestern portion where SDG&E furnishes electric service to its customers.

1 Joint petition to modify Decision No. 44086 dated April 25, 1950, as amended by Decision No. 67000, dated March 31, 1964, by Decision No. 69425, dated July 27, 1965, by Decision No. 69688, dated September 21, 1965, by Decision No. 78435, dated March 16, 1971, by Decision No. 88991, dated June 27, 1978, and by Decision No. 83-12-012, dated December 7, 1983.

O R D E R

IT IS ORDERED that:

1. Southern California Edison Company and San Diego Gas and Electric Company (petitioners) are authorized to exchange portions of their service territories as set forth in the legal description and maps attached as Appendix A.

2. Petitioners shall file amended service territory maps within 30 days of the date of this order.

This order is effective today.

Dated December 4, 1991, at San Francisco, California.

PATRICIA M. ECKERT
President
JOHN B. OHANIAN
DANIEL Wm. FESSLER
NORMAN D. SHUMWAY
Commissioners

I CERTIFY THAT THIS DECISION
WAS APPROVED BY THE ABOVE
COMMISSIONERS TODAY

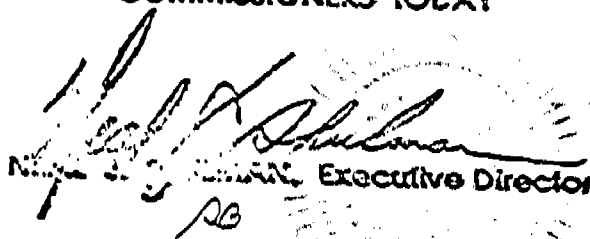
Norman D. Shumway, Executive Director

APPENDIX A

Page 1

DESCRIPTION OF SERVICE TERRITORY BOUNDARY LINE BETWEEN
SAN DIEGO GAS & ELECTRIC COMPANY AND SOUTHERN CALIFORNIA EDISON COMPANY.

Description of boundary line between the respective electric service areas of San Diego Gas & Electric Company and Southern California Edison Company in the County of Orange, State of California, extending from the intersection of the Mean High Tide Line of the Pacific Ocean with the South line of Fractional Section 31, Township 7 South, Range 8 West, San Bernardino Base and Meridian, to a point of intersection with the South line of Section 36, Township 6 South, Range 6 West, San Bernardino Base and Meridian, with the Westerly boundary line of the County of Riverside, State of California, described as follows:

Beginning at a point in the South line of Fractional Section 31, Township 7 South, Range 8 West, San Bernardino Base and Meridian, in said County, said point being at the intersection thereof with the Mean High Tide Line of the Pacific Ocean; thence South $89^{\circ} 25' 45''$ East, along the South line of said Section 31, and along the South line of Section 32 to the Southeast corner of Lot 175 of tract No. 8292 as per map recorded in Book 351, pages 39 to 48, inclusive, of Miscellaneous Maps in the office of the County Recorder of said Orange County; thence North $22^{\circ} 39' 35''$ East along the West line of Lot 175 and Lot "J" of said Tract No. 8292 a distance of 835.18 feet to the Northwest corner of Lot "J" of said Tract No. 8292; thence East along the North line of Lot "J" of said Tract No. 8292 a distance of 1994.38 feet; thence South $56^{\circ} 54' 04''$ East along the Northeast line of Lot "J" of said Tract No. 8292 a distance of 450.74 feet to its intersection with the Northerly corner of Tract No. 5732 as per map recorded in Book 319, page 24 of Miscellaneous Maps in the office of the County Recorder of said Orange County; thence South $56^{\circ} 54' 04''$ East, along the Northeasterly line of said Tract No. 5732 a distance of 1056.76 feet, more or less, to the South line of Section 33, Township 7 South, Range 8 West, S.B.B. & M.; thence South $89^{\circ} 25' 45''$ East along the South line of said Section 33 to a point of intersection with the center line of a public road known as Crown Valley Parkway, as granted to the County of Orange by an easement deed recorded May 24, 1963, in Book 6563, page 80 of Official Records of said Orange County, California, said last mentioned point of intersection being a point in a non-tangent curve concave Easterly and having a radius of 2000.00 feet, a radial line to said curve passing through said last mentioned point of intersection bears North $88^{\circ} 06' 27''$ West; thence Northerly and Northeasterly along said center line of said Crown Valley Parkway the following courses and distances: Northerly, along said curve, through a central angle of $08^{\circ} 25'$, an arc distance of 278.00 feet; thence tangent to a said curve, North $10^{\circ} 18' 33''$ East, a distance of 377.71 feet to the beginning of a tangent curve concave Westerly and having a radius of 2000.00 feet; thence Northerly along said curve, through a central angle of $16^{\circ} 46' 05''$, an arc distance of 585.32 feet; thence tangent to said last mentioned curve North $06^{\circ} 27' 32''$ West, a distance of 450.00 feet to the beginning of a tangent curve concave Easterly and having a radius of 1500.00 feet; thence Northerly along said curve, through a central angle of $33^{\circ} 13' 28''$, an arc distance of 869.81 feet; thence tangent to said curve North $26^{\circ} 45' 56''$ East, a distance of 473.69 feet to the beginning of a tangent curve concave Southeasterly and having a radius of 2000.00

feet; thence Northeasterly along said curve, through a central angle of $17^{\circ} 50'$, an arc distance of 622.50 feet; thence tangent to said curve North $44^{\circ} 35' 56''$ East, a distance of 1883.15 feet to the beginning of a tangent curve concave Southeasterly and having a radius of 2000.00 feet; thence Northeasterly along said curve, through a central angle of $13^{\circ} 54' 10''$, an arc distance of 485.30 feet to the beginning of a reverse curve concave Northwesterly and having a radius of 1800.00 feet; thence Northeasterly along said reverse curve, through a central angle of $26^{\circ} 57' 41''$, an arc distance of 847.02 feet; thence tangent to said curve North $31^{\circ} 32' 25''$ East, a distance of 90.00 feet to the beginning of a tangent curve concave Southeasterly and having a radius of 1800.00 feet; thence Northeasterly along said curve, through a central angle of $08^{\circ} 25''$, an arc distance of 260.00 feet, to a point in said last mentioned curve, a radial line of said curve passing through said point bears North $50^{\circ} 02' 35''$ West; thence leaving said center line of Crown Valley Parkway North $06^{\circ} 14' 45''$ East, a distance of 1540.00 feet; thence North $30^{\circ} 44' 45''$ East, a distance of 1610.00 feet to a T-Iron Post with $1'' \times 2''$ stake set as the Fairchild Aerial Survey Monument No. 45-F687 and being particularly described as Coordinate N. 501,902.00, E. 1,556,880.60 (per California State Plane Coordinate System Zone 6); thence North $02^{\circ} 35' 15''$ West, a distance of 810.00 feet; thence North $15^{\circ} 12' 45''$ East, a distance of 2170.00 feet; thence North $37^{\circ} 21' 15''$ West, a distance of 3540.00 feet, more or less, to a point in the South line of Parcel "D" of a map recorded in Book 11, page 49, of Parcel Maps, in the office of the County Recorder of said Orange County; thence Southeasterly and Easterly along the South line and its Northeasterly prolongation to the intersection with the West line of La Paz Road, 140 feet wide, as said road is shown on the map of Tract No. 6674, as per map recorded in Book 253, page 1 through 10 of Miscellaneous Maps, in the office of the County Recorder of said Orange County; thence Northerly along the West line of said La Paz Road, to the intersection with the South line of Aliso Creek Road, 140 feet wide, as shown on the map of said Tract No. 6674; thence Westerly along the South line of said Aliso Creek Road to the intersection with the East line of Section 21 in Township 7 South, Range 8 West, S.B.B. and M.; thence North $00^{\circ} 05' 15''$ West, along the East line of said Section 21, a distance of 140 feet, more or less, to a point in the North line of said Aliso Creek Road being also a point in the South line of Lot 5 of said Tract No. 6674; thence Westerly along the North line of said Aliso Creek Road to the intersection with the East line of Bettina Road, 84 feet wide, as shown on the map of said Tract No. 6674, being also the Westerly line of said Lot 5 of said Tract No. 6674; thence Northerly along said East line to the intersection with the Southeasterly line of El Lazo Road, 80 feet wide, as shown on the map of said Tract No. 6674, being also the Northwesterly line of Lot 5 of said Tract No. 6674; thence Northeasterly along the Southeasterly line of said El Lazo Road, being also the Northwesterly line of Lots 5 and 4 of said Tract No. 6674 to the intersection with the East line of Section 16 in township 7 South, Range 8 West, S.B.B. and M.; thence North $00^{\circ} 05' 15''$ West along the East line of said Section 16, a distance of 135 feet, more or less, to a point in the Northwesterly line of said El Lazo Road, being also a point in the Southeasterly line of Lot 1 of said Tract No. 6674; thence Northeasterly and Northerly along said Westerly line of said El Lazo Road to the intersection with the Southerly line of Avila Road, 100 feet wide, as said road is shown on said map of Tract No. 6674; thence Southwesterly

along the Southerly line of said Avila Road to a point of intersection with the East line of Section 16, Township 7 South, Range 8 West, S.B.B. and M.; thence North $00^{\circ} 05' 15''$ West, along the East line of said Section 16, to a point of intersection with the centerline of Oso Parkway as said centerline is shown on map of Tract No. 11407, recorded in Book 492, pages 14 through 20, inclusive, of Miscellaneous Maps in the office of the County Recorder of said Orange County and on the Map of Tract No. 11408 as per map recorded in Book 493, pages 6 through 11, inclusive, of Miscellaneous Maps, in the office of the County Recorder of said Orange County; thence along said centerline of Oso Parkway North $58^{\circ} 29' 38''$ West, a distance of 894.02 feet to the beginning of a tangent curve in said centerline of Oso Parkway, concave Southwesterly having a radius of 1800.00 feet; thence Northwesterly along said curve through a central angle of $02^{\circ} 48' 39''$ an arc distance of 88.31 feet, to the intersection with the centerline of Alicia Parkway as shown on said map of Tract No. 11406, a curve concave Southeasterly having a radius of 2100.00 feet, a radial line of said last mentioned curve passing through said point of intersection bears North $68^{\circ} 06' 45''$ West; thence along said centerline of Alicia Parkway, Northeasterly along said curve through a central angle of $11^{\circ} 21' 45''$ an arc distance of 416.46 feet; thence continuing along said centerline of Alicia Parkway North $33^{\circ} 15' 00''$ East, a distance of 399.75 feet to the beginning of a curve concave Northwesterly having a radius of 2100.00 feet; thence along said centerline of Alicia Parkway, Northeasterly along said curve through a central angle of $13^{\circ} 58' 00''$ an arc distance of 511.90 feet; thence continuing along said centerline of Alicia Parkway and along the proposed centerline of Alicia Parkway North $19^{\circ} 17' 00''$ East, a distance of 393.27 feet to the beginning of a curve concave Southeasterly having a radius of 2100.00 feet; thence along said proposed centerline of Alicia Parkway, Northeasterly along said curve through a central angle of $15^{\circ} 35' 00''$ an arc distance of 571.16 feet; thence continuing along said proposed centerline of Alicia Parkway North $34^{\circ} 52' 00''$ East, a distance of 451.10 feet to the beginning of a curve concave Northwesterly having a radius of 2100.00 feet; thence along said proposed centerline of Alicia Parkway, Northeasterly along said curve through a central angle of $09^{\circ} 58' 00''$ an arc distance of 365.30 feet; thence continuing along said proposed centerline of Alicia Parkway North $24^{\circ} 54' 00''$ East, a distance of 1201.29 feet to the beginning of a curve concave Southeasterly having a radius of 2100.00 feet; thence along said proposed centerline of Alicia Parkway Northeasterly along said curve through a central angle of $07^{\circ} 58' 07''$ an arc distance of 292.06 feet; thence along said proposed centerline of Alicia Parkway North $32^{\circ} 52' 07''$ East, a distance of 446.50 feet to the intersection with the centerline of Moulton Parkway, as said centerline is shown on the map of Record of Survey 80-1110 as per map recorded in Book 102, page 8 of Records of Survey in the office of the County Recorder of said Orange County; thence along said centerline of Moulton Parkway North $42^{\circ} 14' 32''$ West, a distance of 835.42 feet to the beginning of a curve concave Northeasterly having a radius of 2100.00 feet; said curve being in the new centerline of Moulton Parkway as shown on map of Tract No. 11392, as per map recorded in Book 497, pages 25 through 31 inclusive, of Miscellaneous Maps, in the office of the County Recorder of said Orange County; thence along said new centerline of Moulton parkway Northwesterly along said curve through a central angle of $13^{\circ} 59' 45''$ an arc distance of 512.97 feet; thence continuing along said new centerline of Moulton

APPENDIX A

Page 4

Parkway North $28^{\circ} 14' 47''$ West, a distance of 2112.27 feet to the intersection with the centerline of Sheep Hills Road as shown on said map of Tract No. 11392, being a curve concave Southeasterly having a radius of 1600.00 feet, a radial line of said last mentioned curve passing through said point of intersection bears North $34^{\circ} 51' 46''$ West; thence along said centerline of Sheep Hills Road Northeasterly along said curve through an angle of $28^{\circ} 21' 22''$ an arc distance of 791.85 feet; thence continuing along said centerline of Sheep Hills Road as shown on said map of Tract No. 11392 and on map of Tract No. 11390 as per map recorded in Book 497, pages 34 through 37 inclusive, of Miscellaneous Maps, in the office of the County Recorder of said Orange County, North $83^{\circ} 29' 36''$ East, a distance of 488.28 feet to the beginning of a curve concave Northerly having a radius of 1600.00 feet; thence along said centerline of Sheep Hills Road Northeasterly along said curve through a central angle of $24^{\circ} 05' 03''$ an arc distance of 672.56 feet; thence continuing along said centerline of Sheep Hills Road North $59^{\circ} 24' 33''$ East, a distance of 43.02 feet to the Northeasterly boundary line of said Tract No. 11390 and to the Southwesterly terminus of that certain course in the South line of the parcel of land described and designated as Parcel 3 in the deed to Rossmoor Leisure World, a corporation, recorded December 4, 1961, in Book 5931, page 586 of Official Records in the office of the County Recorder of said Orange County, said certain course is described in said deed as having a bearing and length of North $58^{\circ} 39' 25''$ East, 1750.20 feet

to the point of intersection with the center line of Paseo de Valencia as shown on the map of Tract No. 7864 recorded in Book 338, pages 13 to 18 inclusive, of Miscellaneous Maps in the office of the County Recorder of said Orange County; thence in a Southeasterly direction along the center line of Paseo de Valencia to the intersection with the Easterly line of Alicia Parkway as said parkway is shown on the map of Tract No. 8091 recorded in Book 325, pages 38 and 39 of Miscellaneous Maps in the office of the County Recorder of said Orange County; thence Northerly along the Easterly line of said Alicia Parkway and its Northerly prolongation to a point in that certain course in the Southwesterly line of the parcel of land described and designated as Parcel 1 in the deed to Rossmoor Leisure World, a corporation, recorded on December 4, 1961, in Book 5931, page 586, of Official Records, in the office of the County Recorder of said Orange County, State of California, said certain course is described in said deed as having a bearing of South $50^{\circ} 51' 03''$ East and a length of 822.89 feet; thence along the boundary line of said parcel 1, South $50^{\circ} 51' 03''$ East, 231.79 feet; thence leaving the Southwesterly line of said Parcel 1 South $55^{\circ} 51' 14''$ East, 200.75 feet; thence South $50^{\circ} 19' 54''$ East, 487.54 feet; thence South $74^{\circ} 27' 49''$ East, 178.24 feet; thence South $50^{\circ} 44' 36''$ East, 171.23 feet to a point in the Southwesterly line of said Parcel 1; thence South $63^{\circ} 32' 44''$ East, along said Southwesterly line, a distance of 339.60 feet; thence leaving said Southwesterly line North $89^{\circ} 30' 01''$ East, 111.20 feet; thence South $53^{\circ} 44' 41''$ East, 305.00 feet to a point in the Southwesterly line of said Parcel 1; thence South $64^{\circ} 51' 03''$ East along said Southwesterly line of Parcel 1, a distance of 1000.00 feet; thence leaving said Southwesterly line of Parcel 1 South $67^{\circ} 48' 42''$ East, 701.44 feet; thence South $62^{\circ} 42' 04''$ East, 200.06 feet; thence South $68^{\circ} 10' 49''$ East, 414.09 feet; thence South $63^{\circ} 23' 39''$ East, 461.18 feet; thence North $73^{\circ} 49' 26''$ East, 29.36 feet; thence South $63^{\circ} 23' 39''$ East, a distance of 57.13 feet, to a point

being 7.00 feet Southeasterly of the center line of a road known as La Paz Road, as shown on a map on file in the office of the County Road Department, Santa Ana, California; thence along a line concentric and/or parallel to said center line of La Paz Road, the following courses and distances: Northeasterly along the arc of a 1193.00 foot radius curve concave Southeasterly, a radial line of said curve passing through said point bears South 59° 30' 01" East, through a central angle of 59° 25' 31", a distance of 1237.34 feet; thence tangent to said curve, North 89° 55' 30" East, 448.00 feet to the beginning of a tangent curve concave Southwesterly and having a radius of 993.00 feet; thence Southeasterly along the arc of said curve through a central angle of 31° 48' 50", a distance of 551.37 feet; thence tangent to said curve, South 58° 15' 40" East, 365.00 feet to the beginning of a tangent curve concave Northeasterly and having a radius of 1007.00 feet; thence Southeasterly along the arc of said curve through a central angle of 16° 19' 40", a distance of 286.97 feet; thence tangent to said curve South 74° 35' 20" East, 550.00 feet to the beginning of a tangent curve concave Northerly and having a radius of 1007.00 feet; thence Easterly along the arc of said curve through a central angle of 24° 26' 20", a distance of 429.52 feet; thence tangent to said curve North 80° 58' 20" East, 174.00 feet to the beginning of a tangent curve concave Southerly and having a radius of 843.00 feet; thence Easterly along the arc of said curve through a central angle of 39° 19' 40", a distance of 578.63 feet; thence tangent to said curve South 59° 42' 00" East, 592.00 feet; thence North 30° 18' 00" East, 141.11 feet; thence North 60° 24' 02" East, 46.78 feet; thence North 81° 03' 33" East, 230.10 feet; thence North 61° 03' 47" East, 176.00 feet; thence North 10° 27' 04" East, 37.71 feet to the Southwesterly corner of Lot 16 of Tract No. 6546, as per map recorded in Book 248, page 1 of Miscellaneous Maps, in the office of the County Recorder of said Orange County; thence along the Southerly line of said Tract No. 6546, the following courses and distances: South 64° 31' 07" East, 112.91 feet; South 71° 53' 28" East, 138.45 feet; South 68° 34' 48" East, 66.29 feet and South 68° 04' 50" East, a distance of 54.00 feet to a point of intersection with a line which is parallel with and 7.00 feet Southeasterly of, measured at right angles from the Southeasterly line of said Tract No. 6546; thence Northeasterly along said parallel line a distance of 525 feet, more or less, to a point in the South line of Section 31, Township 6 South, Range 7 West, S.B.B. and M. as said Section 31 is shown on a Record of Survey Sectionizing Rancho Trabuco, made by McKesseeck and Bill, filed in Book 9, pages 15 through 22 inclusive of Record of Survey in the office of the County Recorder of said County of Orange; thence Easterly along said South line of Section 31 to the intersection of said South line with that certain boundary line of Lot 2 of Tract No. 8807 as per map recorded in Book 423, pages 43 to 50, inclusive, of Miscellaneous Maps in the office of the County Recorder of said Orange County shown on said map as having a bearing and length of North 50° 44' 00" East, 970.35 feet; thence Northeasterly along said boundary line to its Northeasterly terminus and being a point in the cul de sac of Oso Viejo as shown on said map of Tract No. 8807; thence Northerly, Easterly, and Southeasterly along said boundary line of Lot 2 and the Northeasterly line of said Oso Viejo to the intersection with the Southwesterly prolongation of the Northwesterly line of Lot C of Tract No. 9026 as per map recorded in Book 395, pages 16 to 19, inclusive, of Miscellaneous Maps in the office of the County Recorder of said Orange

County said Northwesterly line of Lot C also being in the boundary line of said Tract No. 9026; thence in a general Easterly and Northeasterly direction along said Southwesterly prolongation and along said boundary line of Tract No. 9026; to the Northwesterly corner of Lot 11 of said Tract No. 9026; thence Southeasterly along the Southwesterly lines of said Lot 11 and Lots 12 to 18, inclusive, all of said Tract No. 9026; thence continuing Southeasterly along the Southwesterly line of Lot 19 of said Tract No. 9026 and its Southeasterly prolongation to the intersection with the center line of Ruisenor, 56 feet wide, as shown on the map of Tract No. 9024 recorded in Book 389, pages 35 to 40, inclusive, of Miscellaneous Maps in the office of the County Recorder of said Orange County; thence Southwesterly along said center line of Ruisenor to the intersection with the center line of Los Caballos, 56 feet wide, as shown on said map of Tract No. 9024; thence Southeasterly along said center line of Los Caballos to the intersection with the center line of La Paz Road, 80 feet wide, said last mentioned center line also being the Southeasterly boundary line of said Tract No. 9024; thence Northeasterly along said center line of said La Paz Road to the most Easterly corner of said Tract No. 9024; thence continuing along the center line of proposed La Paz Road in a Northeasterly and Easterly direction 2692 feet, more or less, to the intersection with the center line of proposed O'Neill Road; thence Southwesterly along said last mentioned center line 1250 feet, more or less, to the intersection with the Southerly line of Section 32, Township 6 South, Range 7 West, San Bernardino Base and Meridian; thence Easterly along the South lines of Sections 32, 33, and 34 of said Township 6 South, Range 7 West, San Bernardino Base and Meridian to a point of intersection with the Westerly boundary line of the land delineated on Record of Survey Map filed in Book 9 at Page 25 and also shown as course 76 on Record of Survey Map No. 84-1136 filed August 6, 1984 filed in Book 108, Pages 25 through 29, both maps being filed as Records of Survey in the Office of the County Recorder of Orange County, California, said point of intersection which bears North 03°27'25" West (record North 04°10'31" West) 341.01 feet from the Southerly terminus of said course 76 (North 04°10'31" West per Record of Survey Map 9/25); thence from said point of intersection, continuing along the Southerly line of said Section 34, South 89° 16' 39" East, a distance of 1344.99 feet to the Southeast corner thereof; thence continuing South 89° 16' 39" East, along the Southerly line of Section 35, in said Township 6 South, Range 7 West, a distance of 91.30 feet; thence leaving said Southerly line of Section 35, South 23° 40' 00" West, 200.50 feet; thence South 61° 05' 00" East, 372.81 feet; thence South 86° 20' 00" East, 88.27 feet; thence North 89° 30' 00" East, 133.92 feet; thence South 56° 35' 00" East, 125.38 feet; thence South 75° 55' 00" East, 119.01 feet; thence South 47° 55' 26" East, 141.45 feet; thence South 39° 15' 00" East, 180.45 feet; thence South 49° 10' 00" East, 98.30 feet; thence North 88° 25' 00" East, 121.00 feet to a point of intersection with 1800 foot radius curve, concave Easterly, a radial line of said curve passing through said point of intersection bears South 88°25'00" West; thence Northerly along the arc of said curve, (being along the centerline of proposed Coza De Coza Drive) through a central angle of 17°05'00" a distance of 536.69 feet; thence tangent to said curve North 15°30'00" East, 413.63 feet to the beginning of a tangent 1800 foot radius curve concave Westerly; thence Northerly along the arc of said curve, through a central angle of 8°22'59" a distance of 263.36

feet to the Southwest corner of Lot "D" of Tract No. 12949 according to Map thereof filed December 17, 1987 as Instrument No. 87-696230 in Book 591 Pages 30 through 35 inclusive of miscellaneous maps, records of said Orange County, California; thence continuing along the arc of said 1800 foot radius curve (being also the Westerly line of said Lot "D") through a central angle of $1^{\circ}22'45''$ a distance of 43.33 feet to a point of intersection with the Westerly prolongation of the "Center Line" of Lot "C" (Lot "C" being shown as San Miguel, a private street, on said Tract Map No. 12949); thence South $84^{\circ}23'22''$ East, along said Westerly prolongation and said "Center Line" of Lot "C", 75.00 feet to the beginning of a tangent 396.00 foot radius curve, concave Southwesterly; thence Easterly and Southeasterly along the arc of said curve through a central angle of $43^{\circ}24'22''$ a distance of 300.00 feet to the beginning of a tangent reverse curve having a radius of 400.00 feet; thence Southeasterly and Easterly along the arc of said curve, through a central angle of $53^{\circ}52'00''$ a distance of 376.06 feet; thence tangent to said curve North $85^{\circ}09'00''$ East, 248.28 feet to the beginning of a tangent 400.00 foot radius curve, concave Southerly; thence Easterly along the arc of said curve through a central angle of $39^{\circ}25'38''$, a distance of 275.25 feet to the beginning of a reverse curve having a radius of 765.00 feet and concave Northerly; thence Easterly along the arc of said curve through a central angle of $35^{\circ}03'48''$ a distance of 468.16 feet to the beginning of another reverse curve having a radius of 600.00 feet and concave Southerly; thence Easterly along the arc of said curve through a central angle of $35^{\circ}24'10''$ a distance of 370.74 feet; thence tangent to said curve South $55^{\circ}05'00''$ East, along the "Center Line" of said Lot "C" and its Easterly prolongation a distance of 63.48 feet to a point of intersection with the "Center Line" of Lot "B" (Lot "B" being shown as Vista Del Verde, a private street, on said Tract Map No. 12949), said point of intersection being a point in the arc of a non-tangent curve having a radius of 1200.00 feet, concave Southeasterly, a radial line of said curve passing through said point of intersection bears North $54^{\circ}56'24''$ West, thence Northeasterly along the arc of said curve through a central angle of $05^{\circ}44'26''$ a distance of 120.23 feet to a point of intersection with the Southerly boundary line of Section 35 of said Township 6 South, Range 7 West, a radial line of last said curve passing through said point of intersection bears North $49^{\circ}11'59''$ West; thence leaving said "Center Line" of Lot "B" Easterly along the Southerly line of said Section 35 and Section 36 in Township 6 South, Range 7 West, San Bernardino Base and Meridian, to the Southeast corner of said last mentioned Section 36, being also a point in the West line of Section 31 in Township 6 South, Range 6 West, San Bernardino Base and Meridian; thence South along said West line of Section 31 to the Southwest corner of said last mentioned Section 31; thence Easterly along the South lines of Sections 31, 32, 33, 34, 35 and 36 in said Township 6 South, Range 6 West, San Bernardino Base and Meridian, to a point in the Common boundary line between the County of Orange and the County of Riverside as said boundary line passes through said last mentioned Section 36.

DATE: 10/1/50
 DRAWN BY: J. J. ...
 CHECKED BY: ...

SEE THE ...
 FOR THE ...
 DATE: 10/1/50



TERRITORY SERVED

NO SCALE

MAP 1-B

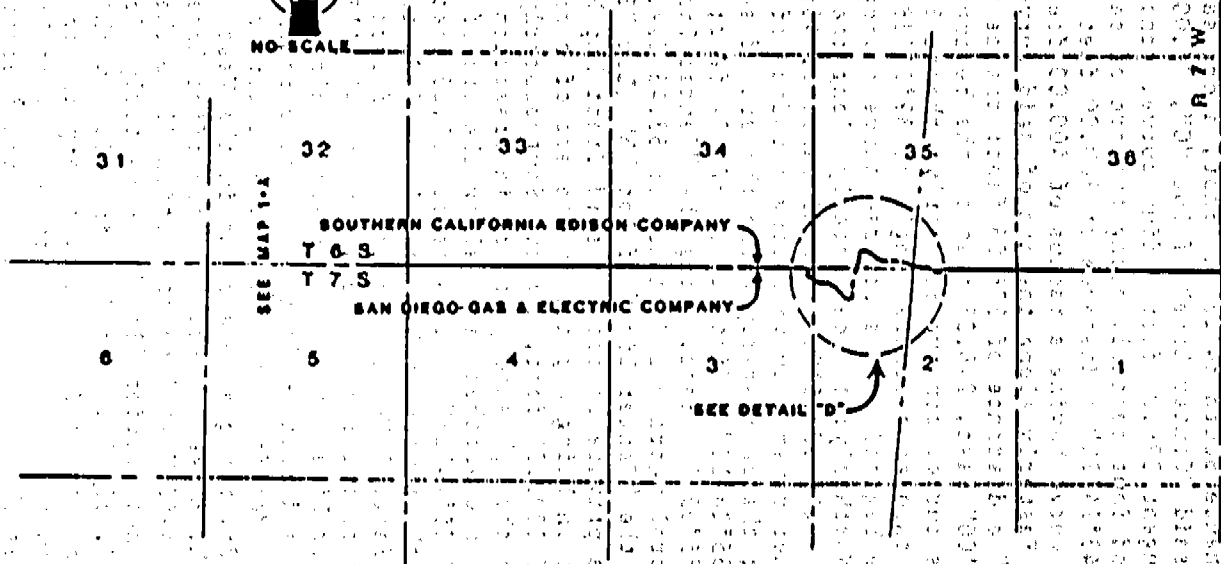

- (1) S 72° 50' 00" W 104.90'
- (2) S 67° 55' 00" W 100.00'
- (3) W 00° 00' 00" E 100.00'
- (4) S 65° 43' 41" E 137.98'
- (5) S 68° 00' 00" E 100.00'
- (6) S 47° 20' 00" E 194.96'
- (7) N 00° 25' 00" E 150.77'

SAN DIEGO GAS & ELECTRIC COMPANY		DATE: 10/1/50	
NO.	DESCRIPTION	DATE	BY

TERRITORY SERVED

MAP 1-A

SEE MAP 1-B

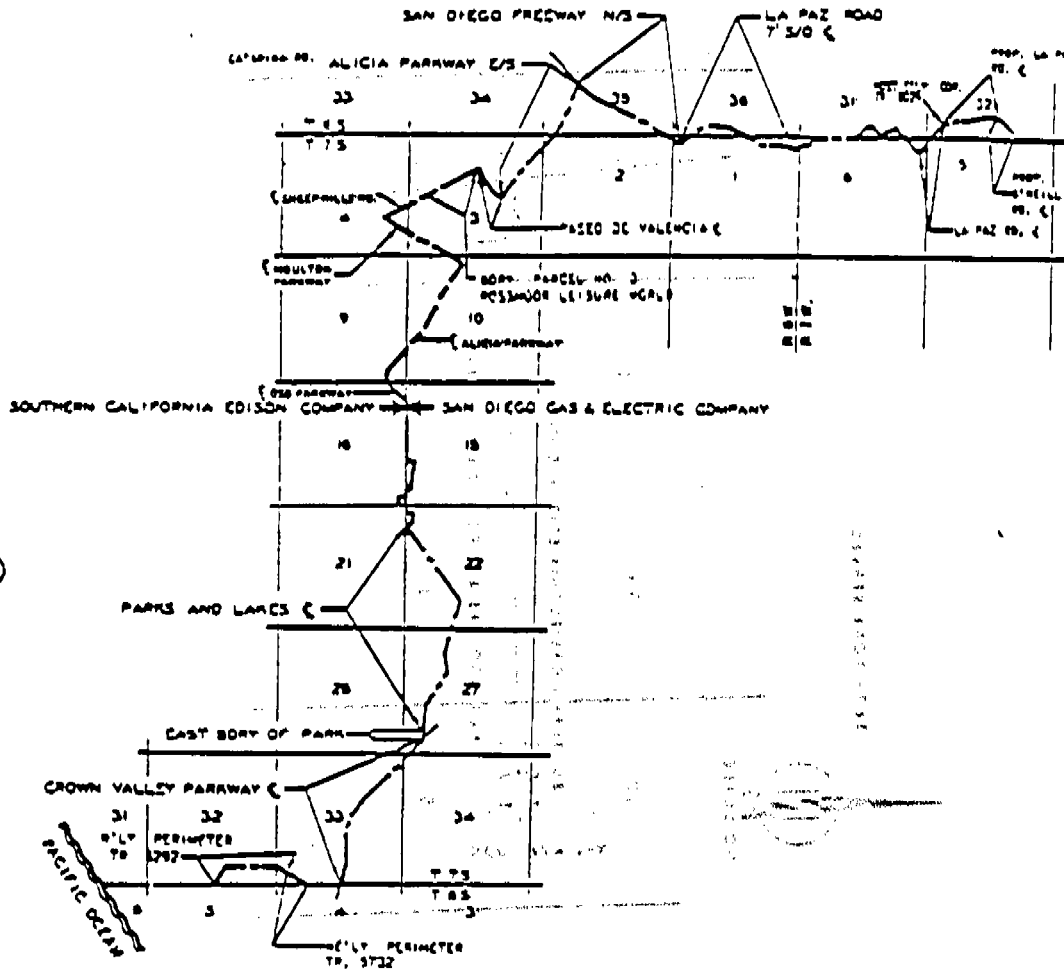

LEGEND
SERVICE AREA BOUNDARY

NOV 19 1968

SECTION 101-101
• • • • •
SECTION 2

SEE MAP 1-B

SEE MAP 1-B
SECTION 101-101
SECTION 2

A-1 QAM

TERRITORY SERVED

MAP 1-B



NO SCALE

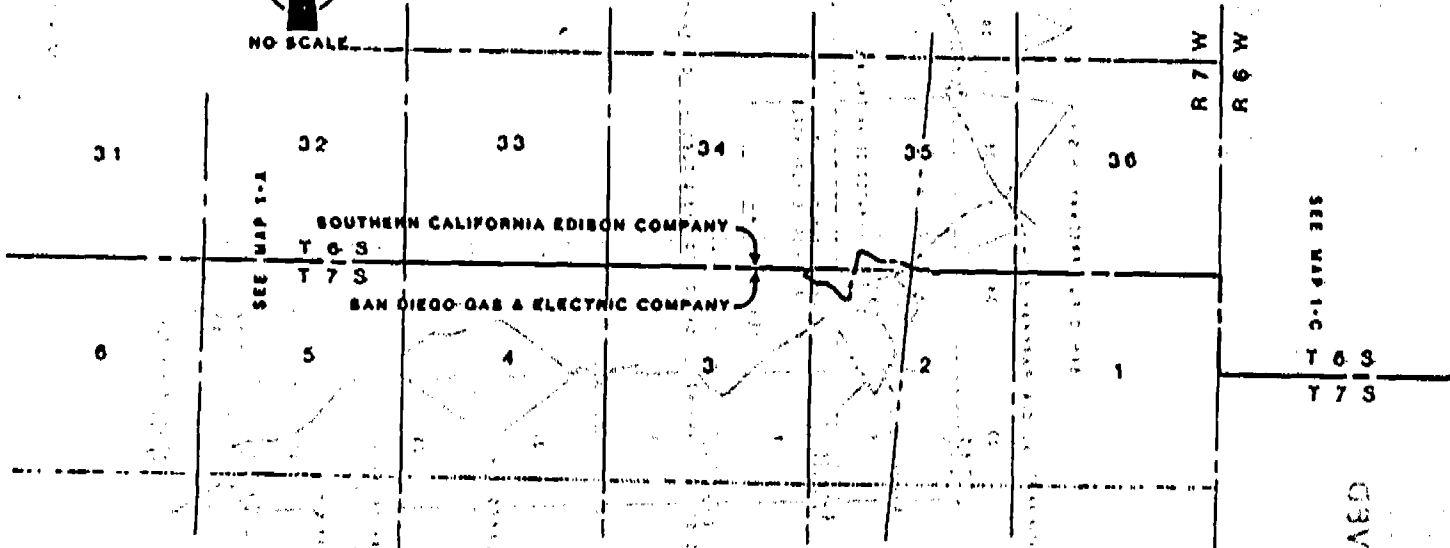

SEE MAP 1-C

SEE MAP 1-C

SERVICE AREA BOUNDARY

SECTION	OWNER	DATE
1	SAN DIEGO GAS & ELECTRIC COMPANY	1968
2	SAN DIEGO GAS & ELECTRIC COMPANY	1968
3	SAN DIEGO GAS & ELECTRIC COMPANY	1968
4	SAN DIEGO GAS & ELECTRIC COMPANY	1968
5	SAN DIEGO GAS & ELECTRIC COMPANY	1968
6	SAN DIEGO GAS & ELECTRIC COMPANY	1968
31	SAN DIEGO GAS & ELECTRIC COMPANY	1968
32	SAN DIEGO GAS & ELECTRIC COMPANY	1968
33	SAN DIEGO GAS & ELECTRIC COMPANY	1968
34	SAN DIEGO GAS & ELECTRIC COMPANY	1968
35	SAN DIEGO GAS & ELECTRIC COMPANY	1968
36	SAN DIEGO GAS & ELECTRIC COMPANY	1968

APPENDIX A
PAGE 10

A. 30208 /BDP/tog

901968 / 80502A

GRAPHIC INFORMATION
P.O. BOX 1000
SAN DIEGO 2

MAP INFORMATION
MAP NO. () AND DATE ()
DATE OF ISSUE ()

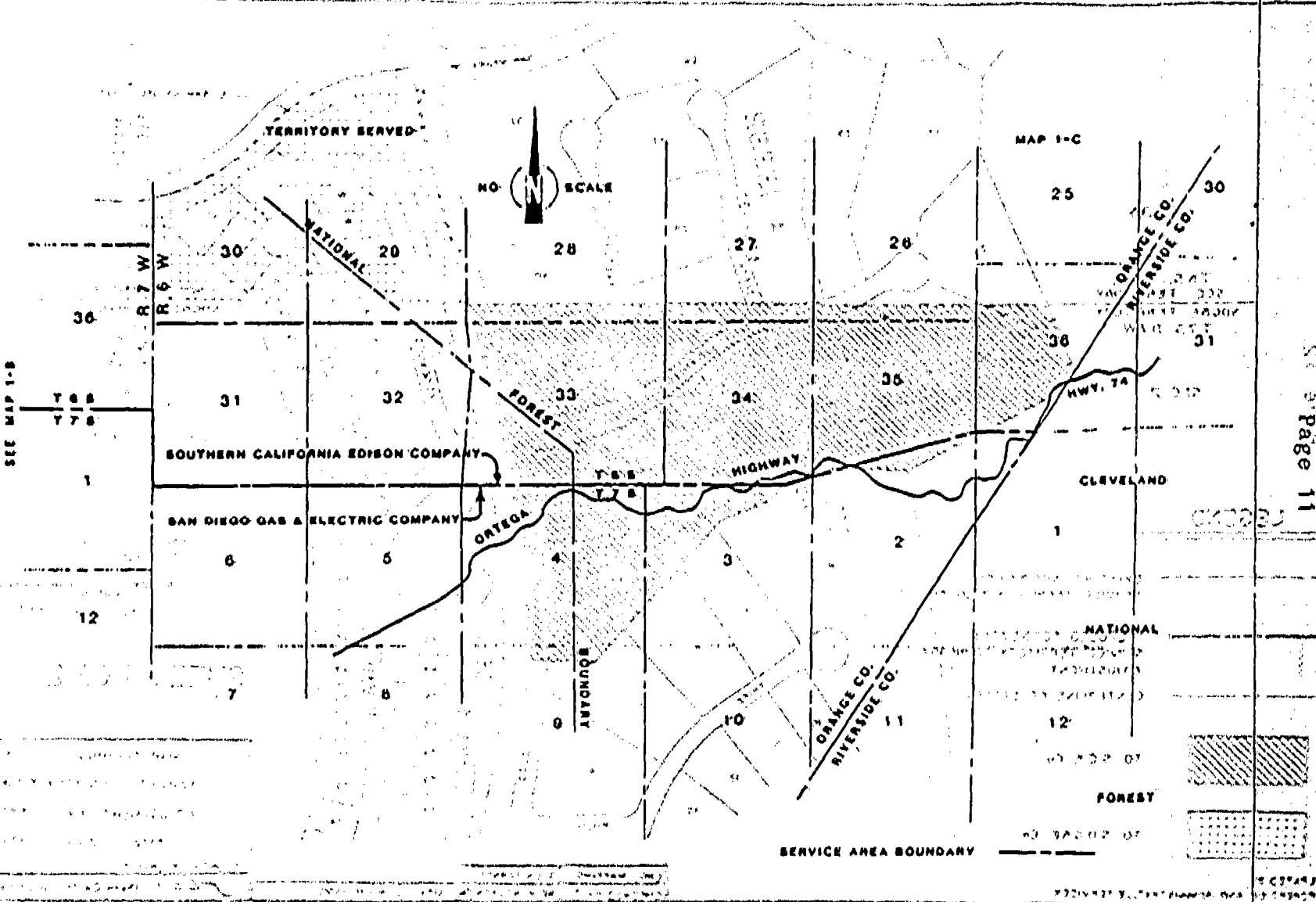

SEE MAP 1-B

APPENDIX A
Page 11

A. 30208 / BDP/tob

DATE	BY	REVISION	DESCRIPTION

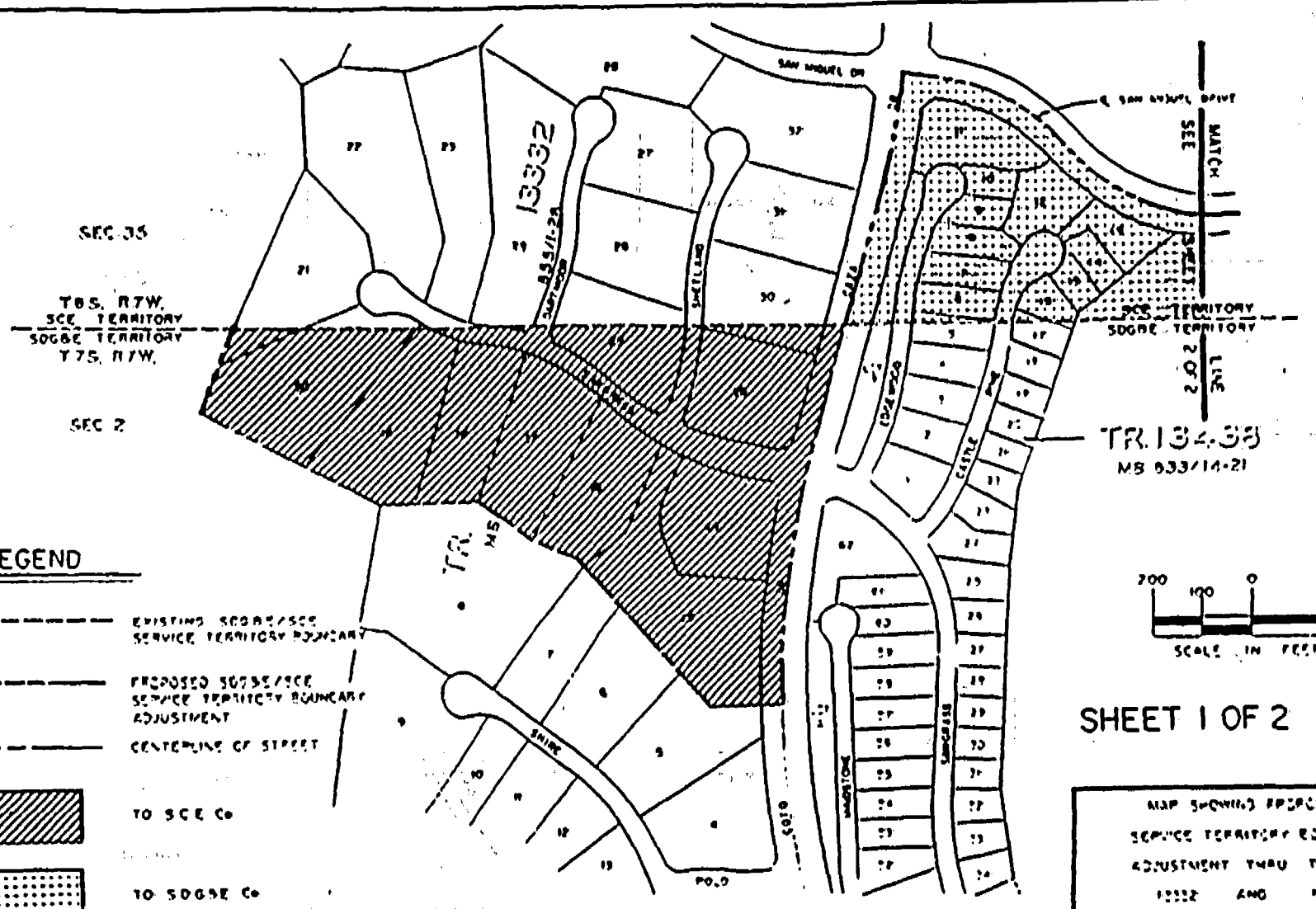





SEC 35

T8S, R7W,
SCE TERRITORY
SOGSE TERRITORY
T7S, R7W,

SEC 2

TR. 134-33
MS 833/14-21

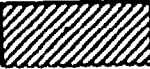
LEGEND

-  EXISTING SOGSE/SCE SERVICE TERRITORY BOUNDARY
-  PROPOSED SOGSE/SCE SERVICE TERRITORY BOUNDARY ADJUSTMENT
-  CENTERLINE OF STREET
-  TO SCE Co
-  TO SOGSE Co

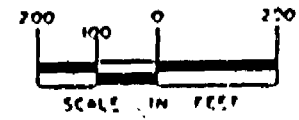

SHEET 1 OF 2

MAP SHOWING PROPOSED
SERVICE TERRITORY BOUNDARY
ADJUSTMENT THRU TRACTS
13332 AND 13433
COUNTY OF GRANT, CALIFORNIA
S. J. BROWN COMPANY ENGINEERS

MAP MADE BY CHUCK R. ...	DRAWN BY NEW ...	DATE A-11-1999
-----------------------------	---------------------	-------------------

MAP PREPARED BY
REAL ESTATE AND ADMINISTRATIVE SERVICES

A. JUKUO

A.30208

/BDP/tcb

APPENDIX A
Page 13

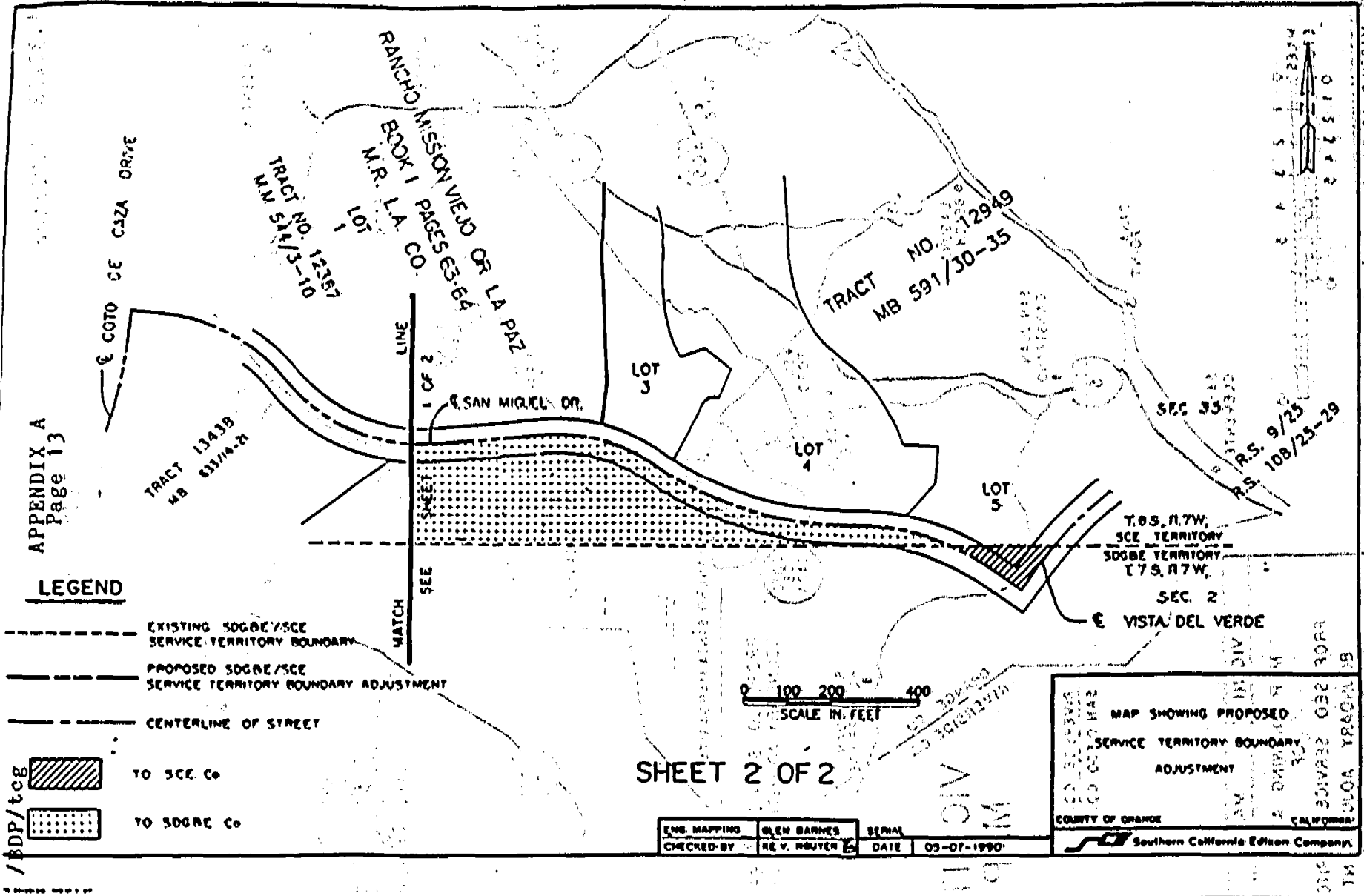

LEGEND

- - - - - EXISTING SOGRE/SCE SERVICE TERRITORY BOUNDARY
- - - - - PROPOSED SOGRE/SCE SERVICE TERRITORY BOUNDARY ADJUSTMENT
- - - - - CENTERLINE OF STREET

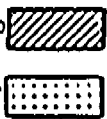

TO SCE Co.

TO SOGRE Co.

SHEET 2 OF 2

0 100 200 400
SCALE IN FEET

ENG. MAPPING	GLEN BARNES	SERIAL	
CHECKED BY	RE V. NGUYEN	DATE	05-07-1990

MAP SHOWING PROPOSED SERVICE TERRITORY BOUNDARY ADJUSTMENT

COUNTY OF ORANGE CALIFORNIA

Southern California Edison Company

RECORDING INFORMATION

DATE 05-07-1990

BOOK 108/25-29

PAGE 13

(END OF APPENDIX A)

1001908 1 80008.A
307 01
1002 01

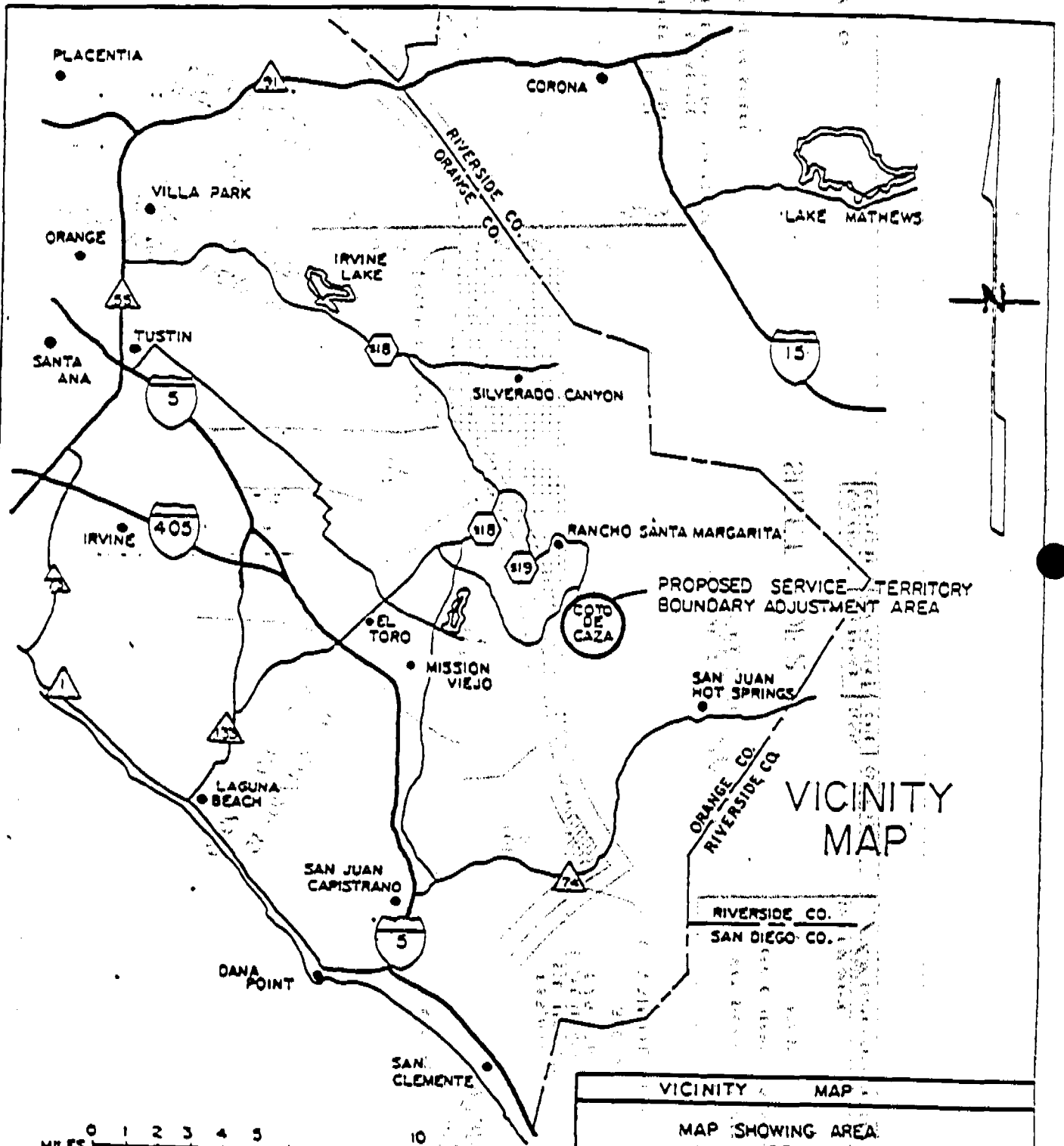

VICINITY
MAP

RIVERSIDE CO.
SAN DIEGO CO.

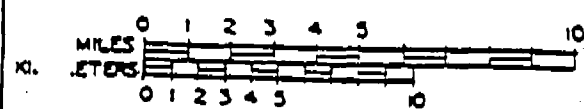

VICINITY MAP	
MAP SHOWING AREA OF PROPOSED SERVICE TERRITORY BOUNDARY ADJUSTMENT	
COUNTY OF ORANGE	CALIFORNIA
Southern California Edison Company	

ENG. MAPPING	GLEN K. BARNES	SERIAL	
CHECKED BY	KE V. NGUYEN	DATE	05-7-1990

(END OF APPENDIX A)

SEE APPENDIX A-10, 11, 12