

# GC Gas As-Build

## Job Estimate Face Sheet 30910059(G) - 07/30/12 09:07

<b>Project Name:</b>	[Redacted]	<b>Notification:</b>	105960178
<b>Address:</b>	[Redacted]	<b>Order Type:</b>	G060
<b>City/County:</b>	BERKELEY/Alameda	<b>PM Order Number:</b>	30910059
<b>Contact Name:</b>		<b>Status:</b>	In Progress
<b>Contact#:</b>		<b>MAT Code:</b>	50E
<b>Job Owner:</b>	[Redacted]	<b>MLX:</b>	
<b>Estimator:</b>	[Redacted]	<b>Prior MLX:</b>	None

**Job Story** PG&E to eliminate 4" Valve K-35, [Redacted]  
 GC GAS REMOVED 4" STL VALVE (K 35) AND REPLACED IT WITH 2" OF 4" STL PIPE.

<b>Permits</b>	<b>Agreements</b>	<b>Other Requirements</b>
<input checked="" type="checkbox"/> City-BERKELEY	<input type="checkbox"/> Right of Way-	<input type="checkbox"/> Strength Test PR5-
<input type="checkbox"/> County-	<input type="checkbox"/> JP Intent-	<input type="checkbox"/> Other-
<input type="checkbox"/> Highway-	<input type="checkbox"/> JT Intent-	
<input type="checkbox"/> Railroad-		

# GC Gas As-Build

### Job Labor Hours

Type	PG&E		PG&E Contractor		Applicant	
	On-Site	Travel	On-Site	Travel	On-Site	Travel
Elec	0	0	0	0	0	0
Gas	100	0	0	0	0	0
<b>Total</b>	<b>100</b>	<b>0</b>	<b>0</b>	<b>0</b>	<b>0</b>	<b>0</b>

### Financial Summary (\$)

PG&E Direct Cost	23102	Applicant Non-Rdf Work *	0
Applicant Direct Cost	0	Gross Financial Cost	25942
Overheads & Material Burden	2840	Joint Utility Credits	0
AFUDC	0	Applicant Cash Contribution *	0
Install Revolving Stock	0		
<b>Total Job Cost</b>	<b>25942</b>	<b>Job Net *</b>	<b>25942</b>

\* These amounts are not completed for jobs that are not in CCBS.

### Job Approval

Recommended: [Redacted] Associate Distribution Eng	[Redacted] Lan ID	/ / mm dd yy
Concurred: [Redacted] Estimating Supervisor	[Redacted] Lan ID	/ / mm dd yy
Authorized:	[Redacted] Lan ID	/ / mm dd yy

**PG&E Crew Instructions**  
**30910059(G) - 07/30/12 09:07**

**Location 1 Descr: -**

Location:	1	Install
Quantity		Description
<b>Cart: GC Review</b>		
1	Asm:	Single items added to cart
63		+OTHER CONTRACT SERVICE - Cut/Break
93		+OTHER CONTRACT SERVICE - Paving
252		+SOIL DISPOSAL
<b>Cart: Labor</b>		
1	Asm:	Single items added to cart
93		+Construction - Gas GC -
<b>Cart: Material</b>		
1	Asm:	Single items added to cart
4		+PIPE STEEL BARE 4 inch GS&S A-15 (01-1693) -
2		+NIPPLE SAVE-A-VLV 1" CI CAP WELD STL -
2		+STOPPER METAL PIPE LINE 4" WELD 250PSI -
1		+ADHESIVE LIQUID ONE QUART CONTAINER -
2		+TAPE PIPE CTG 2" COLD APPLIED 2"X50' RL -
2		+TAPE PIPE CTG 4" COLD APPLIED 4"X50' RL -
<b>Cart: Permits</b>		
1	Asm:	Permits and Fees
500		Permits - Permits and Fees
<b>Cart: Traffic Control</b>		
1	Asm:	Single items added to cart
2800		+TRAFFIC CONTROL/FLAGGING
150		+TRAFFIC CONTROL PLANS

**PG&E Materials  
 30910059(G) - 07/30/12 09:07**

**Long Lead Time Materials**

Quantity	Unit	M-Code	Description	Lead Time (wks)
----------	------	--------	-------------	--------------------

**Normal Lead Time Materials**

Quantity	Unit	M-Code	Description	Lead Time (wks)
4.00	FT	011693	PIPE STEEL BARE 4 inch GS&S A-15 (01-1693)	17
2.00	EA	022452	NIPPLE SAVE-A-VLV 1" CT CAP WELD STL	3
2.00	EA	022516	STOPPER METAL PIPE LINE 4" WELD 250PSI	3
2.00	RL	032603	TAPE PIPE CTG 4" COLD APPLIED 4"X50' RL	3
1.00	CO	130049	ADHESIVE LIQUID ONE QUART CONTAINER	3
2.00	RL	562320	TAPE PIPE CTG 2" COLD APPLIED 2"X50' RL	3

**Material Changes And Additions**

<b>Materials</b>	<b>Additions/Changes</b>
------------------	--------------------------

**Crew Foreman Sign-Off**  
**30910059(G) - 07/30/12 09:07**

**\*\*\*DRS Not Required For This Job\*\*\***

**\*\*\*DSC Not Required For This Job\*\*\***

**\*\*\*Ener/Press Not Required For This Job\*\*\***

**\*\*\*Unit Measure Not Required For This Job\*\*\***

**Construction Foreman Sign-Off (Check all that apply)**

Built as Designed

Redlined

Feedback Form completed N/A

***Plastic Pipe Data-Test at 100-110 PSI for a minimum of 5 minutes***

Size	Manufacturer	Date of Manufacture	Pressure	Duration	Initials
		N/A			

Redacted  
Redacted

**Foreman's Signature**

**Lan ID**

20 / 08 / 2012  
mm dd yy

**Operational Change Order  
30910059(G) - 07/30/12 09:07**

**WORK COMPLETED MUST BE REPORTED ON THE SAME DAY**

Map Number \_\_\_\_\_ (Estimator) CPA# \_\_\_\_\_

LOCATION City BERKELEY County Alameda

Date \_\_\_\_\_ From \_\_\_\_\_ (Job Foreman)

Phone \_\_\_\_\_ Fax \_\_\_\_\_ (Job Foreman)

JOB DESCRIPTION (Job Foreman)

\_\_\_\_\_  
\_\_\_\_\_  
\_\_\_\_\_

MAPPING: Name & Date Received \_\_\_\_\_

MAPPERS NOTE: Add this Change Notice to the job file when the job is completed

SKETCH (Job Foreman)





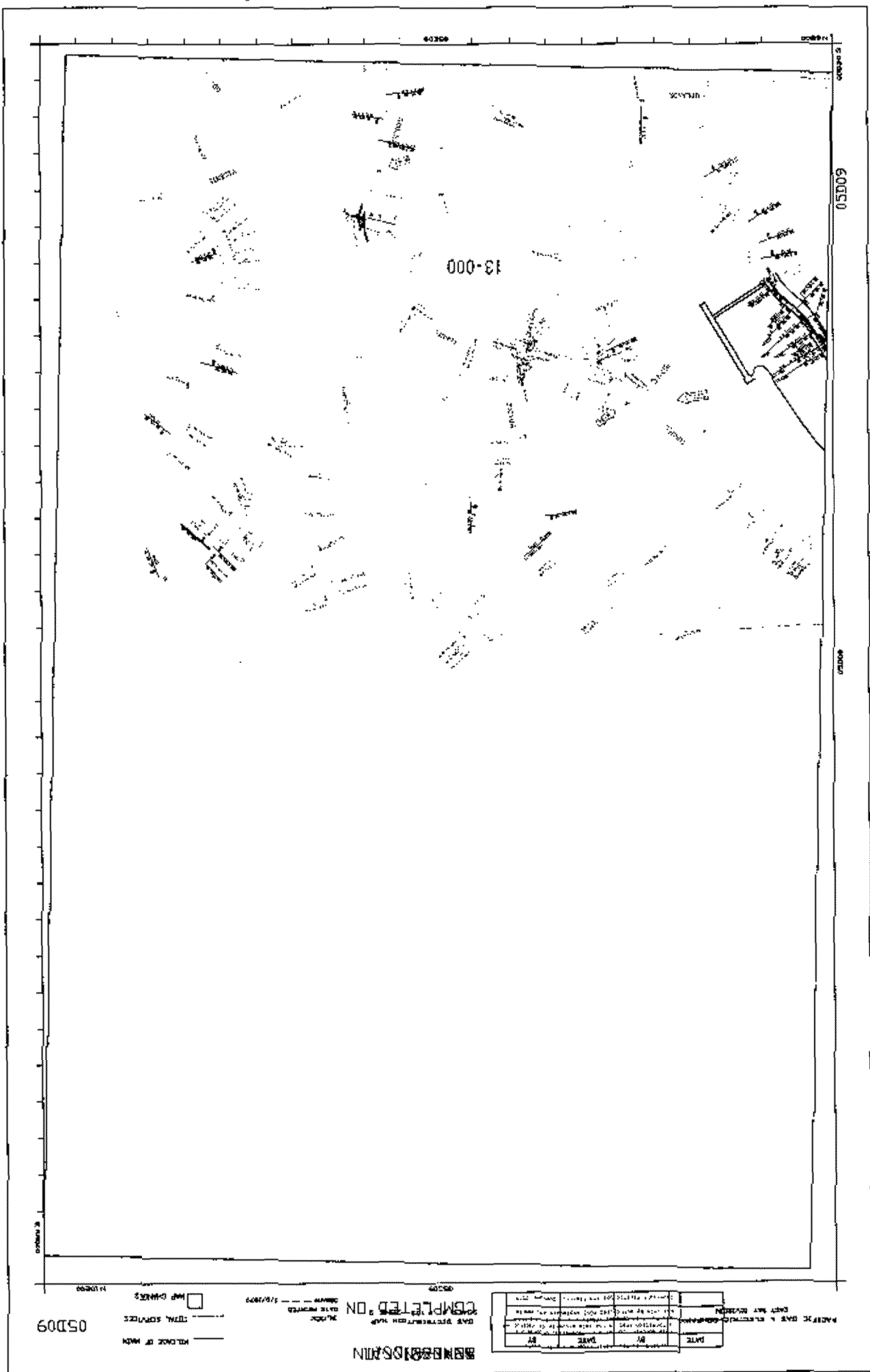



Form TD-9500P-01-F01

Revised 11/01/11

**GAS DISTRIBUTION OPERATING CHANGE NOTICE #1 (FINAL)**

Job Number: PM38910059 Map/Plat/Block: \_\_\_\_\_

Project Name/Location: Redacted

Date occurred in field: 10/08/2012 Date sent to Mapping: 10/08/2012

Detailed Description of Operational Change: \_\_\_\_\_  
REMOVED 4" STL VALVE #K-35, INSTALLED 2' OF 4" STL PIPE

**GC Gas As-Build**

Notice Prepared By (Print): Redacted Notice Prepared By (Signature): Redacted

LAN ID/Initials: Redacted Phone#: Redacted

---Detailed location sketch delineating reportable gas facility operating changes which have occurred---

Redacted

Posted By (Print Name): \_\_\_\_\_ Posted By (Signature): \_\_\_\_\_

LAN ID/Initials: \_\_\_\_\_ Date: \_\_\_\_\_ Plat(s): \_\_\_\_\_

(See Job Aid TD-9500P-01-JA01 for requirements and instructions for completing this form. Complete this form in non-erasable ink.)

GAS OPERATING CHANGE NOTICE #1  
SHEET 2 OF 2

4" VALVE  
IS NOT CRITICAL  
FOR OPERATION. RE-  
MOVE VALVE AND RE-  
PLACE WITH STRAIGHT  
PIPE. USE 4" GR  
B STEEL PIPE.

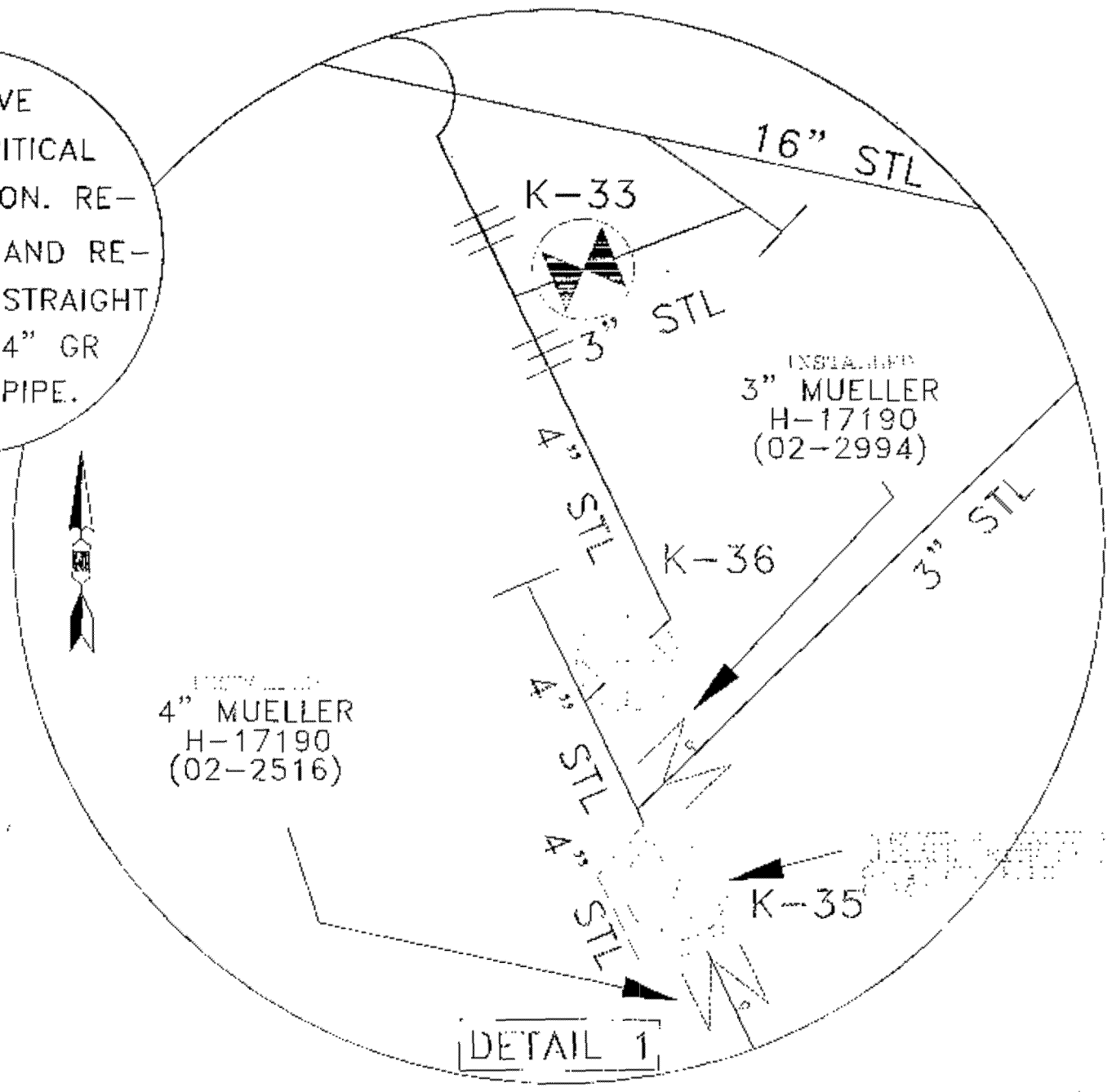

# Construction Feedback to Estimating and W&R

## Items Common to Gas & Electric (Please explain below and/or on back)

- Estimator contacted during construction.
- Job did not include design detail & documentation necessary to construct job.
- Special city/traffic requirements for working in the area not considered in estimate.
- Job not constructed as designed. Estimate: Redacted
- Work not included in Estimate.

### Materials Issues

- Missing: \_\_\_\_\_ Estimating Supervisor: Redacted
- Wrong: \_\_\_\_\_
- Quantity: \_\_\_\_\_
- Delivery: \_\_\_\_\_

### Site Issues

- Conditions: \_\_\_\_\_
- Access: \_\_\_\_\_
- Other: \_\_\_\_\_

### Labor Hours Differ from Estimate(hrs)

	Actual	vs	Est
<input type="checkbox"/> On site labor	_____		100
<input type="checkbox"/> Travel time	_____		0
<input type="checkbox"/> Multiple trips req'd	_____		N/A
<input type="checkbox"/> Traffic Control	_____		N/A
<input type="checkbox"/> Customer Notifications	_____		N/A
<input type="checkbox"/> W&R Additional Hours	_____		N/A

### Other Issues Impacting Labor Hours

	Impact(hrs)
<input type="checkbox"/> Emergency	_____
<input type="checkbox"/> Vehicle Availability	_____
<input type="checkbox"/> Equipment Failure	_____
<input type="checkbox"/> Other	_____
<input type="checkbox"/> Distribution maps incorrect	_____

Gas Issues	Impact(hrs)
<input type="checkbox"/> Existing facilities can't be located	_____
<input type="checkbox"/> Soil Conditions	_____
Coverage:	
<input type="checkbox"/> Shallow	_____
<input type="checkbox"/> Shoring Required	_____
<input type="checkbox"/> Hand digging	_____

Electric Issues	Impact(hrs)
<input type="checkbox"/> New equip causes infraction	_____
<input type="checkbox"/> Issues with clearances	_____
Existing Substructure:	
<input type="checkbox"/> Conduit not useable	_____
<input type="checkbox"/> Enclosure too small	_____
<input type="checkbox"/> Switching	_____

Please provide comments on the back side.

Your feedback is appreciated and will help improve our estimates and schedules. Thank you

Construction Supervisor Name \_\_\_\_\_

Lan ID \_\_\_\_\_

mm / dd / yy

Supervisor Name: \_\_\_\_\_

Lan ID \_\_\_\_\_

mm / dd / yy

ADE Name: Redacted

Lan ID \_\_\_\_\_

mm / dd / yy

Estimator Name: \_\_\_\_\_

Lan ID \_\_\_\_\_

mm / dd / yy