



Pacific Gas and
Electric Company®

705 "P" Street, Second Floor
Fresno, CA 93760

559.263.7400

February 2, 2014

John Lewis
AT&T Engineering Dept.
217 W. Acequia
Visalia, CA 93291

Subject: Class "H" Circuits on Both Sides of a Thoroughfare – Kamm Ave.,
Caruthers, CA

Dear Mr. Lewis:

PG&E is requesting to install a new overhead 12 kV line extension on the north side of Kamm Avenue, between our existing pole line at Blythe and Kamm Avenue to the intersection of Marks and Kamm, located southwest of Caruthers, CA. This circuit extension is needed to service existing and future electric demand. AT&T presently has overhead telecommunications cable on the South side of Kamm Avenue in the vicinity of PG&E's proposed project.

PG&E presently has an existing 12 kV distribution line on the south side of Kamm Avenue. CPUC General Order No. 95, Rule 31.3, does not allow utilities to occupy both sides of a thoroughfare unless there is mutual consent for such occupancy by all pole using operators having service areas or routes in the general vicinity of the length of the thoroughfare concerned.

Enclosed with this letter is a map showing existing facilities and the proposed 12 kV line extension on Kamm Avenue.

We would appreciate your company's concurrence on this occupancy, so that we may submit it to the Commission as required by G.O. 95. If you concur, please sign and return one copy of this letter to me ASAP. A self-addressed envelope is provided for your convenience.

If you have any questions concerning this matter, please call me at (559)263-7353.

Sincerely,

Abe Ortiz
Electric Distribution Engineer, Fresno Division

Concurrence: 

Date: 2/14/14

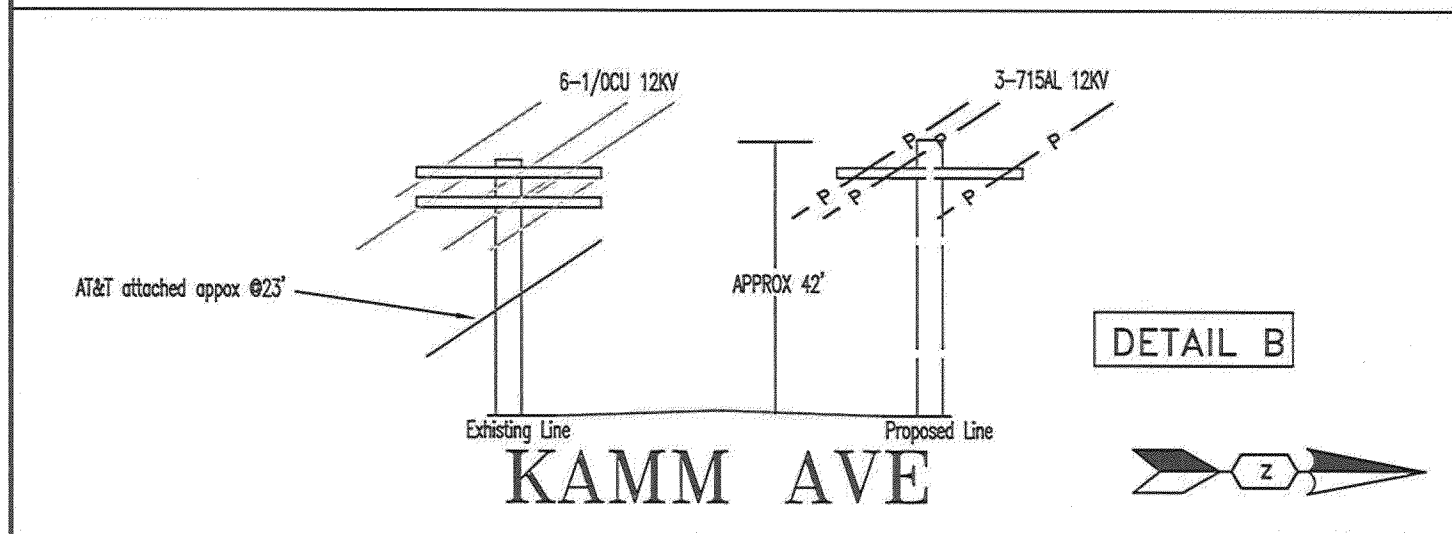
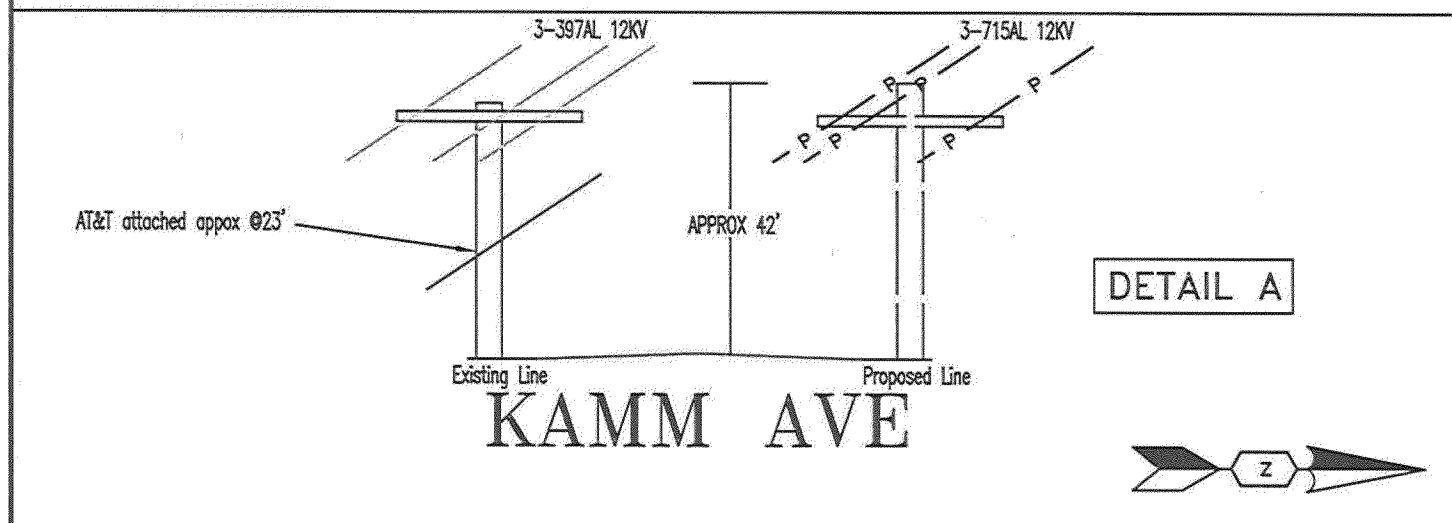
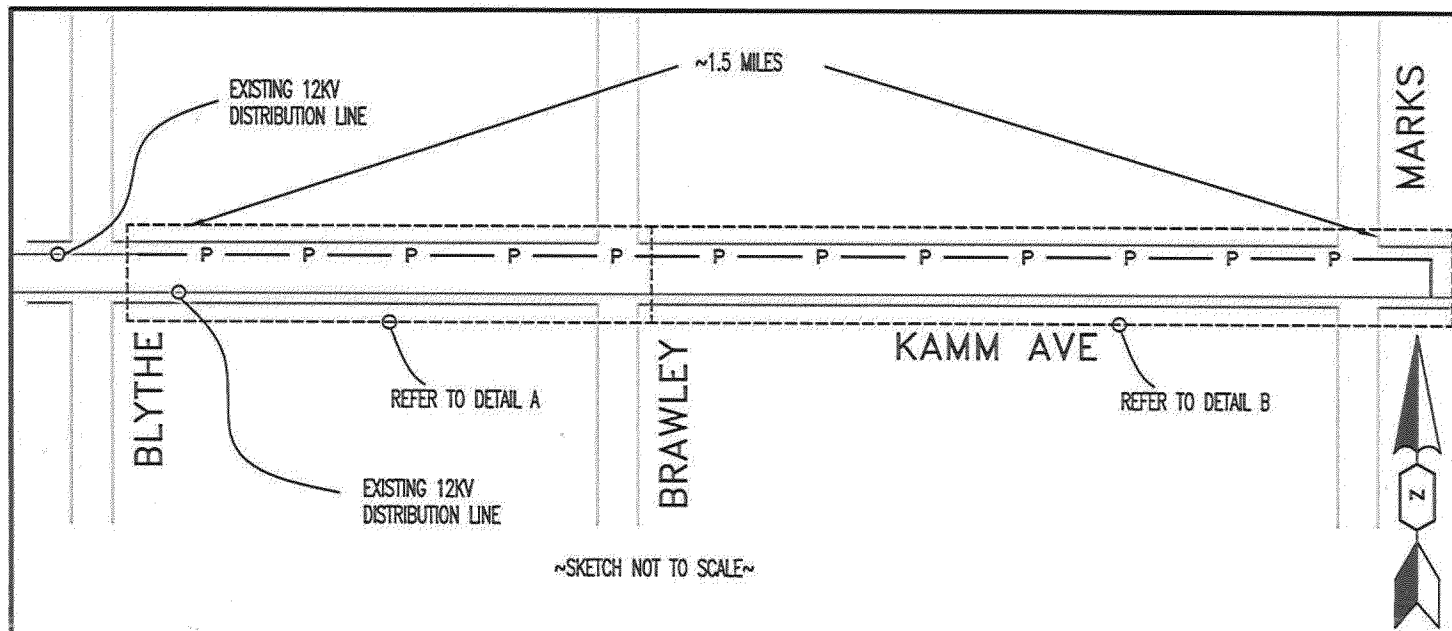

EST:
 ADE:
 SUPV:
 REP:
 PLNR: ABE ORTIZ
 SCALE: DATE: 01/17/84



CARUTHERS 1101 LINE EXTENSION
 KAMM AVE
 CARUTHERS, CA 93609
 PACIFIC GAS AND ELECTRIC COMPANY

CO:
 SD:
 NOTIF: 106981422
 OTHER:
 SHT: 1 OF 1 SHEETS
 PM: 31038245 REV.