

1
2
3
4
5
6
7
8
9
10
11
12
13
14
15
16
17
18
19
20
21
22
23
24
25
26
27
28

15H069

FIRST AMENDMENT

TO

POWER PURCHASE AGREEMENT

BETWEEN

PACIFIC GAS AND ELECTRIC COMPANY

AND

STEVEN C. ONKEN

WHEREAS, on October 27, 1981, Pacific Gas and Electric Company (PGandE) and Steven C. Onken (Seller) entered into a Power Purchase Agreement For Small Power Generation Facilities (100 kilowatts or less) (Agreement) for the purchase of power from the proposed 100 kw Bell Powerhouse site; which agreement was assigned to Swiss American Company on December 13, 1985.

WHEREAS, Seller wishes to make an engineering design change of the diversion point location to increase the generation at the power plant.

THEREFORE, the parties hereby agree to the following amendments:

Appendix B "Location Sketch" shall be amended with attached location sketch. The only revision to the former location sketch is the change in the location of the diversion point.

1
2
3
4
5
6
7
8
9
10
11
12
13
14
15
16
17
18
19
20
21
22
23
24
25
26
27
28

All other definitions and provisions of the Agreement remain unchanged. This Amendment is effective as of the last date set forth below.

SWISS AMERICAN COMPANY

PACIFIC GAS AND ELECTRIC COMPANY

By: M. Donald Reighley
M. DONALD REIGHLEY
Partner

By: Nolan H. Daines
NOLAN H. DAINES
Vice-President
Planning and Research

Date October 31, 1985

Date December 16, 1985

By: Randolph C Rowland
RANDOLPH C. ROWLAND
Partner

SR
PR

gas
attorney

Date 31 Oct 85

By: Janice L. Haemmig
JANICE L. HAEMMIG
Partner

Date October 31, 1985

Mailing Address: Swiss American Company
10904 Brunswick Road
Grass Valley, CA 95945

APPENDIX B, LOCATION MAP

BELL HYDROELECTRIC PROJECT

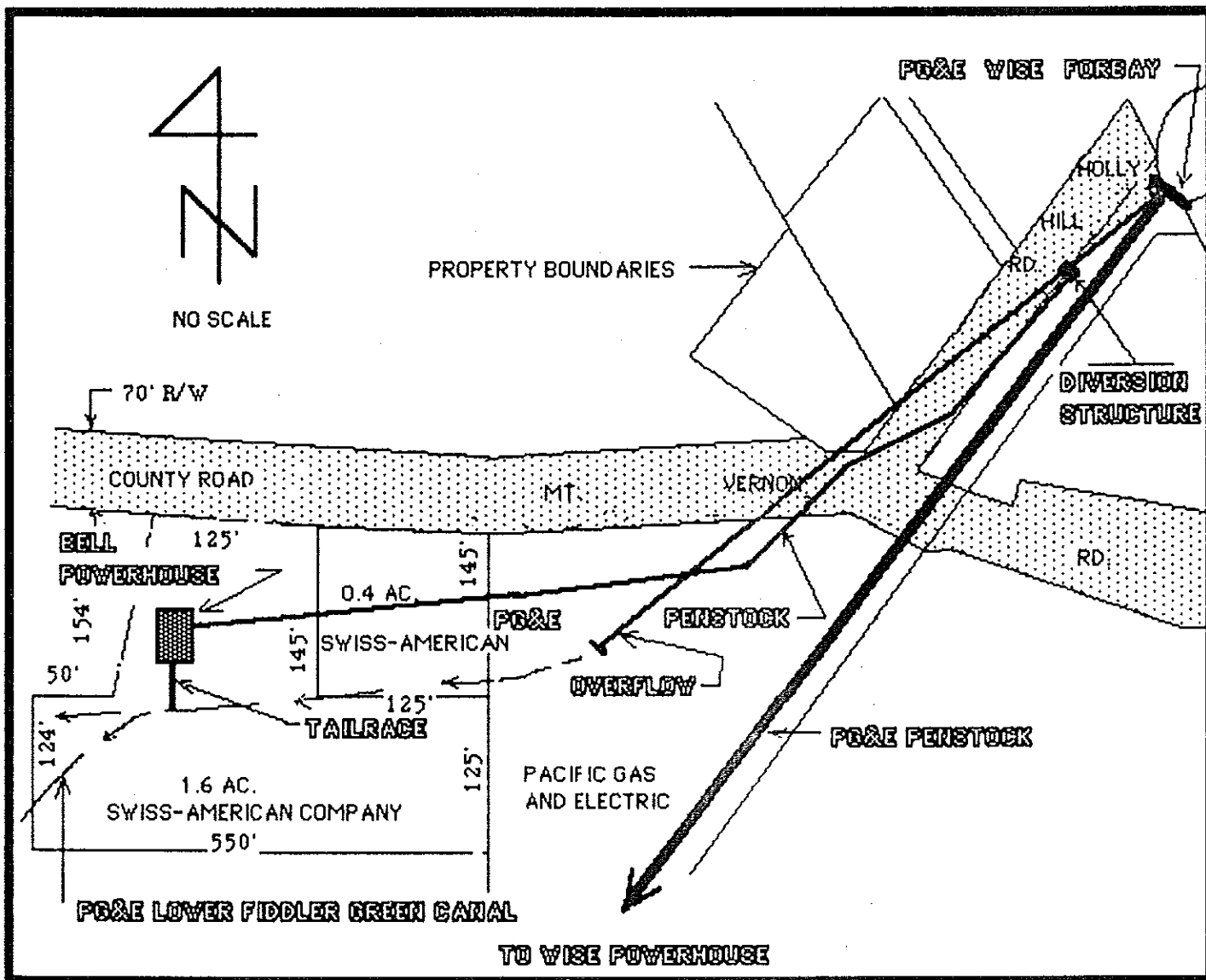

Section 9, T12N, R8E, MDM

SWISS-AMERICAN COMPANY

AUBURN, CALIFORNIA