



**Pacific Gas and
Electric Company**

Gas Information Bulletin

Title: Substation Special Leak Survey

Check all appropriate boxes

- | | | | |
|--|--|--|---|
| <input type="checkbox"/> SAFETY ALERT | <input checked="" type="checkbox"/> GAS | <input checked="" type="checkbox"/> DISTRIBUTION | <input type="checkbox"/> SUBSTATION ENGR. |
| <input checked="" type="checkbox"/> MANDATORY COMPLIANCE | <input checked="" type="checkbox"/> ELECTRIC | <input checked="" type="checkbox"/> TRANSMISSION | <input checked="" type="checkbox"/> TRANS./SUB. M&C |
| <input type="checkbox"/> RECOMMENDED ACTIONS | <input type="checkbox"/> ESTIMATING | <input type="checkbox"/> OPERATIONS | <input type="checkbox"/> APPLICANT DESIGNER /
CONSTRUCTION |
| <input type="checkbox"/> INFORMATIONAL/CLARIFICATION | <input checked="" type="checkbox"/> MAPPING | <input type="checkbox"/> SERVICE | |

The purpose of this bulletin is to establish the requirement to perform a special gas leak survey near designated electric substations where transformers and switching equipment are located inside an enclosed building. Control buildings inside fenced substations are excluded.

This bulletin amends Attachment 1 of UO Standard S4110 "Leak Survey and Repair of Gas Transmission and Distribution Facilities". It will be incorporated into the next revision of the standard and the issuing of its associated Work Procedure WP4110-D1.

Requirements

- All gas mains and services on both sides of the street in front of or adjacent to a designated substation facility shall be leak surveyed with an approved instrument every 6 months not to exceed 7 1/2 months to the date.
- The survey will include at minimum the substation building foundation line as well as any existing gas facilities located within 100' from the outermost edge(s) of the structure and include the nearest electric substructure.
- A qualified electric department employee (electrician or higher) must accompany the leak surveyor if entry into the substation is required.
- The leak surveyor must immediately contact the leak survey supervisor if a leak is detected.
- The leak survey supervisor must immediately consult with substation supervision to determine the proper course of action such as surveying incoming duct banks.

The diagram below is a graphical example of this leak survey requirement.

The areas in yellow are to be leak surveyed.

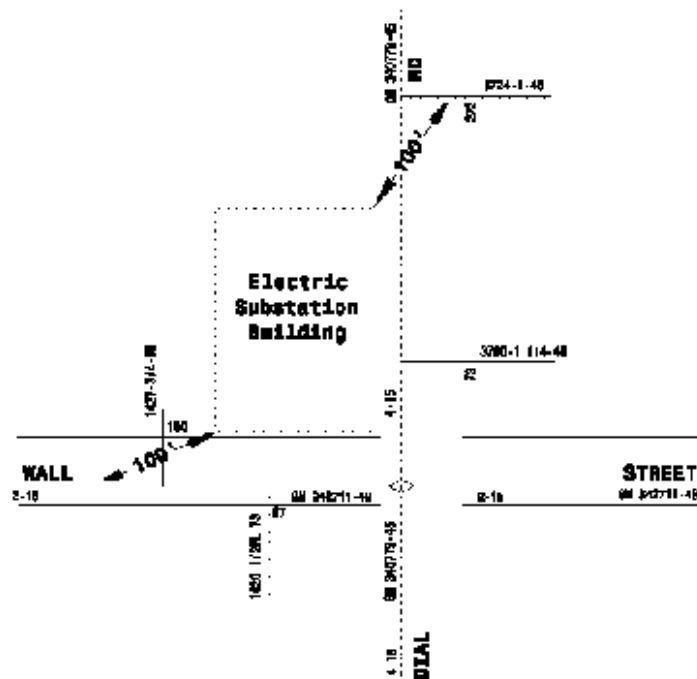

Implementation Requirements

- By June 30, 2009 all areas will discuss this issue in a scheduled Gas Compliance meeting and invite Transmission and Substation Maintenance and Construction to provide feedback on identifying electric substations needing to be included in a 6 months leak survey.
- By August 31, 2009 the Superintendent, Senior Gas Engineer and Mapping will need to concur and review both gas and electric plats and have the designated facilities identified on the gas maps for this special leak survey.
- This special leak survey will be titled - "Substation Special Leak Survey"
- The gas and electric maps will be assembled together in a binder and distributed prior to the target survey months.
- The first of this special leak survey will be completed by September 30, 2009.

This bulletin amends Attachment 1 of UO Standard S4110 "Leak Survey and Repair of Gas Transmission and Distribution Facilities". It will be incorporated into the next revision of the standard and the issuing of its associated Work Procedures.

DEFINITION:

Electric Substructure: Manholes, vaults, splice boxes and pole risers.

Approved by:

Robert P. Fassett

Date: 06/01/2009

Author: [REDACTED]

If you have any questions about this bulletin, please call the employee(s) listed below:

Contact(s):

LAN ID(s):

Phone(s):

